

PLANS PREPARED FOR THE NCDOT BY:

M MOTT MACDONALD I & E, LLC
1101 HAYNES STREET, SUITE 101
RALEIGH, NC 27604
NC LICENSE NO. F-0669

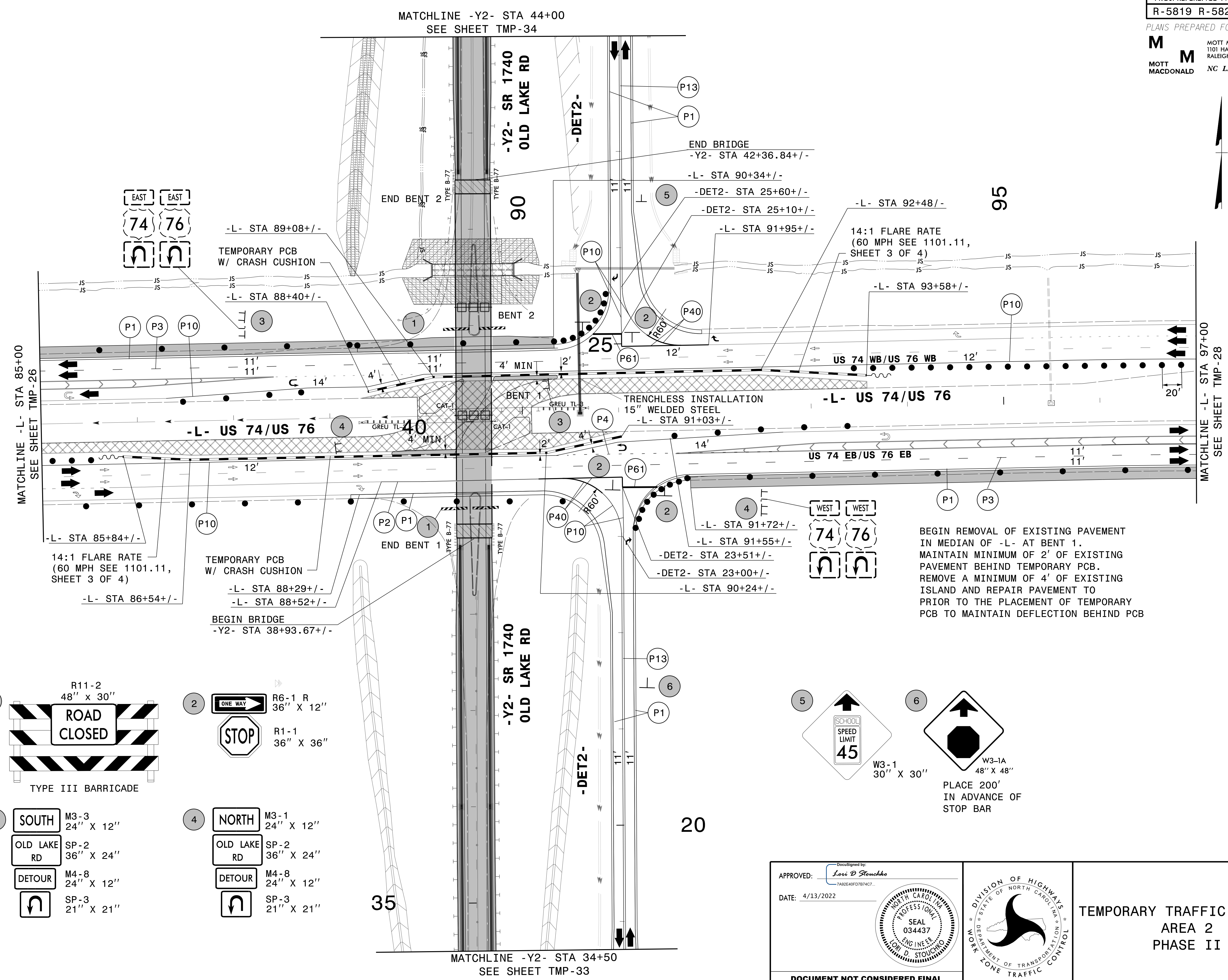

- 1 R11-2 48" x 30" ROAD CLOSED TYPE III BARRICADE
- 2 R6-1 R 36" x 12" ONE WAY, R1-1 36" x 36" STOP
- 3 SOUTH M3-3 24" x 12", SP-2 36" x 24", M4-8 24" x 12", SP-3 21" x 21", OLD LAKE RD, DETOUR
- 4 NORTH M3-1 24" x 12", SP-2 36" x 24", M4-8 24" x 12", SP-3 21" x 21", OLD LAKE RD, DETOUR

BEGIN REMOVAL OF EXISTING PAVEMENT IN MEDIAN OF -L- AT BENT 1. MAINTAIN MINIMUM OF 2' OF EXISTING PAVEMENT BEHIND TEMPORARY PCB. REMOVE A MINIMUM OF 4' OF EXISTING ISLAND AND REPAIR PAVEMENT TO PRIOR TO THE PLACEMENT OF TEMPORARY PCB TO MAINTAIN DEFLECTION BEHIND PCB

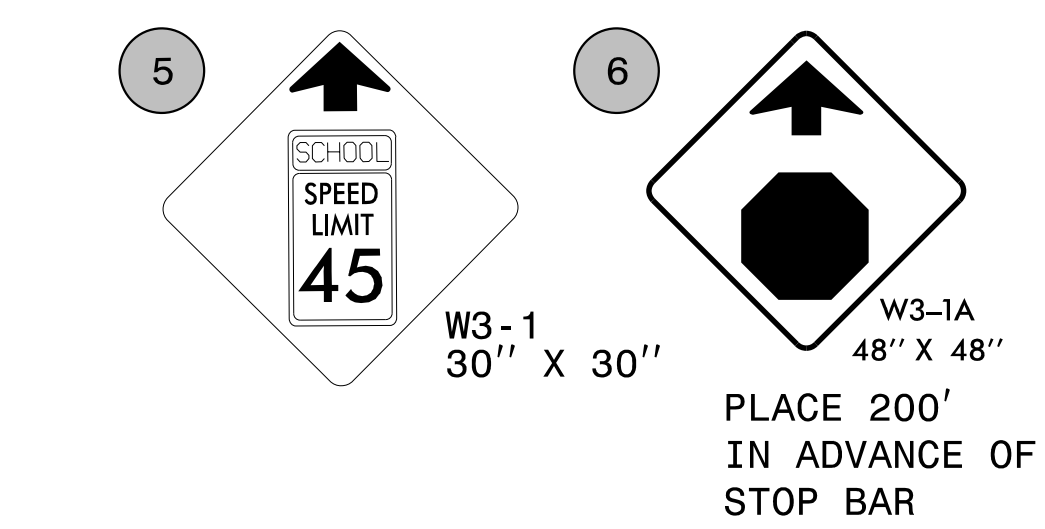

APPROVED: *Lori D. Stoucho*
DATE: 4/13/2022

Seal: NORTH CAROLINA PROFESSIONAL ENGINEER LOW D. STOUCHO 034437

DOCUMENT NOT CONSIDERED FINAL UNLESS ALL SIGNATURES COMPLETED

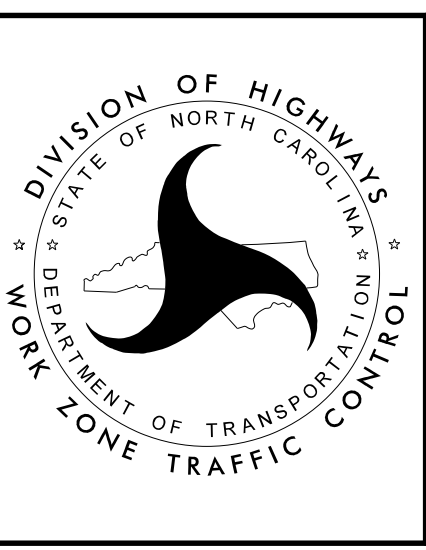

TEMPORARY TRAFFIC CONTROL AREA 2 PHASE II

3/14/2022 G:\501406565_Calyx_R5819_R5820\TrafficControl\TrafficControl\CPNR-5819_R-5820_TC_TMP_27_P2.dgn User:ST086227