

8/17/22

R:\Projects\N\5819_R5820_RDY_PSH2B-5.dgn
E:\Projects\N\5819_R5820_RDY_PSH2B-5.dgn

-Y1- DETOUR

NVS

NVS ENGINEERS & CONSULTANTS, INC.
3300 REGENCY PARKWAY, SUITE 100
CARY, NC 27518
P: 919.881.1912 www.NVS.com
NC License # F-1333
Formerly CALYX Engineers & Consultants

PROJECT REFERENCE NO. R-5819/R-5820	SHEET NO. 2B-5
RW SHEET NO.	
ROADWAY DESIGN ENGINEER 4/13/2022	HYDRAULICS ENGINEER 4/13/2022
DOCUMENT NOT CONSIDERED FINAL UNLESS ALL SIGNATURES COMPLETED	

MATCHLINE -L- STA. 27 + 50.00
SEE SHEET 2B-2

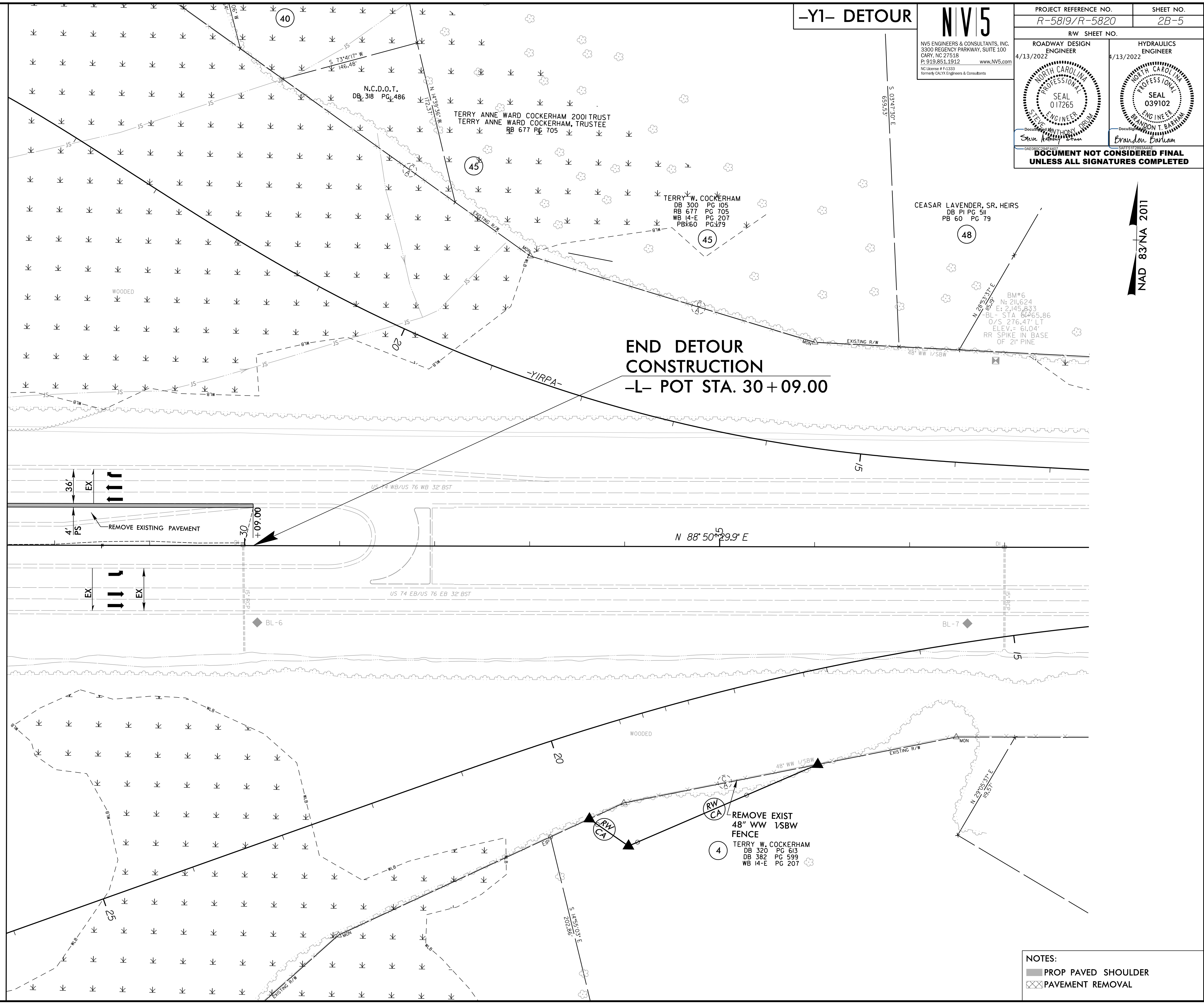

END DETOUR
CONSTRUCTION
-L- POT STA. 30 + 09.00

NOTES:

- PROP PAVED SHOULDER
- PAVEMENT REMOVAL

NAD 83/NA 2011