

NOTES

PROVIDE 1/4" HIGH BEAM BOLSTERS UPPER AT 4'-0" CTS. ATOP THE METAL STAY-IN-PLACE FORMS TO SUPPORT THE BOTTOM MAT OF "A" BARS. WHEN USING REMOVABLE FORMS, PROVIDE CONTINUOUS HIGH CHAIRS FOR METAL DECK (C.H.C.M.) @ 4'-0" CTS. WITH A HEIGHT TO SUPPORT THE BOTTOM MAT OF "A" BARS A CLEAR DISTANCE OF 2 1/2" ABOVE THE TOP OF THE REMOVABLE FORM.

LONGITUDINAL STEEL MAY BE SHIFTED SLIGHTLY, AS NECESSARY, TO AVOID INTERFERENCE WITH STIRRUPS IN PRESTRESSED CONCRETE GIRDERS.

PREVIOUSLY CAST CONCRETE IN A CONTINUOUS UNIT SHALL HAVE ATTAINED A MINIMUM COMPRESSIVE STRENGTH OF 3,000 PSI BEFORE ADDITIONAL CONCRETE IS CAST IN THE UNIT.

BARRIER RAIL IN A CONTINUOUS UNIT SHALL NOT BE CAST UNTIL ALL SLAB CONCRETE IN THE UNIT HAS BEEN CAST AND HAS REACHED A MINIMUM COMPRESSIVE STRENGTH OF 3,000 PSI.

THE TOP SURFACE OF THE END BENT CAP AND WINGS, EXCLUDING THE BEARING AREA AND NON-INTEGRAL AREA AT ENDS OF CAP, SHALL BE RAKED TO A DEPTH OF 1/4".

FOR 6" PVC DECK DRAINS, SEE DRAIN DETAILS IN TYPICAL SECTION SHEET 2 OF 2, AND "PLAN OF SPANS".

* SPLICE #5 B7 BARS TO THE ALTERNATING ENDS OF THE B8 AND B11 BARS. (SEE "PLAN OF SPANS")

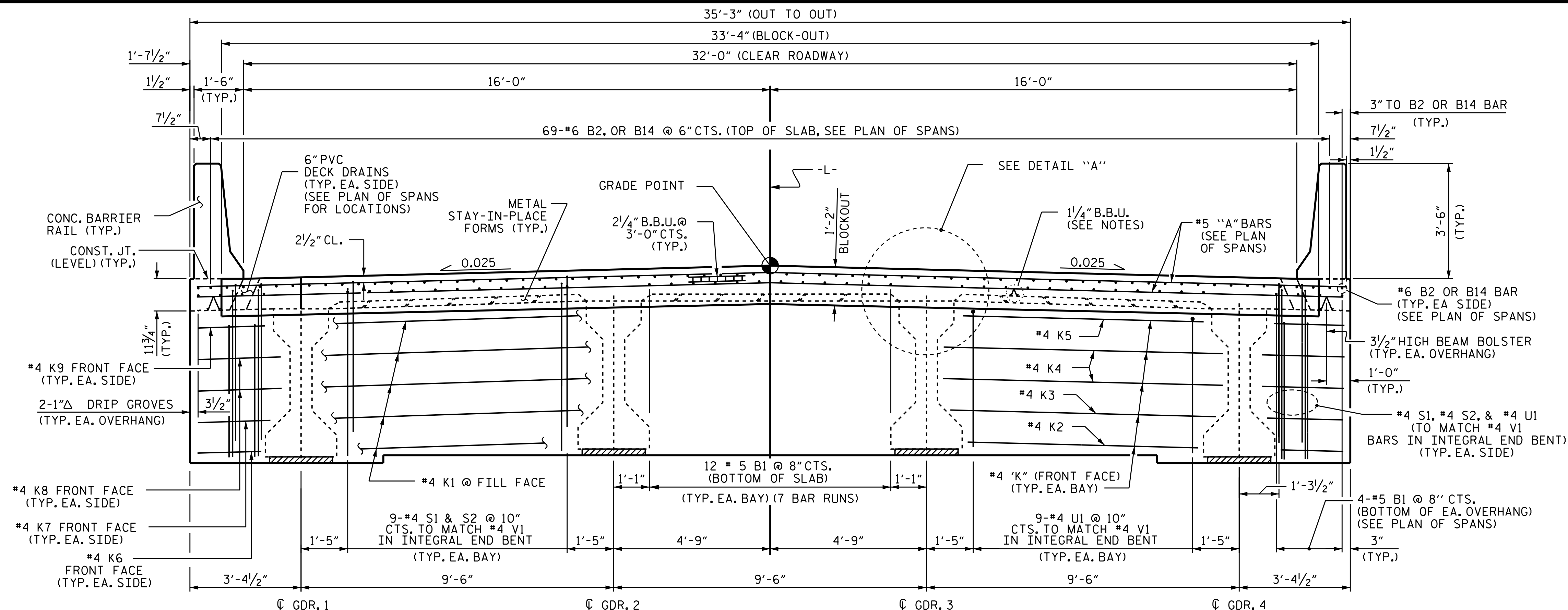

TYPICAL SECTION AT INTEGRAL END BENT
SHOWING ABUTMENT WALL AT FILL FACE OF END BENTS. WINGS NOT SHOWN FOR CLARITY.

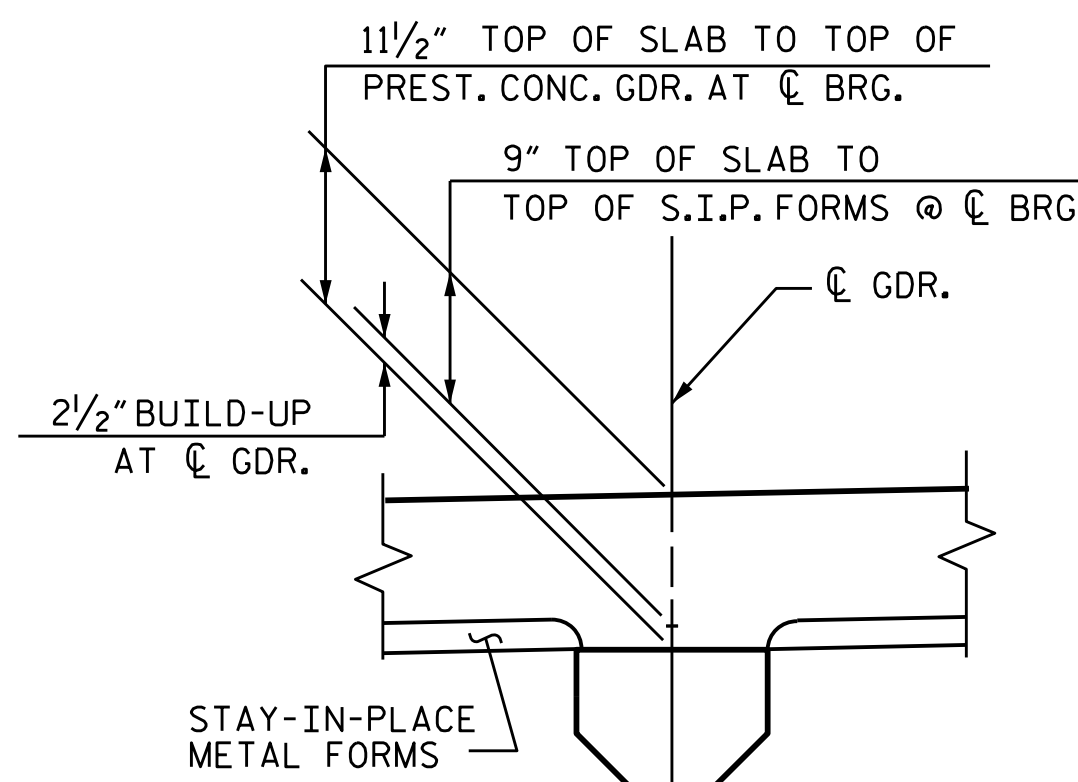

DETAIL "A"
(TYP. EA. GDR.)

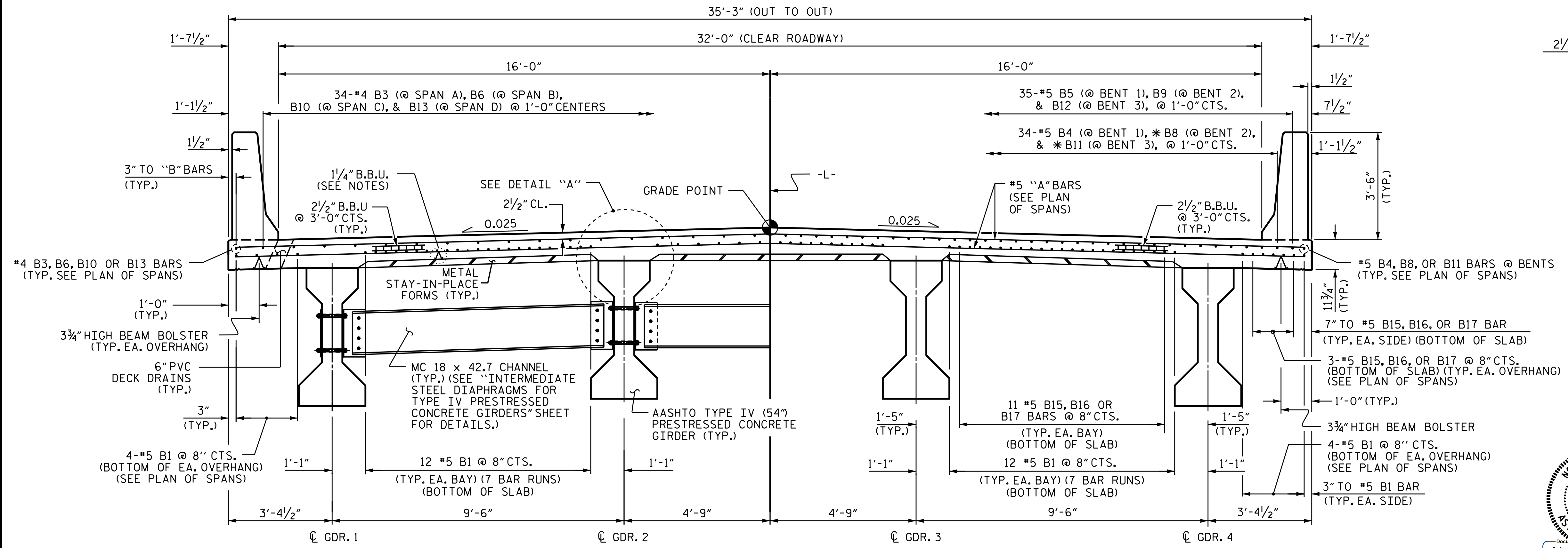

HALF SECTION AT MIDSPAN **HALF SECTION - LINK SLAB AREA AT BENTS**

TYPICAL SECTION

PROJECT NO. B-5694
BLADEN COUNTY
STATION: 21+85.10 -L-

SHEET 1 OF 2

STATE OF NORTH CAROLINA
DEPARTMENT OF TRANSPORTATION
RALEIGH
SUPERSTRUCTURE
TYPICAL SECTIONS

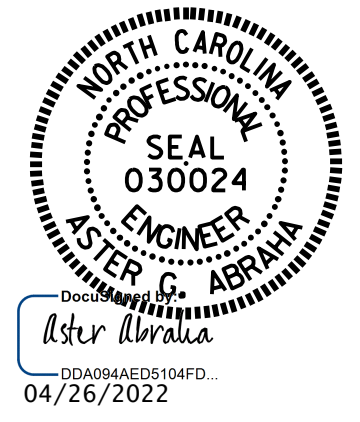

DRAWN BY: A. Y. GODFREY DATE: 07/2020
CHECKED BY: S. WANCE DATE: 09/2020
DESIGN ENGINEER OF RECORD: M. M. AHMED DATE: 08/2019

REVISIONS						SHEET NO.
NO.	BY:	DATE:	NO.	BY:	DATE:	S-6
1			3			TOTAL SHEETS
2			4			37

DOCUMENT NOT CONSIDERED FINAL UNLESS ALL SIGNATURES COMPLETED