

For Excavation Under Bridge  
Install 880 sq. yd. of Coir Fiber Matting for  
Erosion Control for Stabilization as Work Allows.

NOTE: UTILIZE SPECIAL STILLING  
BASIN(S) WHERE APPLICABLE

50 x 20 x 3  
1.5 inch Skimmer  
with 0.875 inch  
Orifice Diameter  
4 ft. weir  
ID 4.1

Temporary Rock  
Silt Check Type A  
1.75 ft. weir height

Temporary Rock  
Silt Check Type A  
1.75 ft. weir height

Temporary Rock  
Silt Check Type A  
1.5 ft. weir height

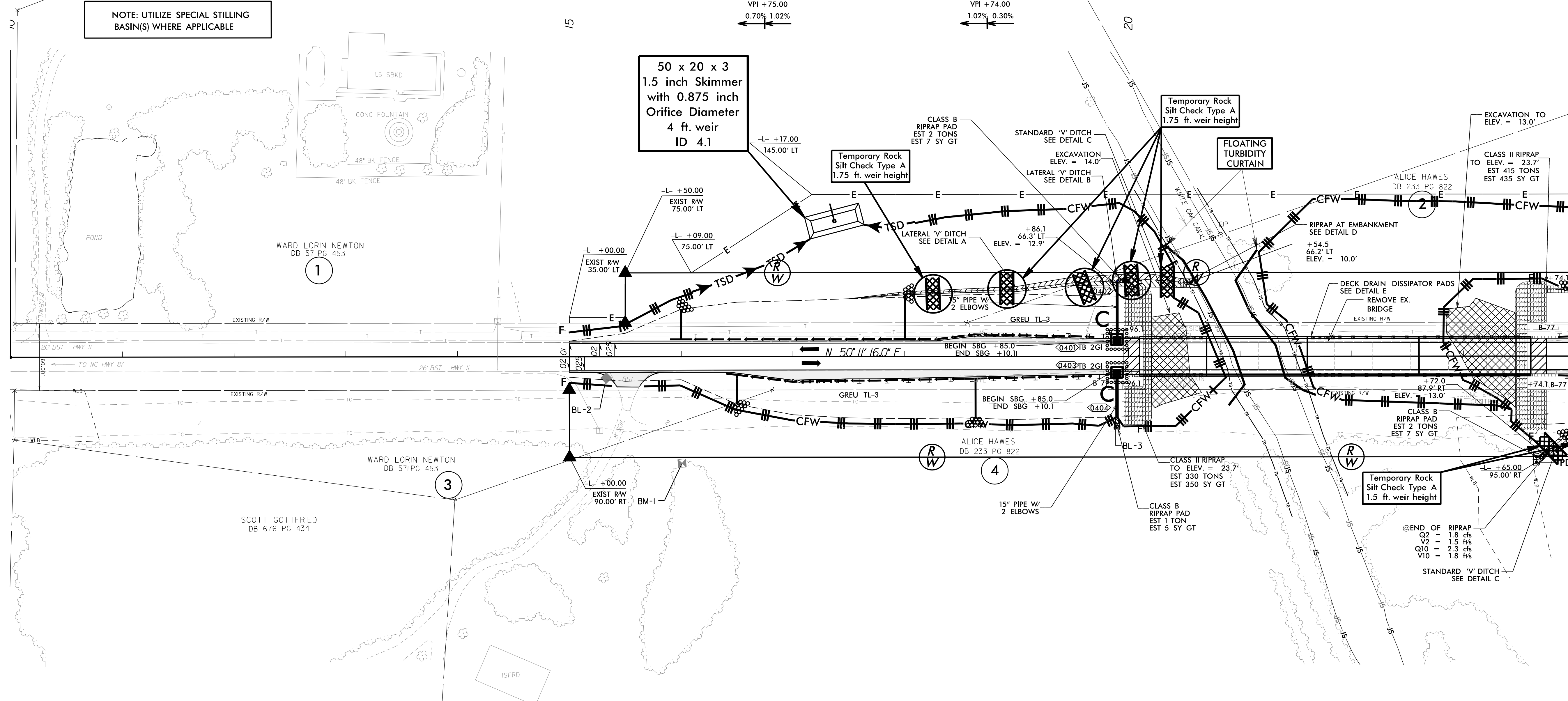

0401 TB 2GI @ -L- STA 19+90.1 LT DA = 0.02 acres C = 0.9 I = 4 in/hr Rdwy. Grade = 0.003 f/ft Cross Slope = 0.025 f/ft Rim = 26.6 ft Invert = 23.4 ft	0401 15" Pipe w/2 Elbows US = 0401 US Invert = 23.4 ft DS = 0402 DS Invert = 12.9 ft L = 51.5 ft n = 0.024 S = 20.0% Q10 = 0.1 cfs V10 = 3.4 f/s	Lateral 'V' Ditch - LT Side Sta. = -L- 17+50.0 to 19+86.1 Q = 1.8 cfs V = 1.1-1.8 f/s d = 0.6-0.7 ft s = 0.003-0.010 f/ft n = 0.035	Standard 'V' Ditch - RT Side Sta. = -L- 23+72.0 to 24+50.0 Q = 2.3 cfs V = 1.3 f/s d = 0.8 ft s = 0.0031 f/ft n = 0.035
0403 TB 2GI @ -L- STA 19+90.1 RT DA = 0.02 acres C = 0.9 I = 4 in/hr Rdwy. Grade = 0.003 f/ft Cross Slope = 0.025 f/ft Rim = 26.6 ft Invert = 23.4 ft	0403 15" Pipe w/2 Elbows US = 0403 US Invert = 23.4 ft DS = 0404 DS Invert = 14.7 ft L = 38.3 ft n = 0.024 S = 22.1% Q10 = 0.1 cfs V10 = 3.6 f/s	Lateral 'V' Ditch - LT Side Sta. = -L- 19+86.1 to 20+10.1 Standard 'V' Ditch Sta. = -L- 20+10.1 to 20+54.5 Q = 1.8 cfs V = 3.3 f/s d = 0.4 ft s = 0.0424 f/ft n = 0.035	

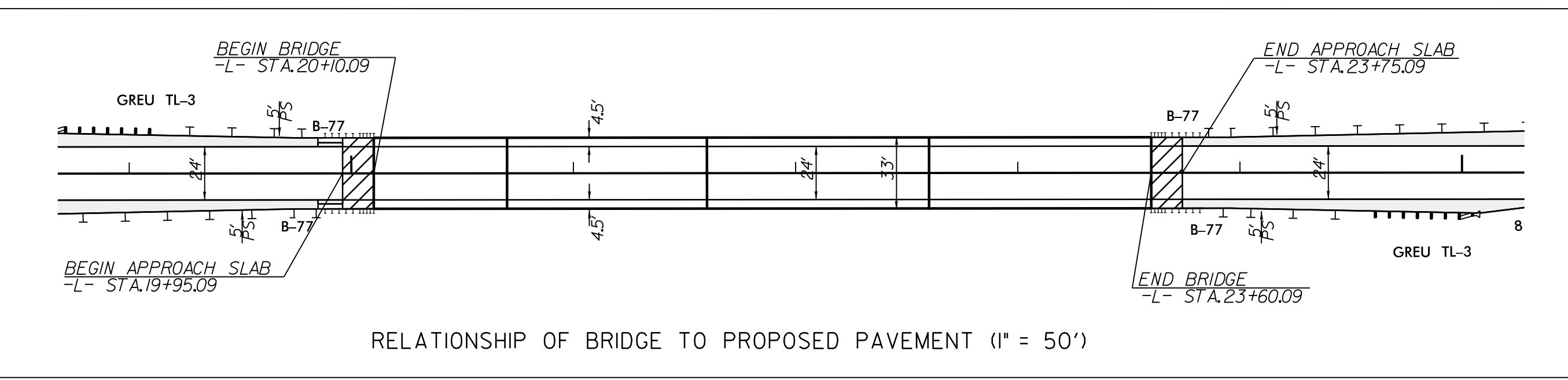

FOR -L- PROFILE SEE SHEET 8  
FOR DETOUR SEE SHEET 6/7

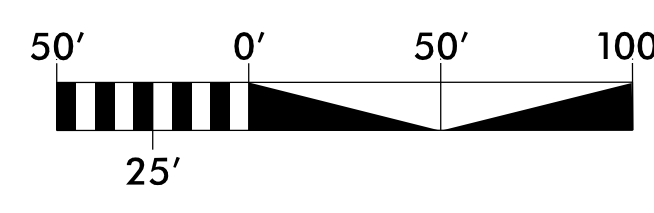

MATCH LINE STA. 24+00.0 - SEE SHEET EC-7

RELATIONSHIP OF BRIDGE TO PROPOSED PAVEMENT (1" = 50')

REVISIONS

8/17/99  
 6/7/2019  
 6/25/2019  
 8/25/2019  
 B:\5694\Roadside\CADD\PS&B-5694\_reu\_EC06.dgn  
 Savier\Waters