

5/28/2022

PROJECT REFERENCE NO. <b>B-5694</b>	SHEET NO. <b>8</b>
ROADWAY DESIGN ENGINEER <i>[Signature]</i> 036853	HYDRAULICS ENGINEER <i>[Signature]</i> 033860
4/4/2022	4/4/2022

**DOCUMENT NOT CONSIDERED FINAL UNLESS ALL SIGNATURES COMPLETED**

**BM #1 - WOODED AREA**  
**-L- STA. 16+00.71, 95.36' RT**  
**EL = 18.15'**

**BRIDGE HYDRAULIC DATA**

DESIGN DISCHARGE	= 950	CFS
DESIGN FREQUENCY	= 50	YRS
DESIGN HW ELEVATION	= 12.8	FT
BASE DISCHARGE	= 1200	CFS
BASE FREQUENCY	= 100	YRS
BASE HW ELEVATION	= 13.7	FT
OVERTOPPING DISCHARGE	= 17000	CFS
OVERTOPPING FREQUENCY	= >500+	YRS
OVERTOPPING ELEVATION	= 22.8	FT

  

DATE OF SURVEY	= 08/16/2017
W.S. ELEVATION AT DATE OF SURVEY	= 5.3 FT

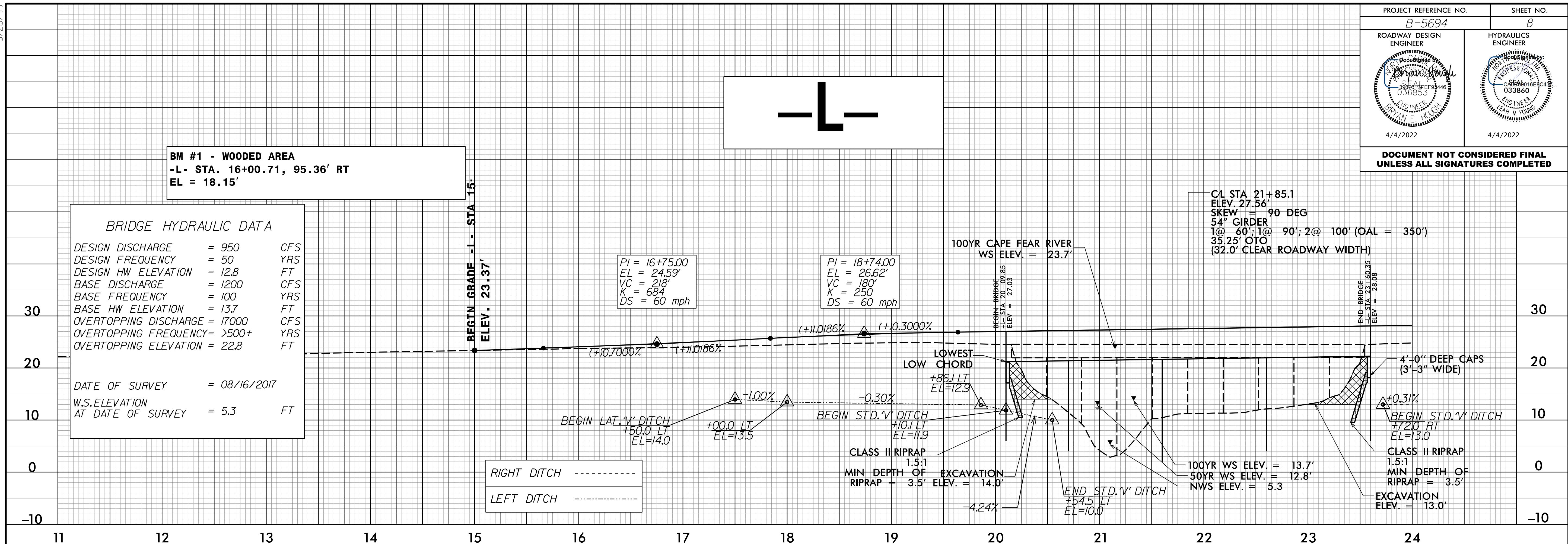

RIGHT DITCH -----

LEFT DITCH -----

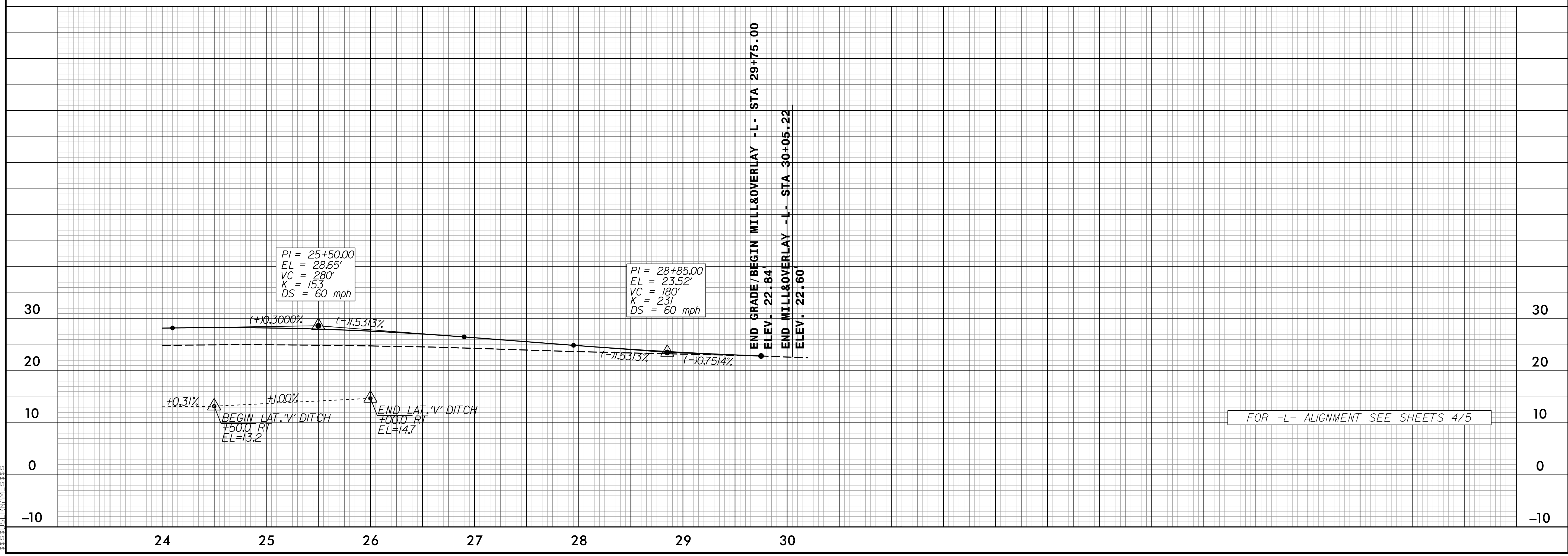

FOR -L- ALIGNMENT SEE SHEETS 4/5

D:\FEB-2022\1406\12 B-5694\Roadway\Proj\B-5694\_Rdy\_pfl\_psh.dgn