

09\_08/2019

STATE	STATE PROJECT REFERENCE NO.	SHEET NO.	TOTAL SHEETS
N.C.	<b>B-5694</b>	1	
STATE PROJ. NO.	F.A. PROJ. NO.	DESCRIPTION	
45648.1.1		P.E.	
45648.2.1		ROW & UTIL.	
45648.3.1		CONSTR.	

STATE OF NORTH CAROLINA  
 DIVISION OF HIGHWAYS  
**BLADEN COUNTY**

**LOCATION: REPLACE BRIDGE NO. 080051 OVER WHITE OAK CANAL ON NC 11**

**TYPE OF WORK: GRADING, DRAINAGE, PAVING AND STRUCTURE**

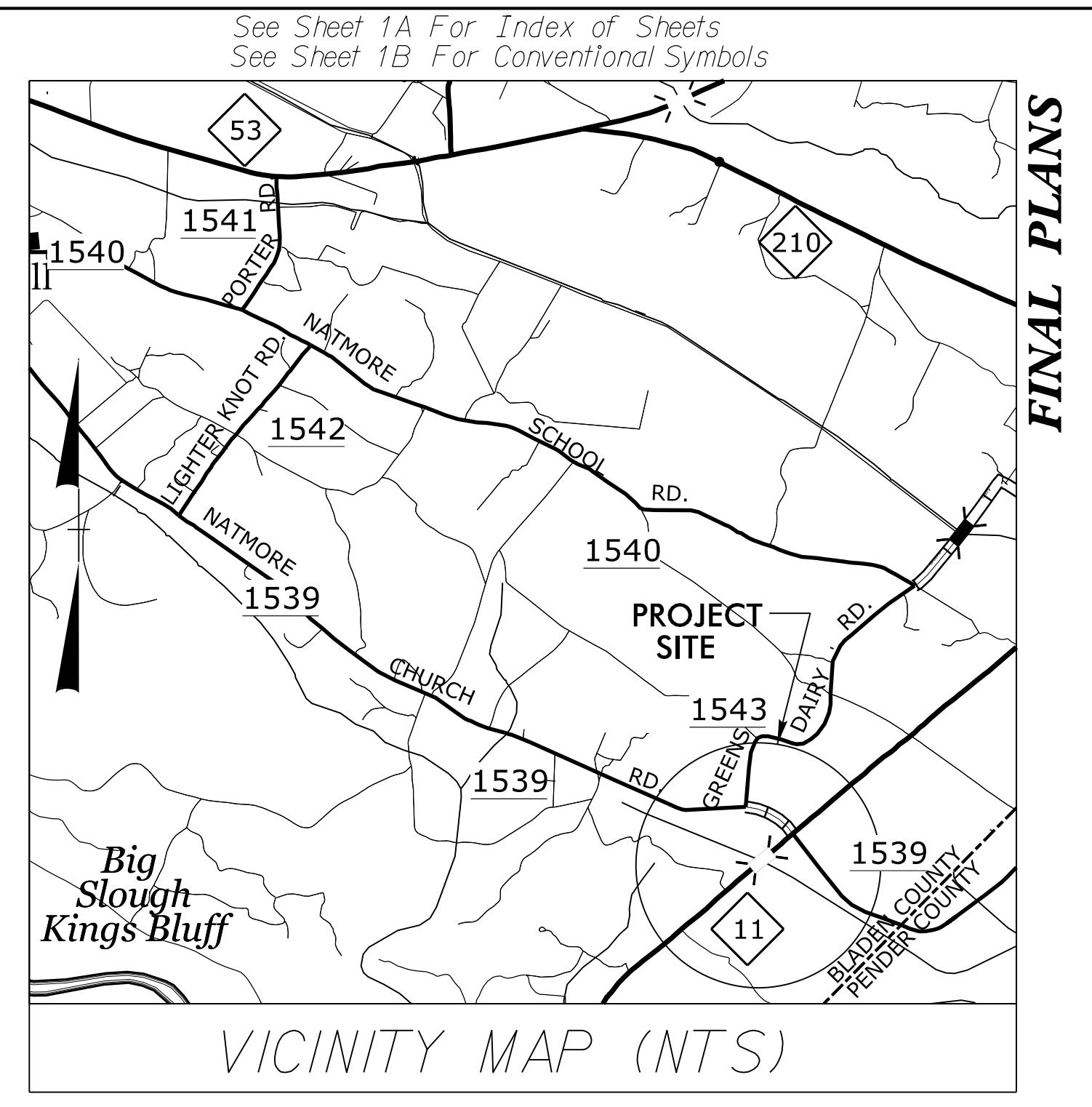

**TIP PROJECT: B-5694**

**CONTRACT: C204362**

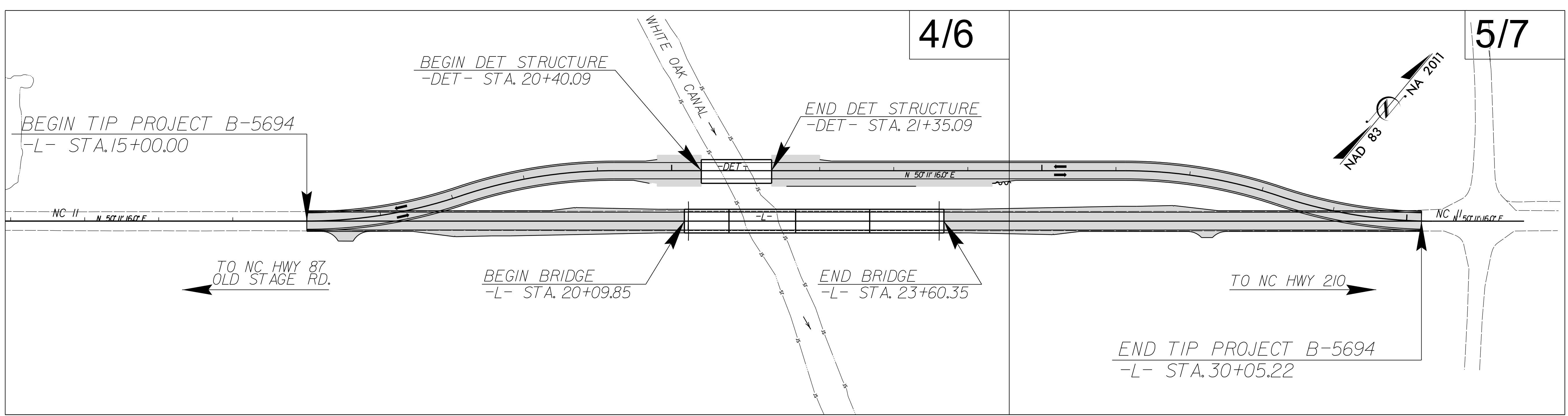

DOCUMENT NOT CONSIDERED FINAL  
 UNLESS ALL SIGNATURES COMPLETED

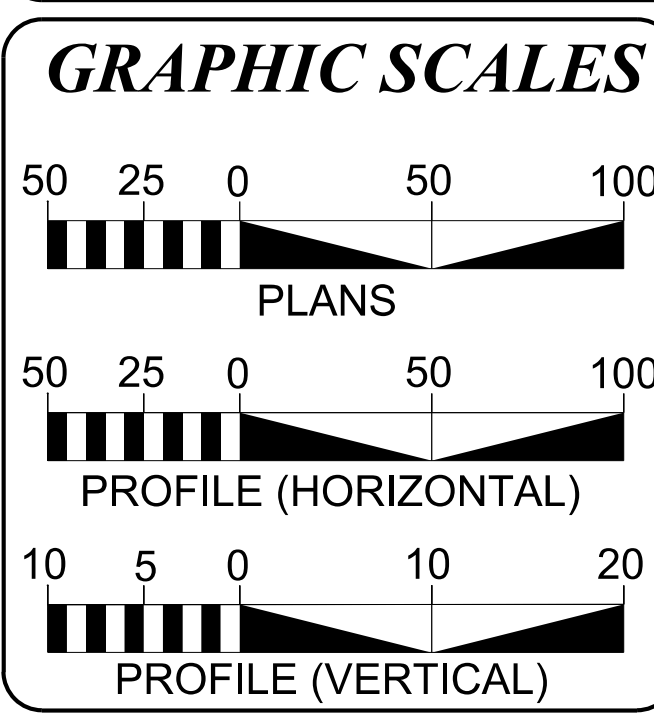

**DESIGN DATA**

ADT 2022 =	3326
ADT 2042 =	4075
K =	10 %
D =	55 %
T =	13 % *
V =	60 MPH
V (DET) =	45 MPH
* TTST =	11% DUAL 2%
FUNC CLASS =	MAJOR COLLECTOR REGIONAL TIER

**PROJECT LENGTH**

LENGTH OF ROADWAY TIP PROJECT B-5694	= .219 MILES
LENGTH OF STRUCTURE TIP PROJECT B-5694	= .066 MILES
TOTAL LENGTH OF TIP PROJECT B-5694	= .285 MILES

Prepared in the Office of:  
 KCI Associates of N.C., P.A.  
 4505 Falls of Neuse Road, Suite 400  
 Raleigh, NC 27609  
 Phone (919) 783-9214  
 Fax (919) 783-9266

2018 STANDARD SPECIFICATIONS

**RIGHT OF WAY DATE:**  
 MAY 31, 2019

**LETTING DATE:**  
 JUNE 21, 2022

**NCDOT CONTACT:**

Plans Prepared For:  
**DIVISION OF HIGHWAYS**  
 1000 Birch Ridge Dr.  
 Raleigh NC, 27610

**DEWAYNE L. SYKES, P.E.**  
 PROJECT ENGINEER

**BRYAN E. HOUGH, P.E.**  
 PROJECT DESIGN ENGINEER

**KRISTY ALFORD, P.E.**  
 STRUCTURES MANAGEMENT UNIT

**HYDRAULICS ENGINEER**

DocuSigned by:  
  
 CA0C89016E8C437...  
 P.E. 4/7/2022

**ROADWAY DESIGN ENGINEER**

DocuSigned by:  
  
 398761E1FEF93446...  
 P.E. 4/4/2022

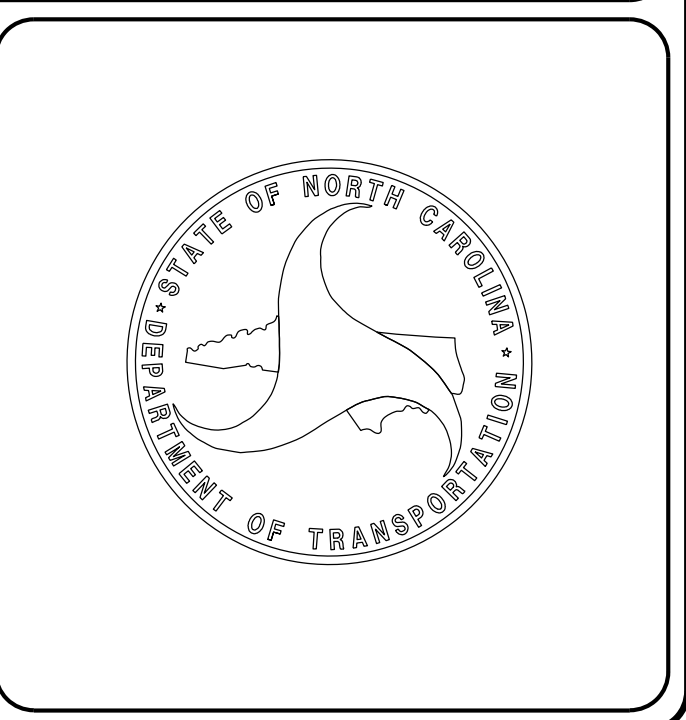

25-MAR-2022 06:46  
 M:\2018\20180945\12 B-5694\Roadway\Proj\B-5694\_Rdy\_t sh.dgn  
 \$\$\$SERVERNAME\$\$\$