

**BR-0048**  
**CROSS SECTION INDEX**

---

---

-L-	X-2 THRU X-11
-DR1-	X-12 THRU X-14
-DR2-	X-15

# STATE OF NORTH CAROLINA DIVISION OF HIGHWAYS

PROJ. REFERENCE NO.	SHEET NO.
BR-0048	X-1A

NOTE: EMBANKMENT COLUMN DOES NOT INCLUDE BACKFILL FOR UNDERCUT

## CROSS-SECTION SUMMARY

Station	Uncl. Exc.	Embt														
L	(cu. yd.)	(cu. yd.)														
10+50.00	0	0														
11+00.00	709	0														
11+50.00	1450	0														
12+00.00	1281	0														
12+50.00	1151	0														
13+00.00	1654	2														
13+50.00	2104	6														
14+00.00	2545	13														
14+50.00	3162	26														
15+00.00	2844	43														
15+50.00	1527	82														
16+00.00	419	275														
16+50.00	57	696														
17+00.00	0	1310														
17+42.50	0	1418														
Station	Uncl. Exc.	Embt														
L	(cu. yd.)	(cu. yd.)														
19+57.50	0	0														
20+00.00	116	1263														
20+50.00	108	1225														
21+00.00	130	739														
21+50.00	154	350														
22+00.00	106	189														
22+50.00	45	137														
23+00.00	7	41														
23+50.00	9	20														
24+00.00	6	20														
24+25.00	0	0														
Station	Uncl. Exc.	Embt														
Dr1	(cu. yd.)	(cu. yd.)														
10+50.00	0	0														
11+00.00	10	219														
11+50.00	20	190														
12+00.00	291	0														
12+50.00	767	0														
Station	Uncl. Exc.	Embt														
Dr2	(cu. yd.)	(cu. yd.)														
10+75.00	0	0														
11+00.00	0	20														
11+25.00	0	61														

Approximate quantities only. Shoulder borrow, fine grading, clearing and grubbing, and removal of existing pavement will be paid for at the lump sum price for "Grading".

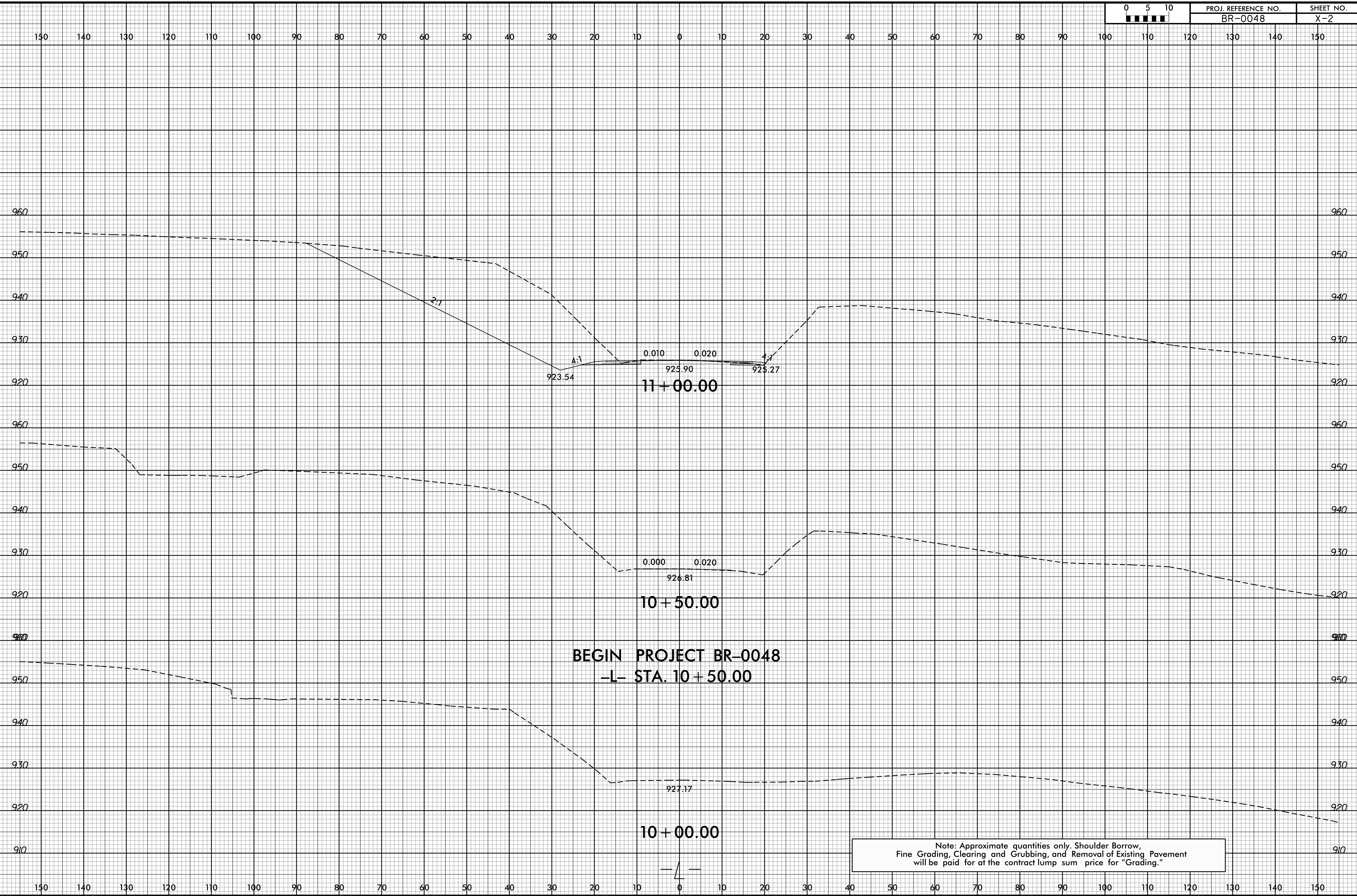

6/23/16

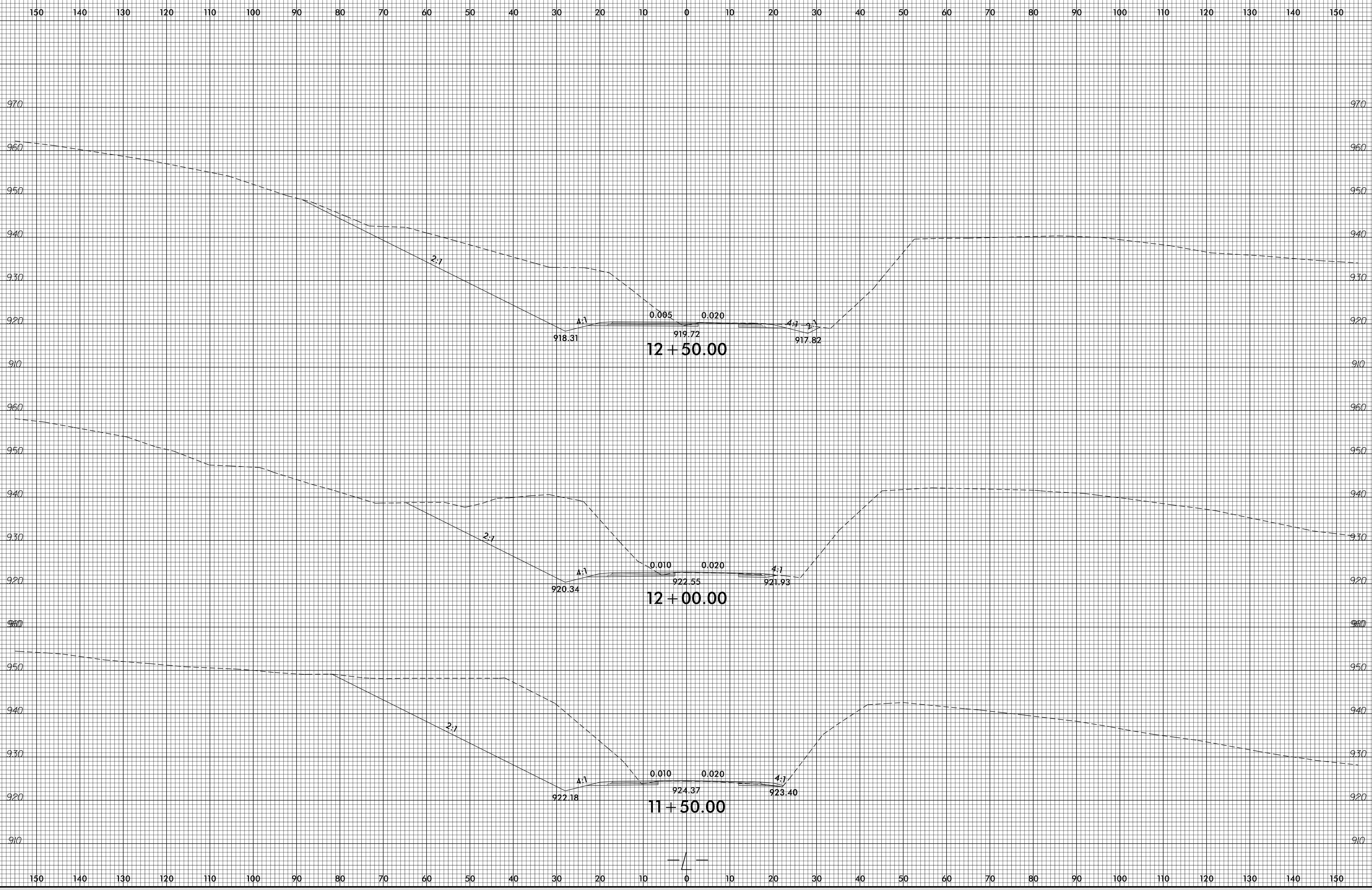

26-FEB-2021 13:47  
R:\Roadway\XSC\BR0048\Reg\_L\_xpl.dgn  
Kds:LF:tdg 41 PU-25088

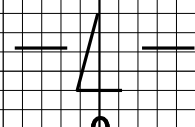

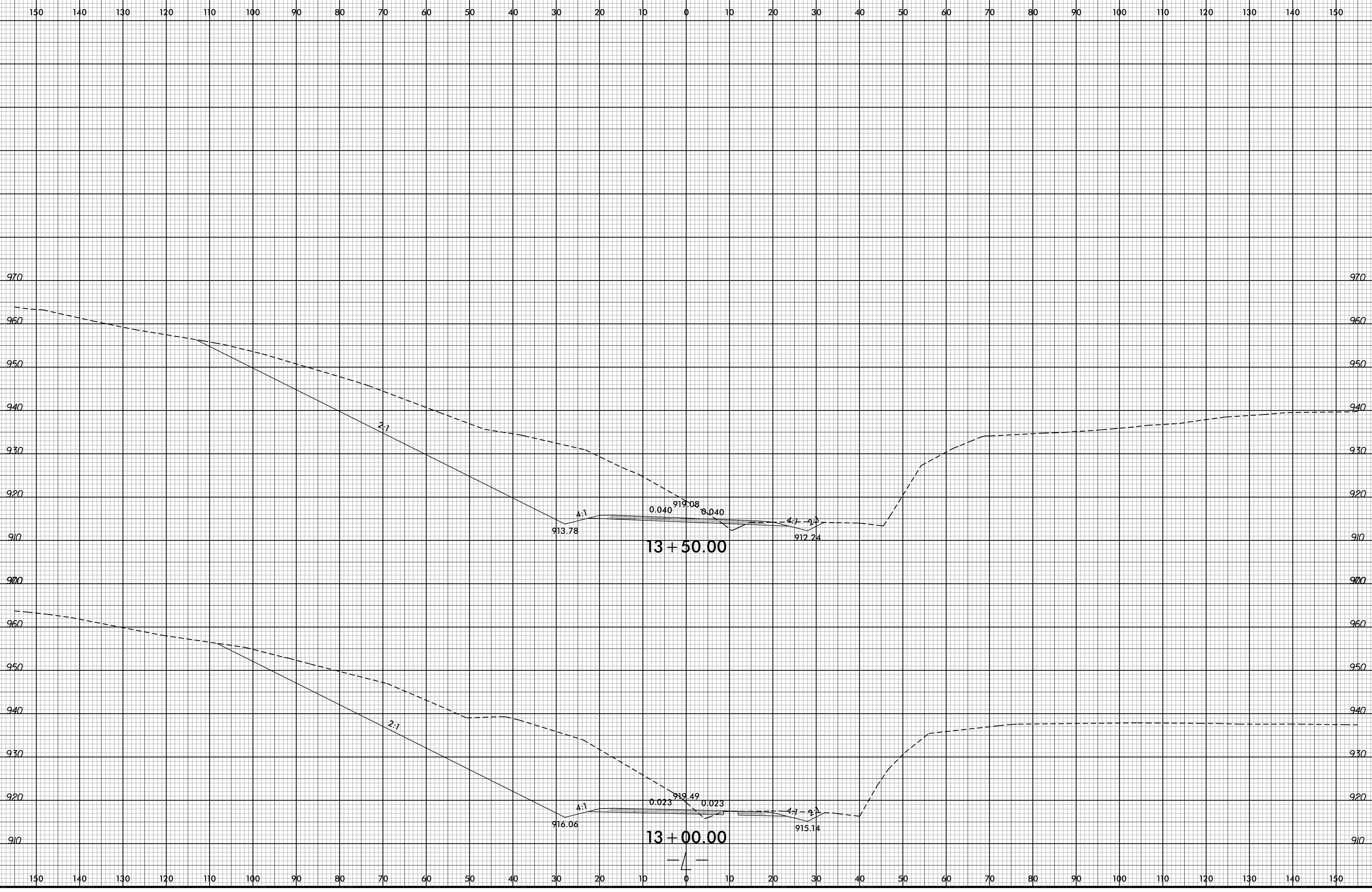

6/23/16

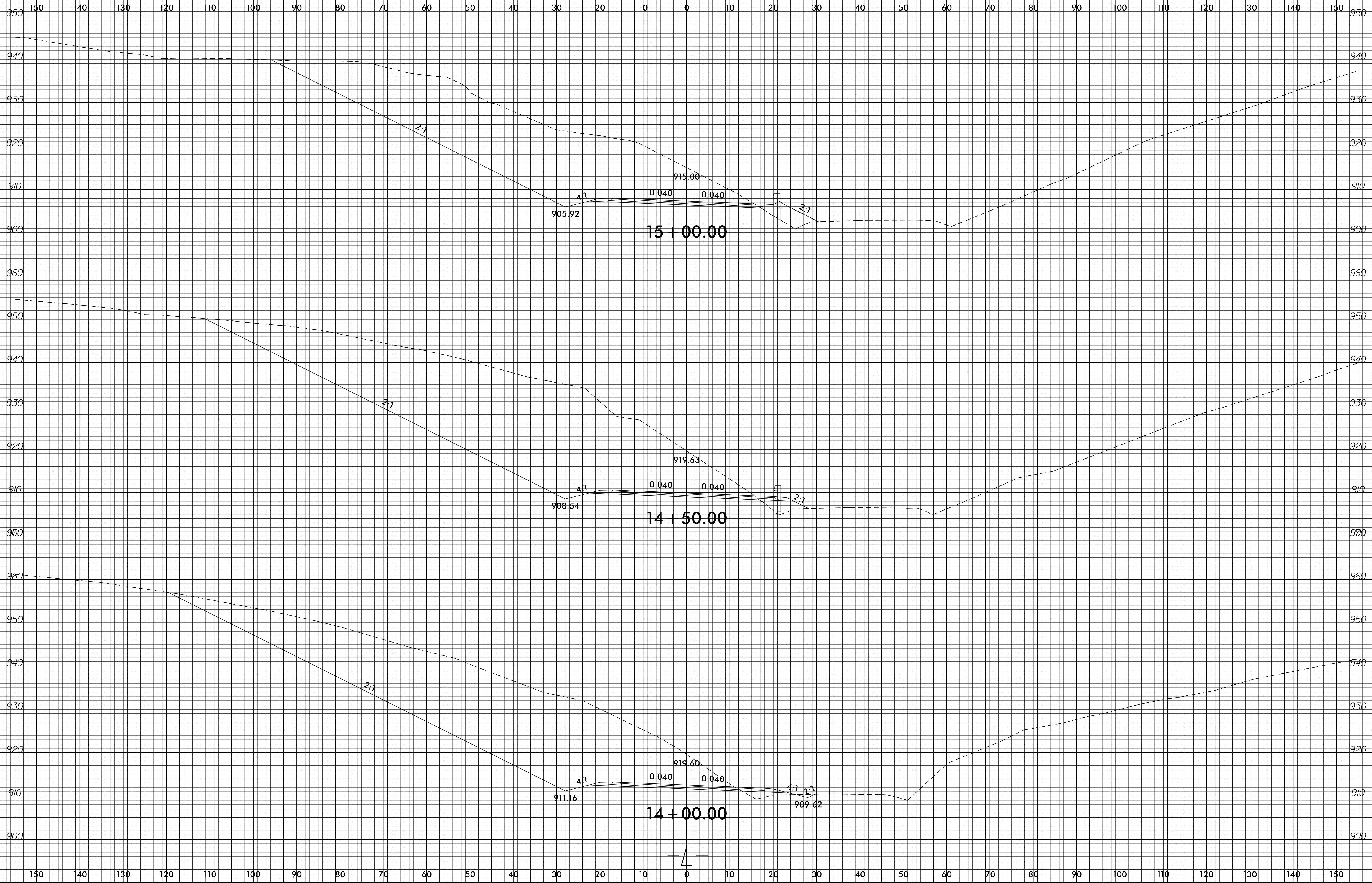

26-FEB-2021 13:47  
R:\Roadway\XSC\BR0048\RegL\_xpl.dgn  
kds,lr,tabe 41 10-29-08

6/23/16

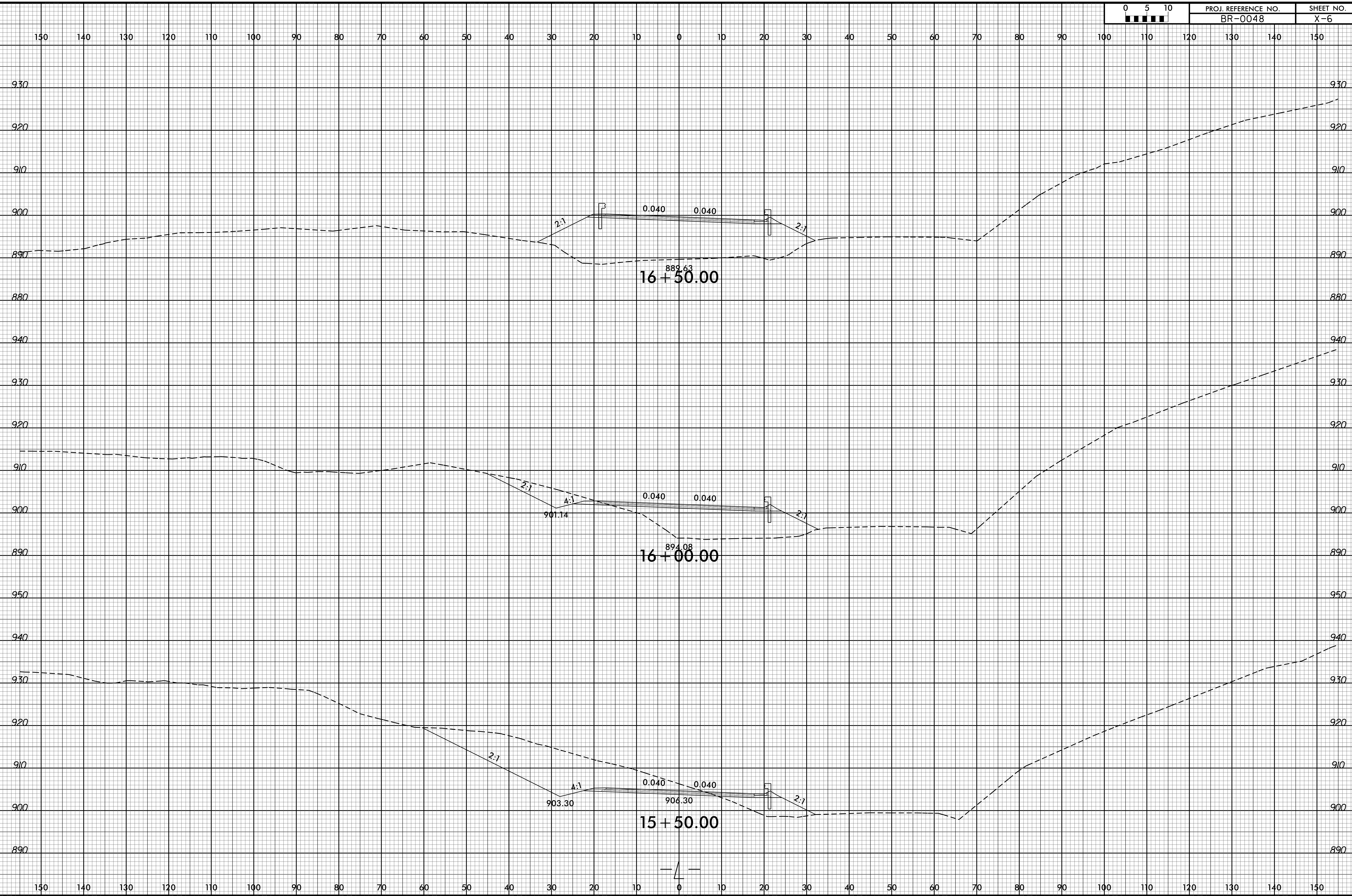

12-APR-2022 11:11  
R:\Roadway\XSC\BR0048\_Rev.L\_.xp1.dgn  
SSAUSER\AME\$

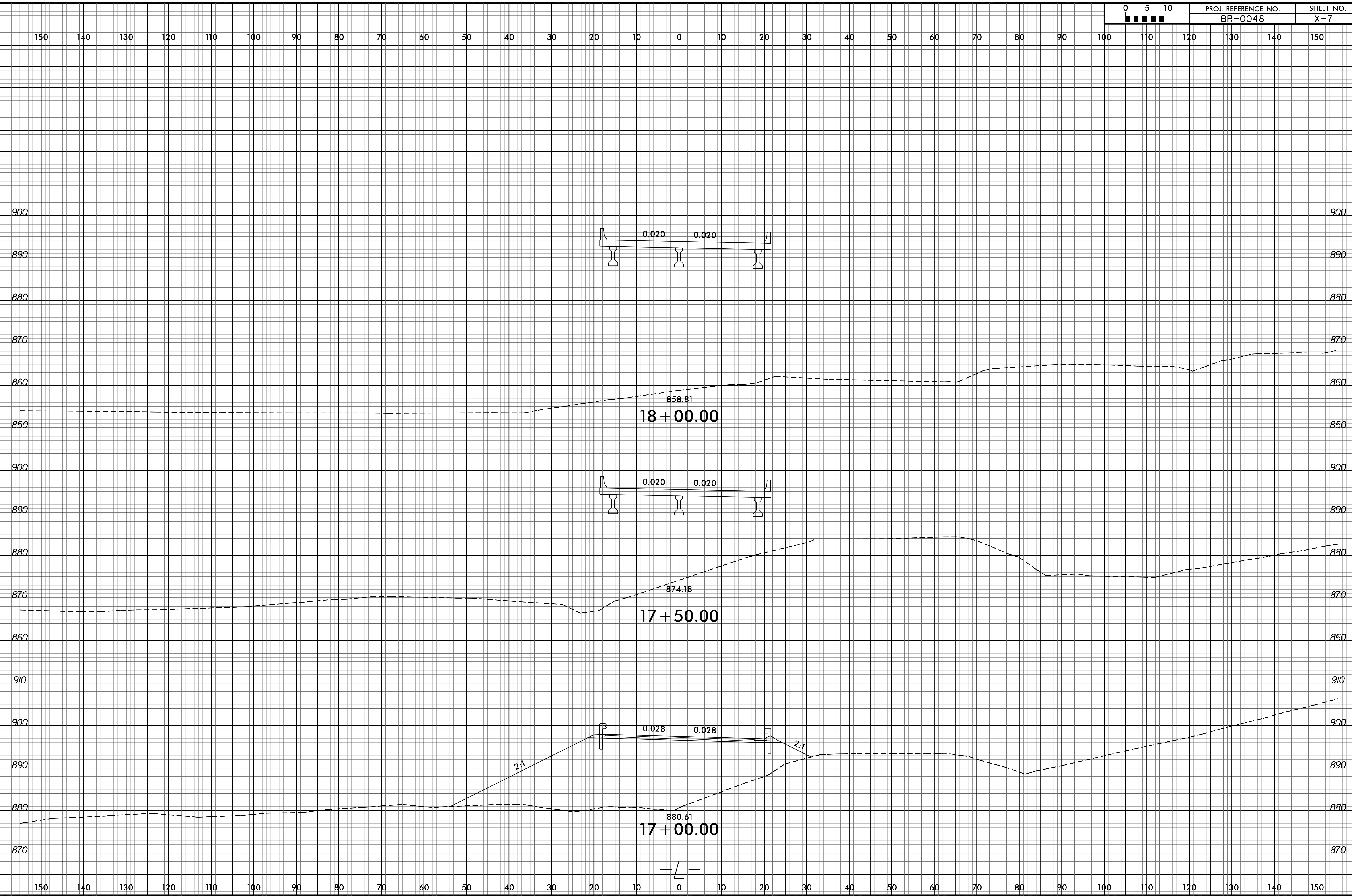



6/23/16

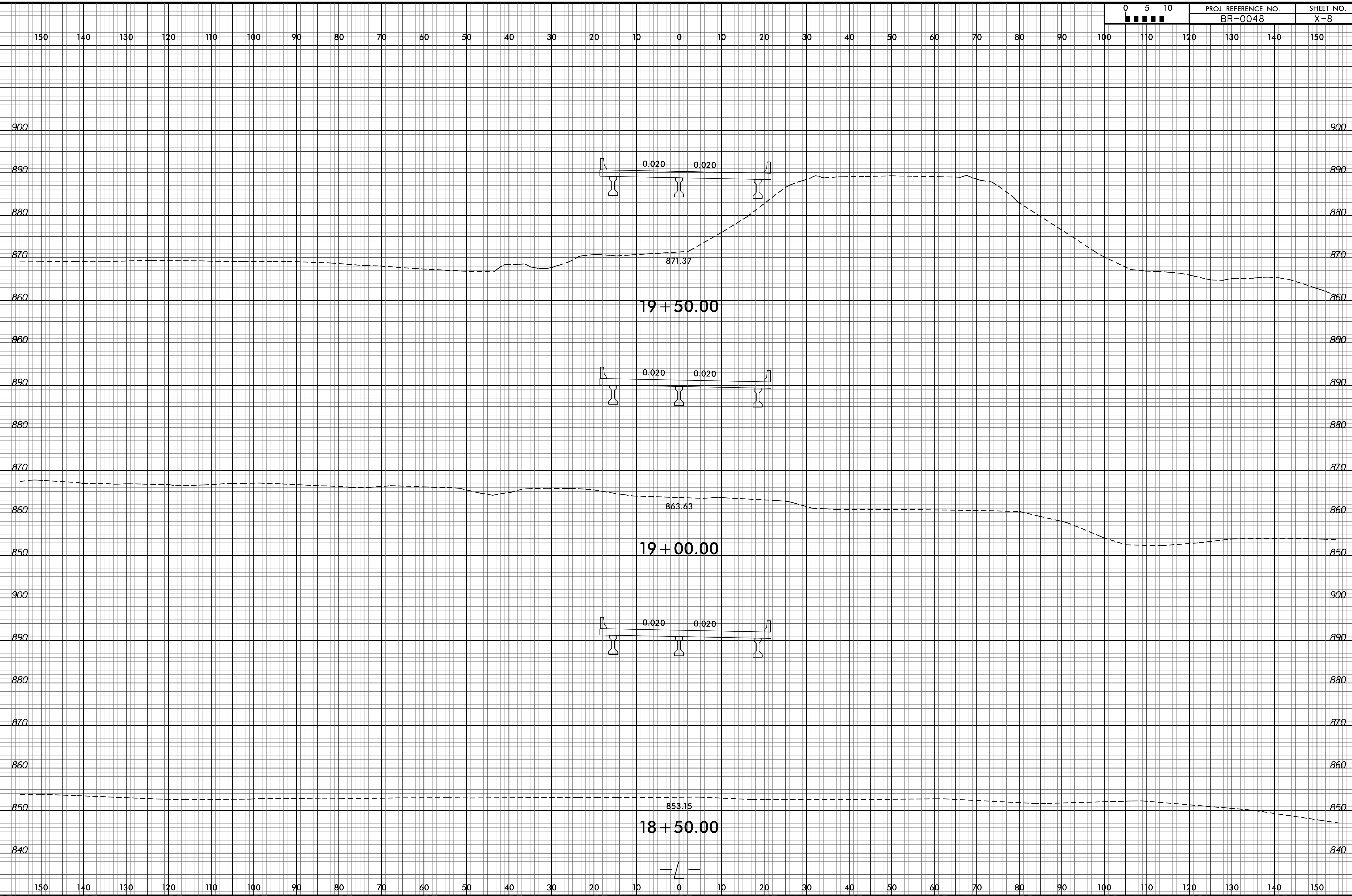

I2-APR-2022 11:01  
R:\Roadway\XSC\BR0048\_Revj\_L\_xpl.dgn  
SS&USER\MES

6/23/16

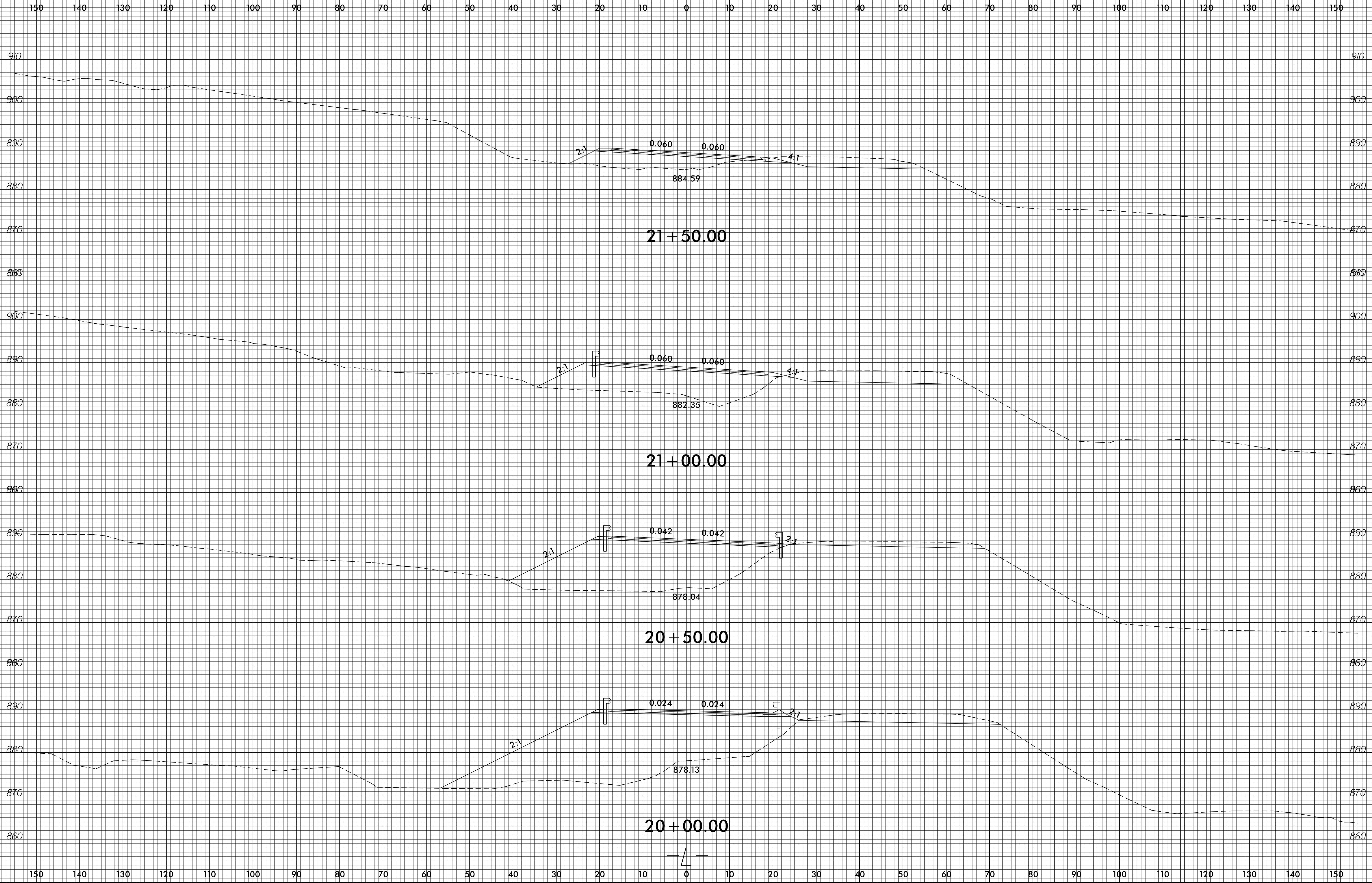

16-MAR-2021 08:12  
F:\Roadway\XSC\_BR0048\Revs\_L\_xpl.dgn  
xds:lf:tbl: 41 PU-219038

6/23/16

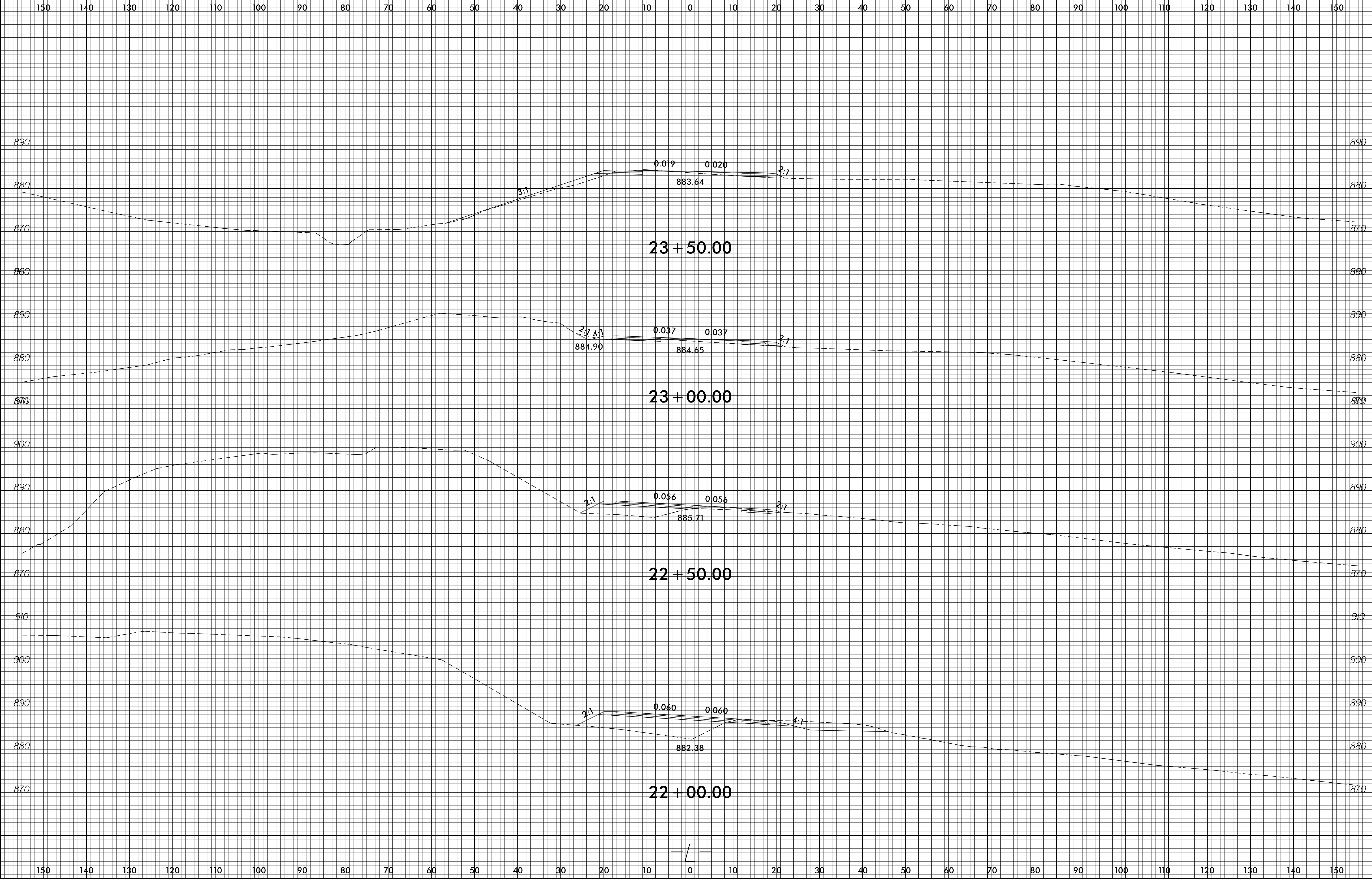

I:\MAR-2021\08:05  
R:\Roadway\XSC\BR0048\RegL\_xpl.dgn  
41 PU-25-0088

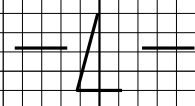

6/23/16

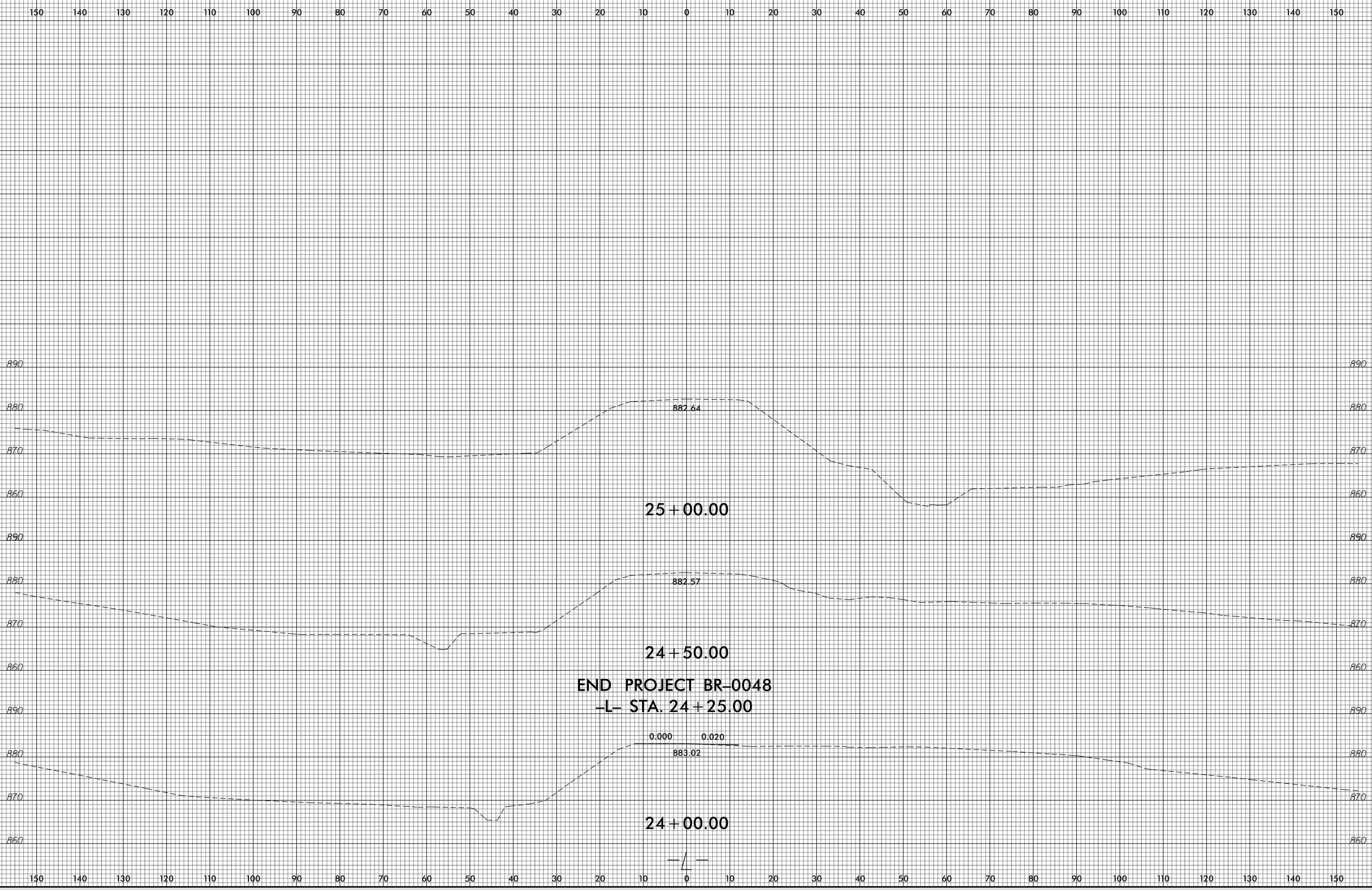

26-FEB-2021 13:47  
R:\Roadway\XSC\BR0048\RegL\_xpl.dgn  
kds:brt:tbl: 41 PU-25-0038

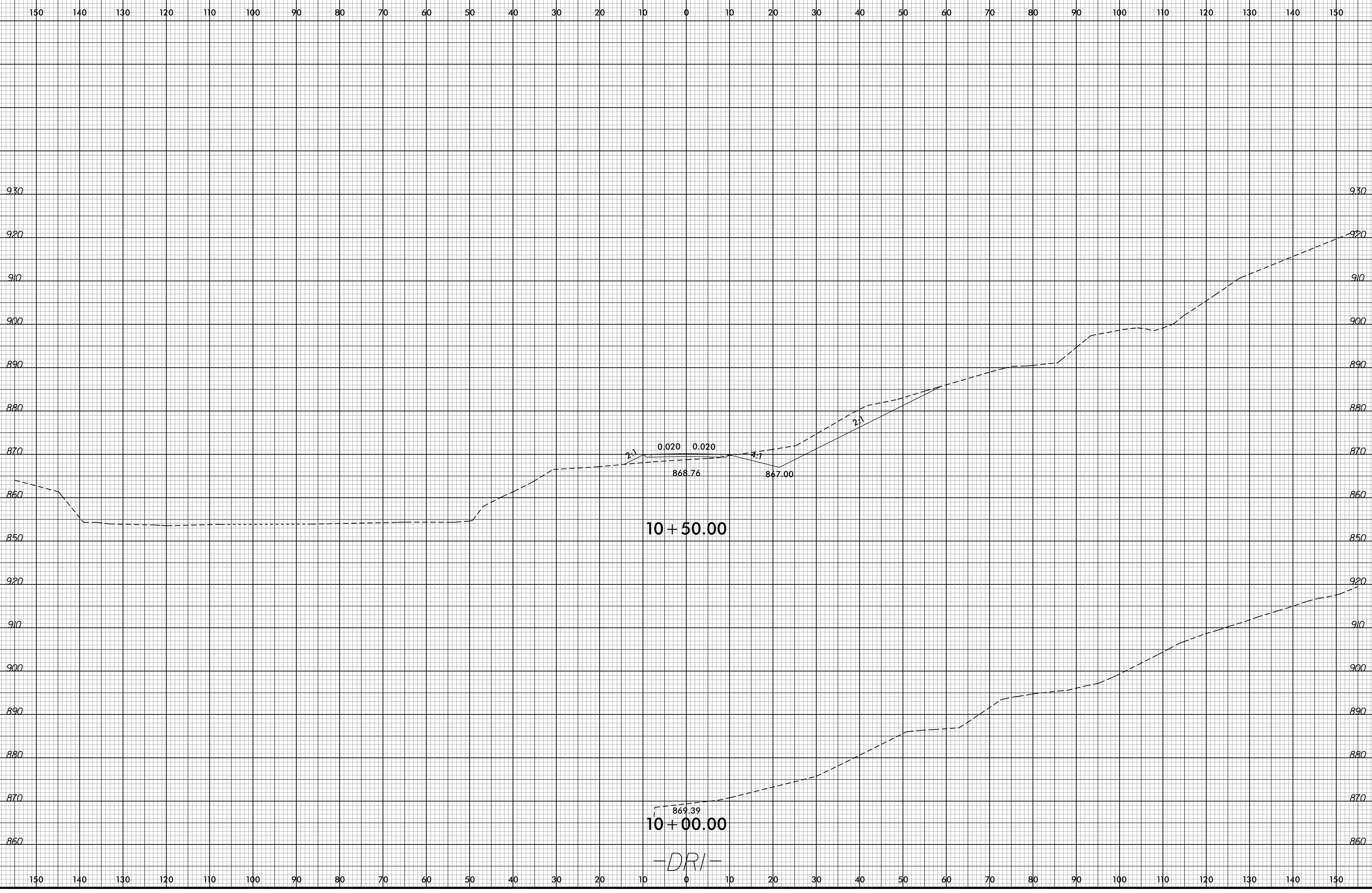

6/23/16

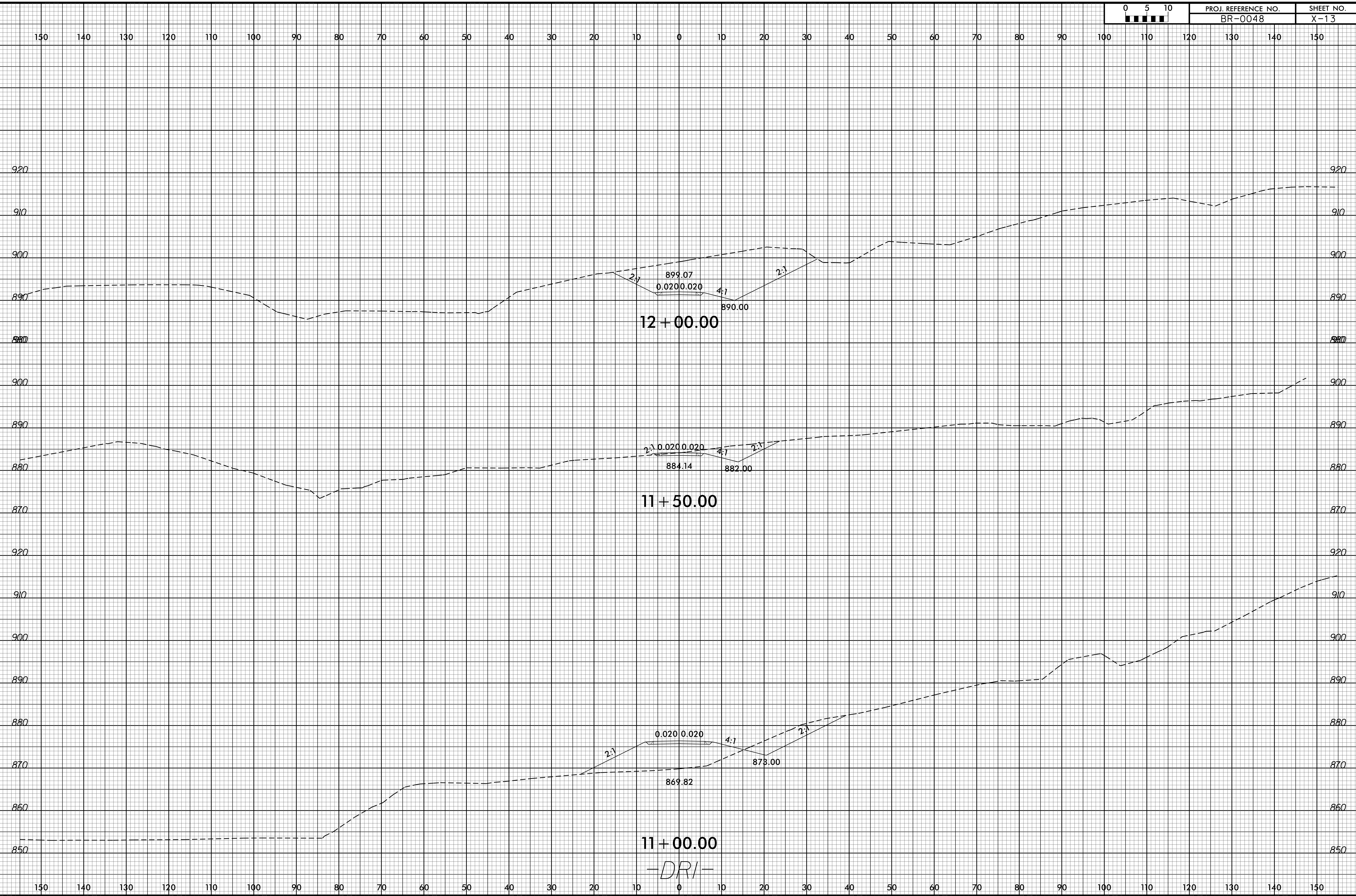

05-MAR-2021 14:22  
R:\Projects\BR0048\XSC\BR0048\_Rdy\_DRI\_xp.dgn  
\$\$\$\$USERNAME\$\$\$\$

6/23/16

0 5 10	PROJ. REFERENCE NO.	SHEET NO.
	BR-0048	X-14

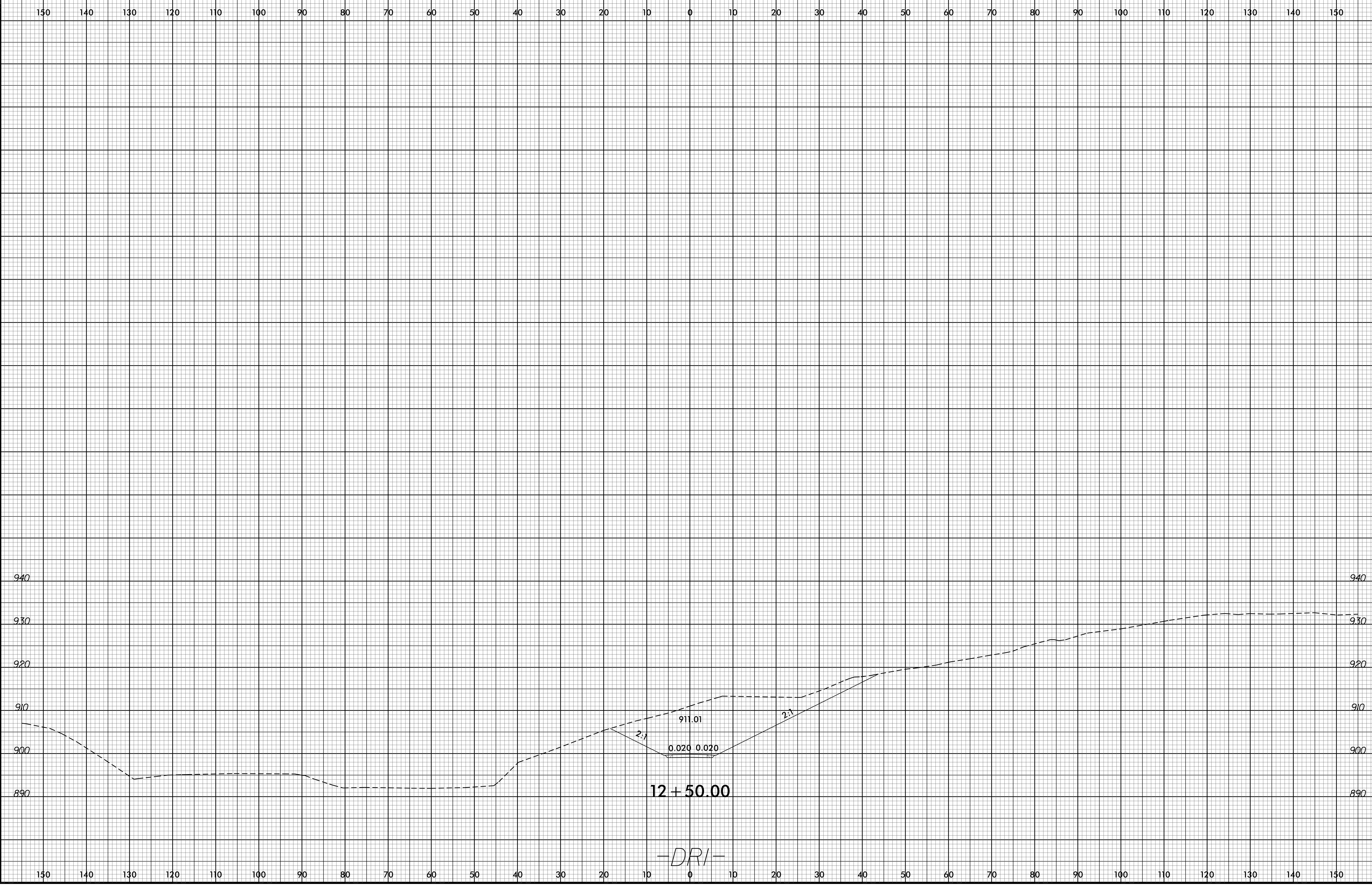

05-MAR-2021 14:22  
R:\Projects\BR-0048\X-14\X-14.dgn  
\$\$\$\$USERNAME\$\$\$\$

6/23/16

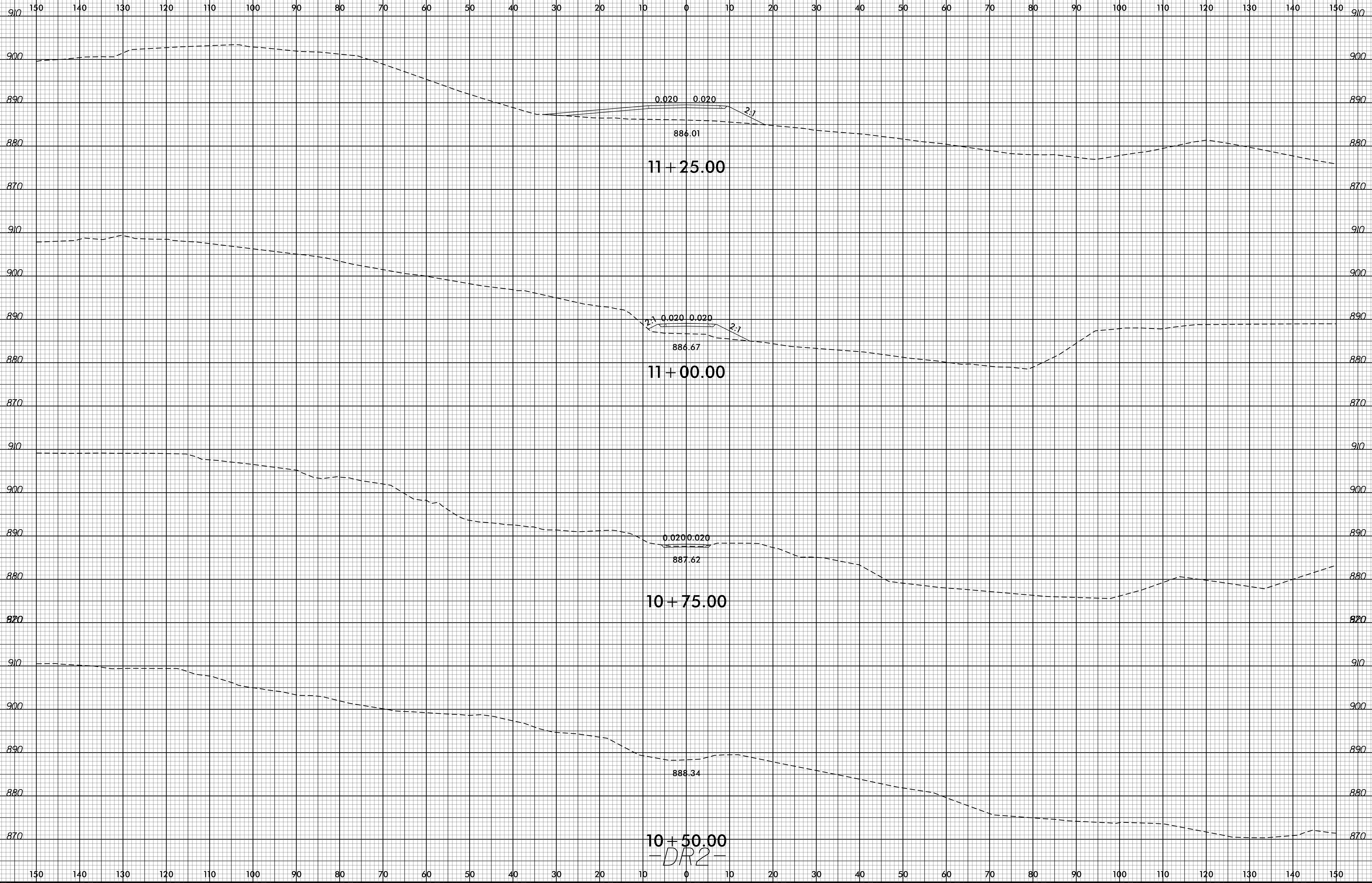

05-MAR-2021 14:25  
R:\Roadway\XSC\BR0048\_Rdy\_DR2\_xpl.dgn  
\$\$\$\$USERNAME\$\$\$\$

10+50.00  
-DR2-