

PART TYPICAL SECTION

(SHOWING BENT DIAPHRAGM)
(FOR CHANNEL DETAILS, SEE "STRUCTURAL STEEL" SHEET 2 OF 2)

PART TYPICAL SECTION

(SHOWING INTERMEDIATE DIAPHRAGM)
(FOR CHANNEL DETAILS, SEE "STRUCTURAL STEEL" SHEET 2 OF 2)

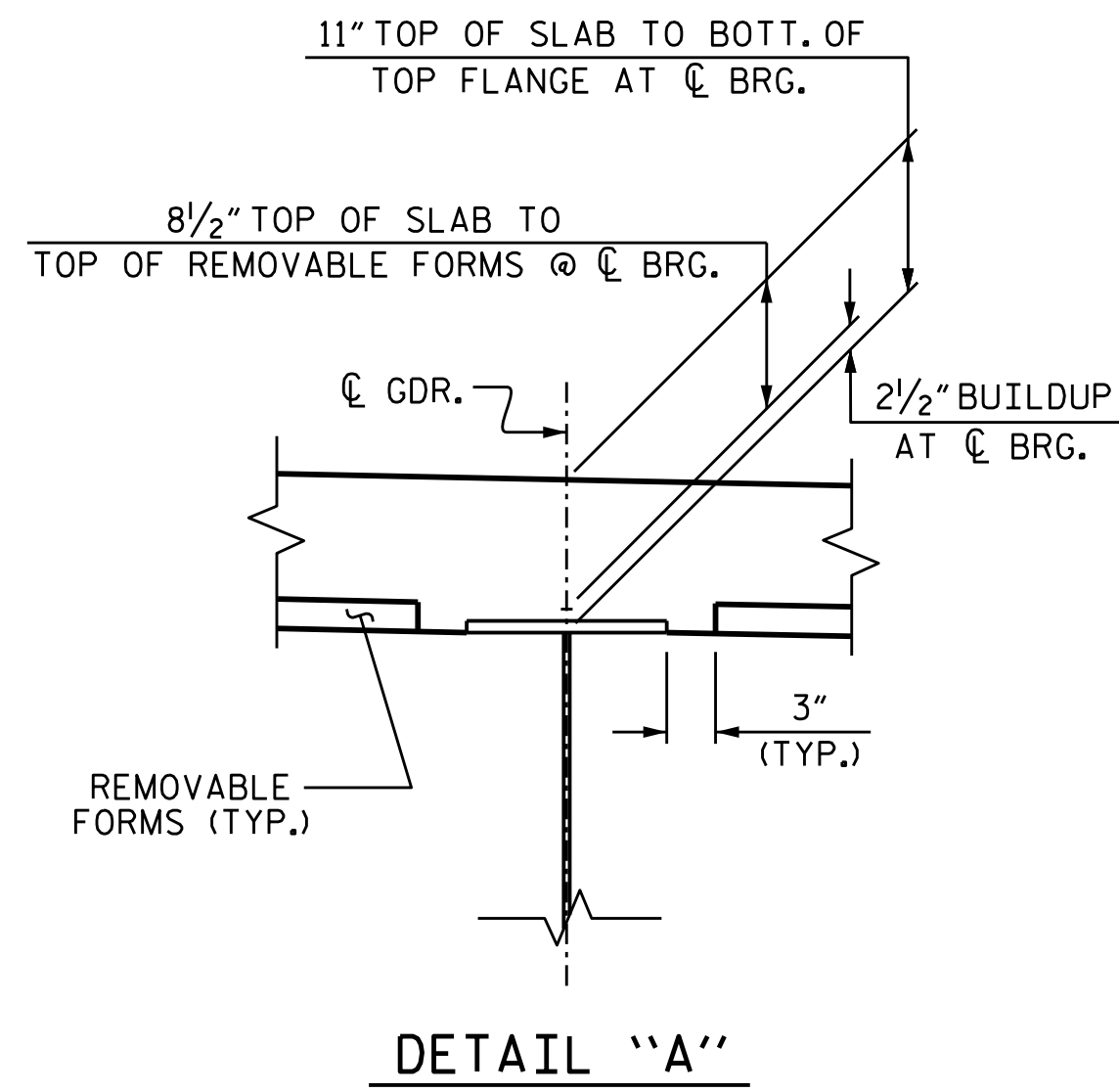

DETAIL "A"

NOTES

- CLASSIC CONCRETE BRIDGE RAIL SHALL NOT BE CAST UNTIL ALL SLAB CONCRETE HAS BEEN CAST AND HAS REACHED A MINIMUM COMPRESSIVE STRENGTH OF 3,000 PSI.
- NO CHAMFER IS REQUIRED ON CORNERS OF GIRDER BUILDUPS.
- ALL BAR SUPPORTS AND ALL INCIDENTAL REINFORCING STEEL SHALL BE EPOXY COATED IN ACCORDANCE WITH THE STANDARD SPECIFICATIONS.

PROJECT NO. 15BPR.56
BEAUFORT COUNTY
 BRIDGE NO. 060028

SHEET 1 OF 2

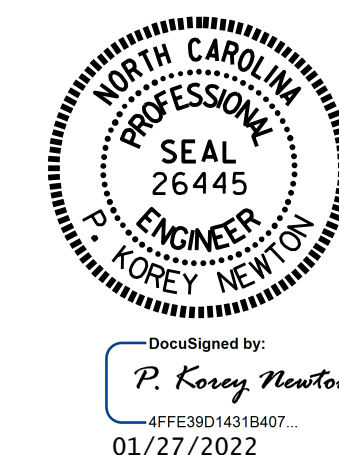

STATE OF NORTH CAROLINA
 DEPARTMENT OF TRANSPORTATION
 RALEIGH
 SUPERSTRUCTURE
 TYPICAL SECTION
 (SPAN 25)

DRAWN BY : M.K. BEARD DATE : 11/3/21
 CHECKED BY : O.T. NGUYEN DATE : 12/2021
 DESIGN ENGINEER OF RECORD: D. SHACKELFORD DATE : 12/2021

1/24/2022
 R:\Structures\Plans\Brdge.060028\403.135.15BPR56.SMU.TS1.068.060028.dgn
 pknewton

DOCUMENT NOT CONSIDERED
 FINAL UNLESS ALL
 SIGNATURES COMPLETED

REVISIONS						SHEET NO.
NO.	BY:	DATE:	NO.	BY:	DATE:	S3-68
1			3			TOTAL SHEETS
2			4			78