

TIP PROJECT: B-5770

See Sheet 1A For Index of Sheets

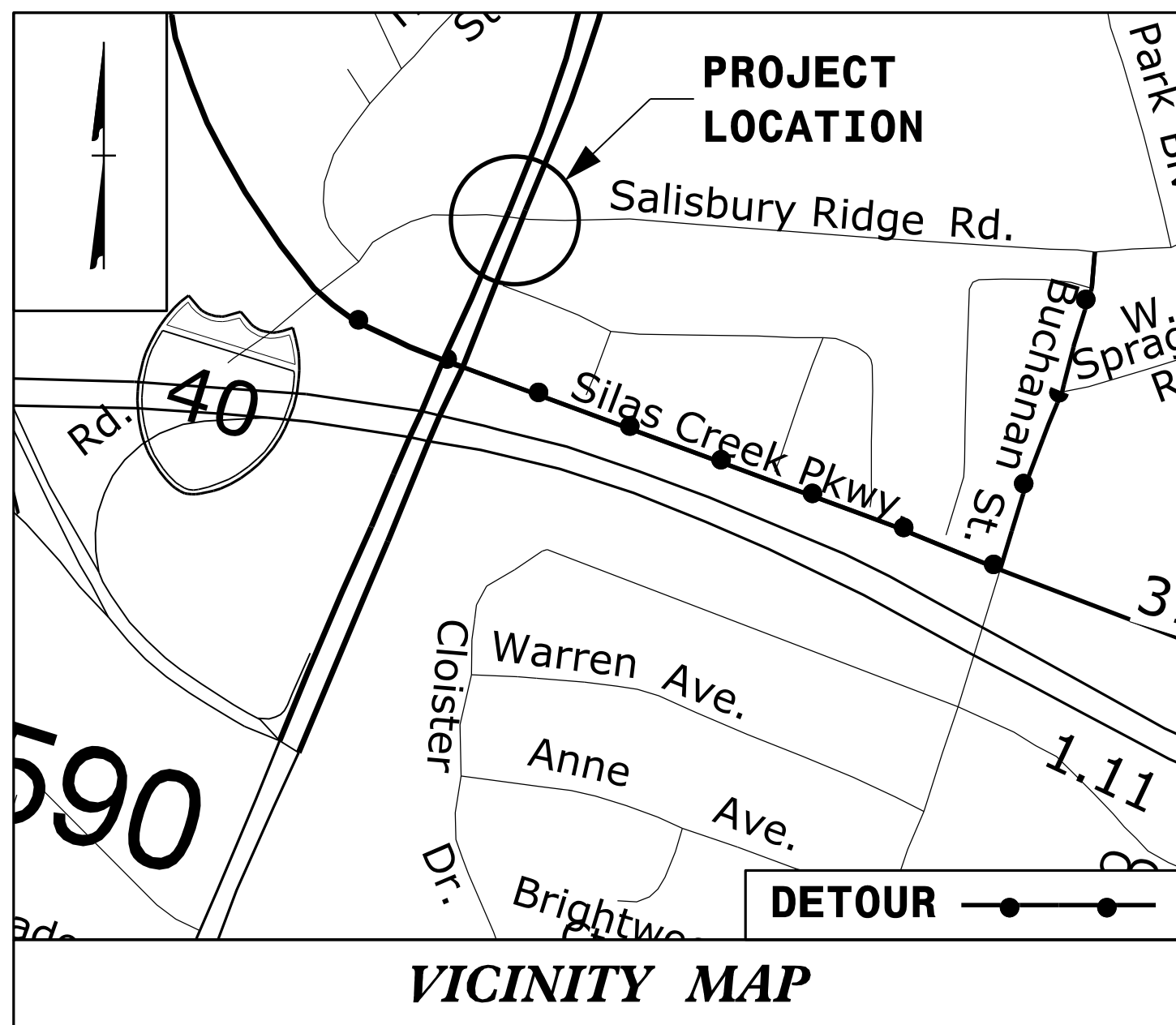

THIS PROJECT IS LOCATED WITHIN THE CITY LIMITS OF WINSTON-SALEM.

STATE OF NORTH CAROLINA DIVISION OF HIGHWAYS

PLAN FOR PROPOSED HIGHWAY EROSION CONTROL

FORSYTH COUNTY

**BRIDGE NO. 243 ON SALISBURY RIDGE RD.
OVER NC 150 (PETERS CREEK PARKWAY)**

TYPE OF WORK: GRADING, DRAINAGE, PAVING AND STRUCTURE

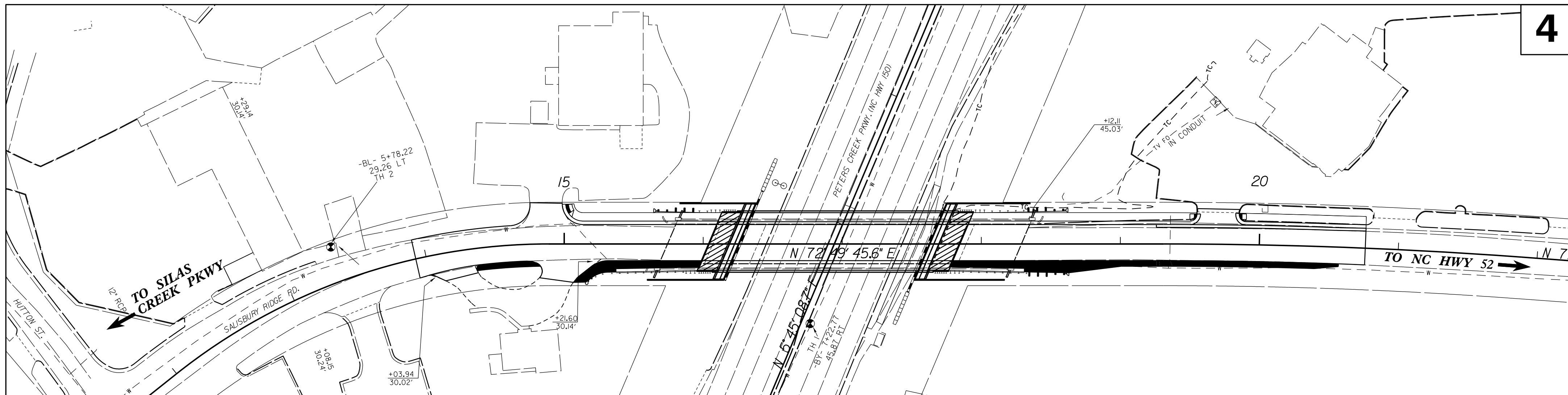

CLEARING ON THIS PROJECT SHALL BE PERFORMED TO THE LIMITS ESTABLISHED BY METHOD II.

STATE	STATE PROJECT REFERENCE NO.	SHEET NO.	TOTAL SHEETS
N.C.	B-5770	EC-1	
STATE PROJ. NO.	F.A. PROJ. NO.	DESCRIPTION	
45726.1.1	BRSTP-0918(98)	PE	
45726.2.1	BRSTP-0918(98)	ROW & UTIL.	
45726.3.1	BRSTP-0918(98)	CONST.	

EROSION AND SEDIMENT CONTROL MEASURES

Std. #	Description	Symbol
1630.05	Temporary Silt Ditch	
1630.05	Temporary Diversion	
1605.01	Temporary Silt Fence	
1606.01	Special Sediment Control Fence	
1622.01	Temporary Berms and Slope Drains	
1630.02	Silt Basin Type B	
1633.01	Temporary Rock Silt Check Type-A	
	Temporary Rock Silt Check Type-A with Matting and Polyacrylamide (PAM)	
1633.02	Temporary Rock Silt Check Type-B	
	Wattle / Coir Fiber Wattle	
	Wattle / Coir Fiber Wattle with Polyacrylamide (PAM)	
1654.01	Temporary Rock Sediment Dam Type-A	
1654.02	Temporary Rock Sediment Dam Type-B	
1655.01	Rock Pipe Inlet Sediment Trap Type-A	
1655.02	Rock Pipe Inlet Sediment Trap Type-B	
1650.04	Stilling Basin	
1630.06	Special Stilling Basin	
	Rock Inlet Sediment Trap:	
1632.01	Type A	
1632.02	Type B	
1632.05	Type C	
	Skimmer Basin	
	Tiered Skimmer Basin	
	Infiltration Basin	

**THIS PROJECT CONTAINS
EROSION CONTROL PLANS
FOR CLEARING AND
GRUBBING PHASE OF
CONSTRUCTION.**

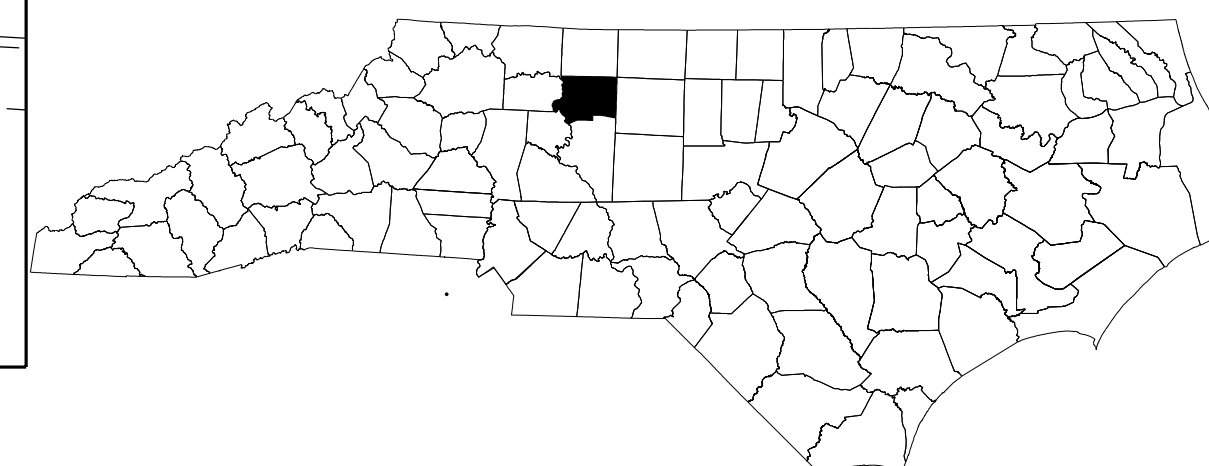

GRAPHIC SCALE

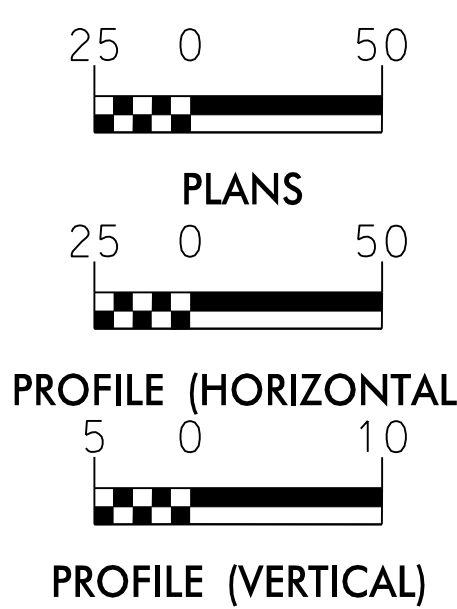

THESE EROSION AND SEDIMENT CONTROL PLANS COMPLY WITH THE APPLICABLE REGULATIONS SET FORTH BY THE NCG-010000 GENERAL CONSTRUCTION PERMIT EFFECTIVE APRIL 1, 2019 AND ISSUED BY THE NORTH CAROLINA DEPARTMENT OF ENVIRONMENT AND NATURAL RESOURCES DIVISION OF WATER RESOURCES.

Prepared In the Office of:



NC FIRM LICENSE No: C-1506
301 Fayetteville St.,
Suite 1500
Raleigh, NC 27601
(919) 882-7839

Designed by:

NELSON KING
NAME

4253
LEVEL III CERTIFICATION NO.

Reviewed In the Office of:

ROADSIDE ENVIRONMENTAL UNIT

1 South Wilmington St.
Raleigh, NC 27611

2018 STANDARD SPECIFICATIONS

Reviewed by:

Thomas A. Smith, CPESC

Roadway Standard Drawings

The following roadway english standards as appear in "Roadway Standard Drawings"- Roadway Design Unit - N. C. Department of Transportation - Raleigh, N. C., dated January 2018 and the latest revision thereto are applicable to this project and by reference hereby are considered a part of these plans.

1604.01 Railroad Erosion Control Detail	1632.01 Rock Inlet Sediment Trap Type A
1605.01 Temporary Silt Fence	1632.02 Rock Inlet Sediment Trap Type B
1606.01 Special Sediment Control Fence	1632.03 Rock Inlet Sediment Trap Type C
1607.01 Gravel Construction Entrance	1633.01 Temporary Rock Silt Check Type A
1622.01 Temporary Berms and Slope Drains	1633.02 Temporary Rock Silt Check Type B
1630.01 Riser Basin	1634.01 Temporary Rock Sediment Dam Type A
1630.02 Silt Basin Type B	1634.02 Temporary Rock Sediment Dam Type B
1630.03 Temporary Silt Ditch	1635.01 Rock Pipe Inlet Sediment Trap Type A
1630.04 Stilling Basin	1635.02 Rock Pipe Inlet Sediment Trap Type B
1630.05 Temporary Diversion	1640.01 Coir Fiber Baffle
1630.06 Special Stilling Basin	1645.01 Temporary Stream Crossing
1631.01 Matting Installation	

7/2/99

DIVISION OF HIGHWAYS
STATE OF NORTH CAROLINA

PROJECT REFERENCE NO. <i>B-5770</i>	SHEET NO. <i>EC-2</i>
ROADWAY DESIGN ENGINEER	HYDRAULICS ENGINEER

SOIL STABILIZATION TIMEFRAMES

<i>SITE DESCRIPTION</i>	<i>STABILIZATION TIME</i>	<i>TIMEFRAME EXCEPTIONS</i>
PERIMETER DIKES, SWALES, DITCHES AND SLOPES	7 DAYS	NONE
HIGH QUALITY WATER (HQW) ZONES	7 DAYS	NONE
SLOPES STEEPER THAN 3:1	7 DAYS	IF SLOPES ARE 10' OR LESS IN LENGTH AND ARE NOT STEEPER THAN 2:1, 14 DAYS ARE ALLOWED.
SLOPES 3:1 OR FLATTER	14 DAYS	7 DAYS FOR SLOPES GREATER THAN 50' IN LENGTH.
ALL OTHER AREAS WITH SLOPES FLATTER THAN 4:1	14 DAYS	NONE, EXCEPT FOR PERIMETERS AND HQW ZONES.

NELSON KING
EROSION CONTROL
LEVEL III
CERTIFICATION #4253

DOCUMENT NOT CONSIDERED FINAL
UNLESS ALL SIGNATURES COMPLETED

PREPARED IN THE OFFICE OF: **KCA**
KISINGER CAMPO & ASSOCIATES
NC FIRM LICENSE NO. C-1508
301 Fayetteville Street, Suite 1500
Raleigh, NC 27601
(919)862-7839

-L-	-Y-	-Y-
PI Sta 13+49.84	PI Sta 20+59.95	PI Sta 15+28.63
$\Delta = 38' 32" 10.6"$ (RT)	$\Delta = 4' 12" 44.1"$ (RT)	$\Delta = 2' 44" 37.0"$ (LT)
$D = 13' 19" 28.6"$	$D = 1' 38' 13.3"$	$D = 1' 38' 13.3"$
$L = 289.21'$	$L = 257.31'$	$L = 167.60'$
$T = 150.32'$	$T = 128.71'$	$T = 83.81'$
$R = 430.00'$	$R = 3,500.00'$	$R = 3,500.00'$
SE = MATCH EXISTING	SE = MATCH EXISTING	
LT = 100'	LT = 100'	

FOR L-PROFILE, SEE SHEET 5

CLEARING AND GRUBBING
EROSION CONTROL FOR
CONSTRUCTION SHEET 4

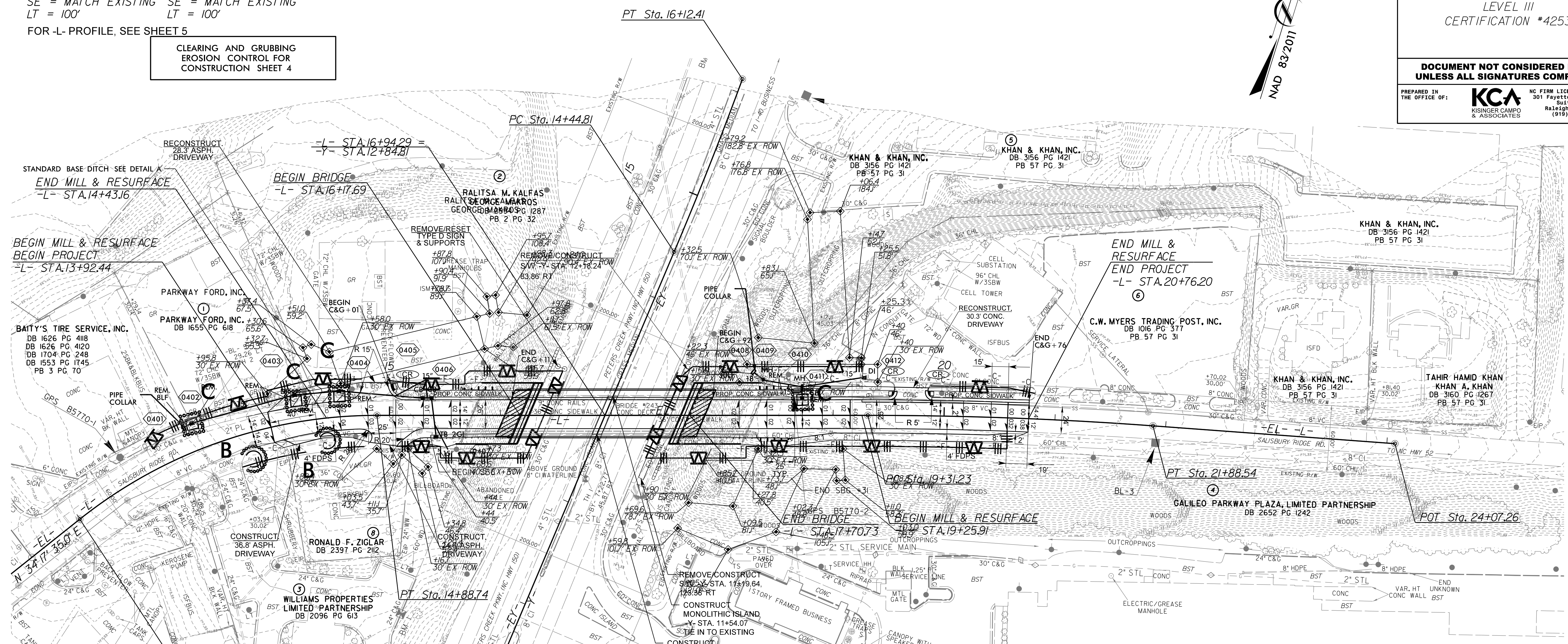
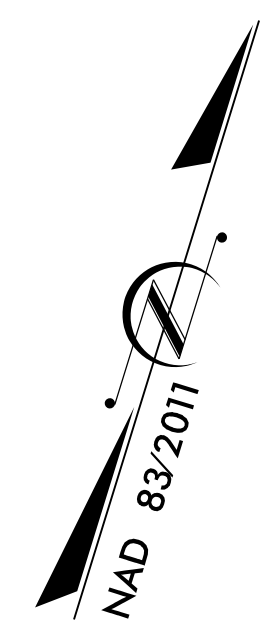

BEGIN MILL & RESURFACE
BEGIN PROJECT
-L- STA.13+92.44

BEGIN BRIDGE
-L- STA.16+17.69

END MILL & RESURFACE
END PROJECT
-L- STA.20+76.20

NOTE: ALL STRUCTURES AND PIPES NOT LABELED "REM." (REMOVE) IN THE PLANS SHALL BE RETAINED.
BASED ON FIELD REVIEW, ALL EXISTING PIPES TO BE RETAINED APPEAR TO BE IN SUFFICIENT WORKING CONDITION.
NOTE: ALL CURB RAMP ARE TYPE 1 MODIFIED

*FABRIC INSERT INLET PROTECTION DEVICES
MAY BE USED ALONG PETERS CREEK PARKWAY,
HWY 150, AS NEEDED

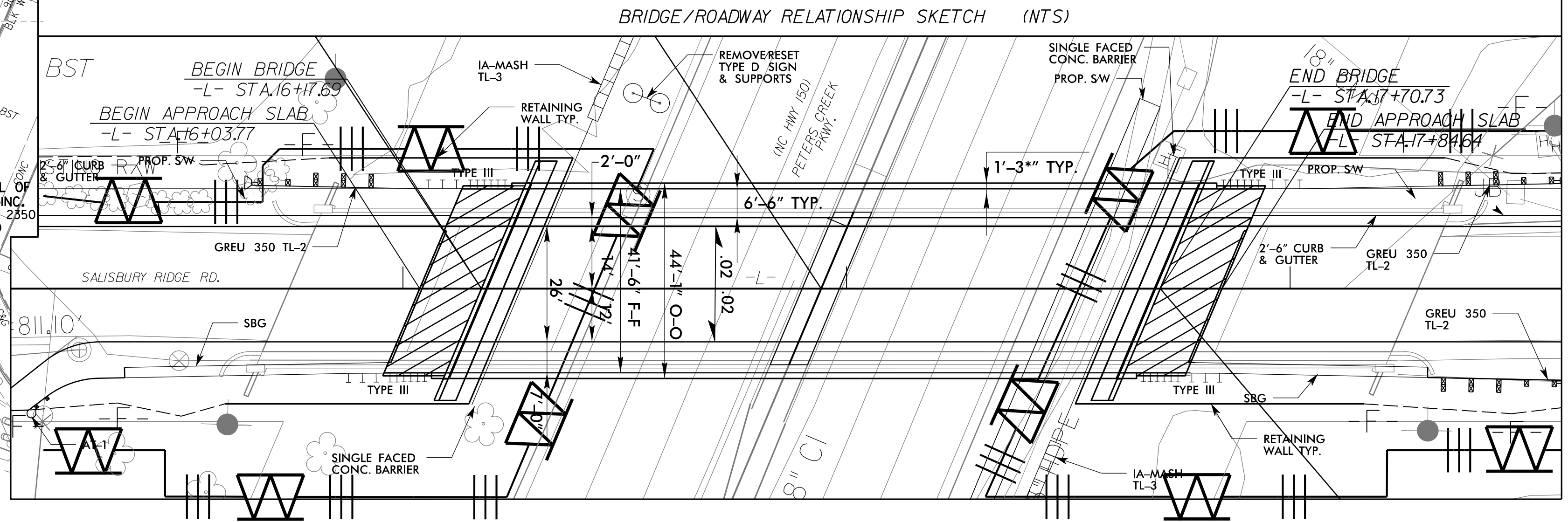
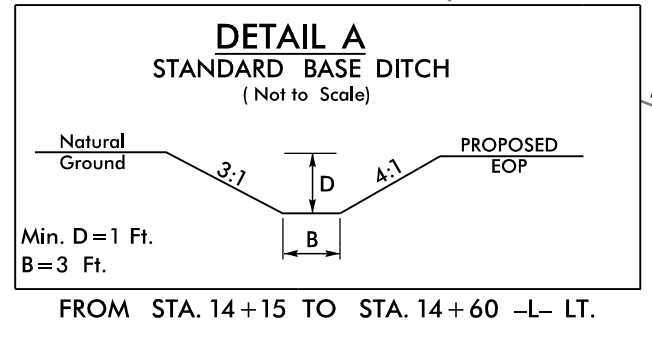

REVISIONS

8/17/99
04-DEC-2020, It40
G:\420172020\B-5770\Hydraulics\CADD\Erosion Control\B-5770_EC_psh_C&G.dgn
KCA0773

NELSON KING
EROSION CONTROL
LEVEL III
CERTIFICATION #4253

**DOCUMENT NOT CONSIDERED FINAL
UNLESS ALL SIGNATURES COMPLETED**

PREPARED IN THE OFFICE OF:
KCA
KISINGER CAMPO & ASSOCIATES
NC FIRM LICENSE NO. C-1508
301 Fayetteville Street, Suite 1500
Raleigh, NC 27601
(919)862-7839

-L-	-Y-	-Y-
PI Sta 13+49.84	PI Sta 20+59.95	PI Sta 15+28.63
$\Delta = 38' 32" 10.6"$ (RT)	$\Delta = 4' 12" 44.1"$ (RT)	$\Delta = 2' 44" 37.0"$ (LT)
$D = 13' 19" 28.6"$	$D = 1' 38' 13.3"$	$D = 1' 38' 13.3"$
$L = 289.21'$	$L = 257.31'$	$L = 167.60'$
$T = 150.32'$	$T = 128.71'$	$T = 83.81'$
$R = 430.00'$	$R = 3,500.00'$	$R = 3,500.00'$
SE = MATCH EXISTING	SE = MATCH EXISTING	
LT = 100'	LT = 100'	

FOR L-PROFILE, SEE SHEET 5

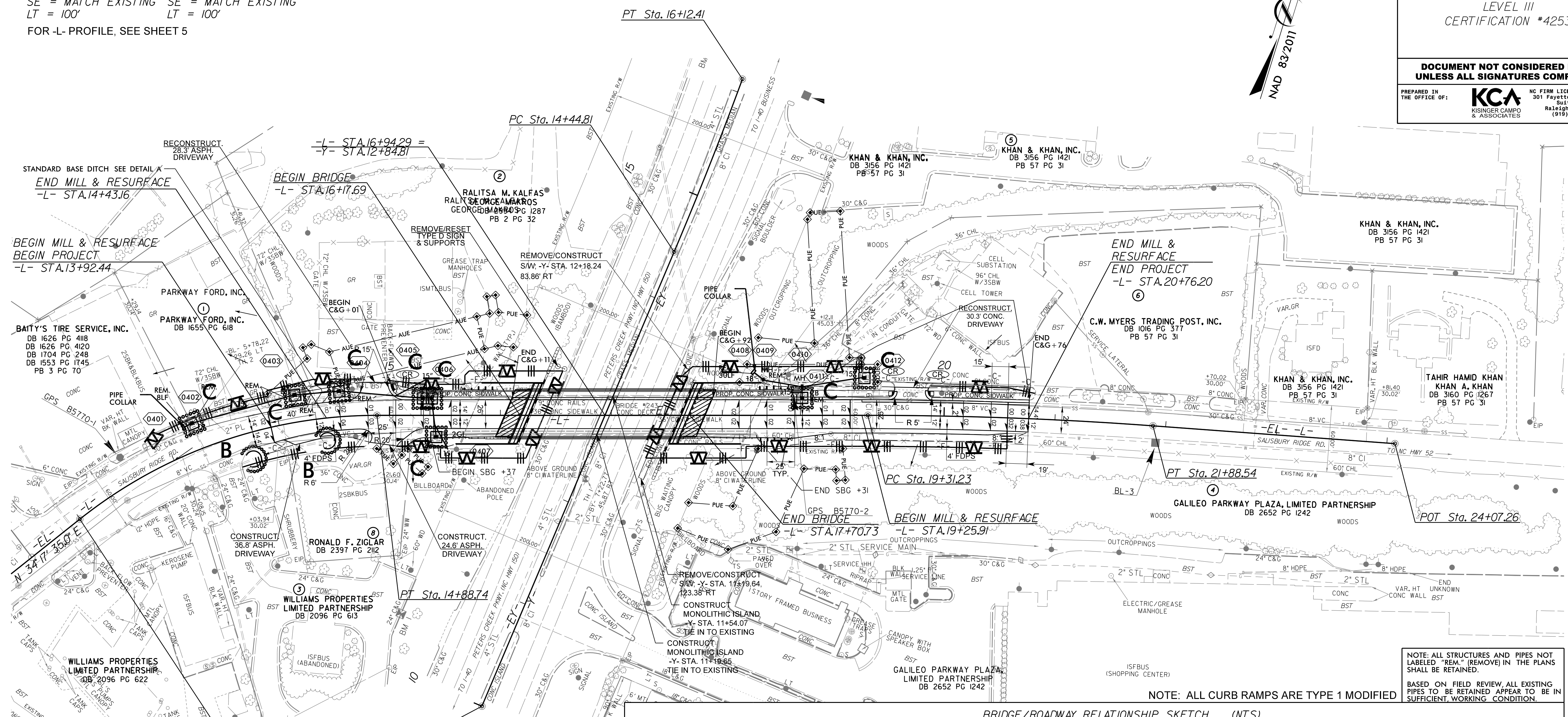
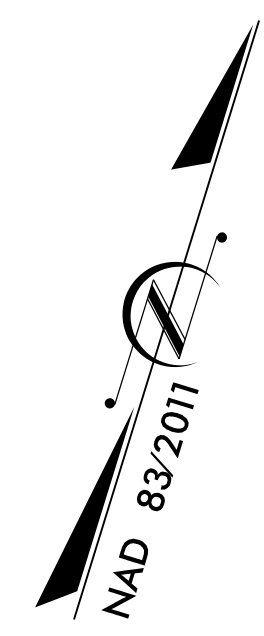

NOTE: ALL STRUCTURES AND PIPES NOT LABELED "REM." (REMOVE) IN THE PLANS SHALL BE RETAINED.
BASED ON FIELD REVIEW, ALL EXISTING PIPES TO BE RETAINED APPEAR TO BE IN SUFFICIENT WORKING CONDITION.

NOTE: ALL CURB RAMP ARE TYPE 1 MODIFIED

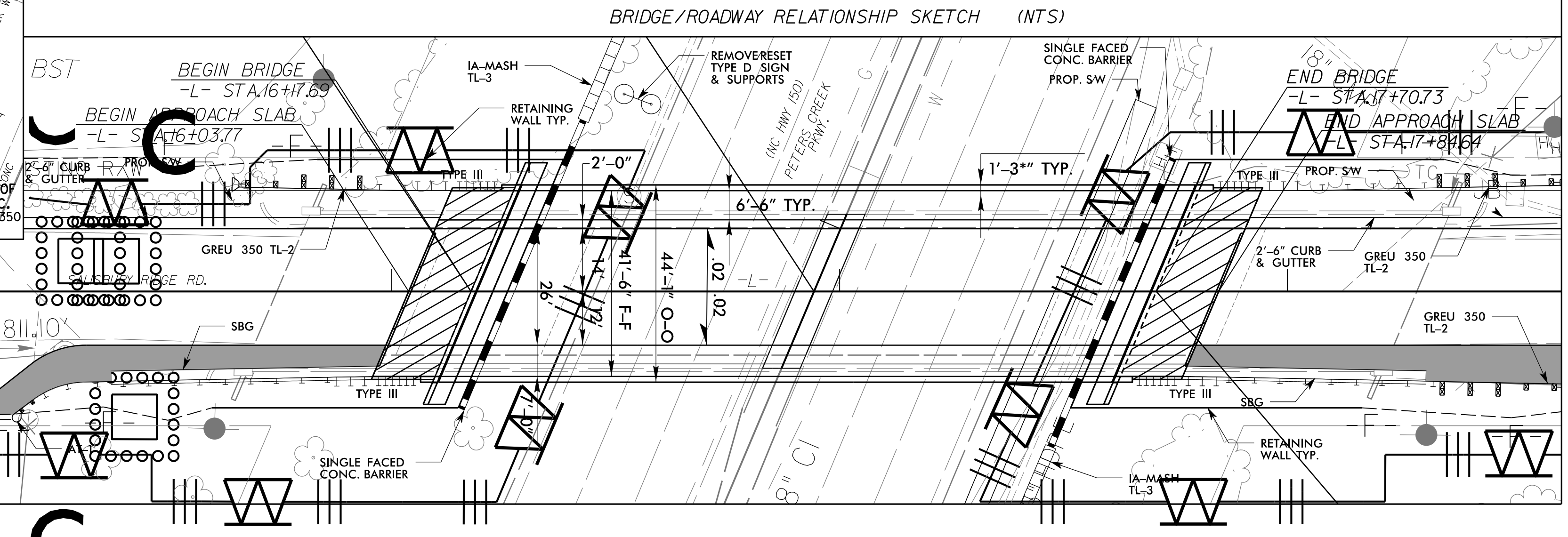

***FABRIC INSERT INLET PROTECTION DEVICES
MAY BE USED ALONG PETERS CREEK PARKWAY,
HWY 150, AS NEEDED**

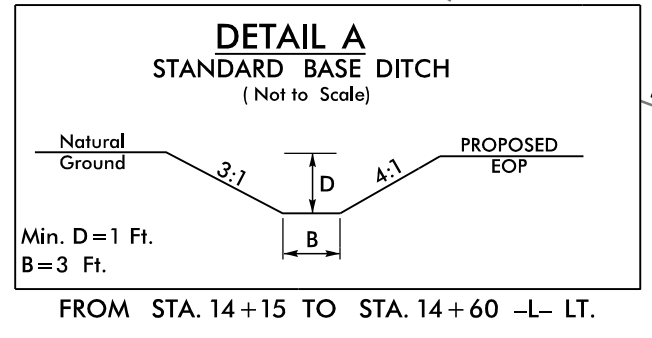

REVISIONS

8/17/99
 04-DEC-2020, llt41
 G:\4201720208-B-5770\Hydraulics\CADD\Erosion Control\B-5770-EC_psh_Final.dgn
 KCA0773