

**This electronic collection of documents is provided  
for the convenience of the user  
and is Not a Certified Document –**

**The documents contained herein were originally issued  
and sealed by the individuals whose names and license  
numbers appear on each page, on the dates appearing  
with their signature on that page.**

**This file or an individual page  
shall not be considered a certified document.**





6/23/16

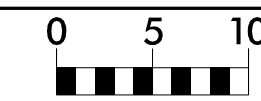

PROJ. REFERENCE NO.	SHEET NO.
B-5728	X-1

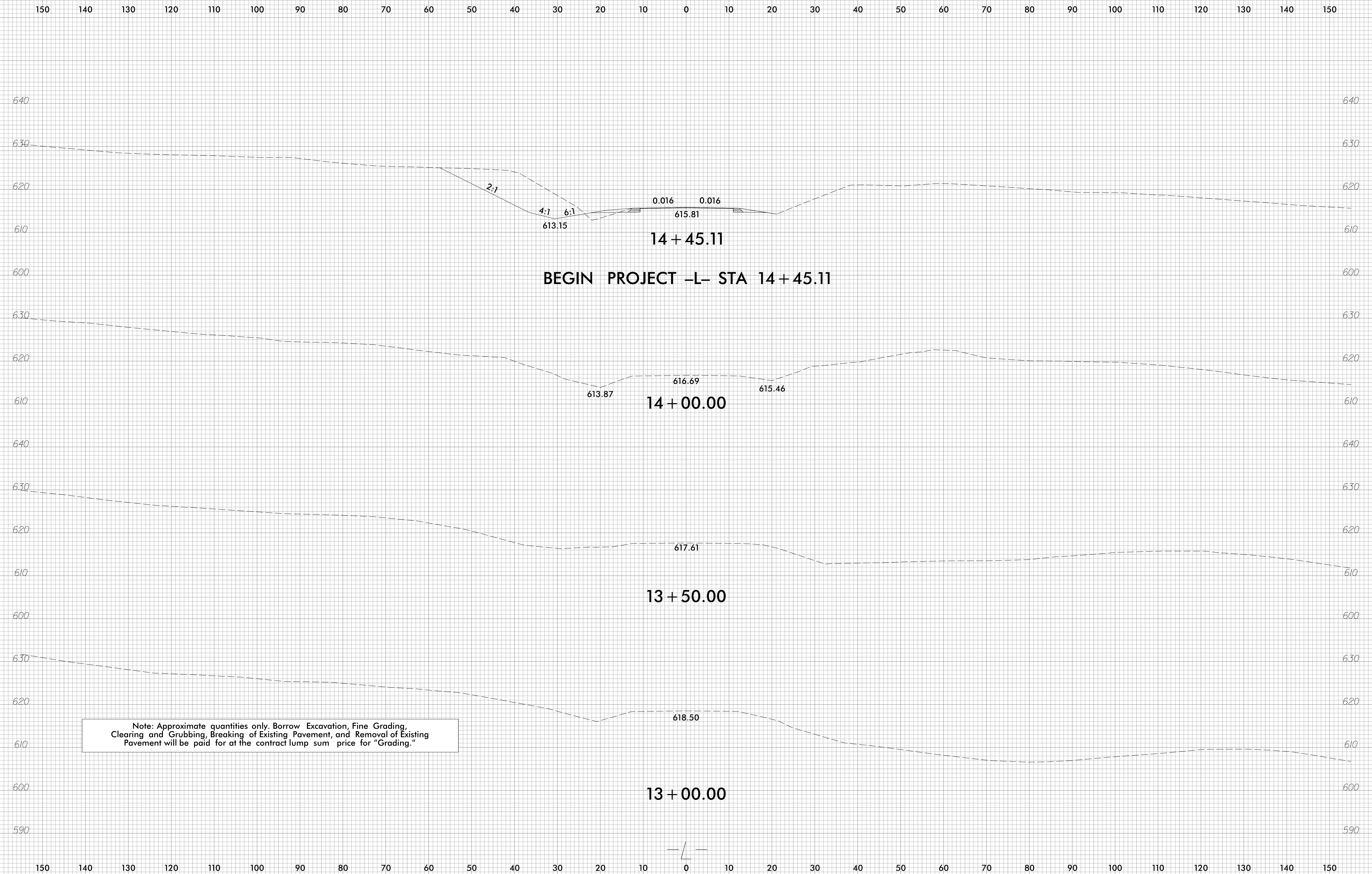

Note: Approximate quantities only. Borrow Excavation, Fine Grading, Clearing and Grubbing, Breaking of Existing Pavement, and Removal of Existing Pavement will be paid for at the contract lump sum price for "Grading."

I:\4\2021\0\1\10011-10\B5728\Roadway\XSC\B5728\_XPL\_L.dgn  
 gncdlin

6/23/16

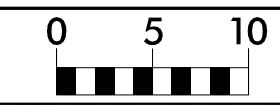

PROJ. REFERENCE NO.  
B-5728

SHEET NO.  
X-2

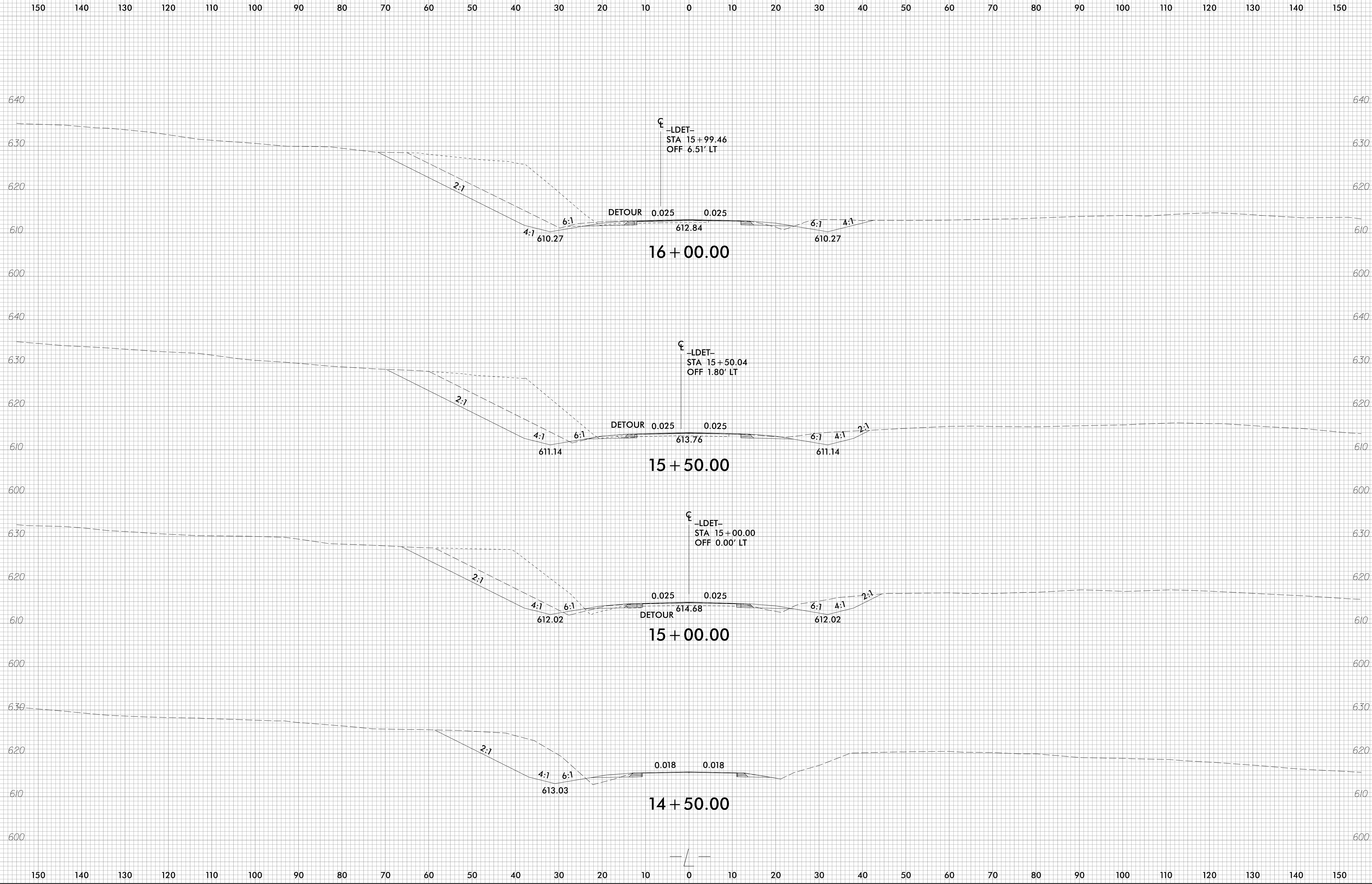

11/4/2021  
G:\RA\10011-10\B5728\Roadway\XSC\B5728\_XPL\_L.dgn  
gncdlin

6/23/16

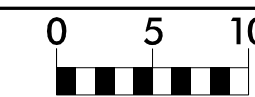

PROJ. REFERENCE NO.  
B-5728

SHEET NO.  
X-3

150 140 130 120 110 100 90 80 70 60 50 40 30 20 10 0 10 20 30 40 50 60 70 80 90 100 110 120 130 140 150

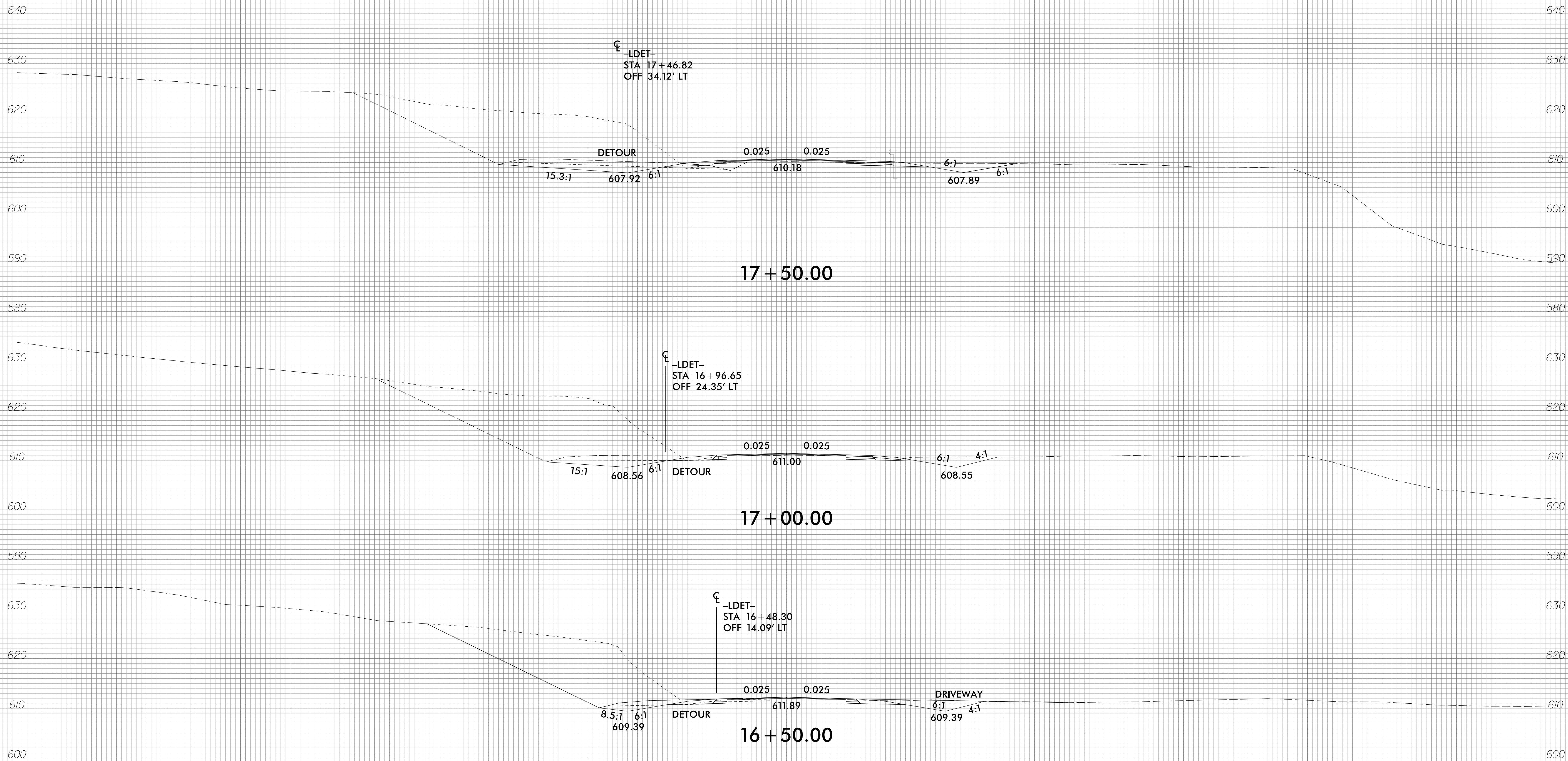

11/4/2021  
G:\RA\10011-10\B5728\Roadway\XSC\B5728\_XPL\_L.dgn  
gmodlin

150 140 130 120 110 100 90 80 70 60 50 40 30 20 10 0 10 20 30 40 50 60 70 80 90 100 110 120 130 140 150

6/23/16

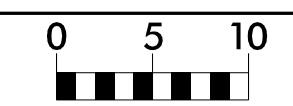

PROJ. REFERENCE NO.	SHEET NO.
B-5728	X-4

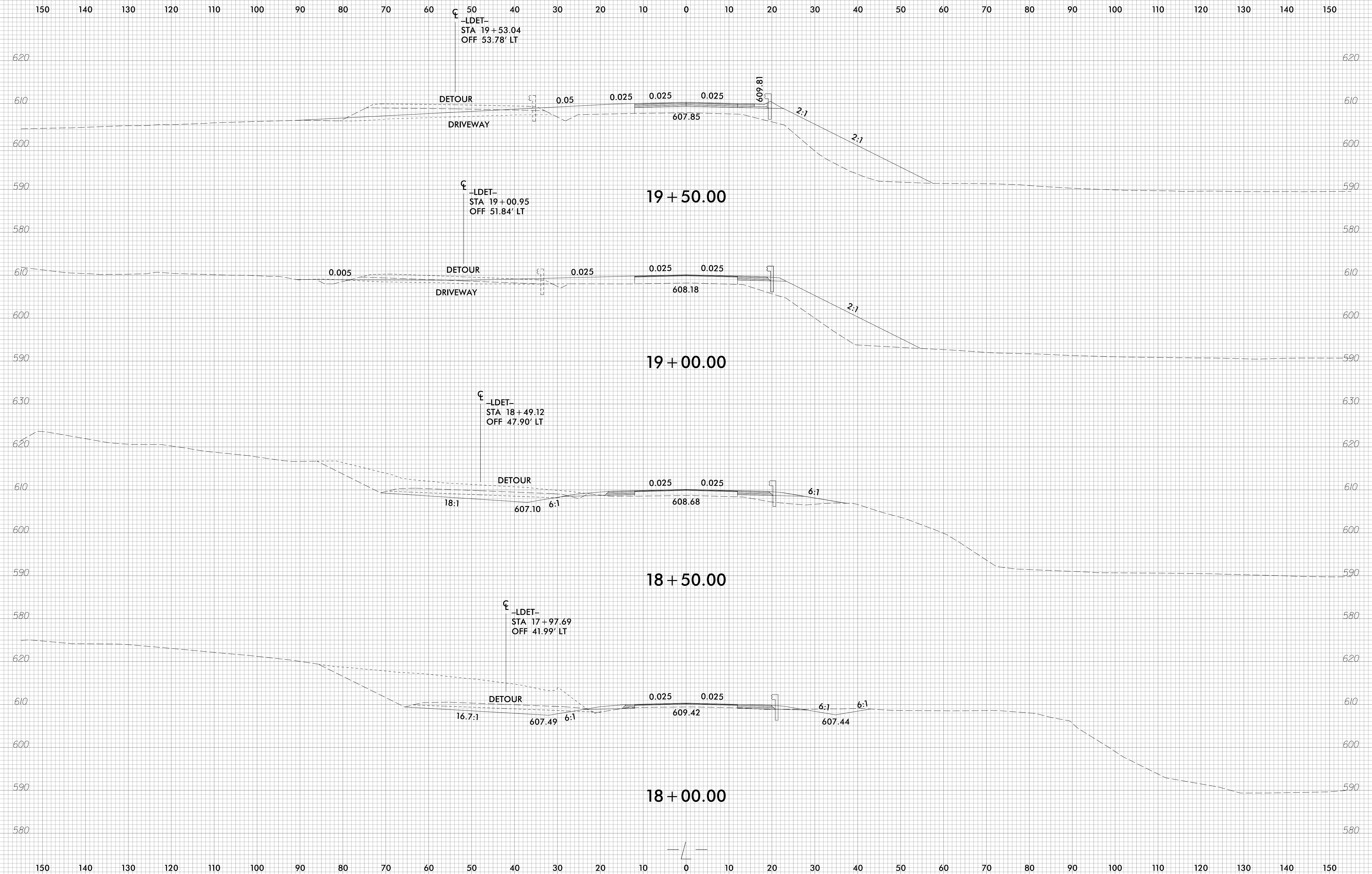

I:\4\2021  
 G:\RA\10011-10\B5728\Roadway\XSC\B5728\_XPL\_L.dgn  
 gmodlin

150 140 130 120 110 100 90 80 70 60 50 40 30 20 10 0 10 20 30 40 50 60 70 80 90 100 110 120 130 140 150

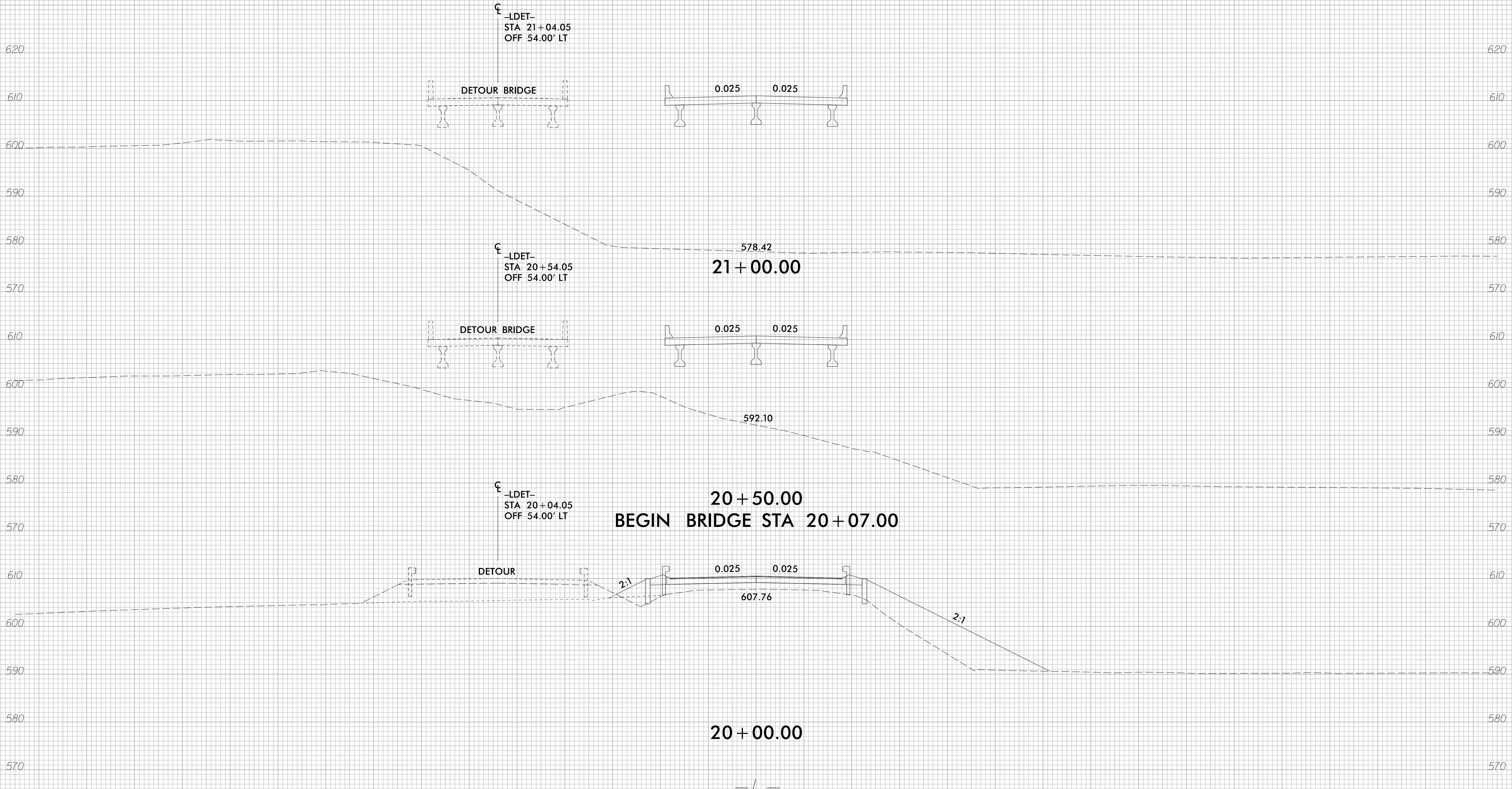

150 140 130 120 110 100 90 80 70 60 50 40 30 20 10 0 10 20 30 40 50 60 70 80 90 100 110 120 130 140 150



6/23/16

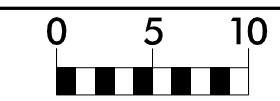

PROJ. REFERENCE NO.  
B-5728

SHEET NO.  
X-6

150 140 130 120 110 100 90 80 70 60 50 40 30 20 10 0 10 20 30 40 50 60 70 80 90 100 110 120 130 140 150

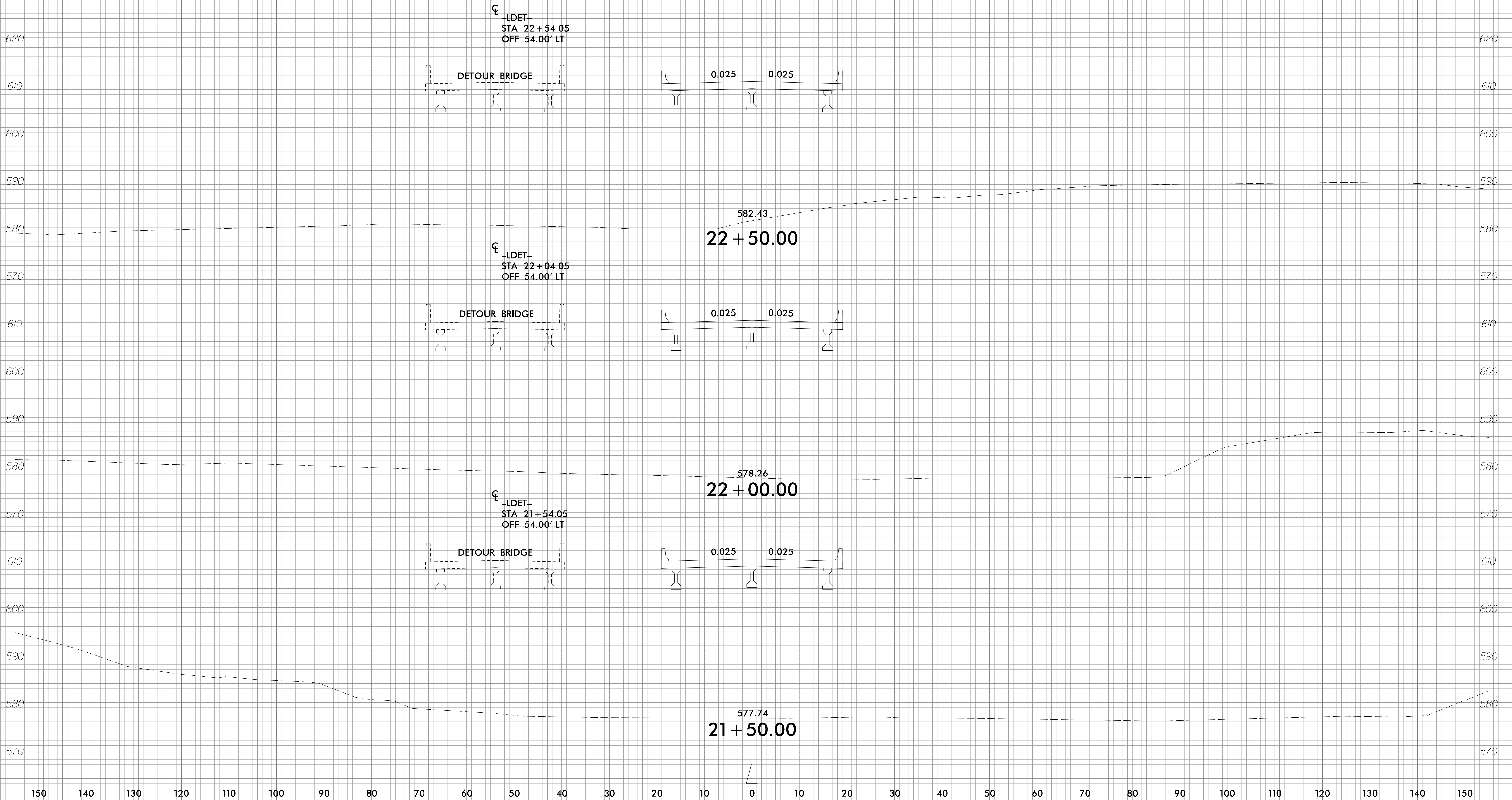

11/4/2021  
G:\RA\10011-10\B5728\Roadway\XSC\B5728\_XPL\_L.dgn  
gmodlin

150 140 130 120 110 100 90 80 70 60 50 40 30 20 10 0 10 20 30 40 50 60 70 80 90 100 110 120 130 140 150

6/23/16

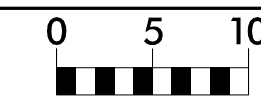

PROJ. REFERENCE NO.  
B-5728

SHEET NO.  
X-7

150 140 130 120 110 100 90 80 70 60 50 40 30 20 10 0 10 20 30 40 50 60 70 80 90 100 110 120 130 140 150

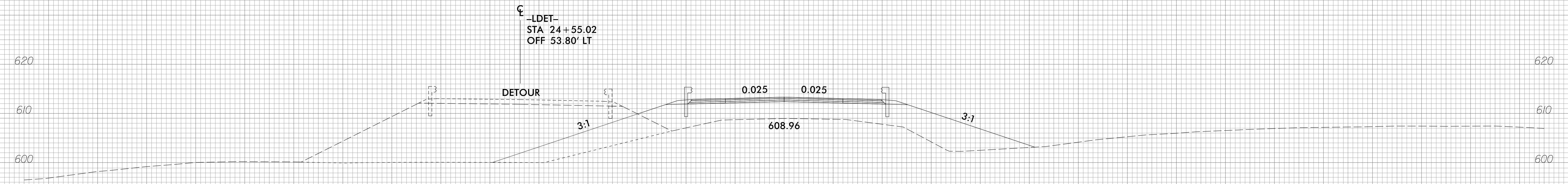

24 + 50.00

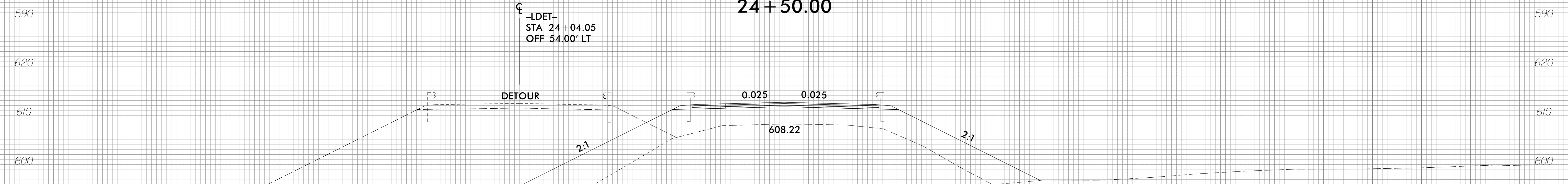

24 + 00.00

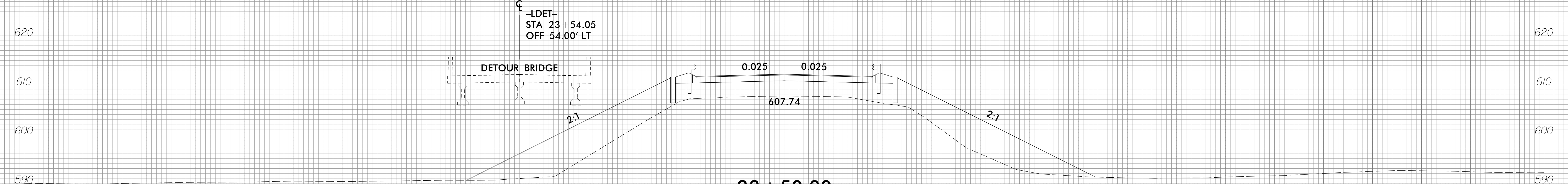

23 + 50.00

END BRIDGE STA 23 + 47.00

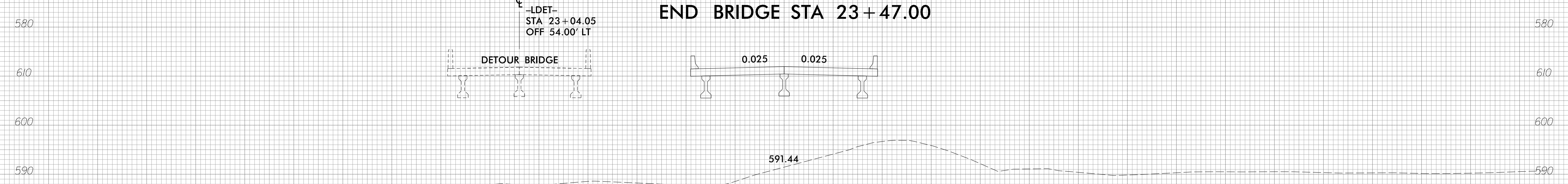

23 + 00.00

150 140 130 120 110 100 90 80 70 60 50 40 30 20 10 0 10 20 30 40 50 60 70 80 90 100 110 120 130 140 150

I:\4\2021\04\10011-10\B5728\Roadway\XSC\B5728\_XPL\_L.dgn  
gmodlin

6/23/16

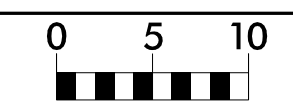

PROJ. REFERENCE NO.	SHEET NO.
B-5728	X-8

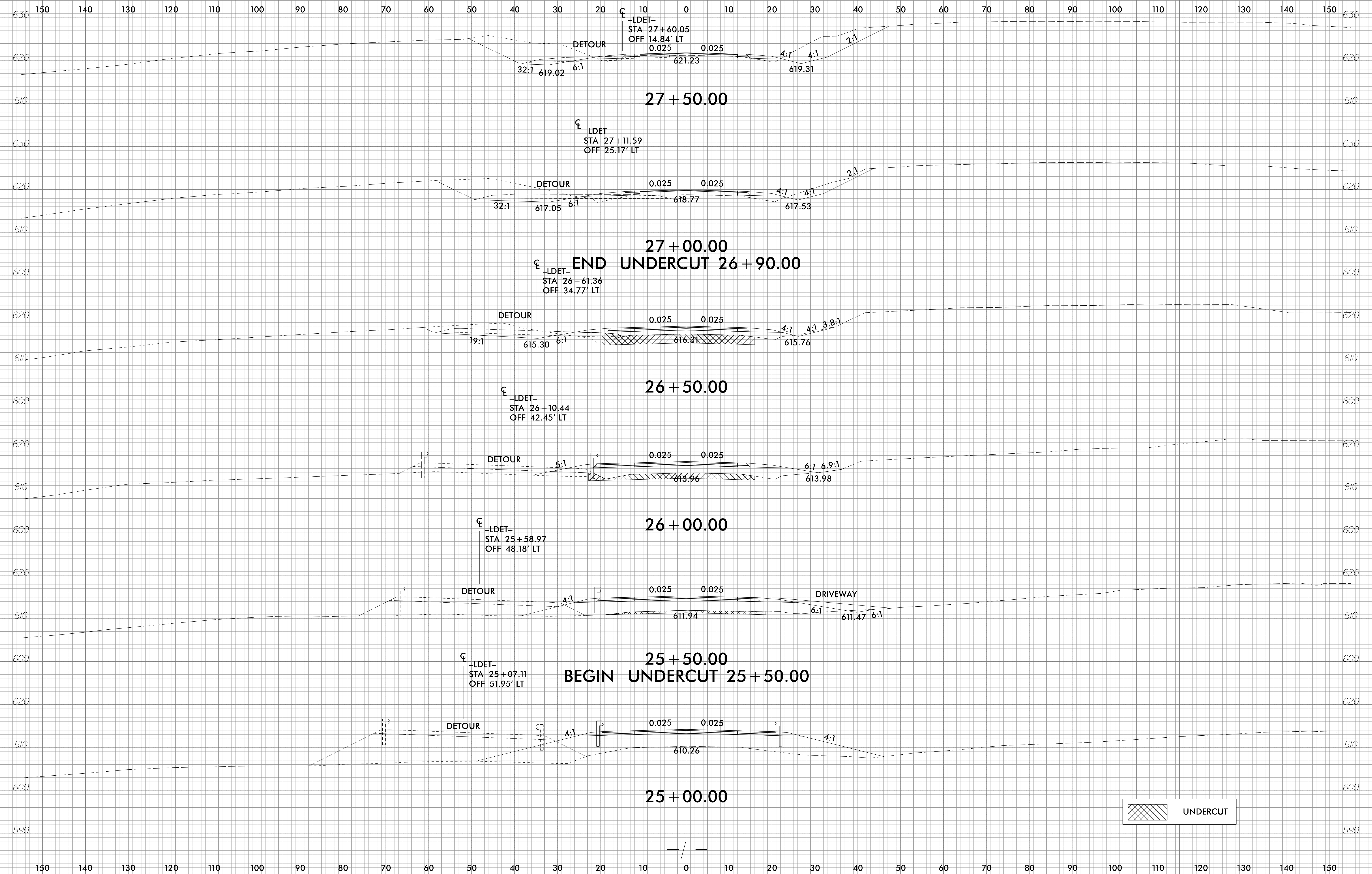

I:\4\2021\01\10\B5728\Roadway\XSC\B5728\_XPL\_L.dgn

6/23/16

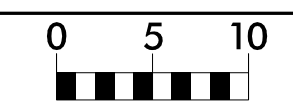

PROJ. REFERENCE NO.	SHEET NO.
B-5728	X-9

150 140 130 120 110 100 90 80 70 60 50 40 30 20 10 0 10 20 30 40 50 60 70 80 90 100 110 120 130 140 150

END PROJECT -L- STA 29+67.69

29+67.69

29+50.00

29+00.00

28+50.00

28+00.00

€ -LDET-  
STA 29+08.22  
OFF 0.14' LT

€ -LDET-  
STA 28+58.33  
OFF 2.21' LT

€ -LDET-  
STA 28+08.83  
OFF 7.09' LT

DETOUR

DETOUR

DETOUR

2:1

4:1

6:1

0.018

0.013

4:1

2:1

2:1

4:1

6:1

0.025

0.020

4:1

4:1

2:1

2:1

4:1

6:1

0.025

0.025

4:1

4:1

2:1

2:1

4:1

6:1

0.025

0.025

4:1

4:1

2:1

2:1

4:1

6:1

0.025

0.025

4:1

4:1

2:1

627.05

628.59

631.29

626.42

627.80

630.62

624.64

624.76

628.50

622.87

623.53

626.15

621.09

621.19

623.69

I:\4\2021\0\1\10011-10\B5728\Roadway\XSC\B5728\_XPL\_L.dgn

150 140 130 120 110 100 90 80 70 60 50 40 30 20 10 0 10 20 30 40 50 60 70 80 90 100 110 120 130 140 150



150 140 130 120 110 100 90 80 70 60 50 40 30 20 10 0 10 20 30 40 50 60 70 80 90 100 110 120 130 140 150

6/23/16

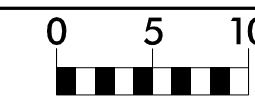

PROJ. REFERENCE NO.	SHEET NO.
B-5728	X-11

150 140 130 120 110 100 90 80 70 60 50 40 30 20 10 0 10 20 30 40 50 60 70 80 90 100 110 120 130 140 150

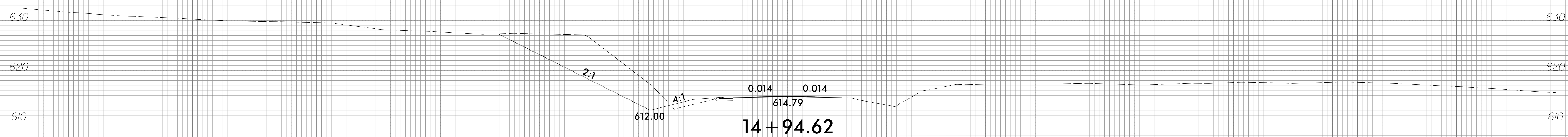
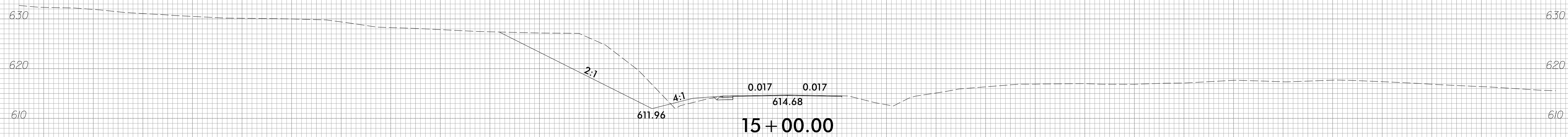

**BEGIN DETOUR -LDET- STA 14+94.62**

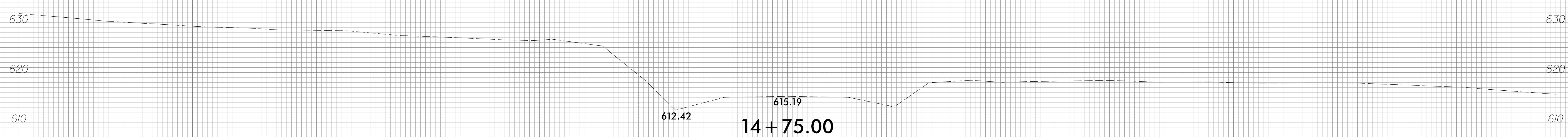

*-LDET-*

150 140 130 120 110 100 90 80 70 60 50 40 30 20 10 0 10 20 30 40 50 60 70 80 90 100 110 120 130 140 150

I:\4\2021\04\10011-10\B5728\Roadway\XSC\B5728\_XPL\_LDET.dgn  
gmodlin

150 140 130 120 110 100 90 80 70 60 50 40 30 20 10 0 10 20 30 40 50 60 70 80 90 100 110 120 130 140 150

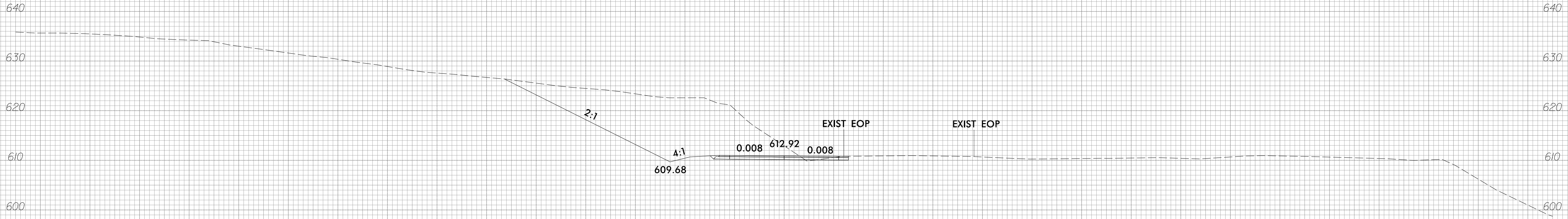

17 + 00.00

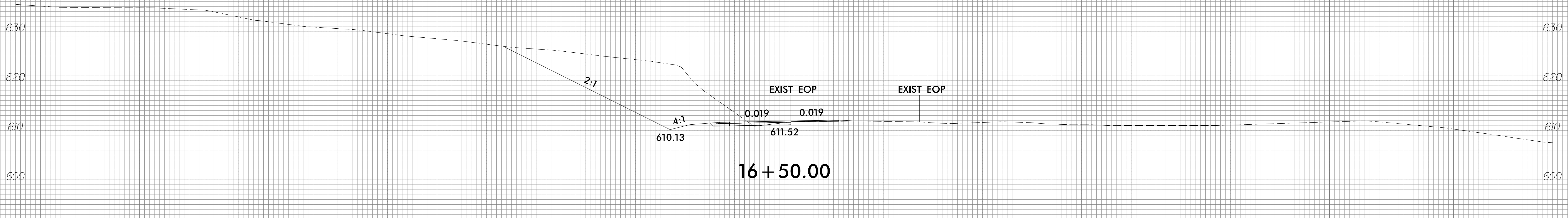

16 + 50.00

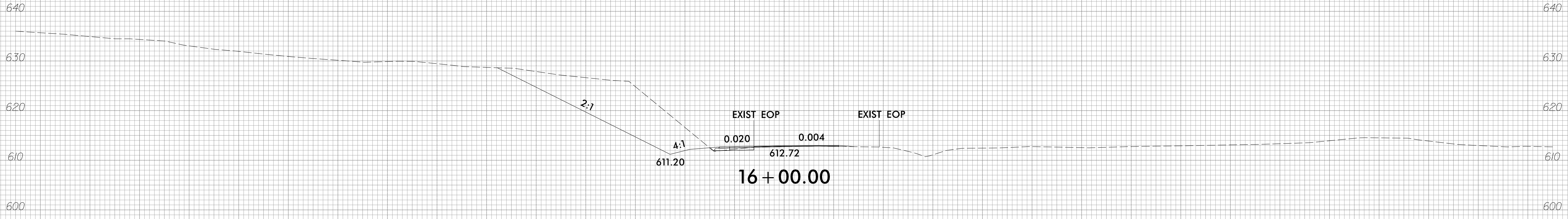

16 + 00.00

-LDET-

150 140 130 120 110 100 90 80 70 60 50 40 30 20 10 0 10 20 30 40 50 60 70 80 90 100 110 120 130 140 150

6/23/16

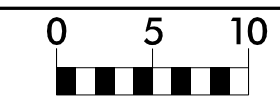

PROJ. REFERENCE NO.	SHEET NO.
B-5728	X-13

150 140 130 120 110 100 90 80 70 60 50 40 30 20 10 0 10 20 30 40 50 60 70 80 90 100 110 120 130 140 150

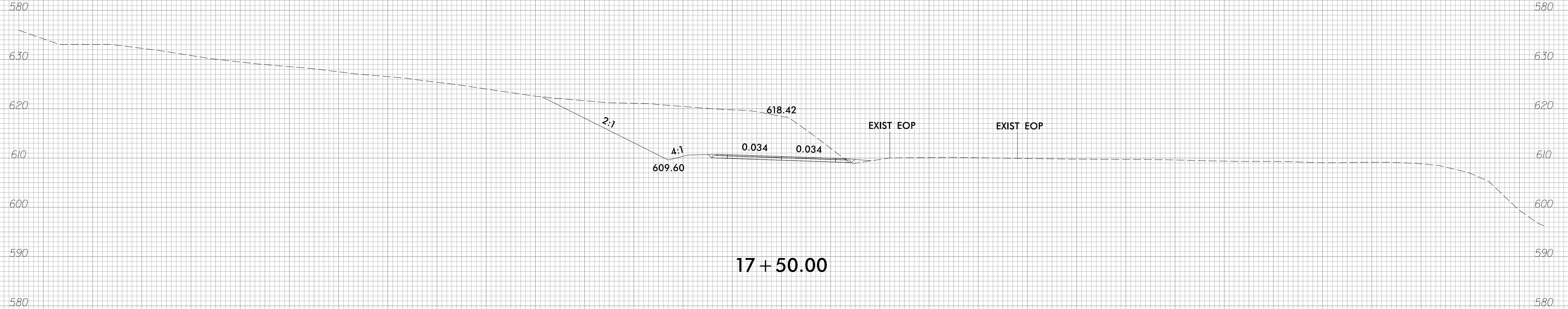
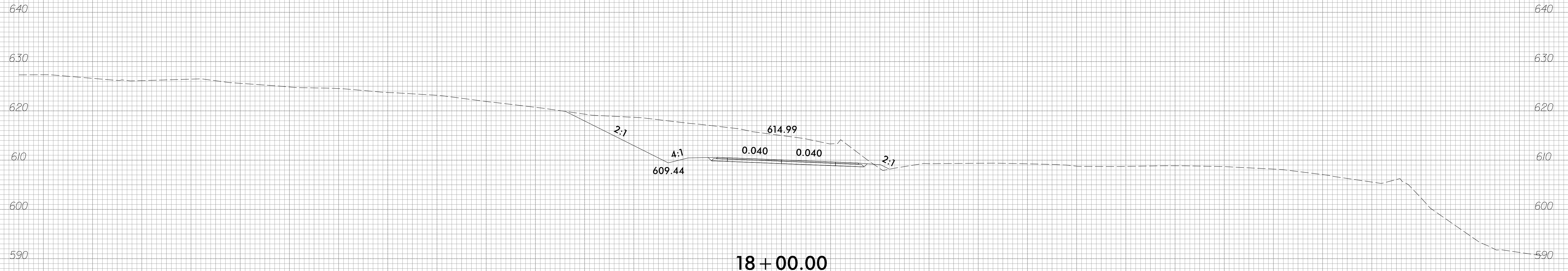
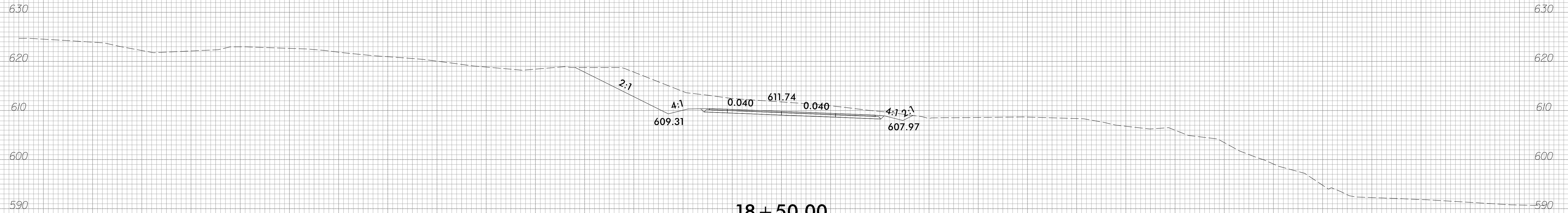

-LDET-

I:\4\2021  
G:\RA\10011-10\B5728\Roadway\XSC\B5728\_XPL\_LDET.dgn  
gmodlin

150 140 130 120 110 100 90 80 70 60 50 40 30 20 10 0 10 20 30 40 50 60 70 80 90 100 110 120 130 140 150



6/23/16

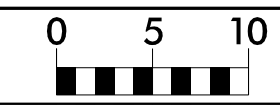

PROJ. REFERENCE NO.  
B-5728

SHEET NO.  
X-14

150 140 130 120 110 100 90 80 70 60 50 40 30 20 10 0 10 20 30 40 50 60 70 80 90 100 110 120 130 140 150

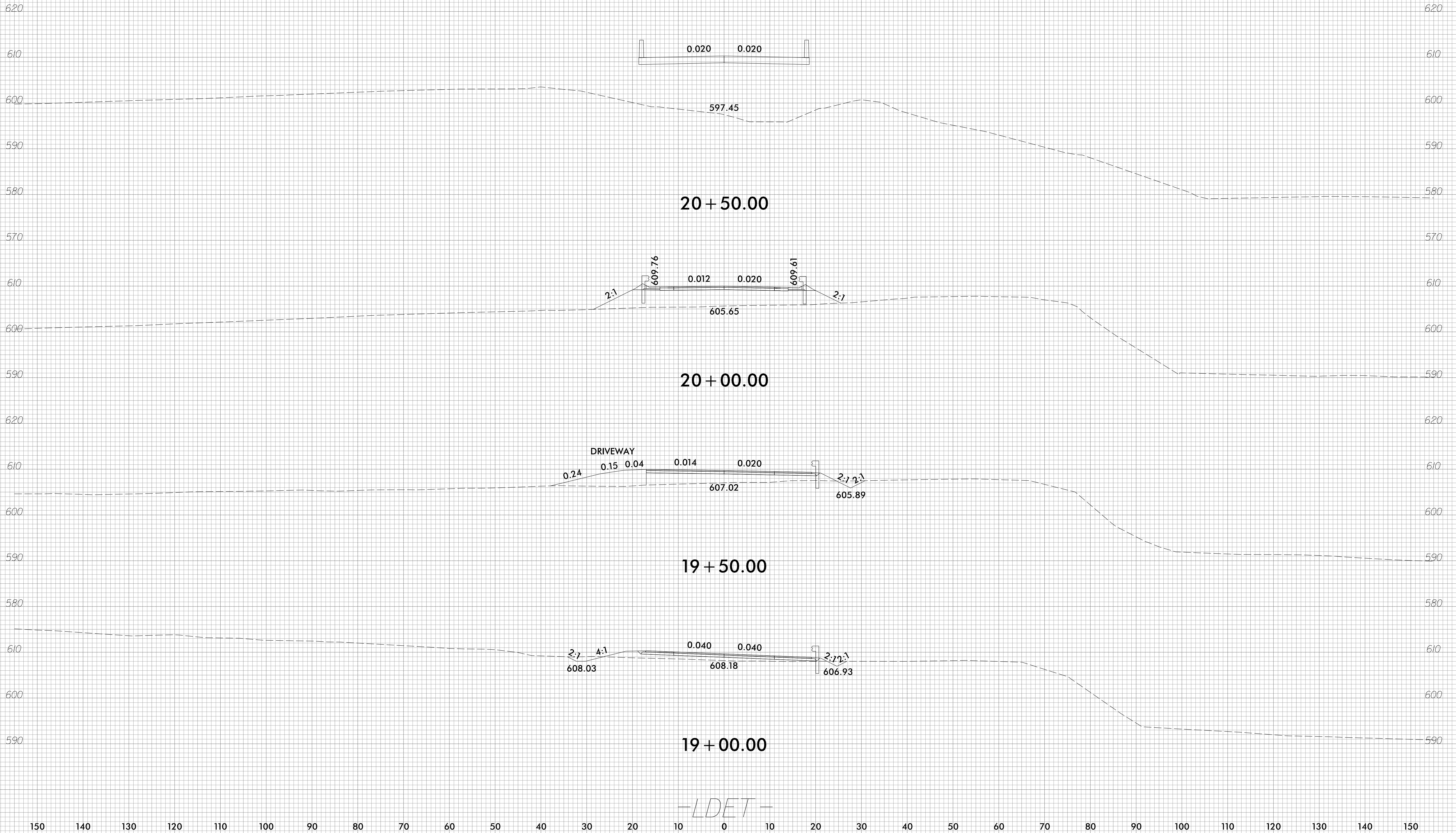

-LDET-

I:\4\2021\04\10011-10\B5728\Roadway\XSC\B5728\_XPL\_LDET.dgn  
gmodlin

150 140 130 120 110 100 90 80 70 60 50 40 30 20 10 0 10 20 30 40 50 60 70 80 90 100 110 120 130 140 150

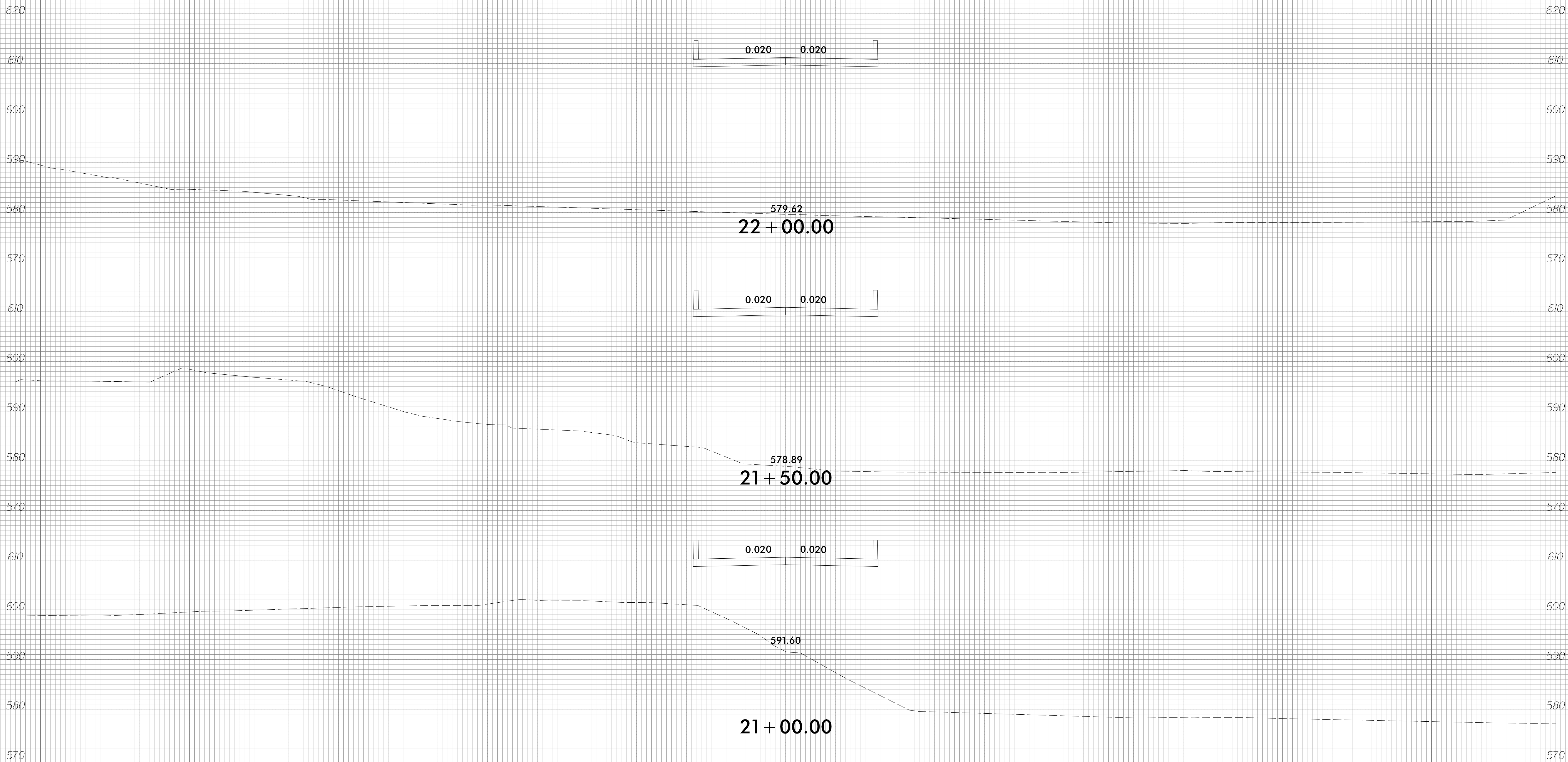

-LDET-

6/23/16

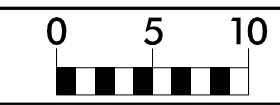

PROJ. REFERENCE NO.	SHEET NO.
B-5728	X-16

150 140 130 120 110 100 90 80 70 60 50 40 30 20 10 0 10 20 30 40 50 60 70 80 90 100 110 120 130 140 150

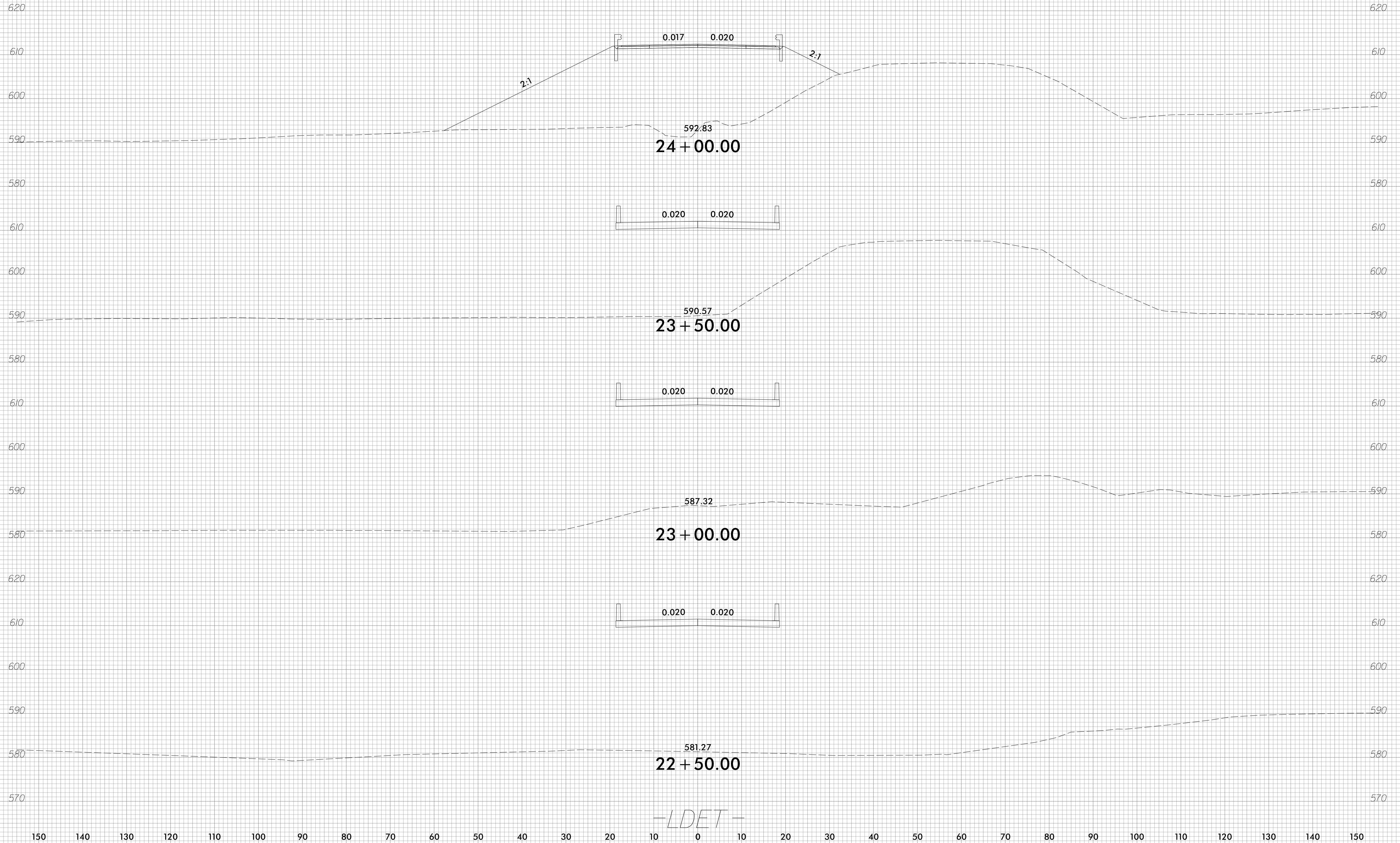

1/4/2021  
G:\RA\10011-10\B5728\Roadway\XSC\B5728\_XPL\_LDET.dgn  
gncdlin

6/23/16

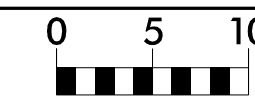

PROJ. REFERENCE NO.	SHEET NO.
B-5728	X-17

150 140 130 120 110 100 90 80 70 60 50 40 30 20 10 0 10 20 30 40 50 60 70 80 90 100 110 120 130 140 150

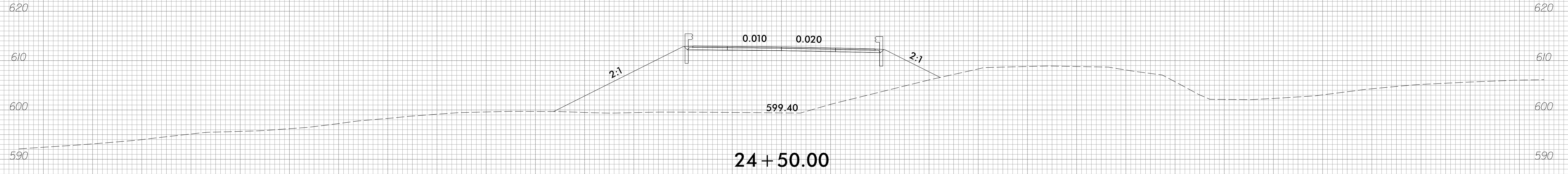
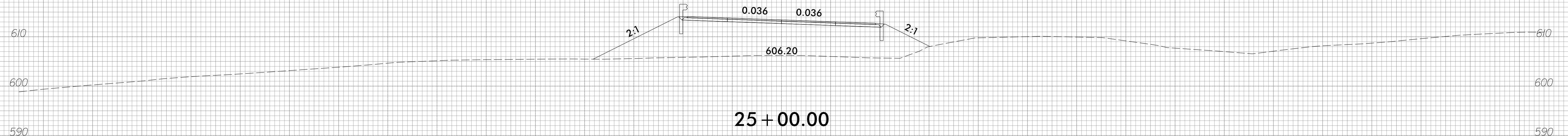
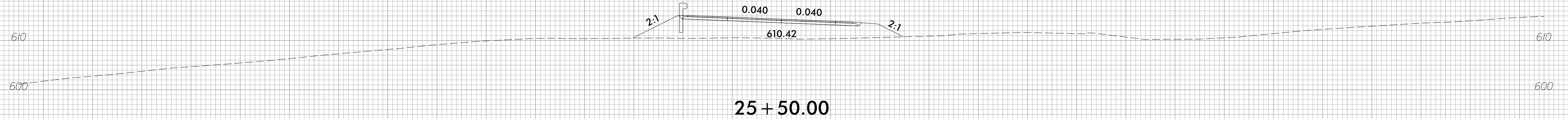
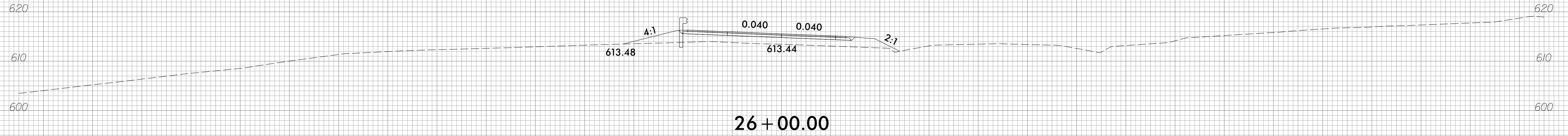
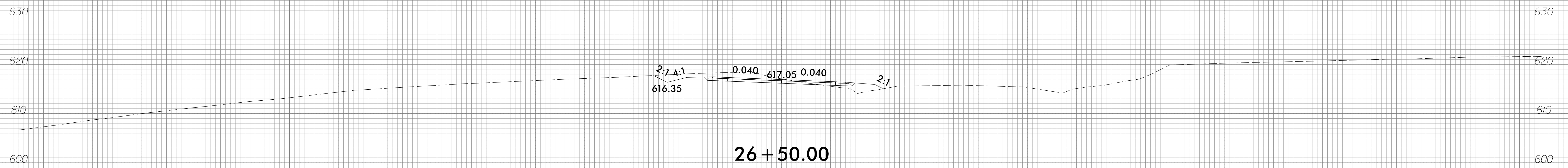

150 140 130 120 110 100 90 80 70 60 50 40 30 20 10 0 10 20 30 40 50 60 70 80 90 100 110 120 130 140 150

-LDET-

I:\4\2021\0:\NRA\10011-10\B5728\Roadway\XSC\B5728\_XPL\_LDET.dgn  
gmodlin

6/23/16

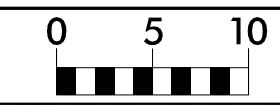

PROJ. REFERENCE NO.	SHEET NO.
B-5728	X-18

150 140 130 120 110 100 90 80 70 60 50 40 30 20 10 0 10 20 30 40 50 60 70 80 90 100 110 120 130 140 150

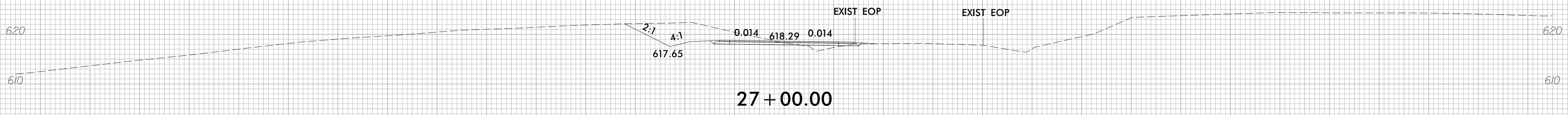
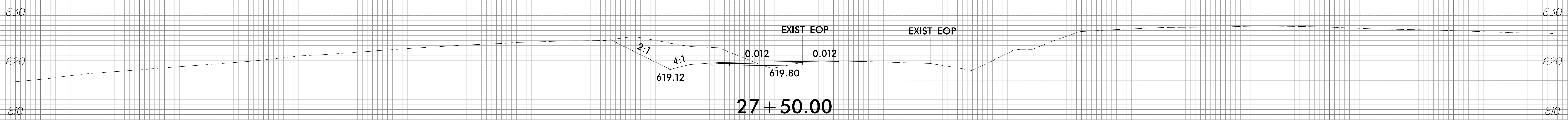
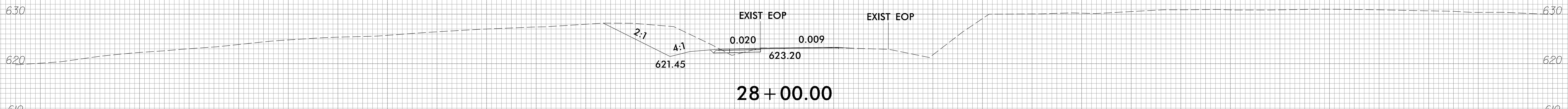
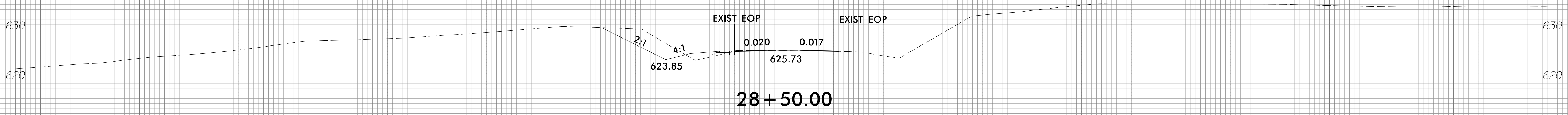
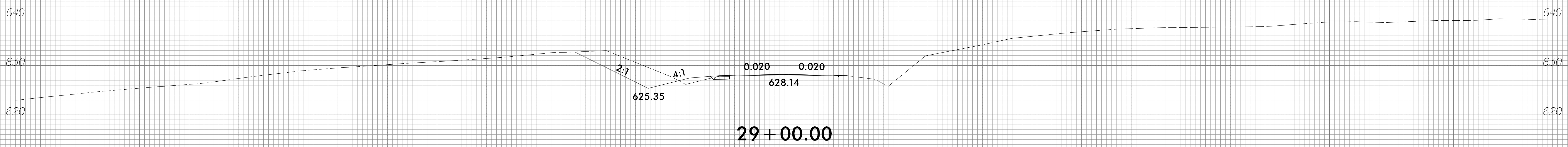

-LDET-

I:\4\2021\0\10011-10\B5728\Roadway\XSC\B5728\_XPL\_LDET.dgn

6/23/16

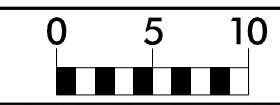

PROJ. REFERENCE NO.	SHEET NO.
B-5728	X-19

150 140 130 120 110 100 90 80 70 60 50 40 30 20 10 0 10 20 30 40 50 60 70 80 90 100 110 120 130 140 150

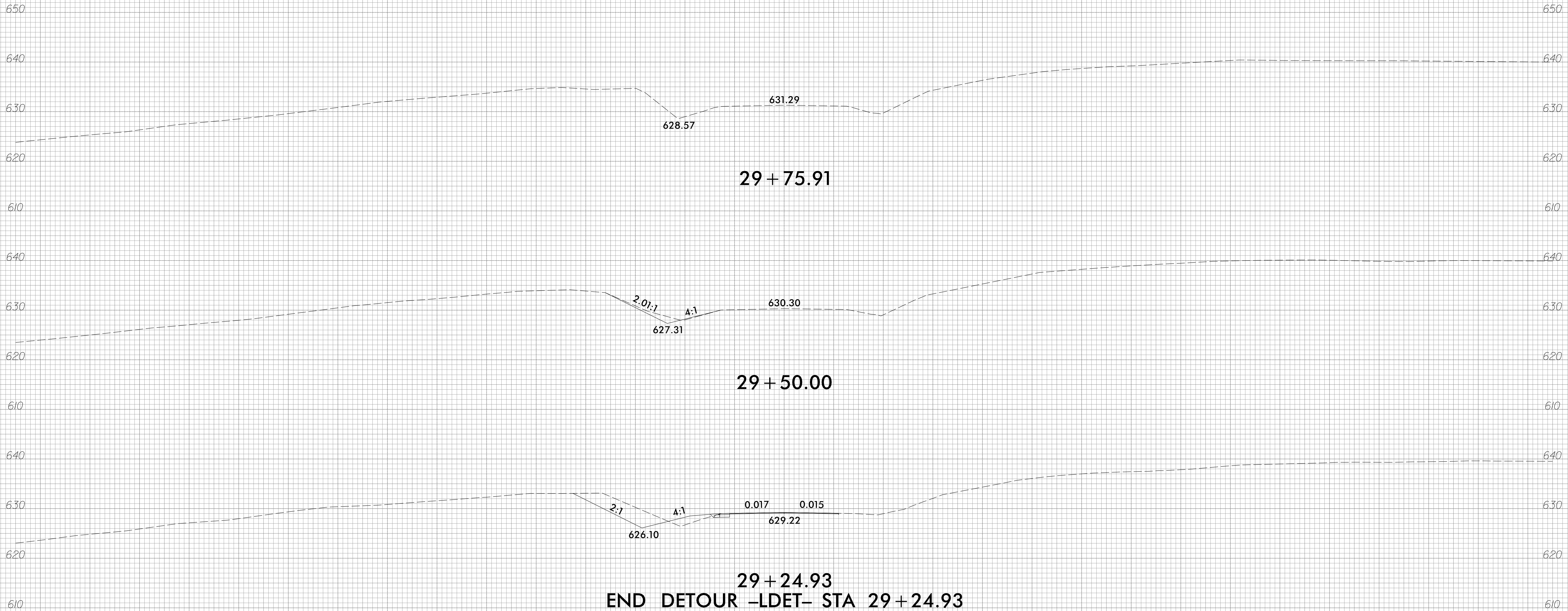

**END DETOUR -LDET- STA 29+24.93**  
 -LDET-

11/4/2021  
 G:\RA\10011-10\B5728\Roadway\XSC\B5728\_XPL\_LDET.dgn  
 gmo011

150 140 130 120 110 100 90 80 70 60 50 40 30 20 10 0 10 20 30 40 50 60 70 80 90 100 110 120 130 140 150