

Note: Approximate quantities only. Unclassified Excavation, Borrow Excavation, Fine Grading, Clearing and Grubbing, Breaking of Existing Pavement, and Removal of Existing Pavement will be paid for at the contract lump sum price for "Grading."

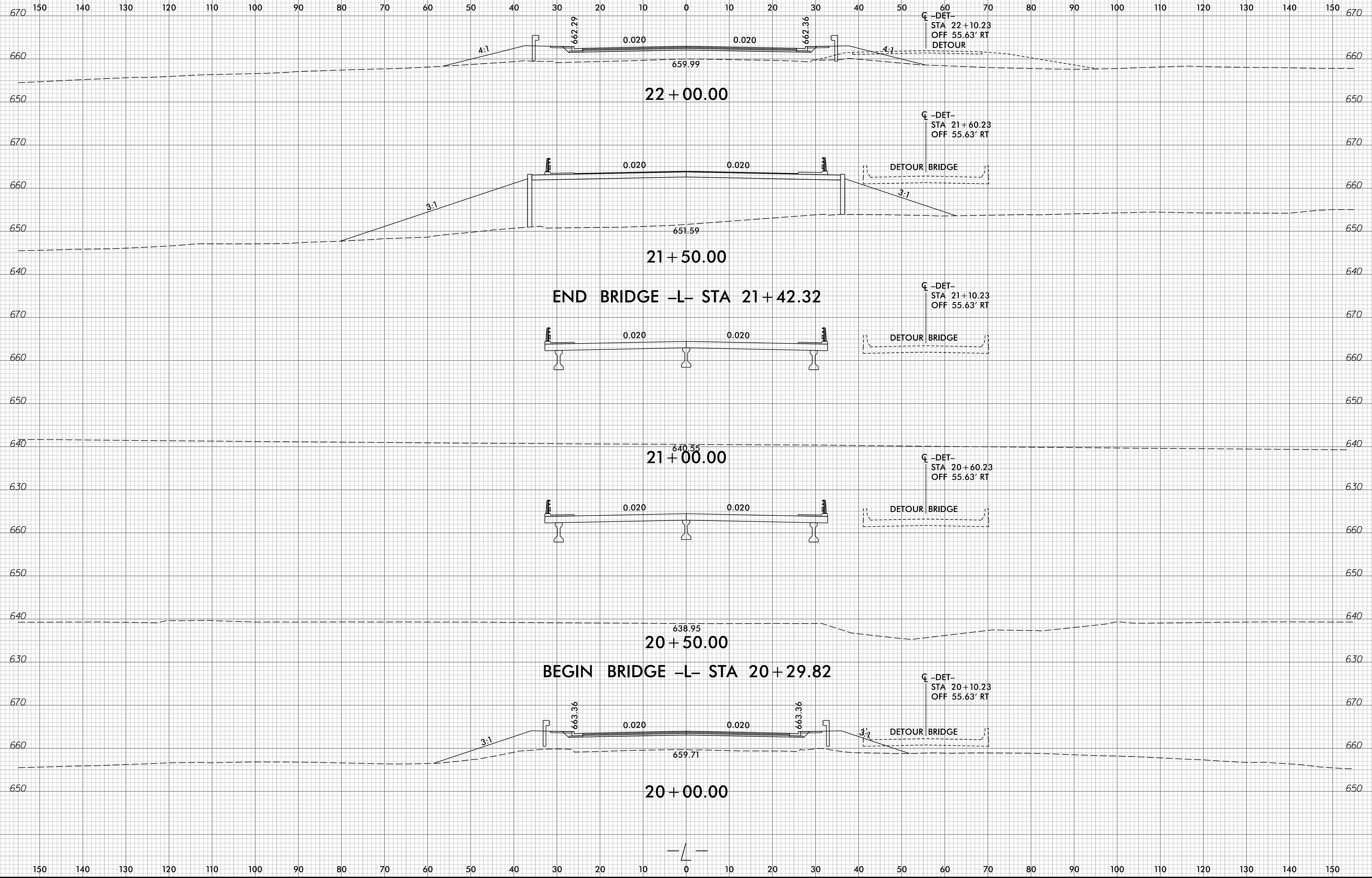

150 140 130 120 110 100 90 80 70 60 50 40 30 20 10 0 10 20 30 40 50 60 70 80 90 100 110 120 130 140 150

END CONSTRUCTION -L- STA 25+00.00

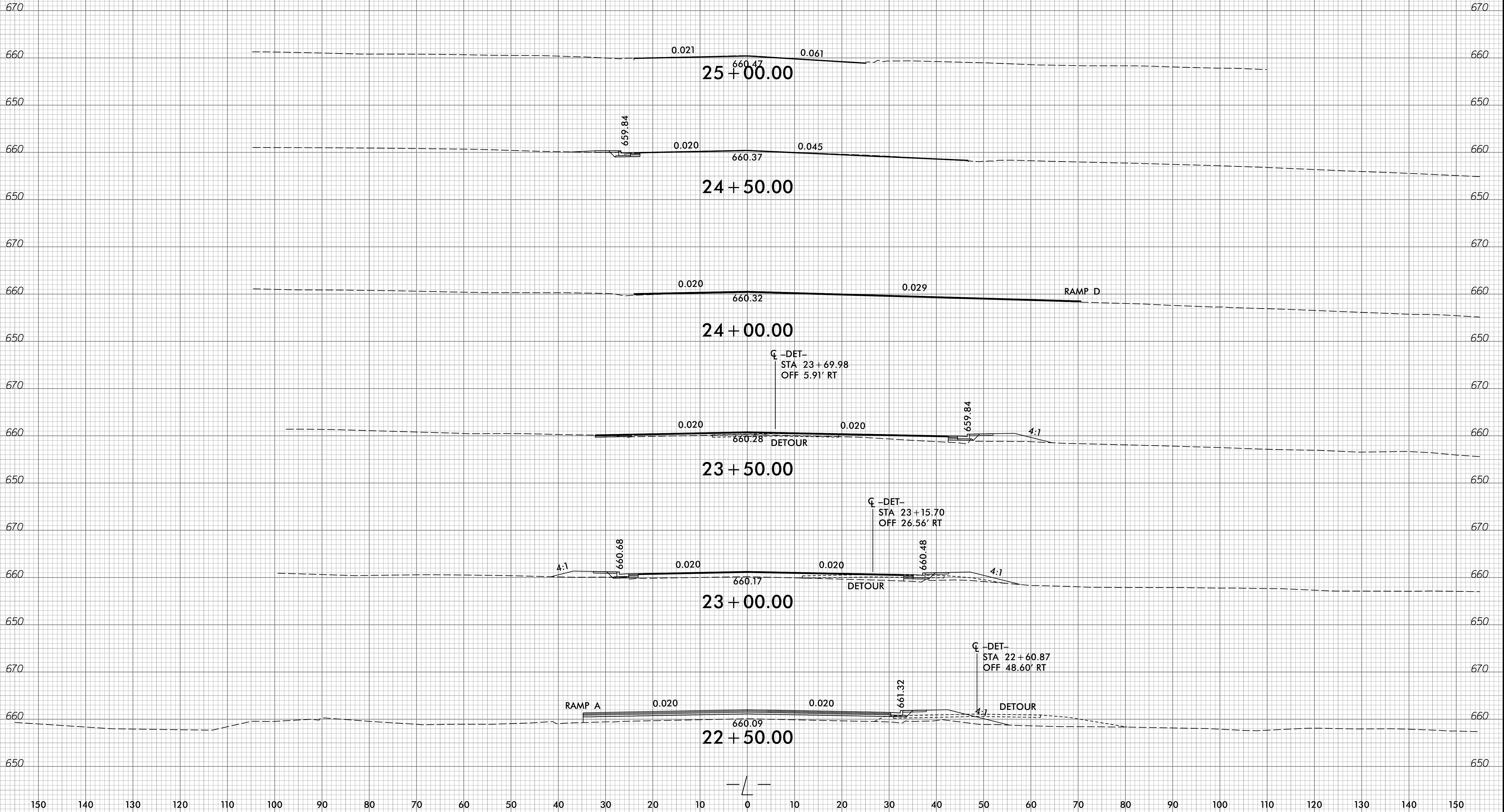

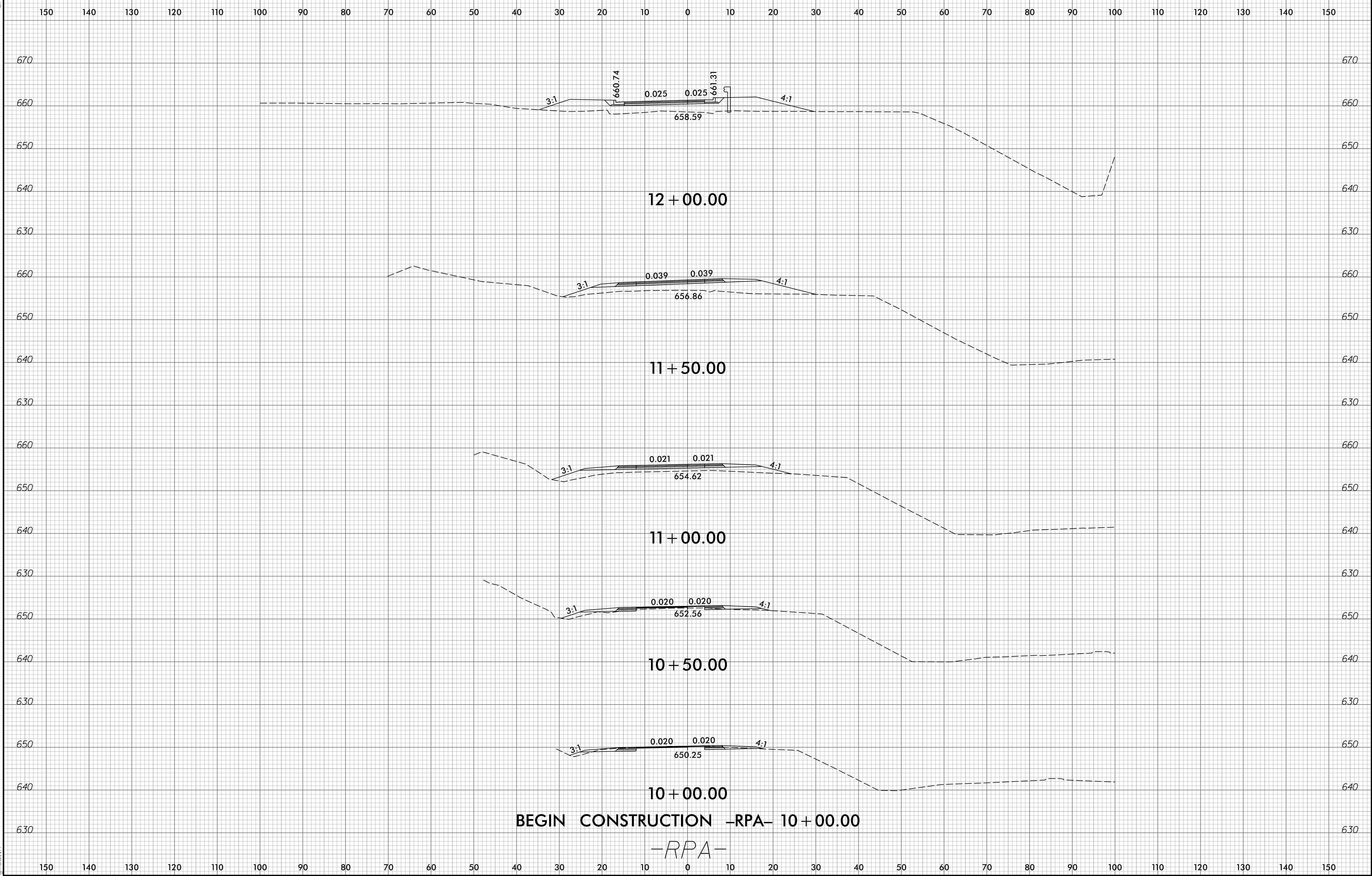

BEGIN CONSTRUCTION -RPA- 10 + 00.00

-RPA-

6/23/16

0	5	10	PROJ. REFERENCE NO.	SHEET NO.
█	█	█	B-5737	X-5

150 140 130 120 110 100 90 80 70 60 50 40 30 20 10 0 10 20 30 40 50 60 70 80 90 100 110 120 130 140 150

END CONSTRUCTION -RPA- 12 + 25.00

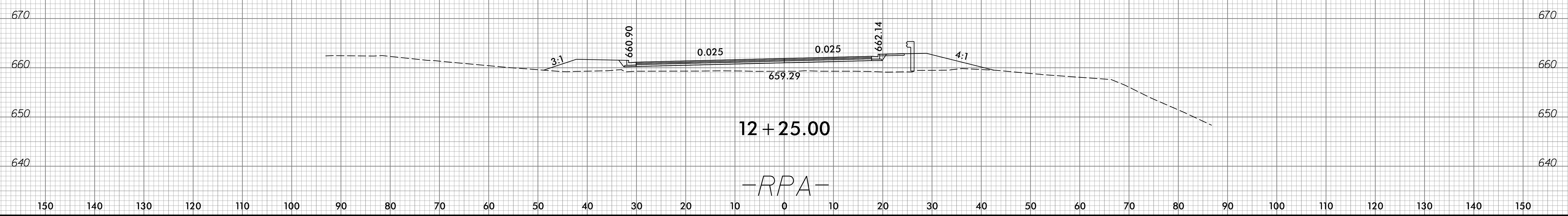

\\30/2021
0:\RA\10011-103\B5737-Roadway\XSC\B5737_xp1_RPA.dgn
gmod.lin

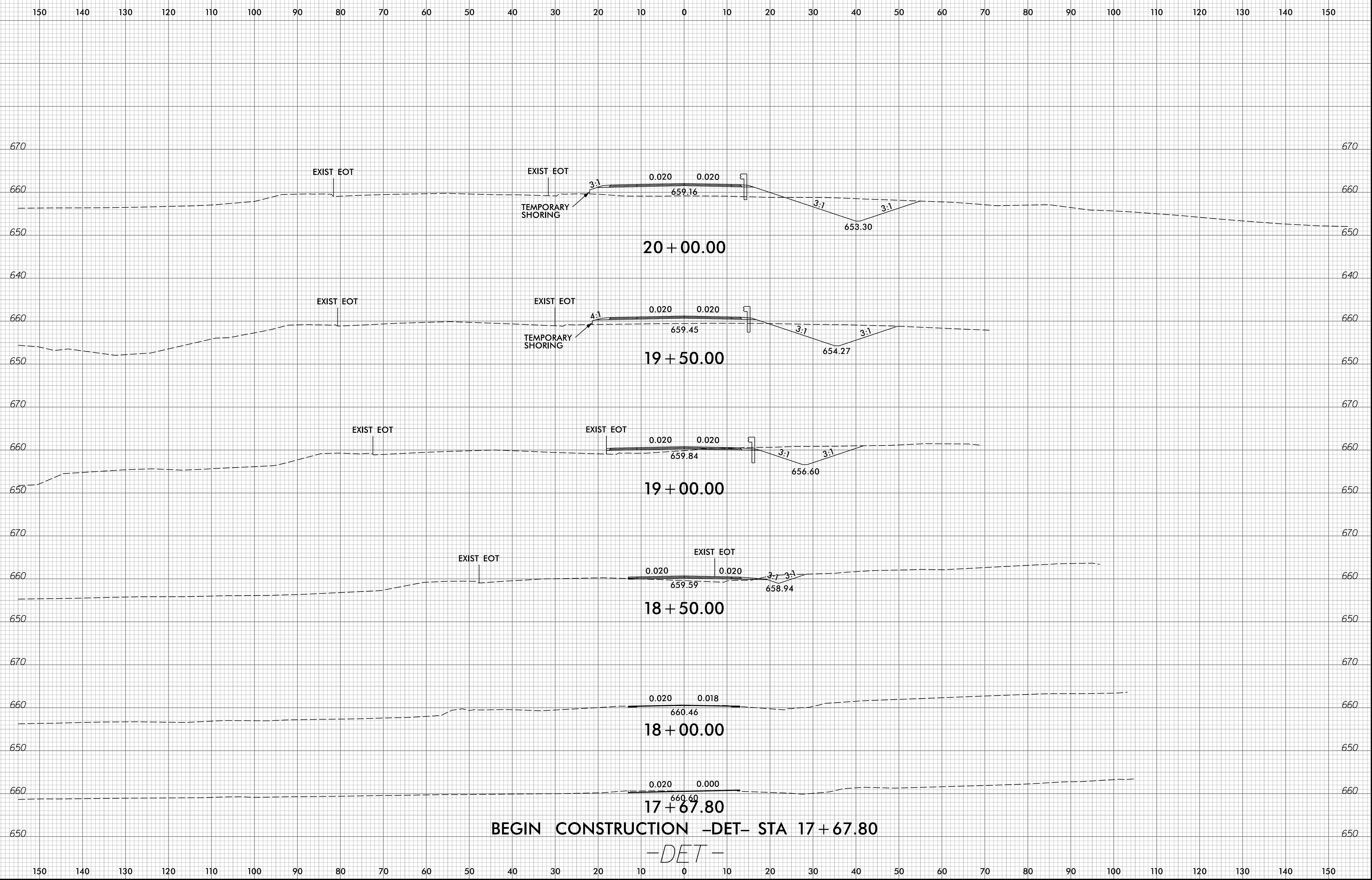

BEGIN CONSTRUCTION -DET- STA 17 + 67.80

-DET-

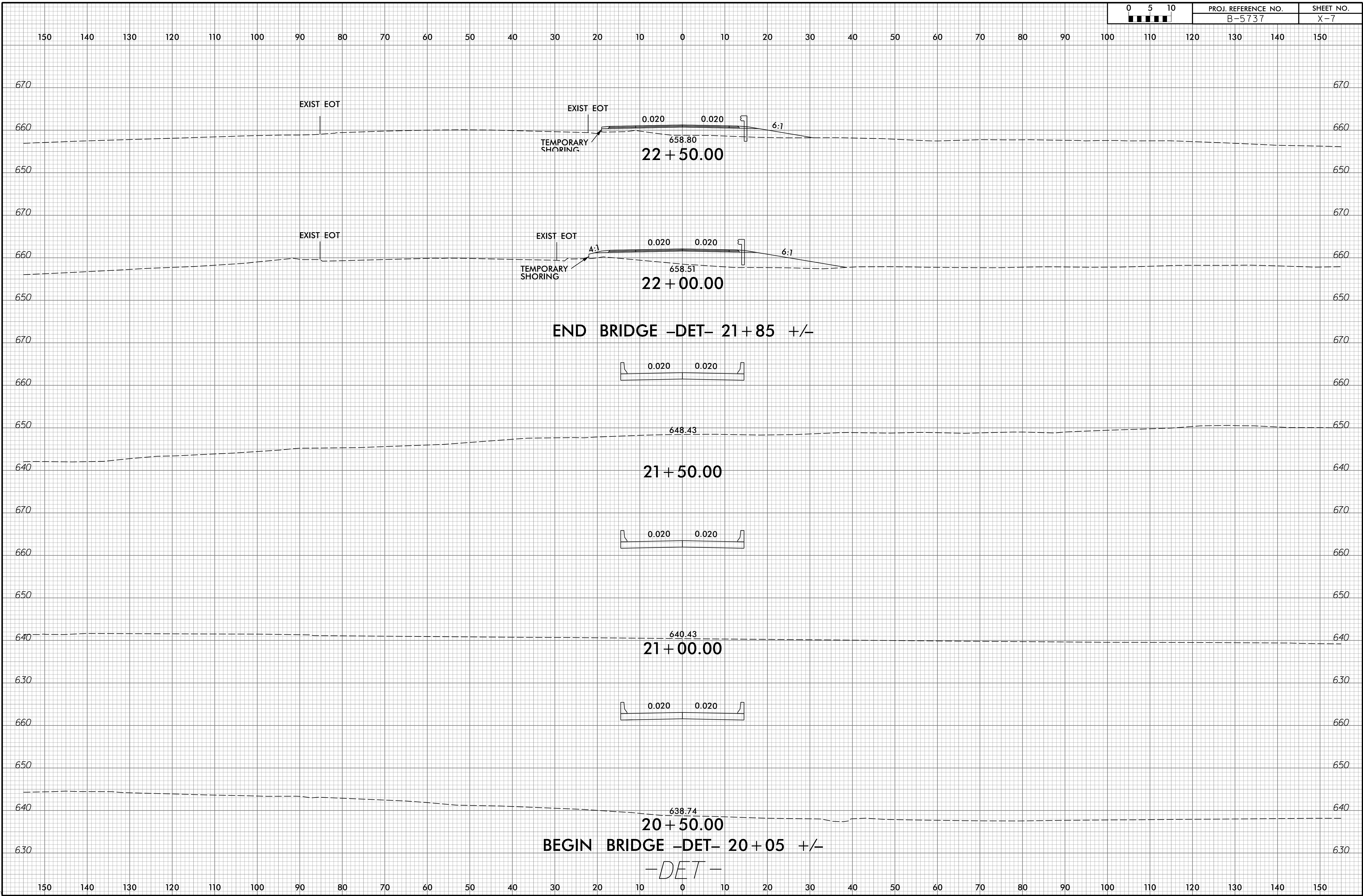

150 140 130 120 110 100 90 80 70 60 50 40 30 20 10 0 10 20 30 40 50 60 70 80 90 100 110 120 130 140 150

END CONSTRUCTION -DET- 24+17.64

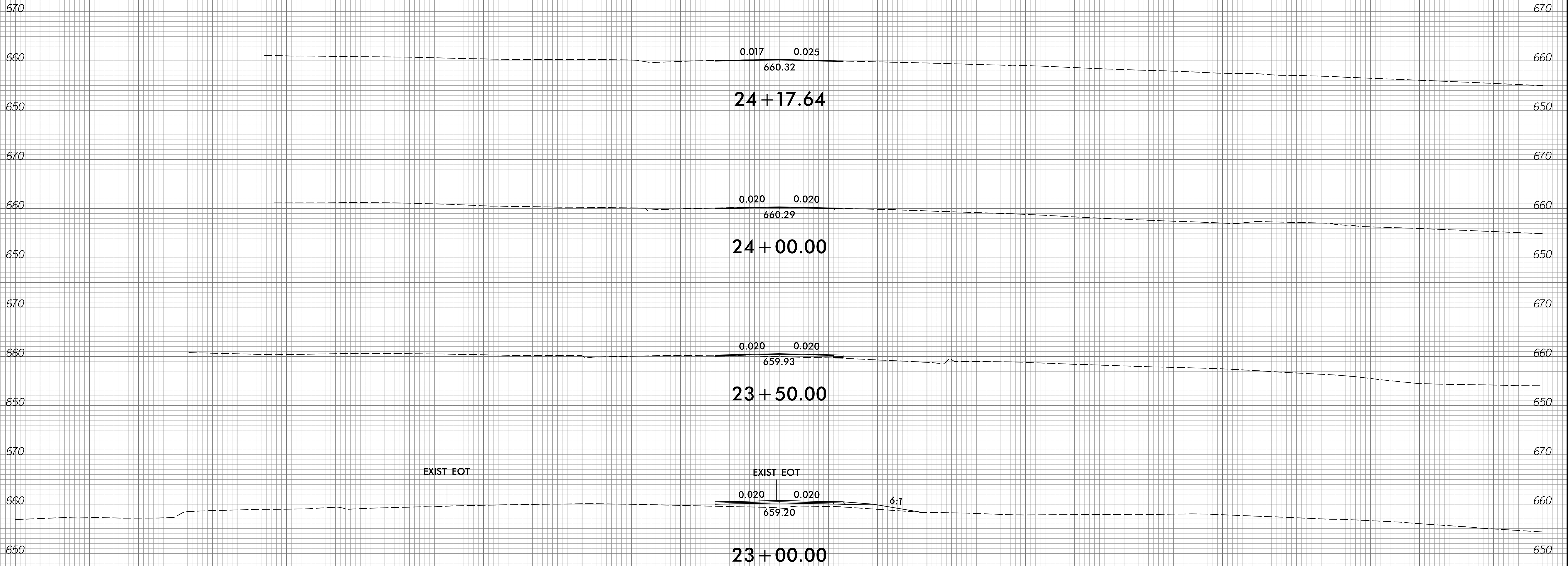

-DET-