

END POST DETAILS

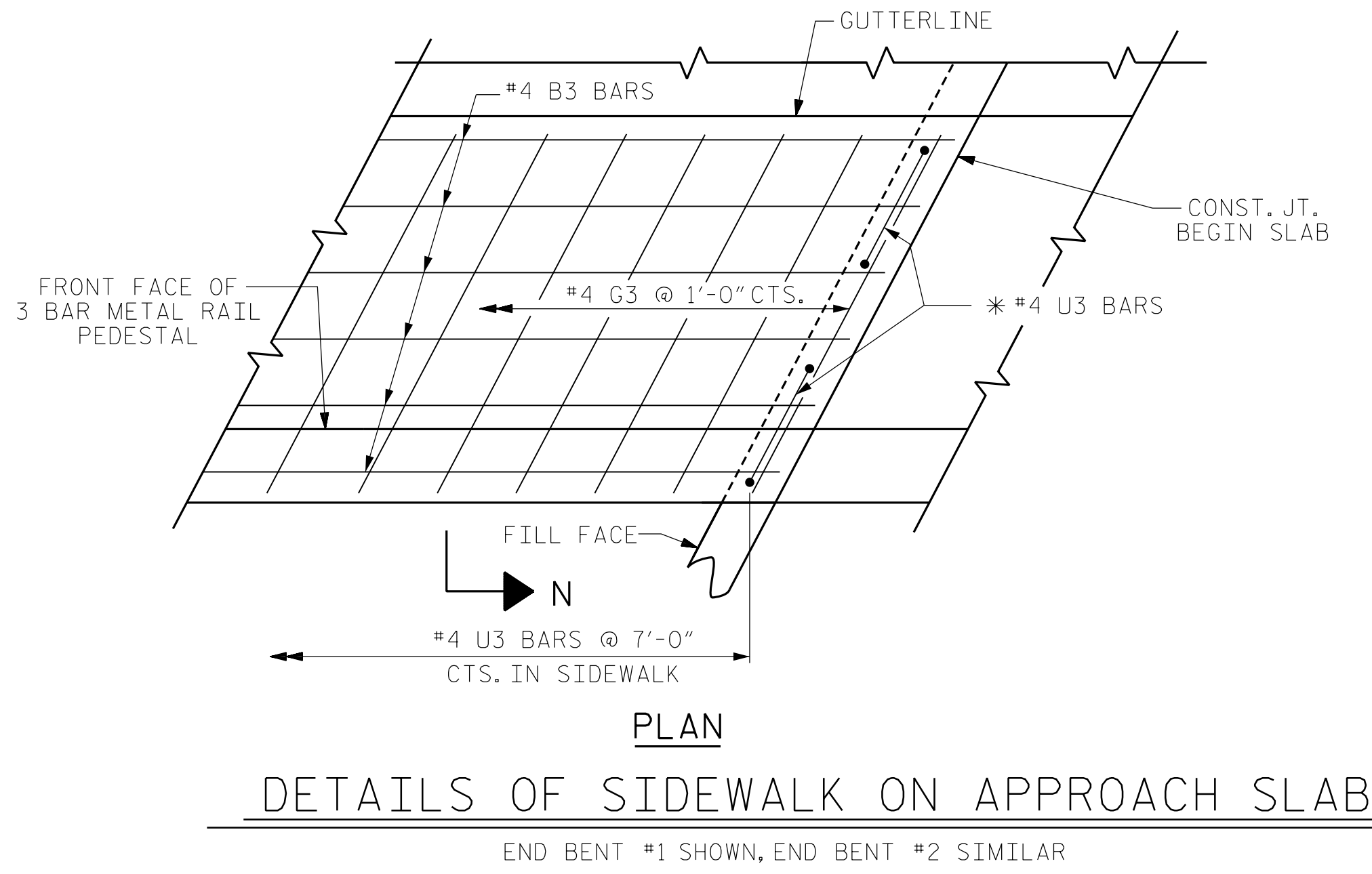

DETAILS OF SIDEWALK ON APPROACH SLAB
END BENT #1 SHOWN, END BENT #2 SIMILAR

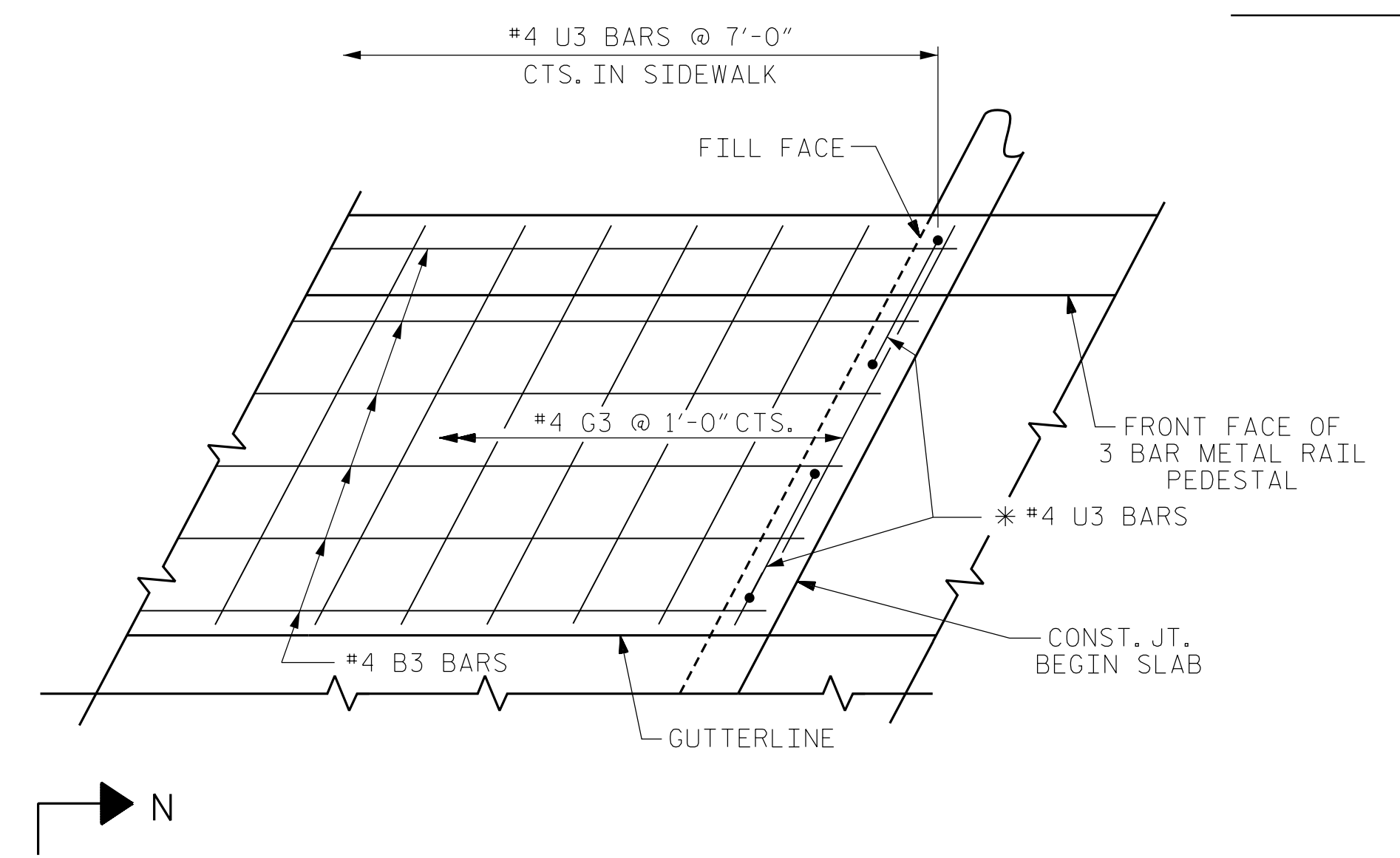
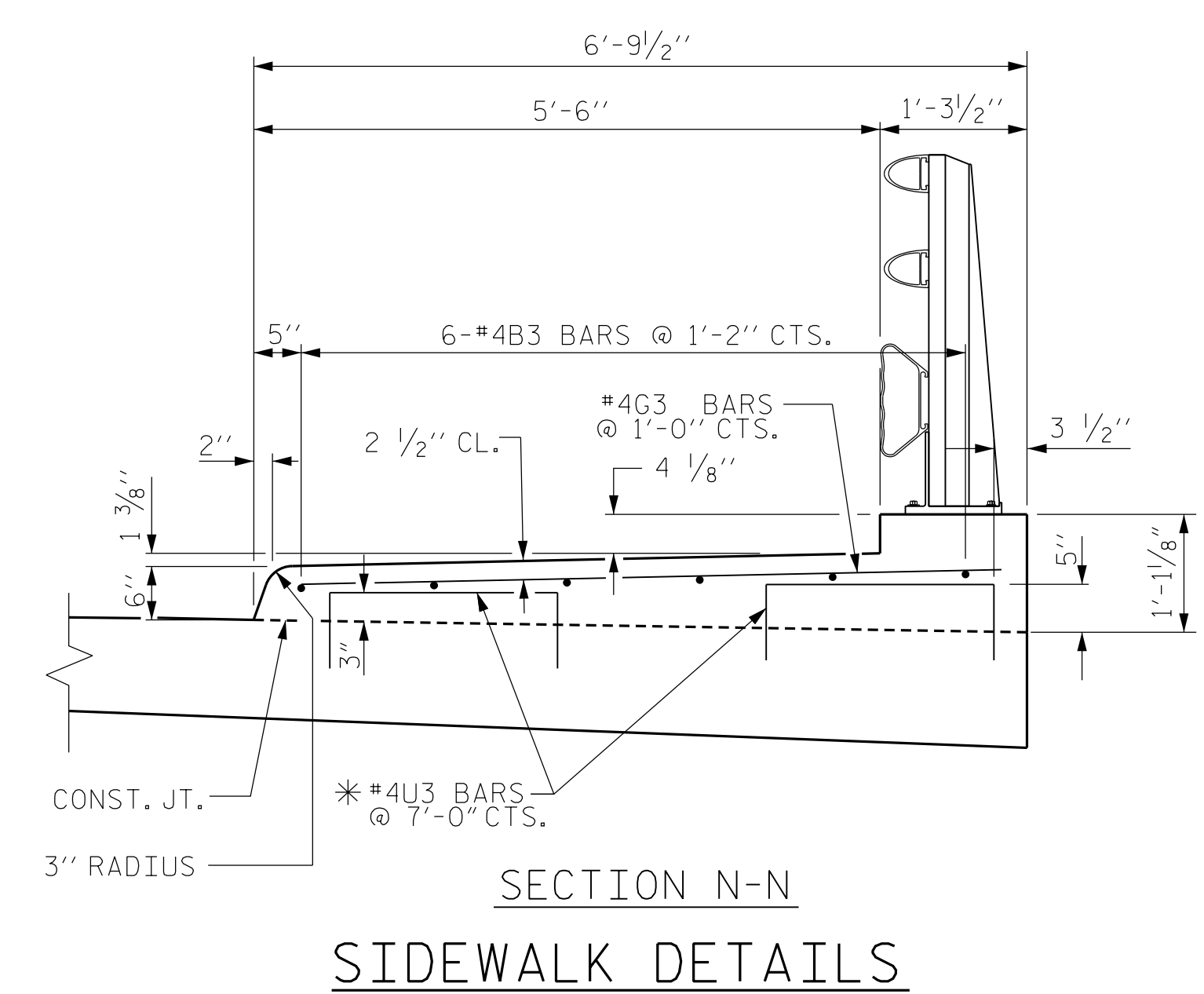

SECTION N-N
SIDEWALK DETAILS

NOTES:
ALL REINFORCING STEEL IN THE SIDEWALK SHALL BE EPOXY COATED.
GROOVED CONTRACTION JOINTS, 1/32" IN DEPTH, SHALL BE TOOLED IN ALL EXPOSED FACES OF THE SIDEWALK IN ACCORDANCE WITH THE ARTICLE 825-10(B) OF THE STANDARD SPECIFICATIONS. THE CONTRACTION JOINTS SHALL BE LOCATED AT A SPACING OF 8 FT. TO 10 FT. BETWEEN EXPANSION JOINTS. NO CONTRACTION JOINT WILL BE REQUIRED FOR SEGMENTS LESS THAN 10 FT. IN LENGTH.
*U3 BARS MAY BE PUSHED INTO GREEN CONCRETE AFTER THE APPROACH SLAB HAS BEEN SCREEDED OFF.

PROJECT NO. B-5737
ROCKINGHAM COUNTY
STATION: 20+86.07 -L-
SHEET 2 OF 3

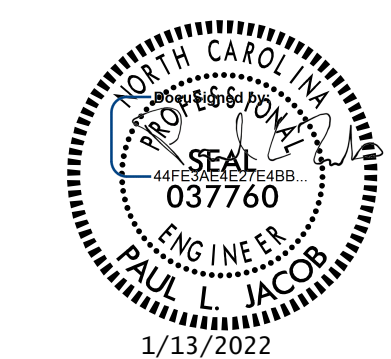

STATE OF NORTH CAROLINA
DEPARTMENT OF TRANSPORTATION
RALEIGH

BRIDGE APPROACH
SLAB DETAILS

DRAWN BY : J. LOFTUS DATE : 03-2021
CHECKED BY : P. JACOB DATE : 07-2021
DESIGN ENGINEER OF RECORD: J. LOFTUS DATE : 04-2021

moffatt & nichol
4700 FALLS OF NEUSE ROAD, SUITE 300
RALEIGH, NORTH CAROLINA 27609
(919) 781-4626 VOICE (919) 781-4869 FAX
NC License No.: F-0105

DOCUMENT NOT CONSIDERED
FINAL UNLESS ALL
SIGNATURES COMPLETED

REVISIONS						SHEET NO.
NO.	BY:	DATE:	NO.	BY:	DATE:	S-27
1			3			TOTAL SHEETS
2			4			29

1/12/2022 10:01:10 AM 1031557371-Structures\01-CADD\03-Final Drawings\01_053_B5737_SMU_A502_027_780108.dgn p.jacob