

W. 14TH ST. AND
DICKINSON AVE.
AT 02-0006

LEGEND

COLOR CODE TIA/EIA 598-A		X - FUSION SPLICE INDIVIDUAL FIBER
(1) BLUE	(7) RED	
(2) ORANGE	(8) BLACK	[BUFFER TUBE] SPLICE OR EXPRESS ENTIRE BUFFER TUBE AS NOTED
(3) GREEN	(9) YELLOW	
(4) BROWN	(10) VIOLET	
(5) SLATE	(11) ROSE	
(6) WHITE	(12) AQUA	

NOTE:
1. UNLESS OTHERWISE NOTED, CAP AND STORE UNUSED FIBERS.
2. UNUSED BUFFER TUBES LEFT COILED AND STORED IN SPLICE TRAY.

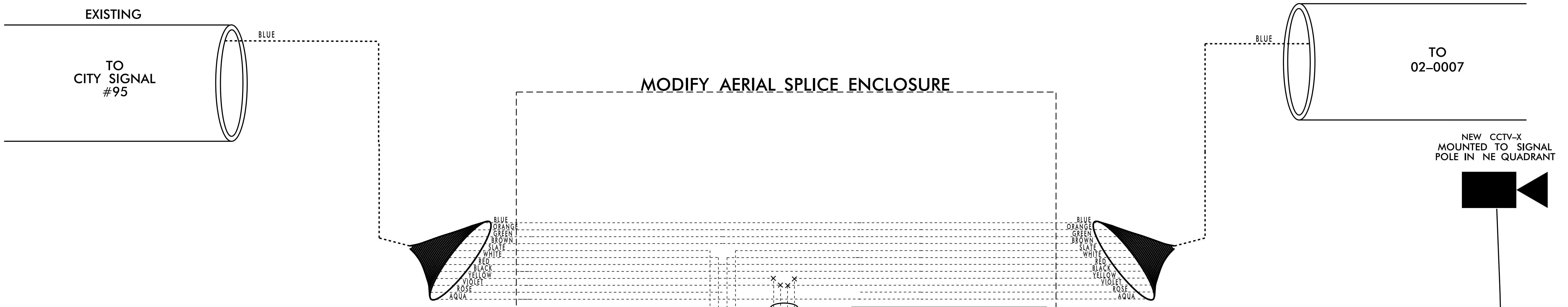

NOTES:

- 1) NOTIFY THE CITY OF GREENVILLE ASSISTANT TRAFFIC ENGINEER, STACEY PIGFORD, AT (252) 329-4678 FIVE (5) DAYS PRIOR TO BEGINNING WORK ON SIGNAL SYSTEM COMMUNICATIONS CABLE. NOTIFY THE ASSISTANT TRAFFIC ENGINEER AFTER ALL WORK IS PERFORMED TO ENSURE THAT ALL FIBER CIRCUITS ARE FUNCTIONING PROPERLY. ALL WORK IS NOT COMPLETE UNTIL THE SIGNAL SYSTEM IS BACK UP AND OPERATIONAL.
- 2) CONTRACTOR TO RECORD EXISTING SPLICE ARRANGEMENT FOR COMPARISON TO THE SUPPLIED SPLICE DETAILS. IF DISCREPANCIES EXIST, CONTACT THE ENGINEER TO DETERMINE HOW TO PROCEED WITH RESPLICING. PROVIDE AS-BUILT PLANS TO THE ENGINEER IF FINAL SPLICE ARRANGEMENT DIFFERS FROM THE SUPPLIED SPLICE DETAILS.
- 3) TRANSCEIVER AND ETHERNET SWITCH TERMINATION CONFIGURATIONS ARE GENERIC. CONTRACTOR IS RESPONSIBLE FOR DETERMINING \ENSURING PROPER TERMINATIONS.
- 4) INCLUDE ON THE COVER OF EACH SPLICE TRAY THE FOLLOWING: REFERENCE SECTION 1731 "FIBER OPTIC SPLICE ENCLOSURE"

- 1) SPLICE LOCATION
- 2) DATE
- 3) COMPANY NAME
- 4) NAME OF INDIVIDUAL PERFORMING THE SPLICING

PRIOR TO INSTALLING THE COVER ON THE SPLICE TRAY TAKE A DIGITAL PHOTOGRAPH SHOWING THE SPLICE TRAY AND INFORMATION SHOWN ABOVE (1-4) AND SUBMIT PHOTOGRAPH ALONG WITH OTDR TEST RESULTS.

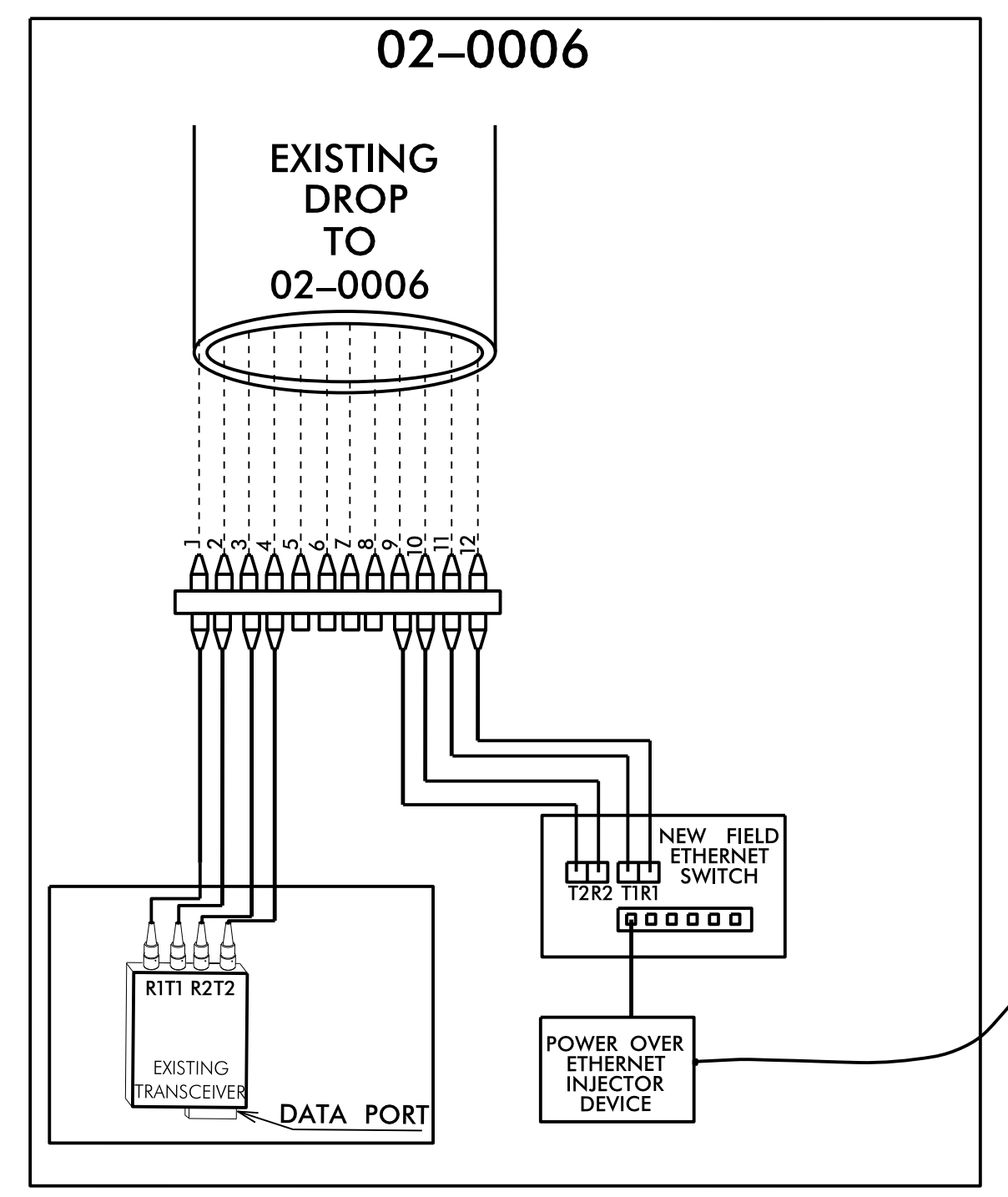

FINAL PHASE DOCUMENT NOT CONSIDERED FINAL UNLESS ALL SIGNATURES COMPLETED

<p>750 N. Greenfield Pkwy., Garner, NC 27529</p>	SPLICE PLANS		
	DIVISION 02 PITT COUNTY GREENVILLE PLAN DATE: FEBRUARY 2018 REVIEWED BY: <i>I. N. Avery</i> PREPARED BY: H. T. BERGGREN, EI	REVISIONS: _____ INIT. DATE _____ _____	
SCALE: 0 N/A N/A	DATE: _____		DATE: 3/5/2018

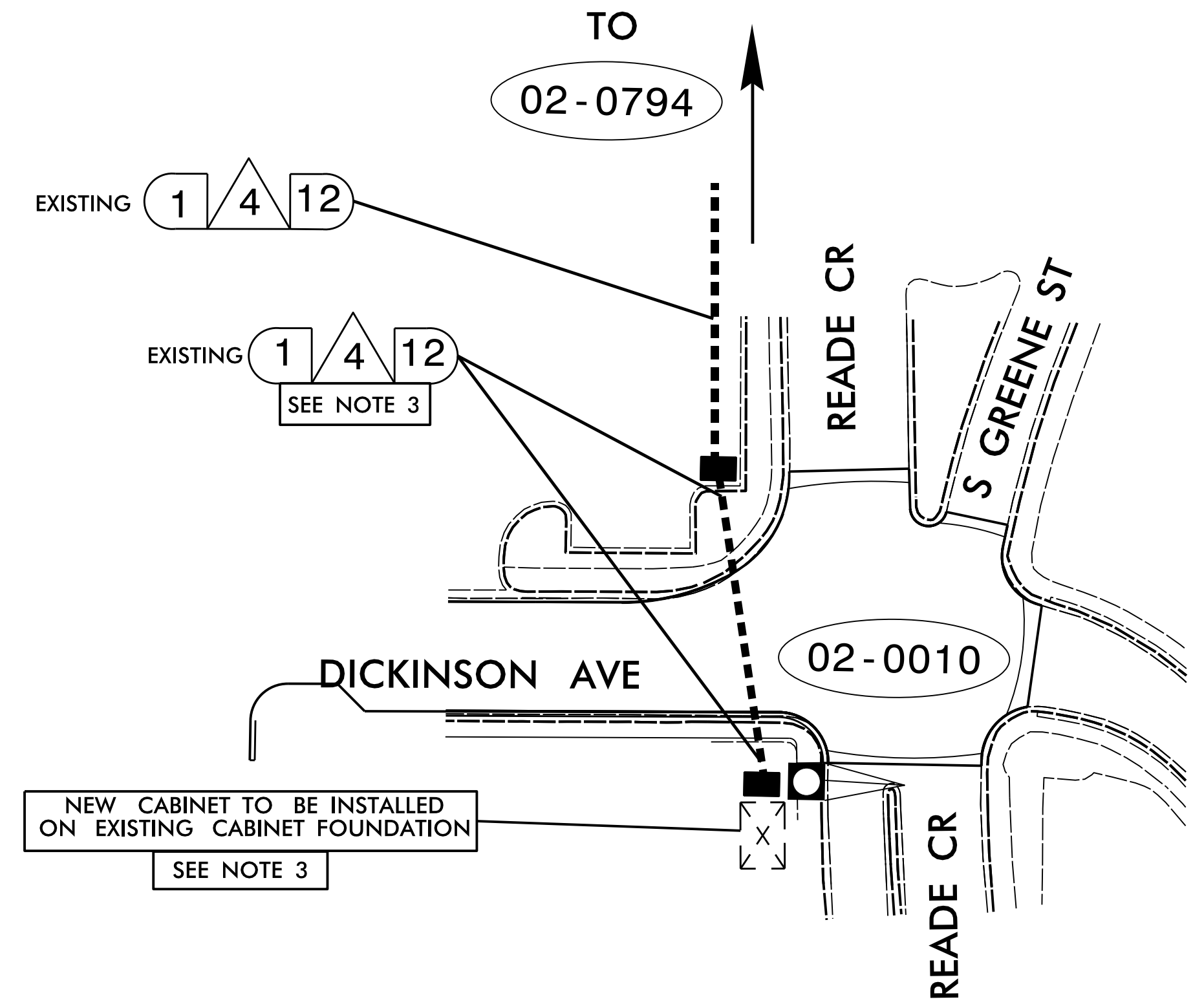

NOTES:

- 1) NOTIFY THE CITY OF GREENVILLE ASSISTANT TRAFFIC ENGINEER, STACEY PIGFORD, AT (252) 329-4678 FIVE (5) DAYS PRIOR TO BEGINNING WORK ON SIGNAL SYSTEM COMMUNICATIONS CABLE. NOTIFY THE ASSISTANT TRAFFIC ENGINEER AFTER ALL WORK IS PERFORMED TO ENSURE THAT ALL FIBER CIRCUITS ARE FUNCTIONING PROPERLY. ALL WORK IS NOT COMPLETE UNTIL THE SIGNAL SYSTEM IS BACK UP AND OPERATIONAL.
- 2) CONTRACTOR TO RECORD EXISTING SPLICE ARRANGEMENTS FOR USE IN THE CASE THAT THE EXISTING SIGNAL SYSTEM CABLE IS DISCONNECTED OR DAMAGED DURING SIGNAL CABINET CHANGE OUT. REPLACE ANY DAMAGED CABLE WITH NEW 12-FIBER CABLE AND RESPLICE ACCORDING TO THE RECORDED SPLICE ARRANGEMENTS. ALL WORK IS NOT COMPLETE UNTIL THE SIGNAL SYSTEM IS BACK UP AND OPERATIONAL.
- 3) DO NOT DISTURB EXISTING CONDUIT OR COMMUNICATIONS CABLE. DO NOT DISTURB OR DISCONNECT INTERCONNECT CENTER DURING SIGNAL CABINET CHANGE OUT.

TMP PHASE 1

**DOCUMENT NOT CONSIDERED FINAL
UNLESS ALL SIGNATURES COMPLETED**

	COMMUNICATIONS CABLE AND CONDUIT ROUTING PLANS		
	DIVISION 02 PITT COUNTY GREENVILLE PLAN DATE: FEBRUARY 2018 REVIEWED BY: <i>I. N. Avery</i> PREPARED BY: H. T. BERGGREN, EI	REVISIONS _____ _____ _____	
750 N. Greenfield Pkwy., Garner, NC 27529 	SCALE 0 50 1" = 50'	_____ _____ _____	_____ _____ _____

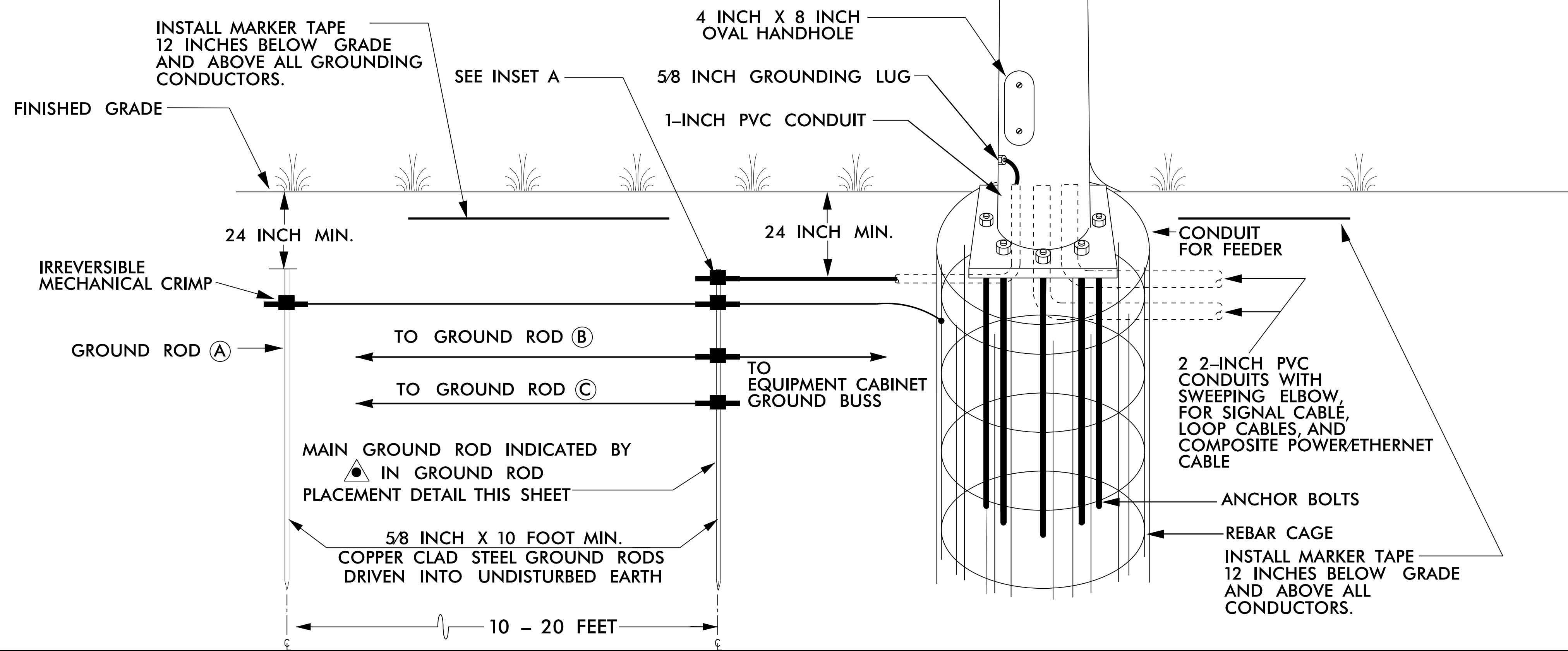
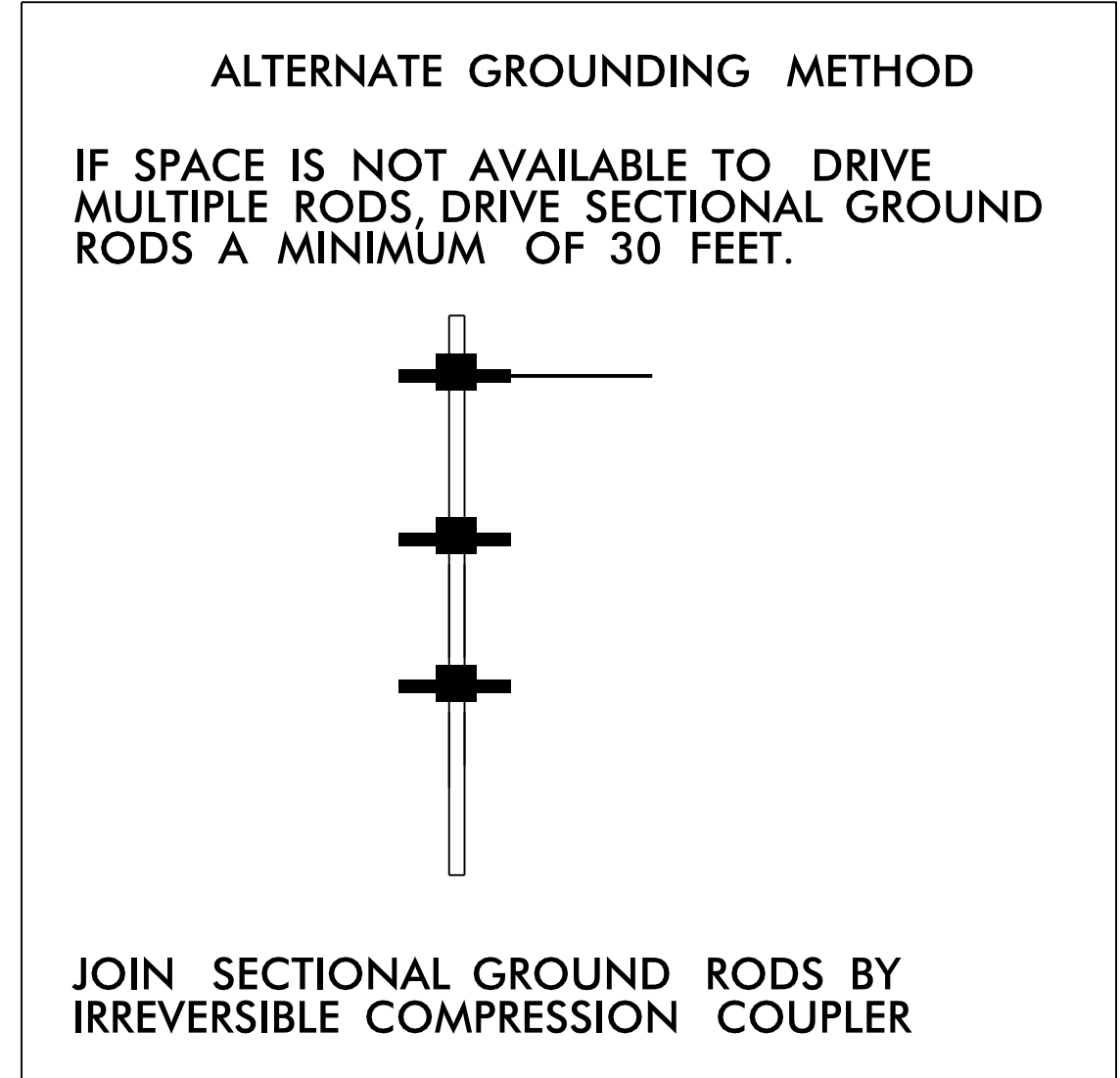
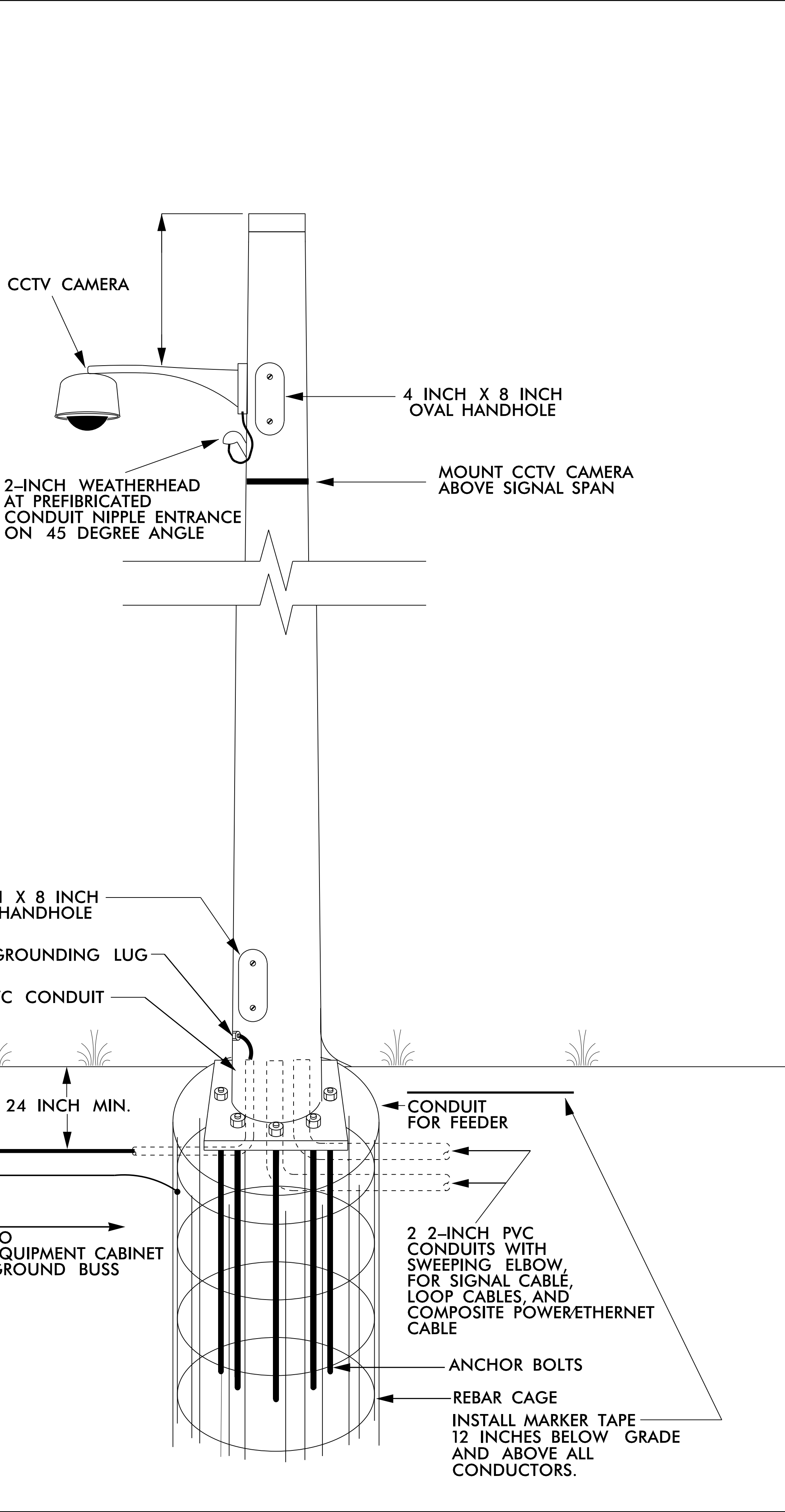
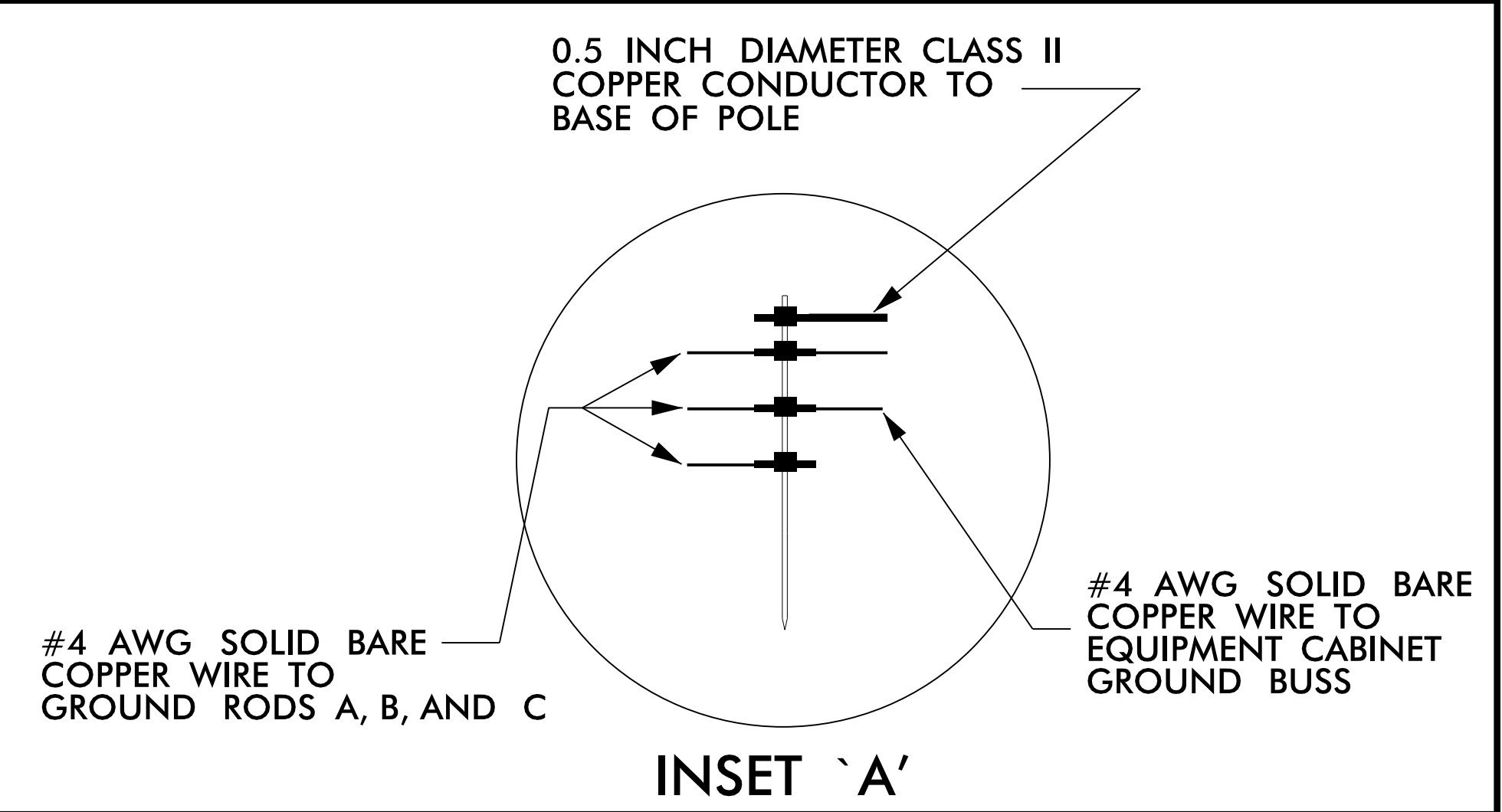
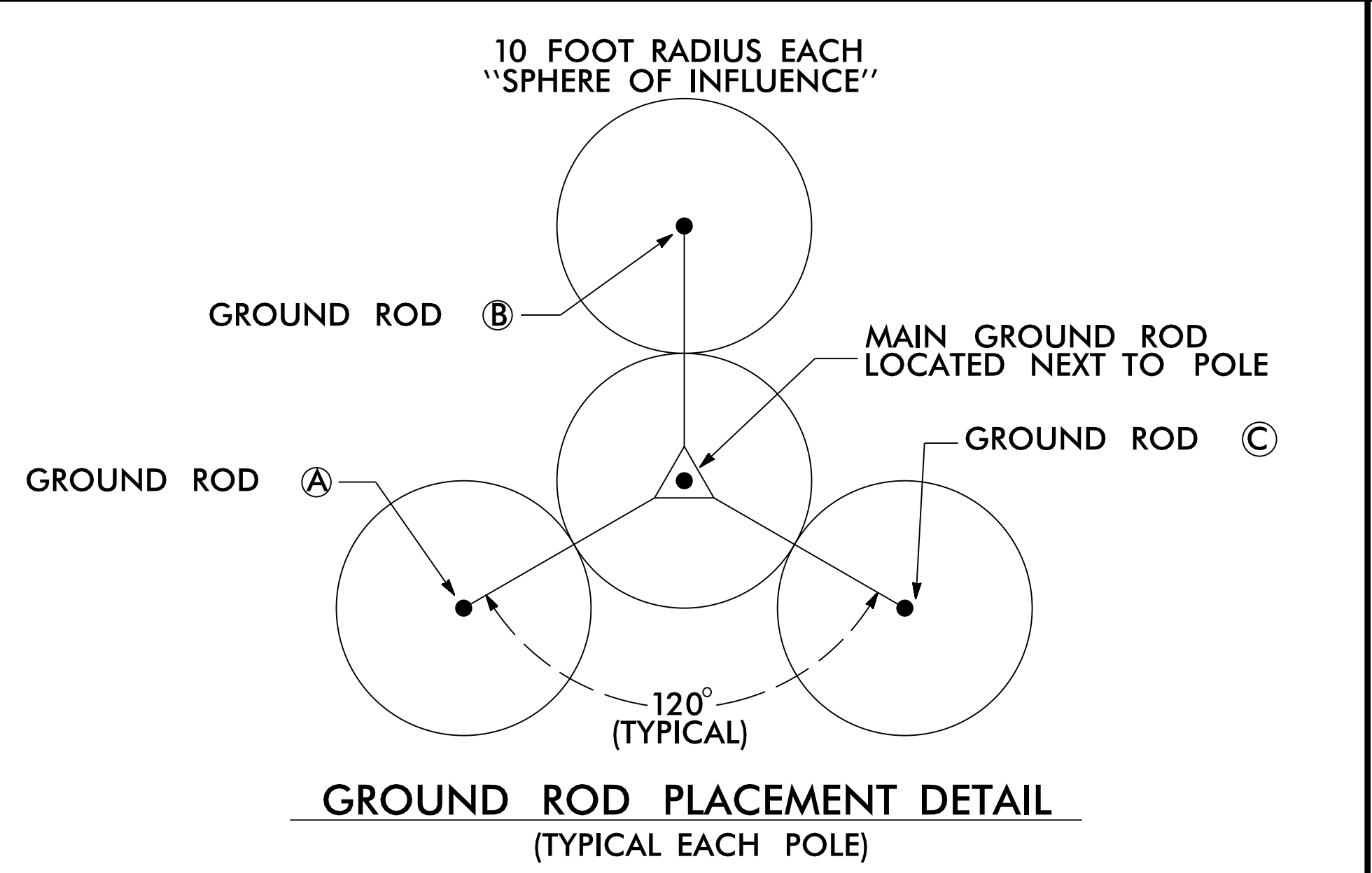

NOTES *DOCUMENT NOT CONSIDERED FINAL UNLESS ALL SIGNATURES COMPLETED*

1. BOND 0.5 INCH DIAMETER, 28 STRAND (MINIMUM) CLASS II COPPER CONDUCTOR TO THE MAIN GROUND ROD BY AN IRREVERSIBLE MECHANICAL CRIMP METHOD.
2. ALL CONNECTIONS TO GROUND RODS SHOULD BE MADE WITH AN IRREVERSIBLE MECHANICAL CRIMP METHOD.
3. BOND #4 AWG SOLID BARE COPPER WIRE TO REBAR CAGE AND THE MAIN GROUND ROD BY AN IRREVERSIBLE MECHANICAL CRIMP.
4. ENSURE CAMERA HOUSING, CAMERA, AND PAN -TILT UNIT ARE BONDED TO POLE.
5. REMOVE BONDING JUMPER BETWEEN EQUIPMENT CABINET GROUND BUSS AND NEUTRAL BUSS.
6. THE CONTRACTOR MAY, UPON APPROVAL OF THE ENGINEER, INSTALL A 30-FOOT SECTIONAL GROUND ROD WHEN CONDITIONS WILL NOT ALLOW FOR THE INSTALLATION OF THE 3 - RADIAL GROUND RODS.
7. INSTALL MARKER TAPE DIRECTLY ABOVE ALL GROUNDING ELECTRODES AND CONDUCTORS AT A DEPTH OF 12 INCHES.

	CCTV CAMERA INSTALLATION FOR METAL SIGNAL POLE TYPICAL DETAIL		SEAL
	PLAN DATE: FEBRUARY 2018 PREPARED BY: H. T. BERGGREN, EI	REVIEWED BY: <i>I. N. Avery</i> DATE: 1/20/17	2018 STANDARD SPECIFICATIONS UPGRADE TO IRREVERSIBLE MECHANICAL CRIMP
SCALE: 0 N/A N/A	REVISIONS:	DATE:	DATE: 3/5/2018