

TABLE OF OPERATION

SIGNAL FACE	PHASE										
	01+5	01+6	02+5	02+6	03+7	03+8	04+7	04+8	TRUCK	PEDESTRIAN	NEW LOOP
11	---	---	---	---	---	---	---	---	---	---	---
21,22	R	R	G	G	R	R	R	R	G	R	Y
31	---	---	---	---	---	---	---	---	---	---	---
41,42	R	R	R	R	R	R	G	G	G	R	R
51	---	---	---	---	---	---	---	---	---	---	---
61,62	R	G	R	G	R	R	R	R	G	R	Y
71	---	---	---	---	---	---	---	---	---	---	---
81,82	R	R	R	R	R	R	G	R	R	R	R
P21,P22	DW	DW	W	W	DW	DW	DW	DW	DW	DW	DRK
P41,P42	DW	DW	DW	DW	DW	W	W	DW	DW	DW	DRK
P61,P62	DW	W	DW	W	DW	DW	DW	DW	DW	DW	DRK
P81,P82	DW	DW	DW	DW	W	DW	W	DW	DW	DW	DRK

ASC/3 DETECTOR INSTALLATION CHART

LOOP	SIZE (FT)	DISTANCE FROM STOPBAR (FT)	TURNS	NEW LOOP	PROGRAMMING						
					PHASE	CALLING	EXTEND TIME	DELAY TIME	USE ADDED INITIAL	TYPE	SYSTEM LOOP
1A	6X40	0	*	-	1	Yes	-	15	-	S	-
2A	6X40	0	*	-	2	Yes	-	3	-	S	-
3A	6X40	0	*	-	3	Yes	-	15	-	S	-
4A	6X40	0	*	-	4	Yes	-	3	-	G	-
4B	6X40	0	*	-	4	Yes	-	10	-	S	-
5A	6X40	0	*	-	5	Yes	-	15	-	S	-
6A	6X40	0	*	-	6	Yes	-	3	-	S	-
7A	6X40	0	*	-	7	Yes	-	15	-	S	-
8A	6X40	0	*	-	8	Yes	-	-	-	S	-
8B	6X40	0	*	-	8	Yes	-	10	-	S	-

* Multizone Microwave Detection

8 Phase Fully Actuated W/ Railroad Preemption Greenville Signal System

NOTES

- Refer to "Roadway Standard Drawings NCDOT" dated January 2018 and "Standard Specifications for Roads and Structures" dated January 2018.
- This location contains railroad preemption phasing. Do not program signal for late night flashing operation.
- Set all detector units to presence mode.
- Omit "WALK" and flashing "DON'T WALK" with no pedestrian calls.
- Program pedestrian heads to countdown the flashing "Don't Walk" time only.
- Pedestrian pedestals are conceptual and shown for reference only. See sheets P1-P3 for pushbutton location details.
- Program parent phases for Overlap "P" for all phases used in normal operation.
- Maximum times shown in timing chart are for free-run operation only. Coordinated signal system timing values supersede these values.

SIGNAL FACE I.D.

All Heads L.E.D.

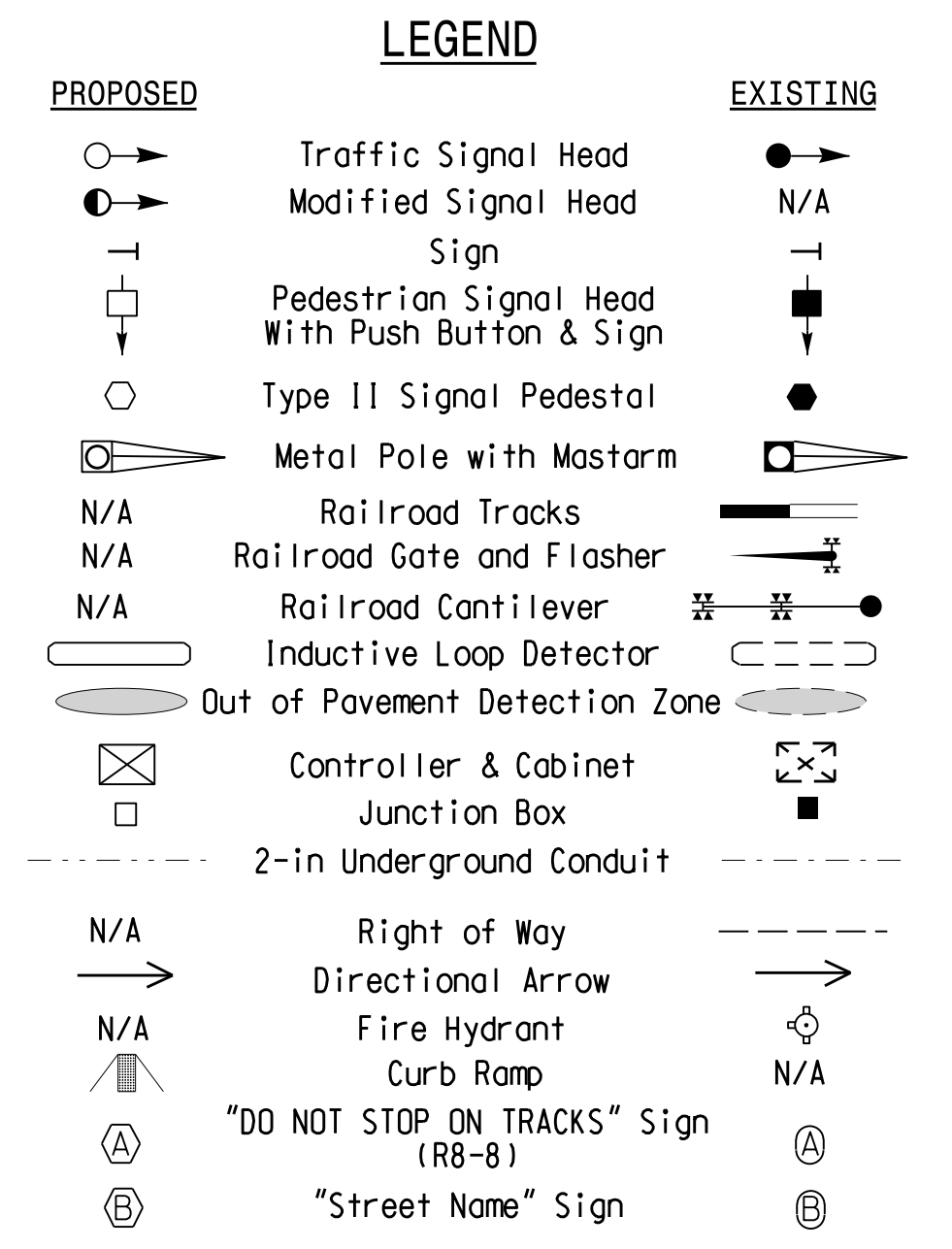
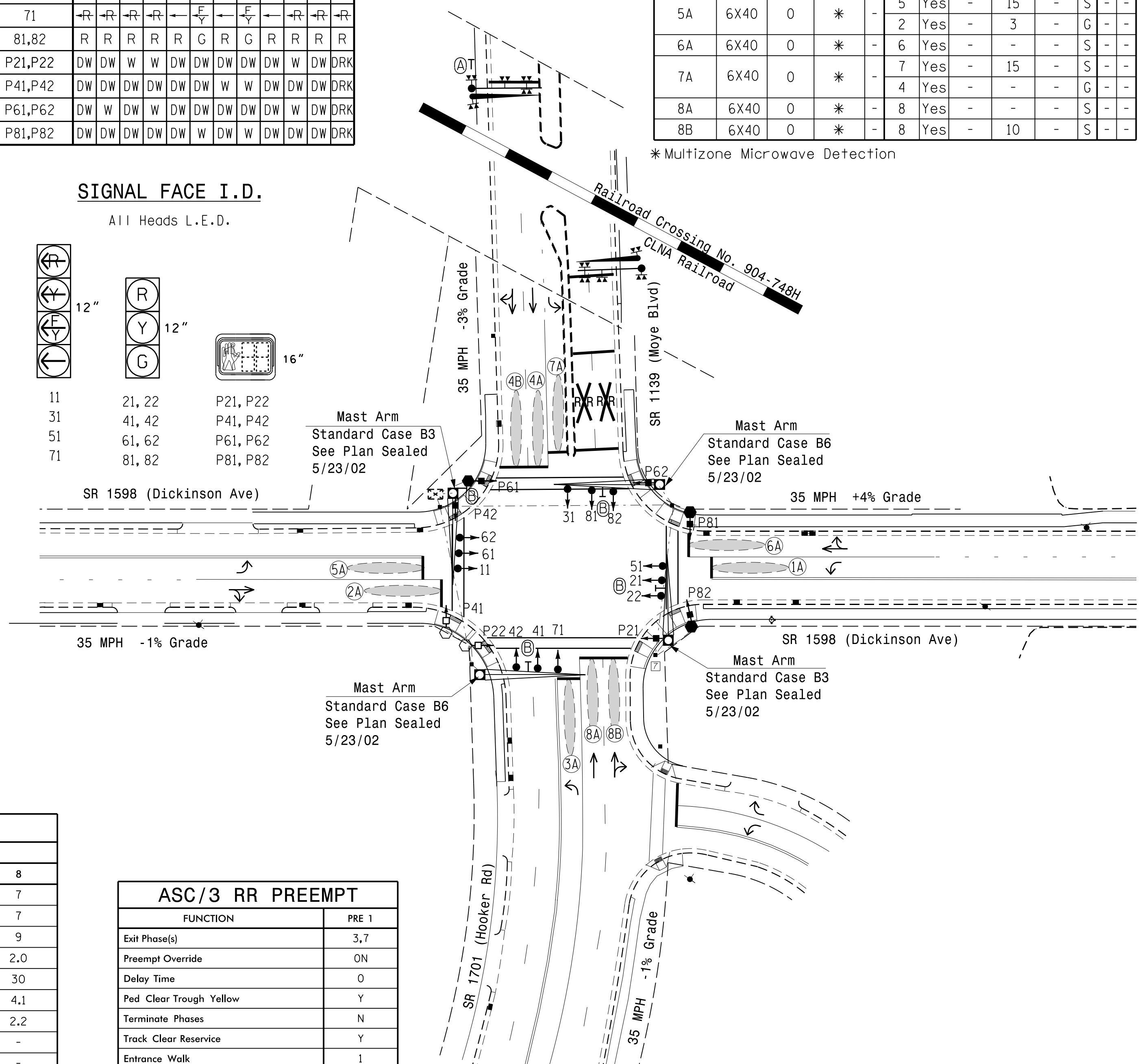
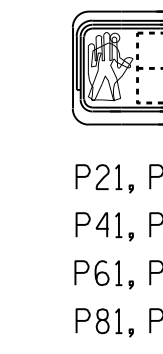
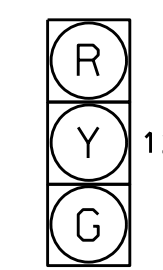
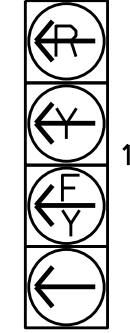

ASC/3 TIMING CHART

FEATURE	PHASE							
	1	2	3	4	5	6	7	8
Min Green *	7	10	7	7	7	10	7	7
Walk *	0	7	0	7	0	7	0	7
Ped Clear	0	19	0	11	0	17	0	9
Veh. Extension *	2.0	3.0	2.0	2.0	2.0	3.0	2.0	2.0
Max 1 *	20	35	20	30	20	35	20	30
Yellow	3.0	3.9	3.0	4.1	3.0	3.9	3.0	4.1
Red Clear	3.1	2.5	3.1	2.2	3.2	2.5	3.1	2.2
Actuations B4 Add *	-	-	-	-	-	-	-	-
Seconds / Actuation *	-	-	-	-	-	-	-	-
Max Initial *	-	-	-	-	-	-	-	-
Time Before Reduction *	-	-	-	-	-	-	-	-
Time To Reduce *	-	-	-	-	-	-	-	-
Minimum Gap	-	-	-	-	-	-	-	-
Locking Detector	-	X	-	-	-	X	-	-
Recall Position	-	VEH. RECALL	-	-	-	VEH. RECALL	-	-
Dual Entry	-	-	-	X	-	-	-	X
Simultaneous Gap	X	X	X	X	X	X	X	X

* These values may be field adjusted. Do not adjust Min Green and Extension times for phases 2 and 6 lower than what is shown. Min Green for all other phases should not be lower than 4 seconds.

ASC/3 RR PREEMPT

FUNCTION	PRE 1
Exit Phase(s)	3,7
Preempt Override	ON
Delay Time	0
Ped Clear Trough Yellow	Y
Terminate Phases	N
Track Clear Reserve	Y
Entrance Walk	1
Entrance Ped Clear	3
Entrance Min Green	1
Entrance Yellow Change	25.5*
Entrance Red Clear	25.5*
Track Clear Min Green	24
Track Clear Yellow Change	25.5*
Track Clear Red Clear	25.5*
Min Dwell Time	7
Exit Yellow Change	25.5*
Exit Red Clear	25.5*

* Allows normal phase times to be used.

Signal Upgrade - Final

SR 1598 (Dickinson Avenue) at SR 1701 (Hooker Rd) / SR 1709 (Moye Boulevard)

Division 2 Pitt County Greenville

PLAN DATE: November 2021 PREPARED BY: MEL REVIEWED BY: MEL

750 N. Greenfield Pkwy, Garner, NC 27529

SCALE 0 40 1"=40'

DOCUMENT NOT CONSIDERED FINAL UNLESS ALL SIGNATURES COMPLETED

SEAL

MECHAN E. WELLS, INC. ENGINEER

11/16/2021 DATE

SIG. INVENTORY NO. 02-0004

01-DEC-2021 11:14 AM W:\2020\04\19_1598_20211116_Final.dgn mel/bb/01c