

DETOUR ROUTE USED DURING CONSTRUCTION OF SECTION 6

* NOTE: REFER TO SHEET TMP-4, INSET A, FOR WESTBOUND DICKINSON AVE DETOUR ROUTE AND ASSOCIATED SIGNAGE PLACEMENT

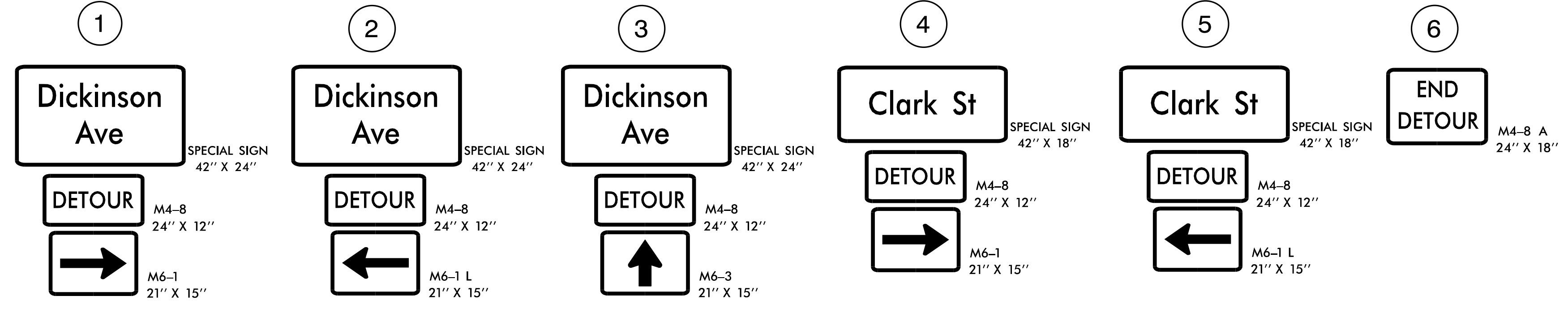
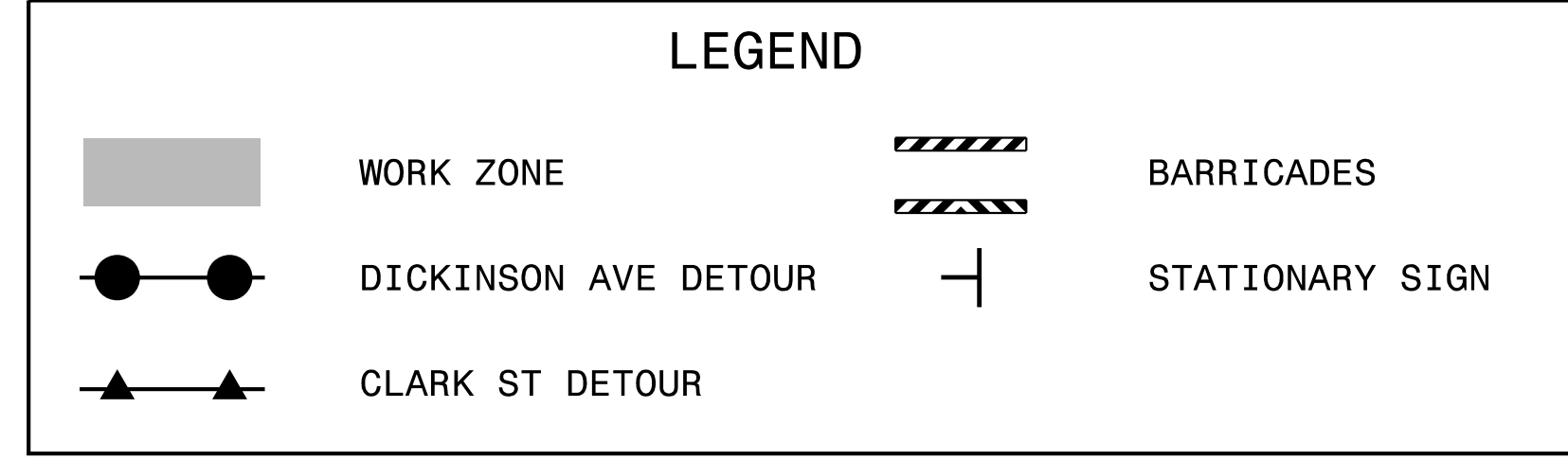
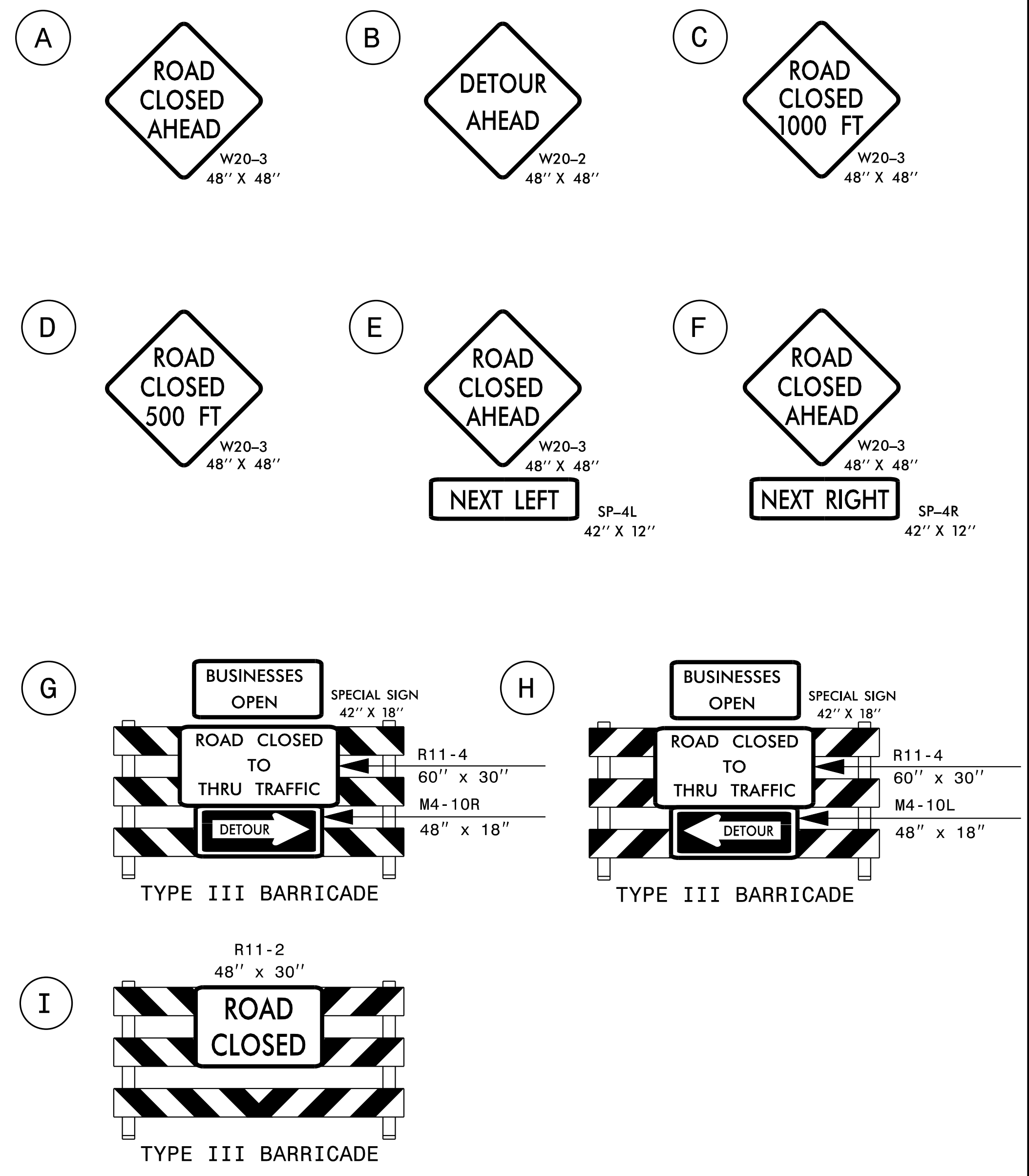

K:\RAL_Roadway\01036243 - U-5606 Dickinson Avenue\TrafficControl\TCPU-5606_TC_TMP_14_Def566.dgn 1/17/2022

Kimley»Horn

APPROVED: *Evan Parrott*
DATE: 1/17/2022
SEAL

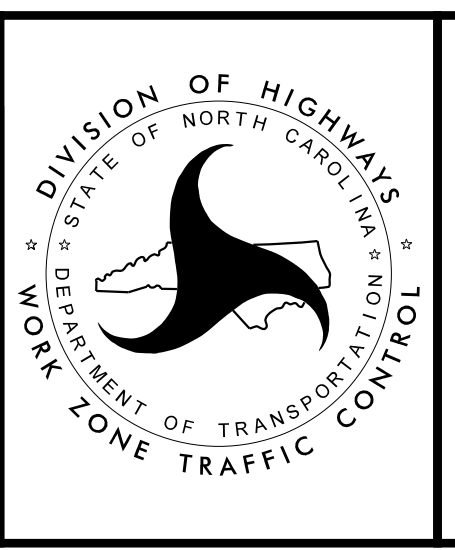

SECTION 6
DETOUR

DOCUMENT NOT CONSIDERED FINAL UNLESS ALL SIGNATURES COMPLETED