

LOCAL DETOUR ROUTE USED DURING CONSTRUCTION OF SECTION 1

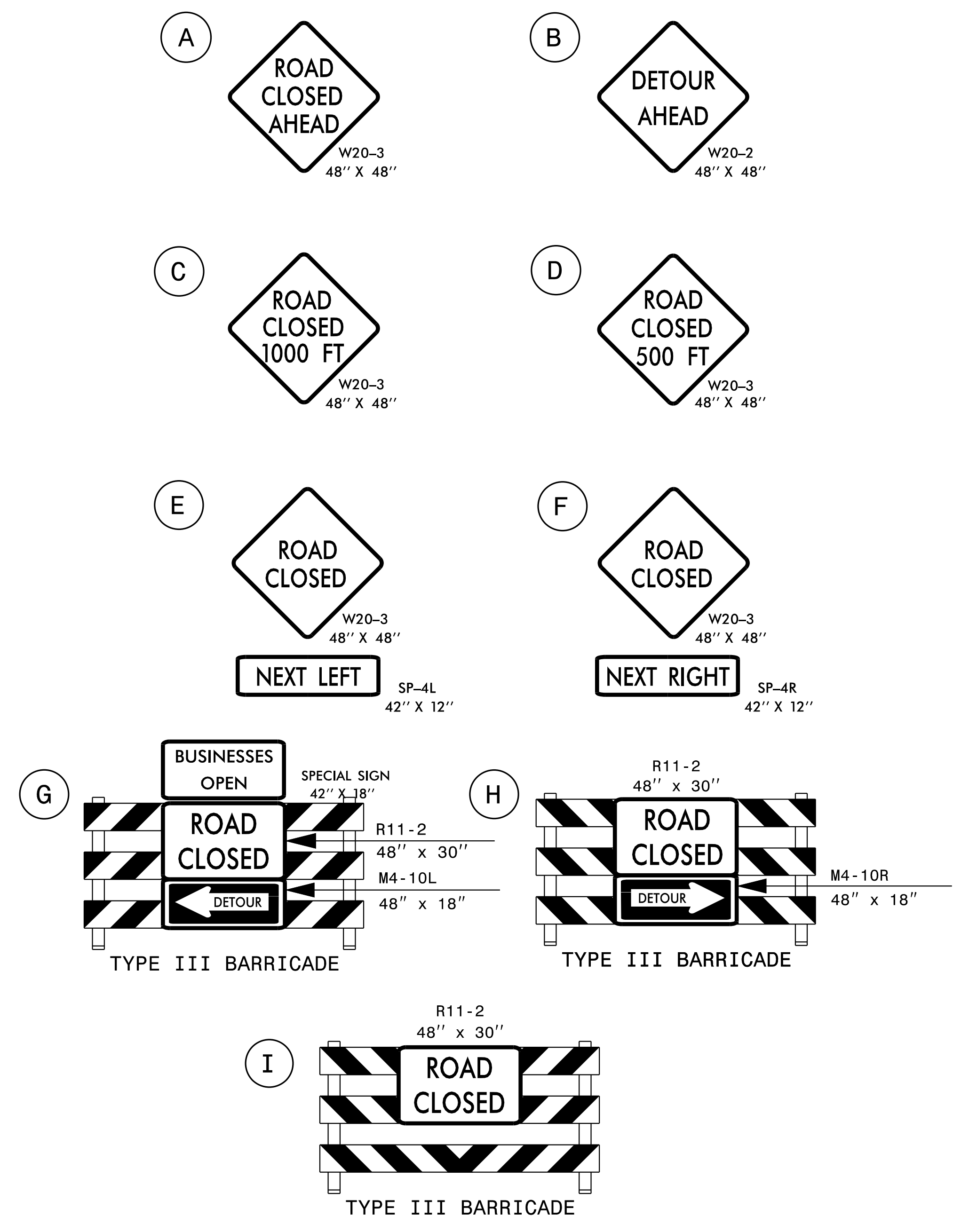

LEGEND

- WORK ZONE
- DETOUR ROUTE
- BARRICADES
- STATIONARY SIGN

1 Dickinson Ave
SPECIAL SIGN 42" X 24"
DETOUR M4-8 24" X 12"
M6-1 21" X 15"

2 Dickinson Ave
SPECIAL SIGN 42" X 24"
DETOUR M4-8 24" X 12"
M6-1 L 21" X 15"

3 Dickinson Ave
SPECIAL SIGN 42" X 24"
DETOUR M4-8 24" X 12"
M6-3 21" X 15"

4 END DETOUR
M4-8 A 24" X 18"

* NOTE: REFER TO SHEET TMP-4 FOR THRU-TRAFFIC DETOUR ROUTE AND ASSOCIATED SIGNAGE PLACEMENT
 ** NOTE: DRUM OFF LEFT TURN LANE TO DICKINSON AVE.

K:\RAL_Roadway\01036243 - U-5606 Dickinson Avenue\TrafficControl\TCP-U-5606_TC_TMP-6_DetSec1.dgn 1/17/2022



APPROVED: <i>Evan Parrott</i> DATE: 1/17/2022 SEAL DOCUMENT NOT CONSIDERED FINAL UNLESS ALL SIGNATURES COMPLETED			<p>SECTION 1 LOCAL TRAFFIC DETOUR</p>
---------------------------------------------------------------------------------------------------------------------------	--	--	------------------------------------------------------