

- NOTES:**
- TIE TO EXIST CURB AND GUTTER AT EXIST CONCRETE JOINT TRANSITION 2'-6" C&G TO MATCH EXIST GUTTER WIDTH AS NECESSARY
 - LIMITS OF PAVEMENT REMOVAL AND REPLACEMENT
 - ADJUSTMENT OF MANHOLE
 - ADJUSTMENT OF METER OR VALVE BOX
 - REMOVE AND STOCKPILE EXISTING GRANITE CURB
 - RETAIN EXISTING MAST ARM
 - SAWCUT A NEAT EDGE LINE AND REMOVE EXIST PARKING LOT PAVEMENT

2022 ADT	-Y2- MOYE BOULEVARD (SR 1139)		10920	
2042 ADT			12120	
	640	1550	13460	
	10830	12130	2050	15060
	1250	3070		
	1750	3770		
	-Y2- HOOKER ROAD		13050	
			14550	

-L-
 PI Sta 22+35.26
 $\Delta = 3' 21'' 08.7''$ (LT)
 $D = 1' 38'' 13.3''$
 $L = 204.79'$
 $T = 102.42'$
 $R = 3,500.00'$
 SE = SEE PLANS
 RO = SEE PLANS

-Y2-
 PI Sta 13+76.05
 $\Delta = 22' 00'' 37.0''$ (RT)
 $D = 1' 27'' 33.0''$
 $L = 192.08'$
 $T = 97.24'$
 $R = 500.00'$
 SE = EXISTING
 RO = EXISTING

Kimley Horn
 421 FAYETTEVILLE STREET, SUITE 600
 RALEIGH, NC 27601

PROJECT REFERENCE NO. U-5606	SHEET NO. 5
ROADWAY DESIGN ENGINEER	HYDRAULICS ENGINEER
SEAL 024436 1/17/2022 J. FREY W. MOORE	SEAL 038668 1/17/2022 WANCE W. BLANTON
DOCUMENT NOT CONSIDERED FINAL UNLESS ALL SIGNATURES COMPLETED	

HOME BUILDER & SUPPLY COMPANY
 DB 3289 PG 248
 FKA MARJORIE CLARK
 WEATHERS HEIRS
 DB 125 PG 294

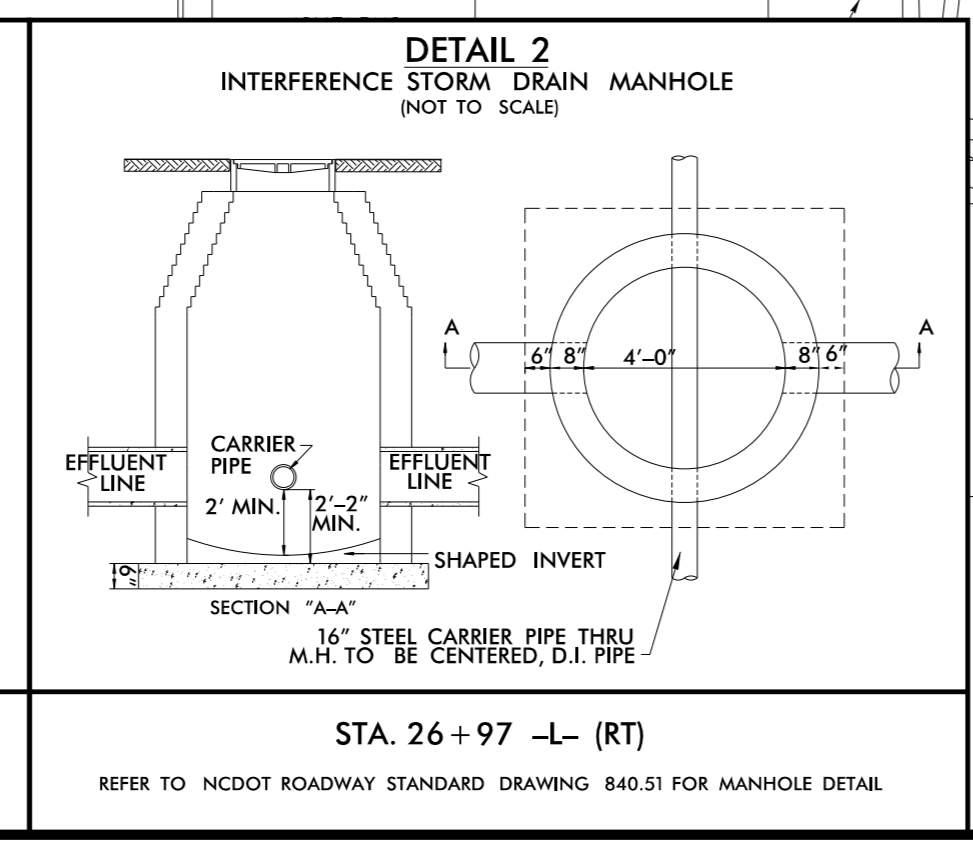
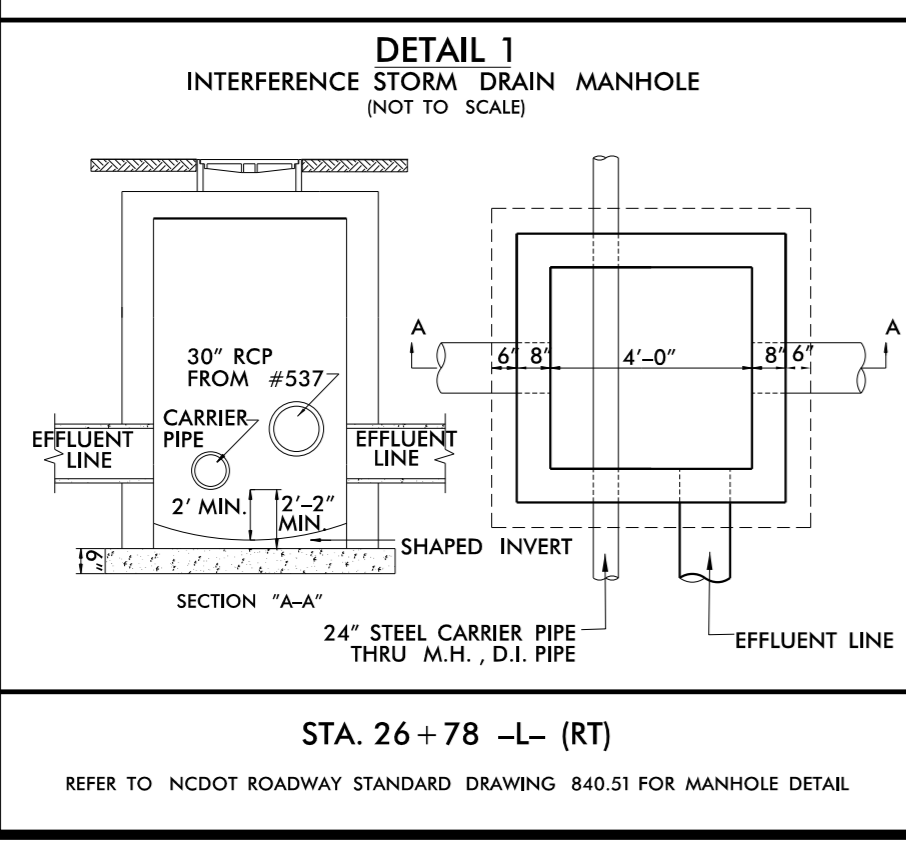
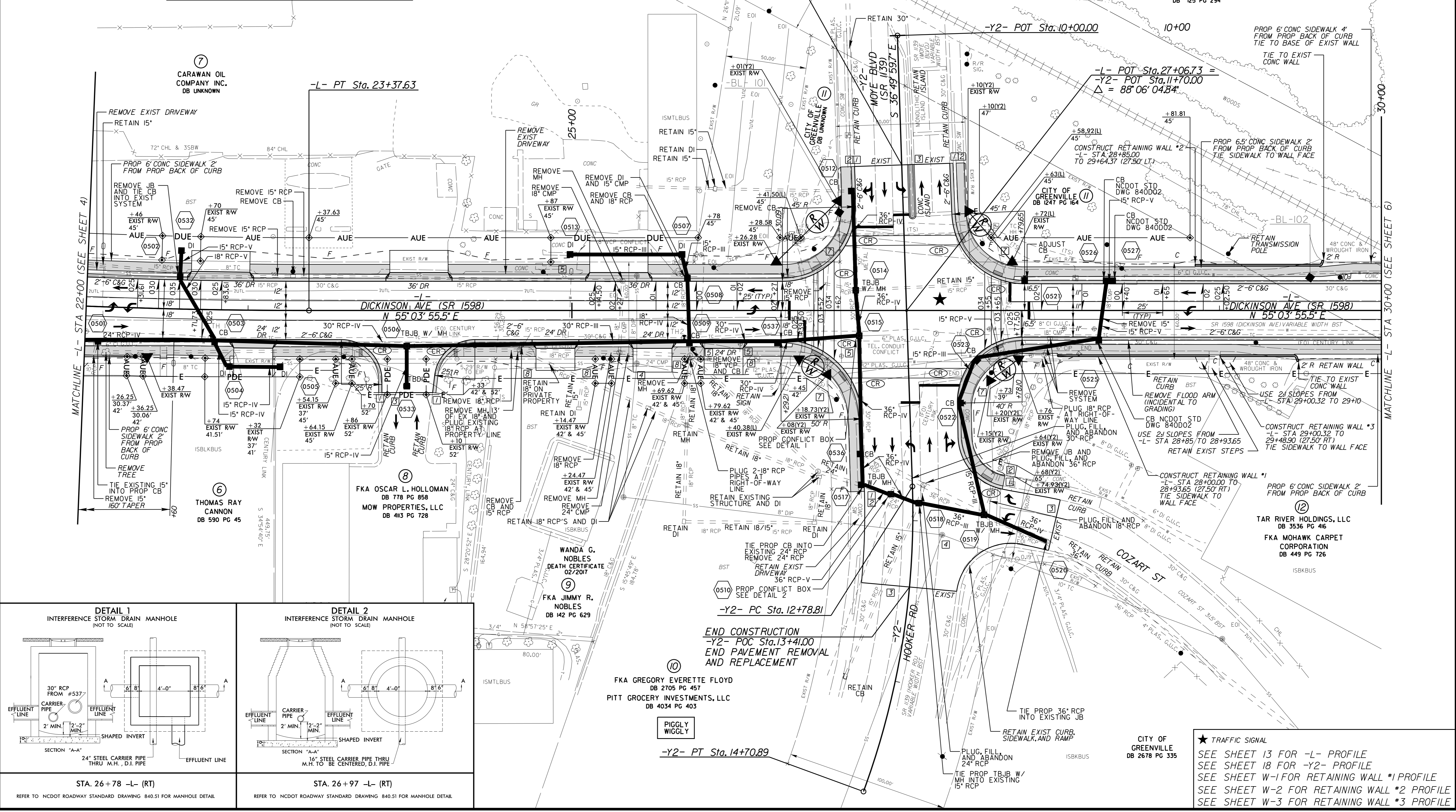

END CONSTRUCTION
 -Y2- PC Sta. 13+41.00
 END PAVEMENT REMOVAL AND REPLACEMENT

FKA GREGORY EVERETTE FLOYD
 DB 2705 PG 457
 PITT GROCERY INVESTMENTS, LLC
 DB 4034 PG 403

PIGGY WIGGLY

-Y2- PT Sta. 14+70.89

★ TRAFFIC SIGNAL
 SEE SHEET 13 FOR -L- PROFILE
 SEE SHEET 18 FOR -Y2- PROFILE
 SEE SHEET W-1 FOR RETAINING WALL #1 PROFILE
 SEE SHEET W-2 FOR RETAINING WALL #2 PROFILE
 SEE SHEET W-3 FOR RETAINING WALL #3 PROFILE

REVISIONS

K:\VAL_Roadway\01036243 - U-5606 Dickinson Avenue Roadway Proj\U5606_rdy_pst05.dgn

1/17/2022