

| | |
|--------------------|--------------------|
| TIP NO. BR-0033 | SHEET NO. PMP-2 |
| APPROVED: _____ | |
| DATE: _____ | |
| SEAL | |
| | |

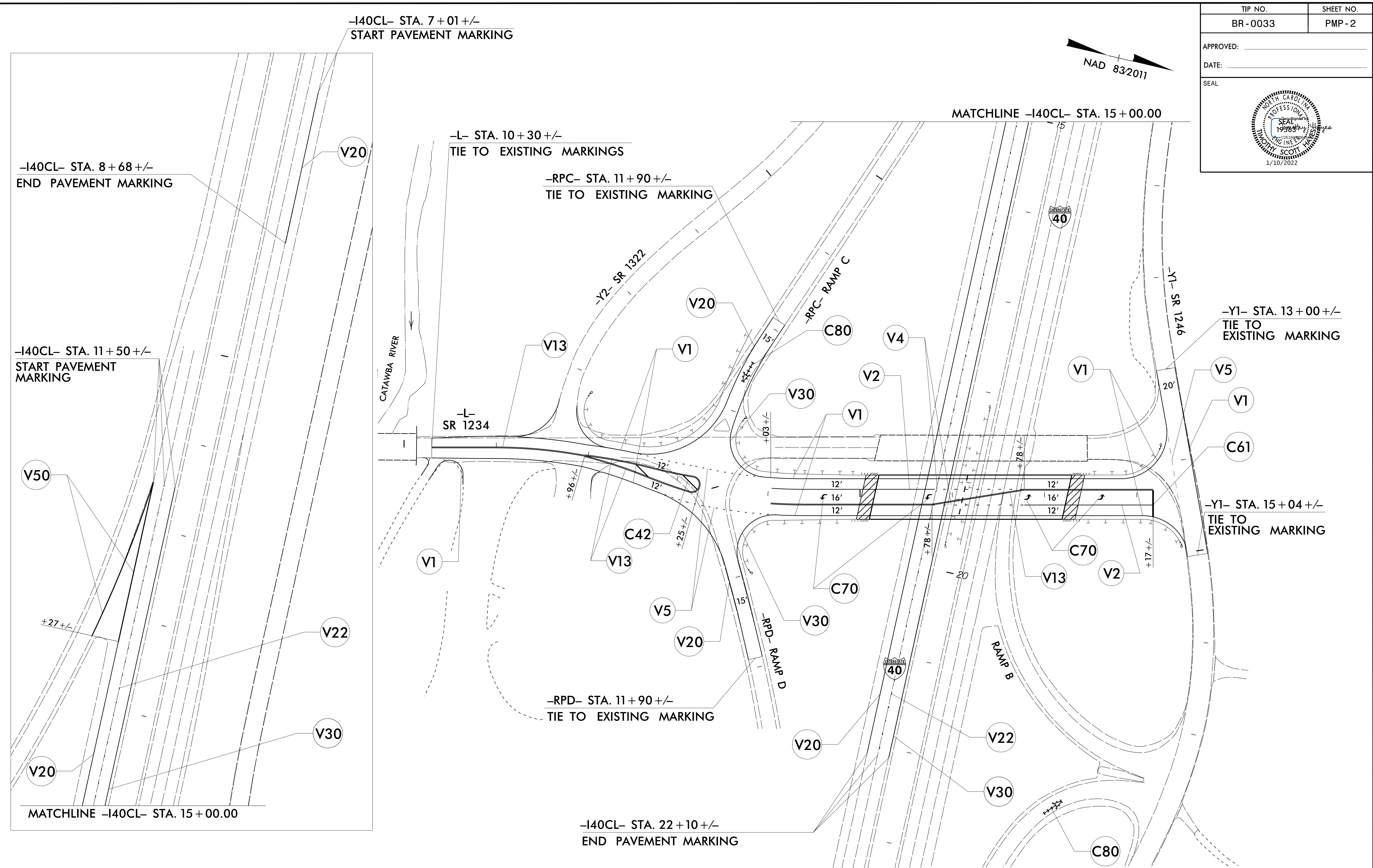

-140CL- STA. 8+68 +/-
END PAVEMENT MARKING

-140CL- STA. 11+50 +/-
START PAVEMENT MARKING

-140CL- STA. 7+01 +/-
START PAVEMENT MARKING

-L- STA. 10+30 +/-
TIE TO EXISTING MARKINGS

-RPC- STA. 11+90 +/-
TIE TO EXISTING MARKING

-RPD- STA. 11+90 +/-
TIE TO EXISTING MARKING

MATCHLINE -140CL- STA. 15+00.00

-Y1- STA. 13+00 +/-
TIE TO EXISTING MARKING

-Y1- STA. 15+04 +/-
TIE TO EXISTING MARKING

-140CL- STA. 22+10 +/-
END PAVEMENT MARKING

MATCHLINE -140CL- STA. 15+00.00

INDEX

**PAVEMENT MARKING DETAIL
AND SCHEDULE**

13-DEC-2021 10:54
 R:\Traffic\BR0033_PMP_2.dgn
 Fbarham