

SURVEY CONTROL SHEET

W/EXISTING CENTERLINE ALIGNMENTS PRIOR TO CONSTRUCTION

6/2/09

REVISIONS

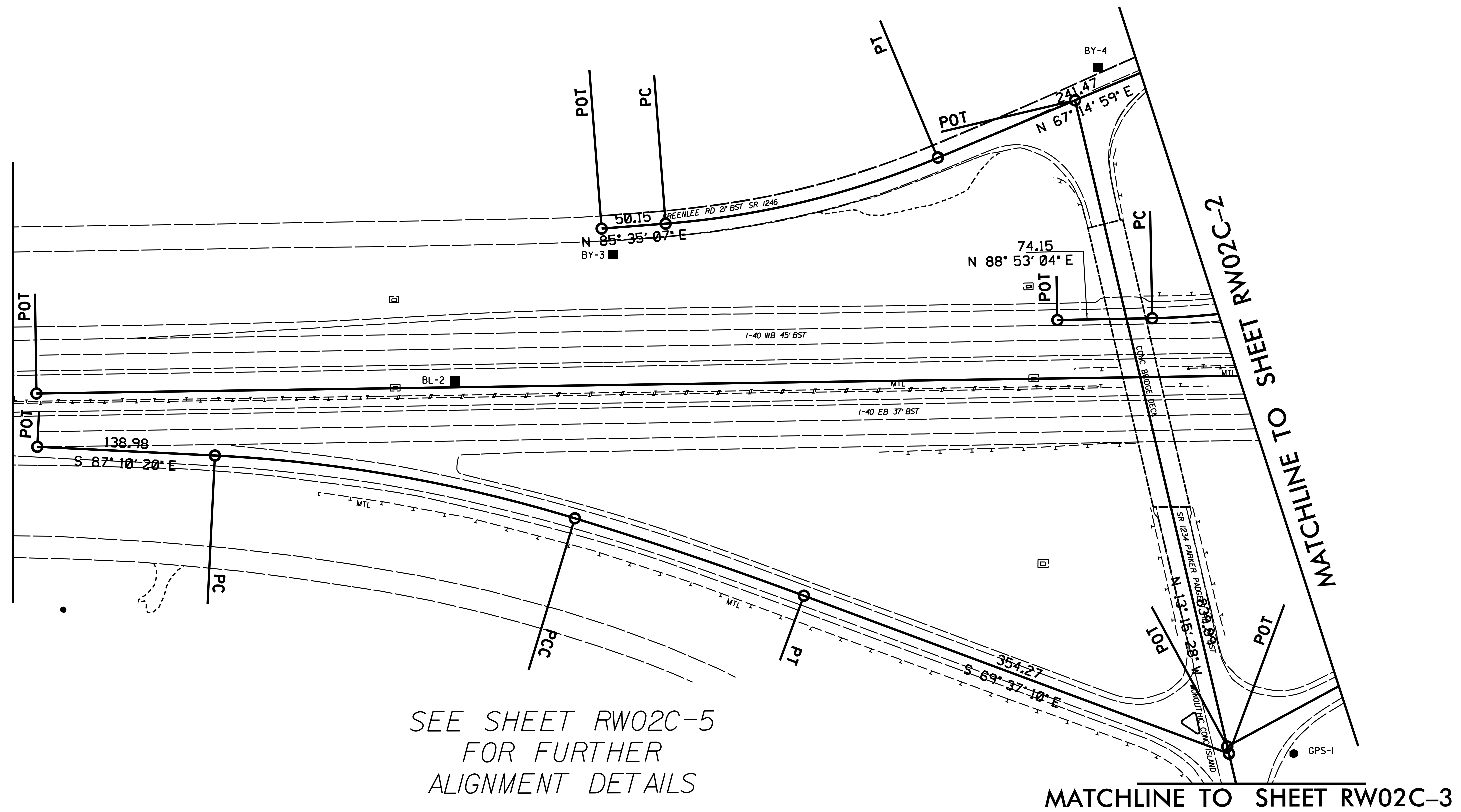

NOTES:

- PROJECT CONTROL WAS ESTABLISHED USING GNSS, THE GLOBAL NAVIGATION SATELLITE SYSTEM.
- THE SURVEY CONTROL DATA FOR THIS PROJECT HAS BEEN COMPILED FROM VARIOUS SOURCES. IF FURTHER INFORMATION REGARDING PROJECT CONTROL IS NEEDED, PLEASE CONTACT THE LOCATION AND SURVEYS UNIT.

1: SCALE
 2: DATE
 3: DRAWN
 4: CHECKED
 5: APPROVED
 6: 6/2/09
 7: 09
 8: 09
 9: 09
 10: 09
 11: 09
 12: 09
 13: 09
 14: 09
 15: 09
 16: 09
 17: 09
 18: 09
 19: 09
 20: 09
 21: 09
 22: 09
 23: 09
 24: 09
 25: 09
 26: 09
 27: 09
 28: 09
 29: 09
 30: 09
 31: 09
 32: 09
 33: 09
 34: 09
 35: 09
 36: 09
 37: 09
 38: 09
 39: 09
 40: 09
 41: 09
 42: 09
 43: 09
 44: 09
 45: 09
 46: 09
 47: 09
 48: 09
 49: 09
 50: 09