

ADDED PNG DESIGNS 01/18/20
 ADDED PUE DESIGNS 01/18/20
 ADDED SEGRA DESIGNS 01/20/20
 ADDED CHARTER DESIGNS 01/21/20
 ADDED UPDATED PUE 2/24/20
 ADDED PWC ELECTRIC DESIGN 3/3/20
 UPDATED PUE 3/24/20
 UPDATED PWC WATER/SEWER DESIGNS 2/26/21
 UPDATED PWC DESIGN 5/19/21
 UPDATED CENTURYLINK DESIGN 6/9/21
 UPDATED CHARTER DESIGN 7/5/21
 UPDATED PWC WATER/SEWER DESIGN 7/8/21
 UPDATED SEGRA DESIGN 8/20/21
 UPDATED PWC WATER/SEWER DESIGN 10/8/21
 UPDATED PWC WATER/SEWER DESIGN 10/26/21

UTILITY 31930-21 U5798A UTILITIES UTILITY COORDINATION U5798A UTILITY PSH4 U04.DGN

UTILITIES BY OTHERS

ALL PROPOSED UTILITY WORK SHOWN ON THIS SHEET WILL BE DONE BY OTHERS. NO PAYMENT WILL BE MADE TO THE CONTRACTOR FOR PROPOSED UTILITY WORK SHOWN ON THIS SHEET.

0401 TOP = 222.35' INV IN = 219.35' INV OUT = 219.35'	0407 TOP = 222.95' INV IN = 217.60' INV OUT = 217.50'
0402 TOP = 223.62' INV IN = 220.10' INV OUT = 220.00'	0408 TOP = 222.69' INV IN = 216.90' INV OUT = 216.80'
0403 TOP = 222.66' INV IN = 219.76' INV OUT = 219.66'	0409 INV IN = 217.86' INV OUT = 217.60'
0404 TOP = 222.95' INV IN = 219.20' INV OUT = 219.10'	0411 TOP = 224.02' INV OUT = 220.85'
0405 TOP = 222.56' INV IN = 218.80' INV OUT = 218.70'	
0406 TOP = 222.88' INV IN = 218.10' INV OUT = 218.00'	

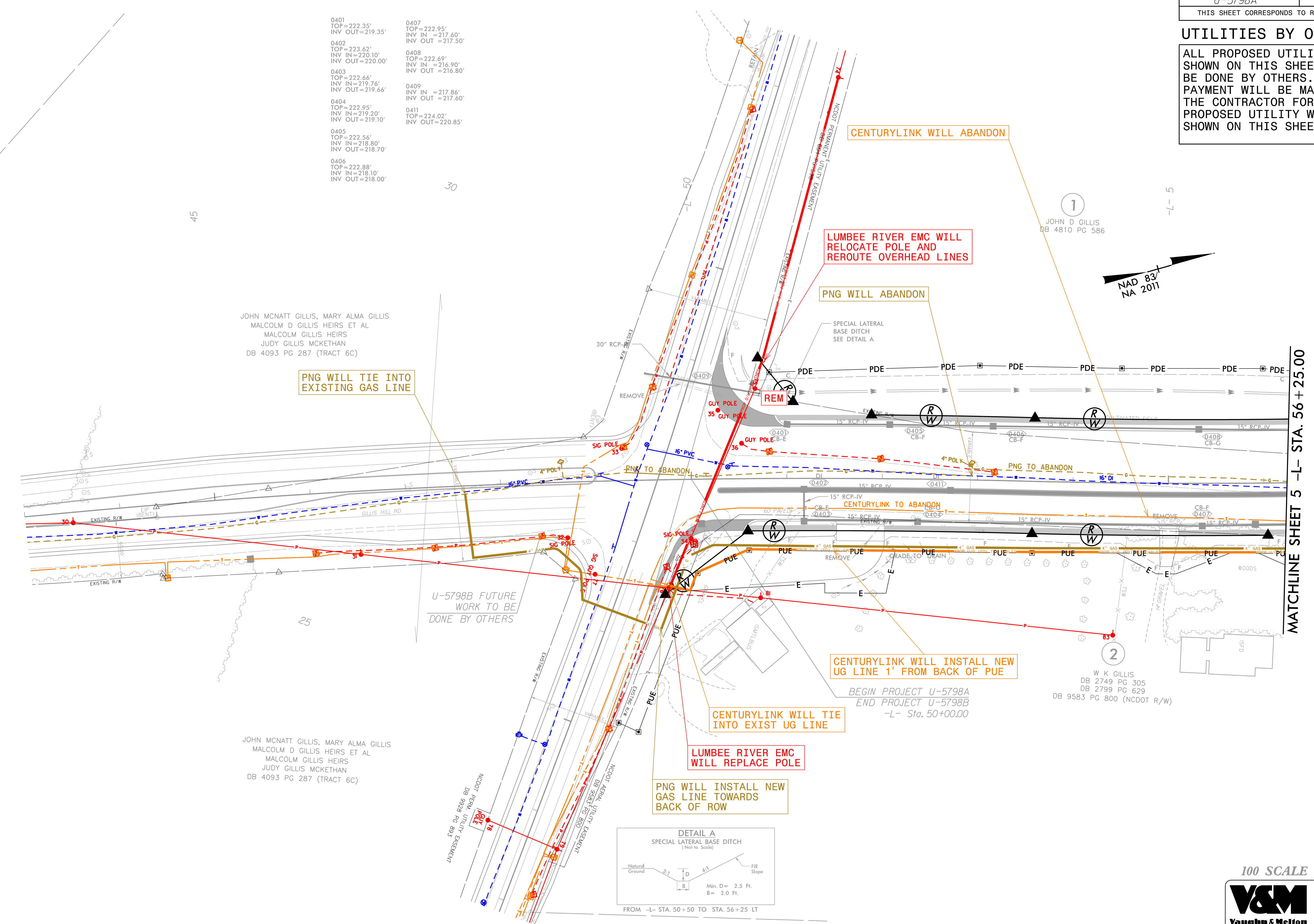

JOHN MCNATT GILLIS, MARY ALMA GILLIS
 MALCOLM D GILLIS HEIRS ET AL
 MALCOLM GILLIS HEIRS
 JUDY GILLIS MCKETHAN
 DB 4093 PG 287 (TRACT 6C)

JOHN MCNATT GILLIS, MARY ALMA GILLIS
 MALCOLM D GILLIS HEIRS ET AL
 MALCOLM GILLIS HEIRS
 JUDY GILLIS MCKETHAN
 DB 4093 PG 287 (TRACT 6C)

1
 JOHN D GILLIS
 DB 4810 PG 586

2
 W K GILLIS
 DB 2749 PG 305
 DB 2799 PG 629
 DB 9583 PG 800 (NCDOT R/W)

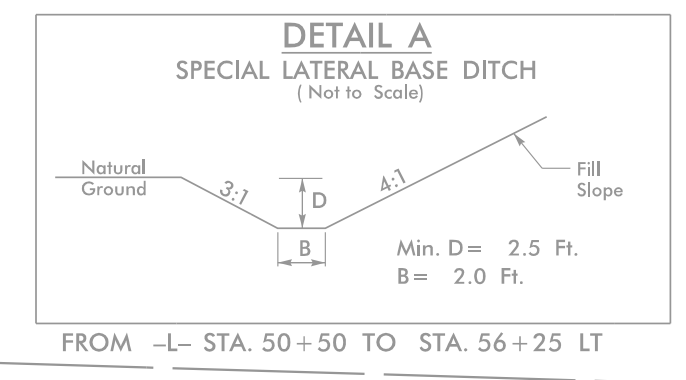
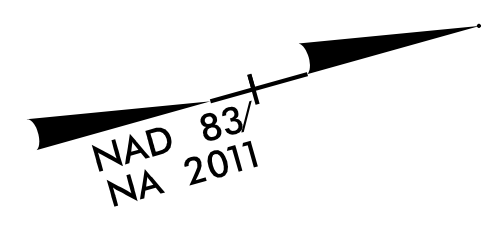

MATCHLINE SHEET 5 -L- STA. 56 + 25.00

100 SCALE 11X17

Charlotte, North Carolina 704-551-0568
 Tri-Cities, Tennessee 423-461-8400
 Knoxville, Tennessee 865-546-5800
 Asheville, North Carolina 828-253-2196
 Middlesboro, Kentucky 606-248-6500
 Spartanburg, South Carolina 864-574-4775

Copyright © 2006 Vaughn & Melton, Inc. All Rights Reserved.



UTILITIES BY OTHERS

ALL PROPOSED UTILITY WORK SHOWN ON THIS SHEET WILL BE DONE BY OTHERS. NO PAYMENT WILL BE MADE TO THE CONTRACTOR FOR PROPOSED UTILITY WORK SHOWN ON THIS SHEET.

ADDED SEGRA DESIGNS 01/28/20
 ADDED CHARTER DESIGNS 01/29/20
 ADDED UPDATED PUE 2/24/20
 ADDED PWC ELECTRIC DESIGN 3/3/20
 UPDATED PUE 3/24/20
 UPDATED PUE 3/24/20
 UPDATED PWC WATER/SEWER DESIGNS 2/26/21
 UPDATED PNG DESIGN 5/19/21
 UPDATED CENTURYLINK DESIGN 5/21/21
 UPDATED CENTURYLINK DESIGN 5/21/21
 UPDATED PWC WATER/SEWER DESIGN 7/8/21
 UPDATED PWC WATER/SEWER DESIGN 7/8/21
 UPDATED SEGRA DESIGN 8/20/21
 UPDATED PWC WATER/SEWER DESIGN 10/8/21
 UPDATED PWC WATER/SEWER DESIGN 10/26/21
 UPDATED ROW 12/30/21
 UPDATED ROW 2/22/22

M D GILLIS C/O JUDY GILLIS DIBACCO DB 2584 PG 0783
 M D GILLIS C/O JUDY GILLIS DIBACCO DB 2584 PG 0783
 M D GILLIS C/O JUDY GILLIS DIBACCO DB 2584 PG 0783
 JOHN D GILLIS DB 5280 PG 386 PB 51 PG 32
 JOHN MCN GILLIS JR ET AL DB 2899 PG 463
 DOUGLAS KEITH MILLER & WIFE KATHRYN GILLIS DB 4227 PG 487

UTILITY 31930-21 U5798A UTILITIES UTILITY COORDINATION U5798A UTILITY PSHE 1065.DGN

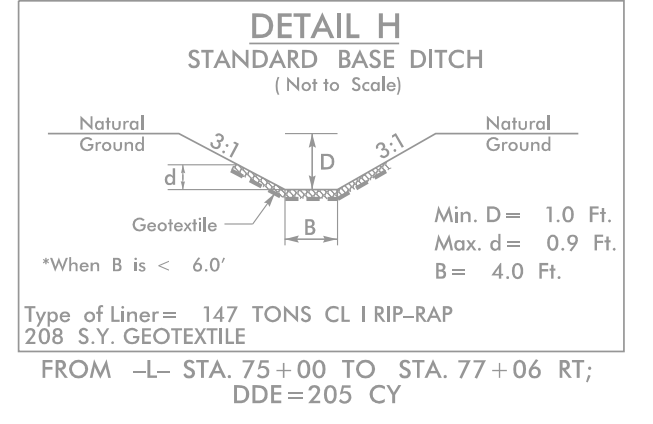
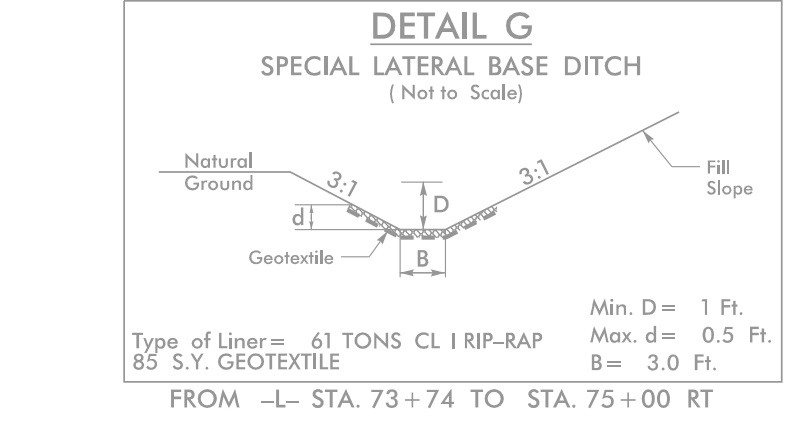
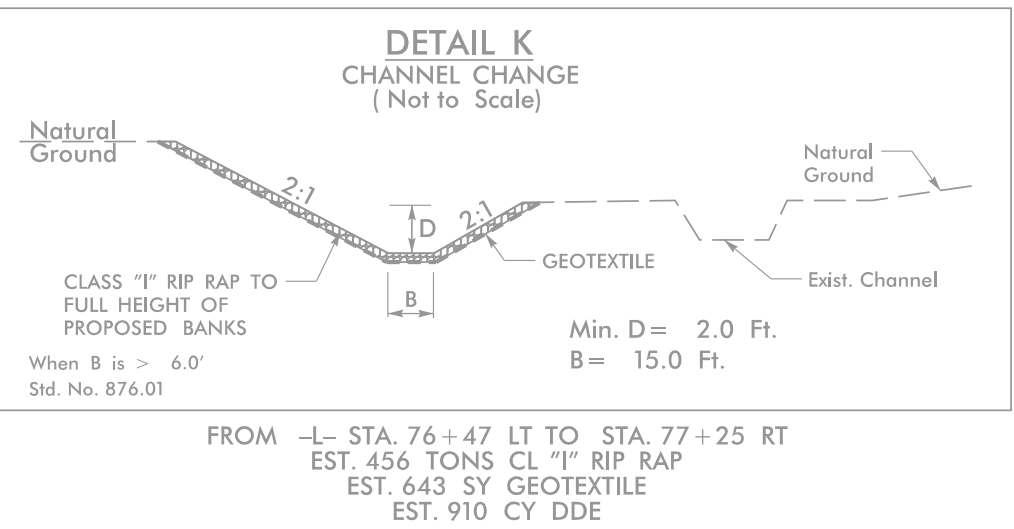
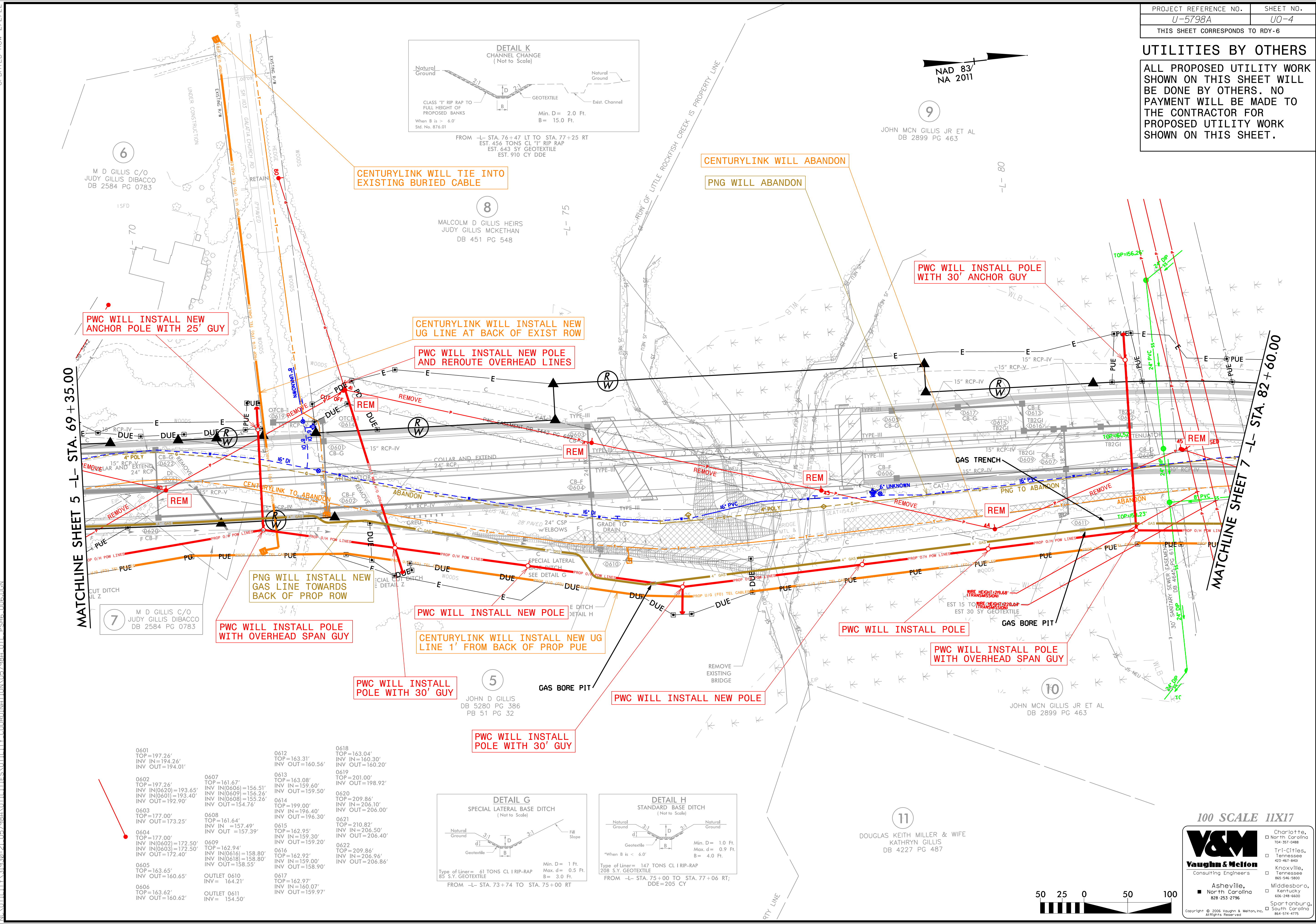

PWC WILL INSTALL NEW ANCHOR POLE WITH 25' GUY

CENTURYLINK WILL TIE INTO EXISTING BURIED CABLE

CENTURYLINK WILL ABANDON
 PNG WILL ABANDON

PWC WILL INSTALL POLE WITH 30' ANCHOR GUY

CENTURYLINK WILL INSTALL NEW UG LINE AT BACK OF EXIST ROW

PWC WILL INSTALL NEW POLE AND REROUTE OVERHEAD LINES

MATCHLINE SHEET 5 -L- STA. 69 + 35.00

MATCHLINE SHEET 7 -L- STA. 82 + 60.00

0601 TOP=197.26' INV IN=194.26' INV OUT=194.01'	0607 TOP=161.67' INV IN(0606)=156.51' INV IN(0609)=156.26' INV IN(0608)=155.26' INV OUT=154.76'	0613 TOP=163.08' INV IN=159.60' INV OUT=159.50'	0619 TOP=201.00' INV IN=198.92'
0602 TOP=197.26' INV IN(0620)=193.65' INV IN(0601)=193.40' INV OUT=192.90'	0608 TOP=161.64' INV IN=157.49' INV OUT=157.39'	0614 TOP=199.00' INV IN=196.40' INV OUT=196.30'	0620 TOP=209.86' INV IN=206.10' INV OUT=206.00'
0603 TOP=177.00' INV OUT=173.25'	0609 TOP=162.94' INV IN(0616)=158.80' INV IN(0603)=172.50' INV OUT=172.40'	0615 TOP=162.92' INV IN=159.30' INV OUT=159.20'	0621 TOP=210.82' INV IN=206.50' INV OUT=206.40'
0604 TOP=177.00' INV IN(0602)=172.50' INV IN(0603)=172.50' INV OUT=172.40'	0616 TOP=209.86' INV IN=159.90' INV OUT=158.55'	0617 TOP=162.97' INV IN=160.07' INV OUT=159.97'	0622 TOP=209.86' INV IN=206.96' INV OUT=206.86'
0605 TOP=163.65' INV OUT=160.65'	OUTLET 0610 INV= 164.21'	0618 TOP=163.04' INV IN=160.30' INV OUT=160.20'	
0606 TOP=163.62' INV OUT=160.62'	OUTLET 0611 INV= 154.50'	0619 TOP=201.00' INV IN=198.92'	



100 SCALE 11X17

V&M
Vaughn & Melton
Consulting Engineers

Charlotte, North Carolina 704-531-0988
 Tri-Cities, Tennessee 423-461-8400
 Knoxville, Tennessee 865-546-5800
 Middlesboro, Kentucky 606-248-6600
 Spartanburg, South Carolina 864-514-4715

Asheville, North Carolina 828-253-2196

Copyright © 2006 Vaughn & Melton, Inc. All Rights Reserved.

UTILITIES BY OTHERS

ALL PROPOSED UTILITY WORK SHOWN ON THIS SHEET WILL BE DONE BY OTHERS. NO PAYMENT WILL BE MADE TO THE CONTRACTOR FOR PROPOSED UTILITY WORK SHOWN ON THIS SHEET.

ADDED PNG DESIGNS 01/18/20
 ADDED PWC PUE DESIGNS 01/18/20
 ADDED SEGRA DESIGNS 01/20/20
 ADDED CHARTER DESIGNS 01/21/20
 ADDED UPDATED PUE 2/24/20
 ADDED PWC ELECTRIC DESIGN 3/3/20
 UPDATED PUE 3/24/20
 UPDATED PWC WATER/SEWER DESIGNS 2/25/21
 UPDATED PNG DESIGN 5/19/21
 UPDATED CENTURYLINK DESIGN 6/29/21
 UPDATED CHARTER DESIGN 7/5/21
 UPDATED PWC WATER/SEWER DESIGN 7/8/21
 UPDATED PNG DESIGN 7/8/21
 UPDATED SEGRA DESIGNS 8/20/21
 UPDATED PWC WATER/SEWER DESIGN 9/2/21
 UPDATED PWC WATER/SEWER DESIGN 10/8/21
 UPDATED PWC WATER/SEWER DESIGN 10/26/21

MATCHLINE SHEET 8 -L- STA. 105+00.00
 UTILITY COORDINATION U-5798A.U1 - PSH9 11091.DGN

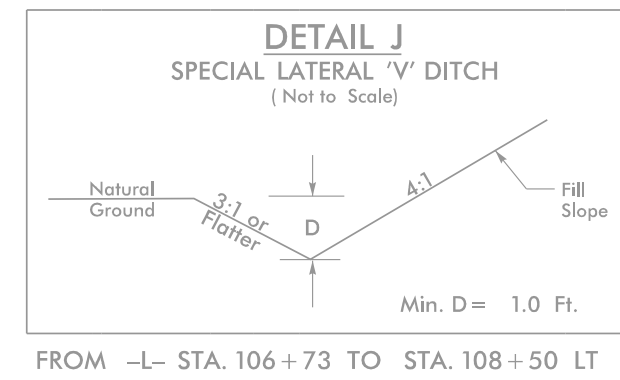
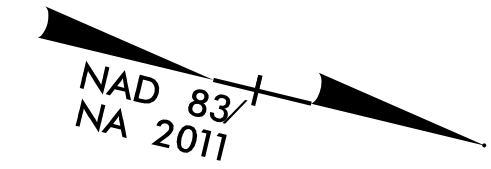
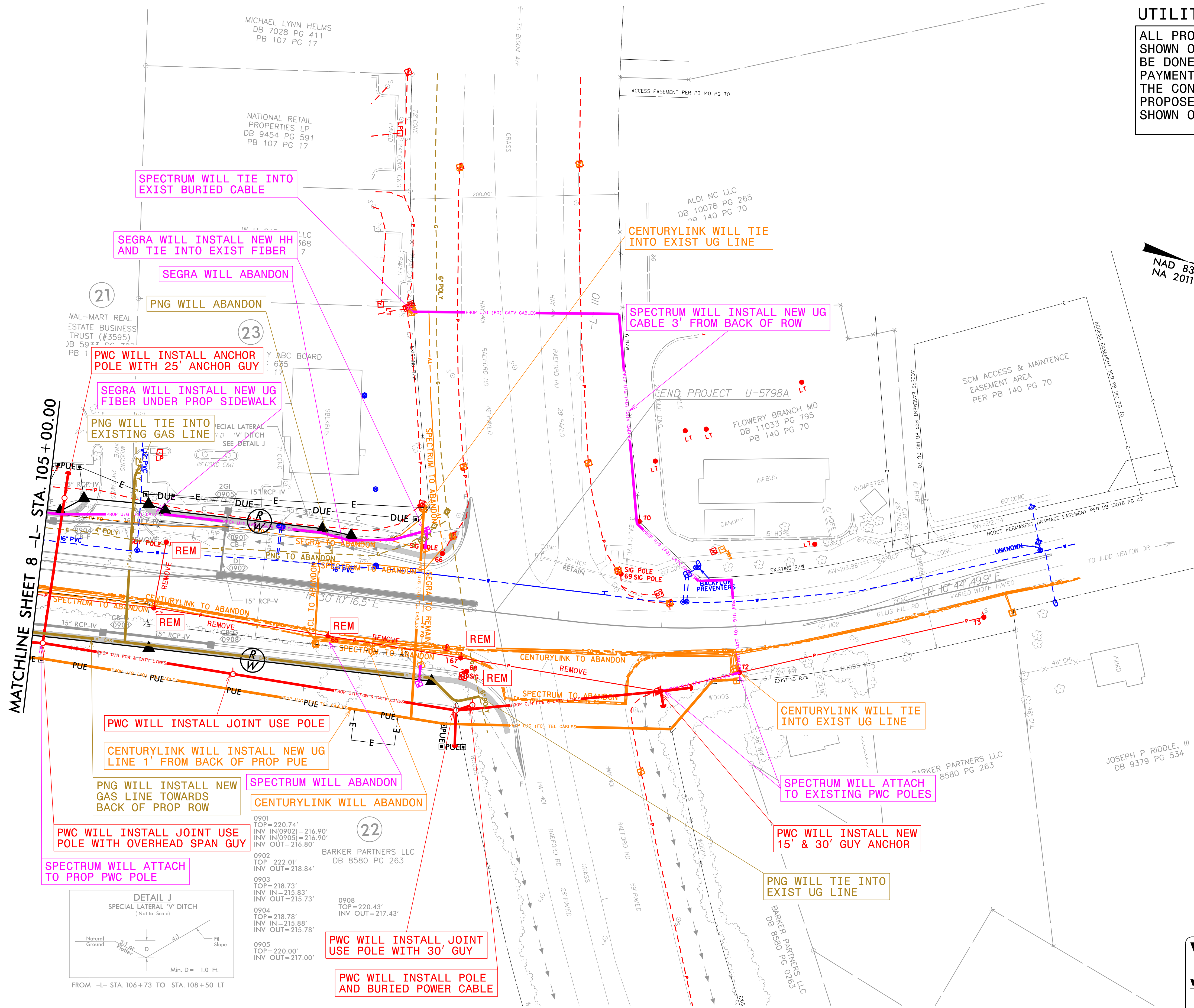

0901	TOP=220.74'	INV IN(0902)=216.90'	INV IN(0905)=216.90'	INV OUT=216.80'
0902	TOP=222.01'	INV OUT=218.84'		
0903	TOP=218.73'	INV IN=215.83'	INV OUT=215.73'	
0904	TOP=218.78'	INV IN=215.88'	INV OUT=215.78'	
0905	TOP=220.00'	INV OUT=217.00'		



V&M
Vaughn & Melton
Consulting Engineers

Asheville, North Carolina 828-253-2796

Charlotte, North Carolina 704-551-0988
 Tri-Cities, Tennessee 423-461-8400
 Knoxville, Tennessee 865-546-5800
 Middlesboro, Kentucky 606-248-6500
 Spartanburg, South Carolina 864-574-4775

Copyright © 2006 Vaughn & Melton, Inc. All Rights Reserved.