

**PLAN OF BARRIER RAIL**  
PARAPET NOT SHOWN FOR CLARITY

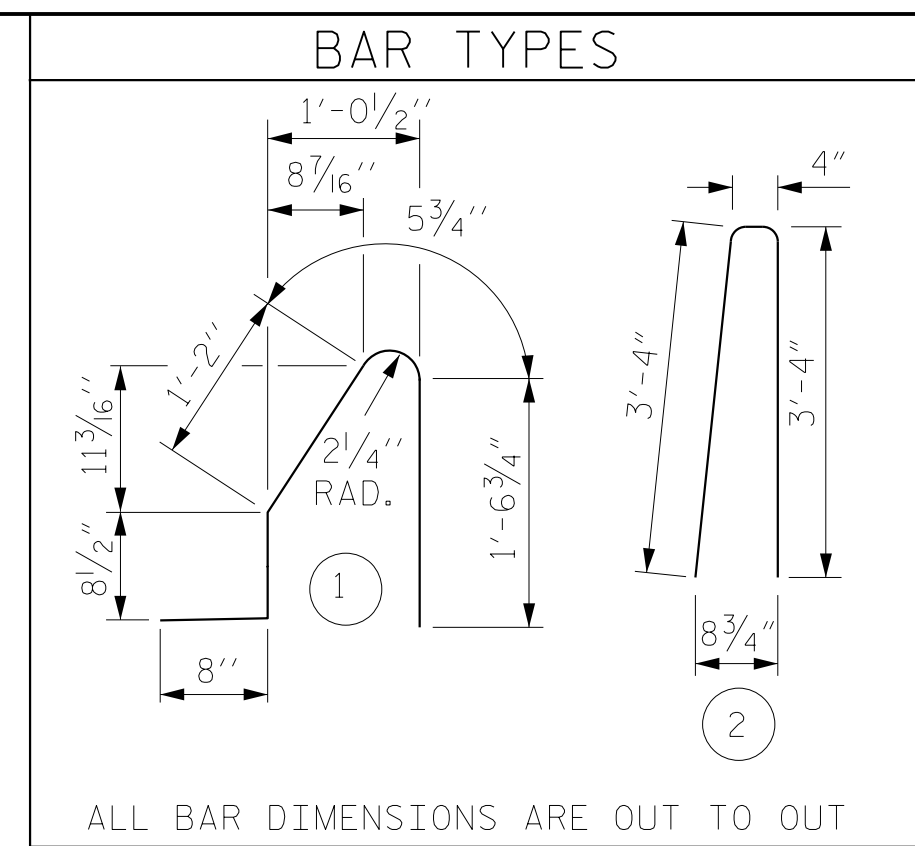

ALL BAR DIMENSIONS ARE OUT TO OUT

BILL OF MATERIAL					
FOR CONCRETE BARRIER RAIL ONLY					
BAR	NO.	SIZE	TYPE	LENGTH	WEIGHT
* B1	88	#5	STR.	26'-7"	2440
* B2	11	#5	STR.	5'-6"	63
* B3	5	#5	STR.	12'-7"	66
* B4	6	#5	STR.	12'-11"	81
* S1	235	#5	1	4'-7"	1123
* S2	235	#5	2	7'-0"	1716
* EPOXY COATED REINFORCING STEEL					5,489 LBS.
CLASS AA CONCRETE					32.1 CU. YDS.
CONCRETE BARRIER RAIL					235.6 LIN. FT.

**NOTES**

THE BARRIER RAIL IN EACH SPAN SHALL NOT BE CAST UNTIL ALL SLAB CONCRETE IN THAT SPAN HAS BEEN CAST AND HAS REACHED A MINIMUM COMPRESSIVE STRENGTH OF 3,000 PSI.

ALL REINFORCING STEEL IN BARRIER RAILS SHALL BE EPOXY COATED.

GROOVED CONTRACTION JOINTS, 1/2" IN DEPTH, SHALL BE TOOLED IN ALL EXPOSED FACES OF THE BARRIER RAIL AND IN ACCORDANCE WITH ARTICLE 825-10(B) OF THE STANDARD SPECIFICATIONS. THE CONTRACTION JOINT SHALL BE LOCATED AT EACH THIRD POINT BETWEEN BARRIER RAIL EXPANSION JOINTS. ONLY ONE CONTRACTION JOINT IS REQUIRED AT MIDPOINT OF BARRIER RAIL SEGMENTS LESS THAN 20 FEET IN LENGTH AND NO CONTRACTION JOINTS ARE REQUIRED FOR THOSE SEGMENTS LESS THAN 10 FEET IN LENGTH.

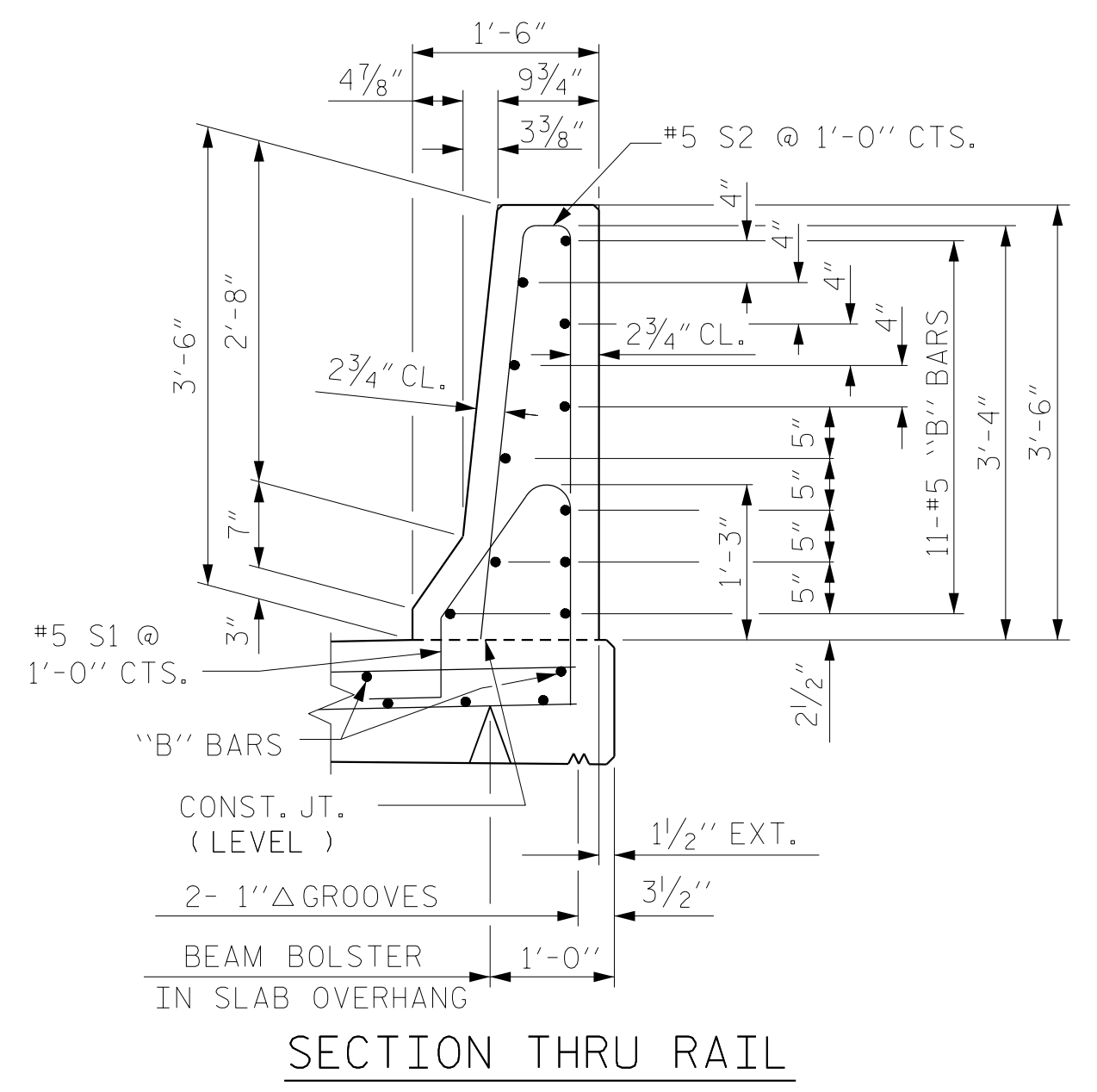

**SECTION THRU RAIL**

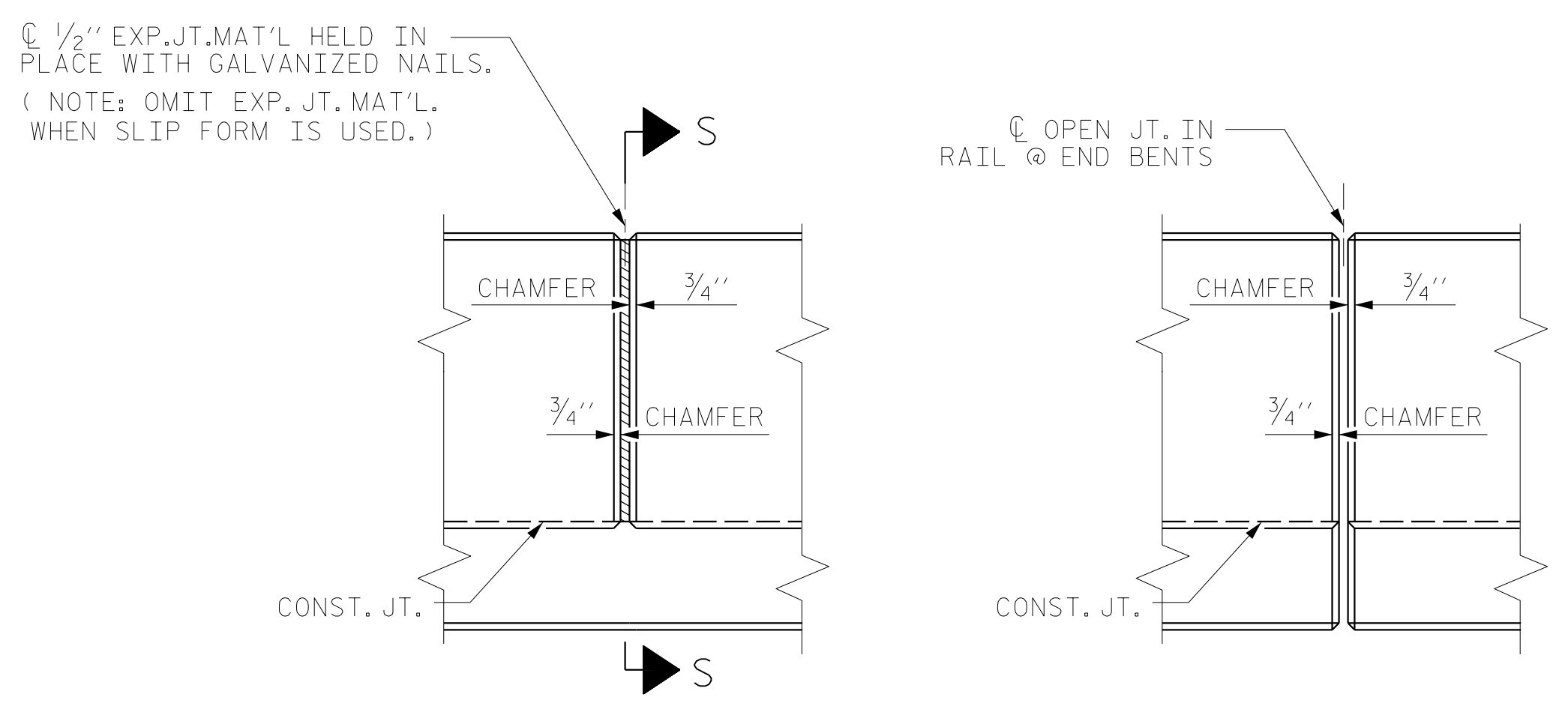

**ELEVATION AT EXPANSION JOINTS**

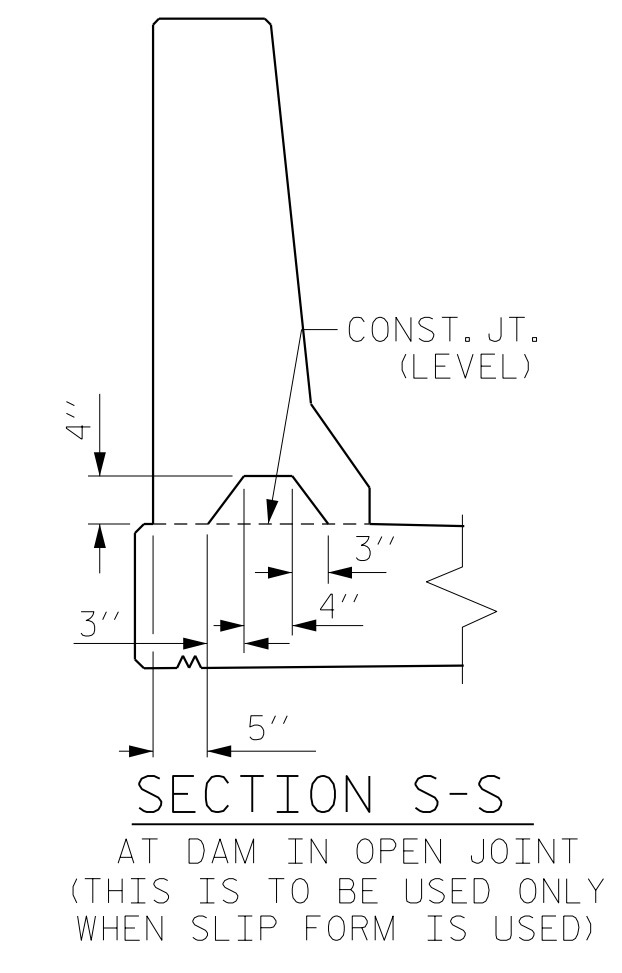

**BARRIER RAIL DETAILS**

PROJECT NO. U-5798A  
CUMBERLAND COUNTY  
STATION: 76+80.00 -L-



STATE OF NORTH CAROLINA  
DEPARTMENT OF TRANSPORTATION  
RALEIGH  
SUPERSTRUCTURE  
CONCRETE  
BARRIER RAIL  
RIGHT LANE

REVISIONS						SHEET NO.
NO.	BY:	DATE:	NO.	BY:	DATE:	
1			3			S2-18
2			4			TOTAL SHEETS 43

DRAWN BY : TWL DATE : 12/2020  
CHECKED BY : MRA DATE : 12/2020  
DESIGN ENGINEER OF RECORD: RLB DATE : 09/2021

DOCUMENT NOT CONSIDERED FINAL UNLESS ALL SIGNATURES COMPLETED