

PLAN OF SIDEWALK

NOTES

- GROOVED CONTRACTION JOINTS, 1/2" IN DEPTH, SHALL BE TOOLED IN ALL EXPOSED FACES OF THE SIDEWALK IN ACCORDANCE WITH ARTICLE 825-10(B) OF THE STANDARD SPECIFICATIONS. THE CONTRACTION JOINTS SHALL BE LOCATED AT A SPACING OF 8 FT. TO 10 FT. BETWEEN EXPANSION JOINTS. NO CONTRACTION JOINTS WILL BE REQUIRED FOR SEGMENTS LESS THAN 10 FEET IN LENGTH.
- CONTRACTION JOINTS SHALL BE NORMAL TO BARRIER.
- ALL REINFORCING STEEL IN THE SIDEWALK SHALL BE EPOXY COATED.
- FOR SIDEWALK ON APPROACH SLABS, SEE APPROACH SLAB DRAWINGS.
- PAYMENT FOR THE SIDEWALK SHALL BE INCLUDED IN THE PAY ITEM FOR "REINFORCED CONCRETE DECK SLAB".
- U1 BARS MAY BE PUSHED INTO GREEN CONCRETE AFTER SPAN HAS BEEN SCREEDED OFF.
- SIDEWALK IN A CONTINUOUS UNIT SHALL NOT BE CAST UNTIL ALL SLAB CONCRETE IN THE UNIT HAS BEEN CAST AND HAS REACHED A MINIMUM COMPRESSIVE STRENGTH OF 3000 PSI.
- FOR CONCRETE PARAPET REINFORCING STEEL AND DETAILS, SEE "CONCRETE PARAPET" SHEETS.
- FOR SIDEWALK COVER PLATE DETAILS AT END BENTS, SEE "EXPANSION JOINT SEAL DETAILS FOR SIDEWALK" SHEETS.

BILL OF MATERIAL

BAR	NO.	SIZE	TYPE	LENGTH	WEIGHT
*B1	36	#4	STR	38'-2"	918
*G1	220	#4	STR	5'-2"	759
*U1	62	#4	1	3'-4"	138
* EPOXY COATED REINFORCING STEEL				1,815 LBS.	
CLASS AA CONCRETE				27.4 C.Y.	

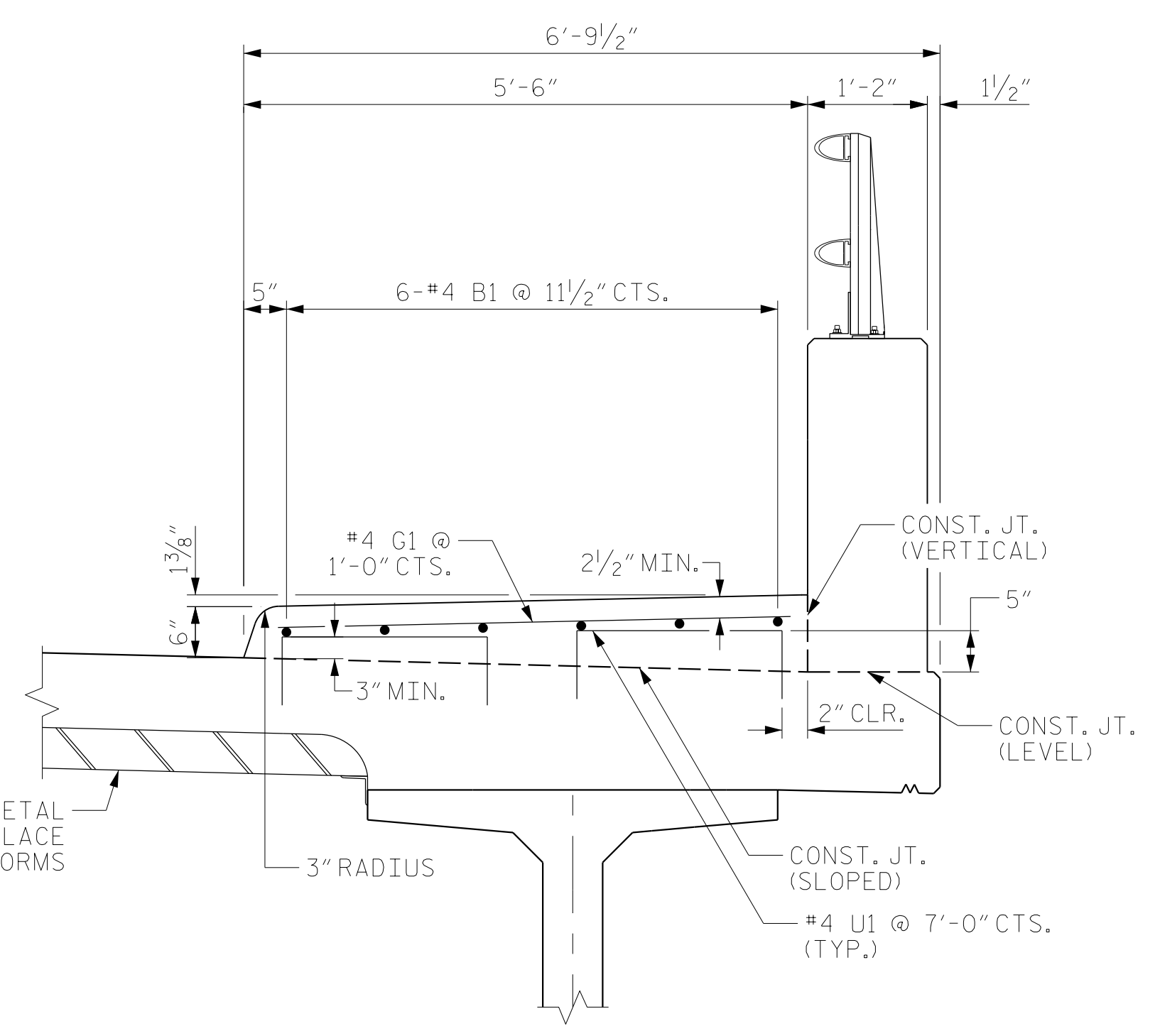
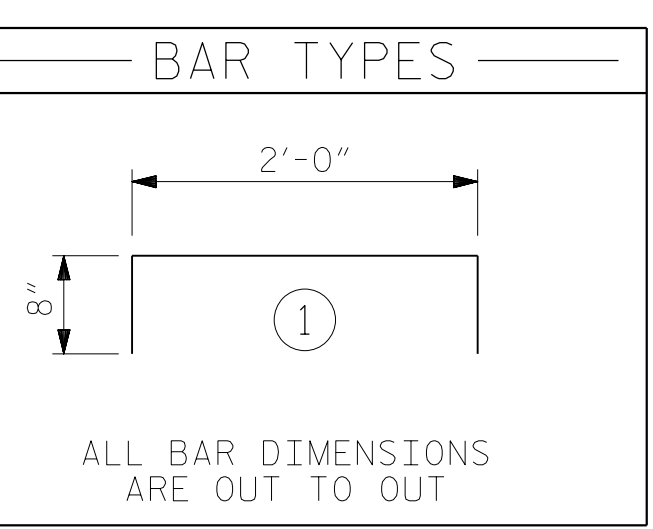

SECTION A-A

PROJECT NO. U-5798A  
 CUMBERLAND COUNTY  
 STATION: 76+80.00 -L-



STATE OF NORTH CAROLINA  
 DEPARTMENT OF TRANSPORTATION  
 RALEIGH  
 SUPERSTRUCTURE  
 SIDEWALK DETAILS  
 RIGHT LANE

REVISIONS						SHEET NO.
NO.	BY:	DATE:	NO.	BY:	DATE:	S2-9
1			3			TOTAL SHEETS
2			4			43

DRAWN BY : MRA DATE : 04/2020  
 CHECKED BY : NSC DATE : 04/2021  
 DESIGN ENGINEER OF RECORD: RLB DATE : 09/2021

DOCUMENT NOT CONSIDERED FINAL UNLESS ALL SIGNATURES COMPLETED