

UTILITIES BY OTHERS

ALL PROPOSED UTILITY WORK SHOWN ON THIS SHEET WILL BE DONE BY OTHERS. NO PAYMENT WILL BE MADE TO THE CONTRACTOR FOR PROPOSED UTILITY WORK SHOWN ON THIS SHEET.

ADDED PNG DESIGNS 01/18/20
 ADDED PUE DESIGNS 01/18/20
 ADDED SEGRA DESIGNS 01/20/20
 ADDED CHARTER DESIGNS 01/21/20
 ADDED UPDATED PUE 2/24/20
 ADDED PUE ELECTRIC DESIGN 3/3/20
 UPDATED PUE 3/24/20
 UPDATED PNC & PWC WATER/SEWER DESIGNS 2/25/21
 UPDATED PNC DESIGN 5/19/21
 UPDATED CENTURYLINK DESIGN 6/29/21
 UPDATED CHARTER DESIGN 7/5/21
 UPDATED PNC DESIGN 7/8/21
 UPDATED PNC WATER/SEWER DESIGN 8/20/21
 UPDATED SEGRA DESIGNS 9/2/21
 UPDATED PWC WATER/SEWER DESIGN 10/8/21
 UPDATED PWC WATER/SEWER DESIGN 10/26/21

UTILITY 31930-21 U5798A UTILITIES UTILITY COORDINATION U5798A.U1 - PSH9 11091.DGN

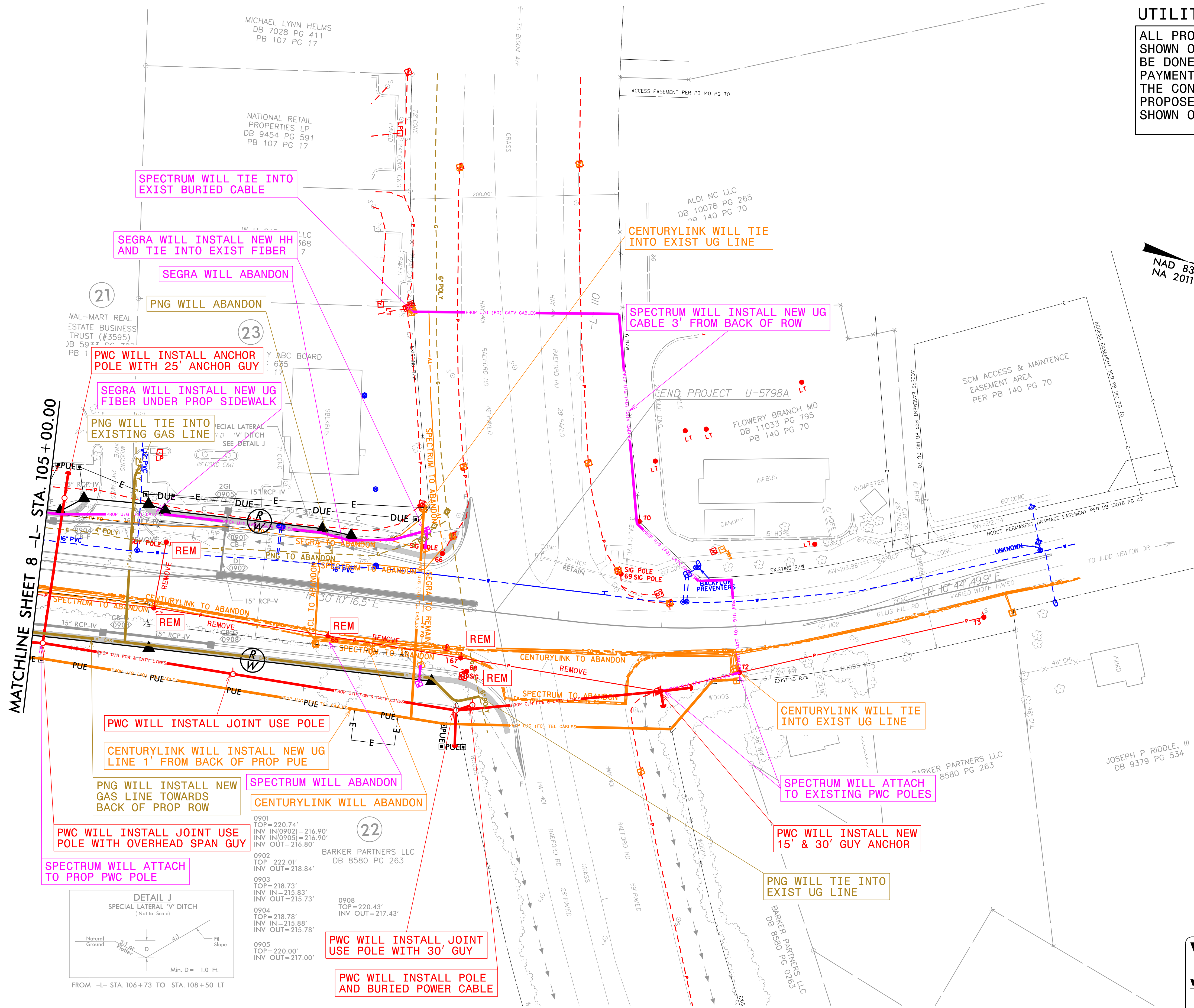

MATCHLINE SHEET 8 -L- STA. 105+00.00

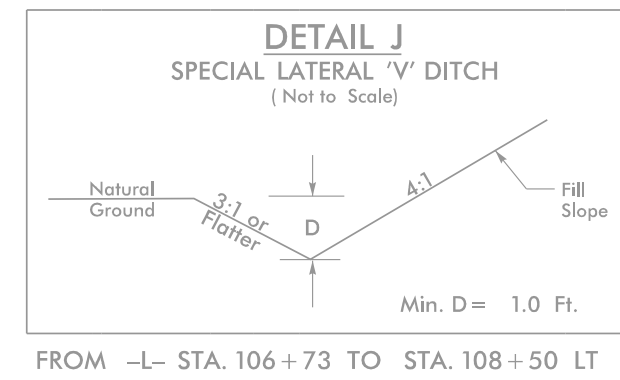

0901	TOP=220.74'	INV IN(0902)=216.90'	INV IN(0905)=216.90'	INV OUT=216.80'
0902	TOP=222.01'	INV OUT=218.84'		
0903	TOP=218.73'	INV IN=215.83'	INV OUT=215.73'	
0904	TOP=218.78'	INV IN=215.88'	INV OUT=215.78'	
0905	TOP=220.00'	INV OUT=217.00'		

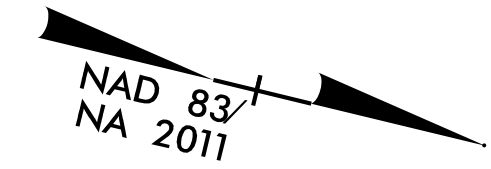

V&M
 Vaughn & Melton
 Consulting Engineers

Asheville, North Carolina 828-253-2796

Charlotte, North Carolina 704-551-0988
 Tri-Cities, Tennessee 423-461-8400
 Knoxville, Tennessee 865-546-5800
 Middlesboro, Kentucky 606-248-6500
 Spartanburg, South Carolina 864-574-4775

Copyright © 2006 Vaughn & Melton, Inc. All Rights Reserved.