

UTILITIES BY OTHERS

ALL PROPOSED UTILITY WORK SHOWN ON THIS SHEET WILL BE DONE BY OTHERS. NO PAYMENT WILL BE MADE TO THE CONTRACTOR FOR PROPOSED UTILITY WORK SHOWN ON THIS SHEET.

ADDED SEGRA DESIGNS 01/20/20
 ADDED CHARTER DESIGNS 01/21/20
 ADDED UPDATED PUE 2/24/20
 ADDED PWC ELECTRIC DESIGN 3/3/20
 UPDATED PUE 3/24/20
 UPDATED PUE 3/24/20
 UPDATED PNG & PWC WATER/SEWER DESIGNS 2/26/21
 UPDATED PNG DESIGN 5/19/21
 UPDATED CENTURYLINK DESIGN 5/21/21
 UPDATED CENTURYLINK DESIGN 5/21/21
 UPDATED PWC DESIGN 7/8/21
 UPDATED PWC DESIGN 7/8/21
 UPDATED SEGRA DESIGN 8/20/21
 UPDATED SEGRA DESIGN 9/2/21
 UPDATED PWC WATER/SEWER DESIGN 10/8/21
 UPDATED PWC WATER/SEWER DESIGN 10/26/21
 UPDATED ROW 12/30/21
 UPDATED ROW 2/22/22

M D GILLIS C/O JUDY GILLIS DIBACCO DB 2584 PG 0783
 M D GILLIS C/O JUDY GILLIS DIBACCO DB 2584 PG 0783
 M D GILLIS C/O JUDY GILLIS DIBACCO DB 2584 PG 0783
 JOHN D GILLIS DB 5280 PG 386 PB 51 PG 32
 JOHN MCN GILLIS JR ET AL DB 2899 PG 463
 DOUGLAS KEITH MILLER & WIFE KATHRYN GILLIS DB 4227 PG 487

UTILITY 31930-21 U5798A UTILITIES UTILITY COORDINATION U5798A UTILITY PSHE 1065.DGN

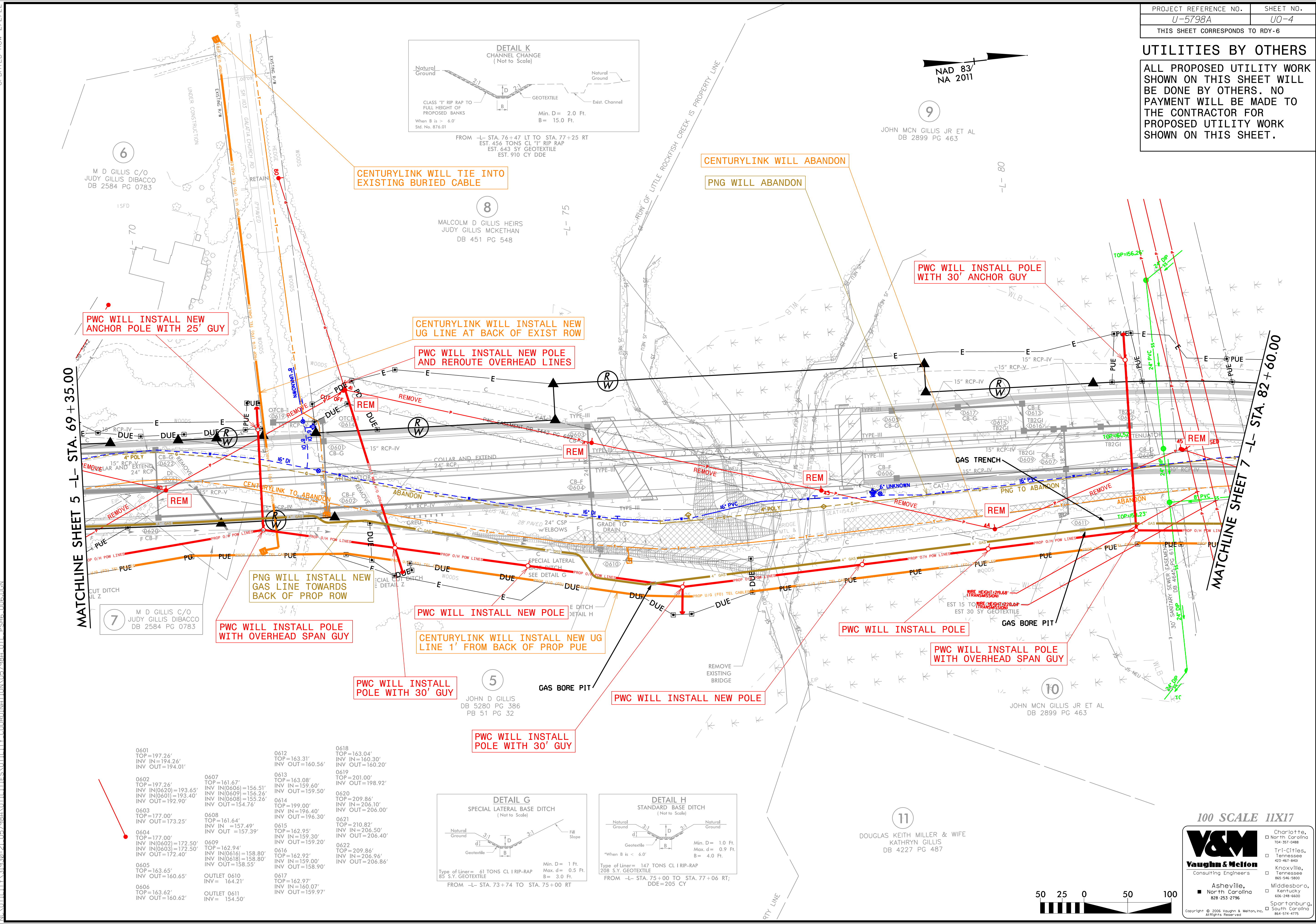

0601 TOP = 197.26' INV IN = 194.26' INV OUT = 194.01'	0607 TOP = 161.67' INV IN(0606) = 156.51' INV IN(0609) = 156.26' INV IN(0608) = 155.26' INV OUT = 154.76'	0612 TOP = 163.31' INV OUT = 160.56'	0613 TOP = 163.08' INV IN = 159.60' INV OUT = 159.50'	0618 TOP = 163.04' INV IN = 160.30' INV OUT = 160.20'	0619 TOP = 201.00' INV OUT = 198.92'
0602 TOP = 197.26' INV IN(0620) = 193.65' INV IN(0601) = 193.40' INV OUT = 192.90'	0608 TOP = 161.64' INV IN = 157.49' INV OUT = 157.39'	0614 TOP = 199.00' INV IN = 196.40' INV OUT = 196.30'	0615 TOP = 162.95' INV IN = 159.30' INV OUT = 159.20'	0620 TOP = 209.86' INV IN = 206.10' INV OUT = 206.00'	0621 TOP = 210.82' INV IN = 206.50' INV OUT = 206.40'
0603 TOP = 177.00' INV OUT = 173.25'	0609 TOP = 162.94' INV IN(0616) = 158.80' INV IN(0603) = 172.50' INV OUT = 172.40'	0616 TOP = 209.86' INV IN = 159.90' INV OUT = 158.90'	0617 TOP = 162.97' INV IN = 160.07' INV OUT = 159.97'	0622 TOP = 209.86' INV IN = 206.96' INV OUT = 206.86'	
0604 TOP = 177.00' INV IN(0602) = 172.50' INV IN(0603) = 172.50' INV OUT = 172.40'	OUTLET 0610 INV = 164.21'				
0605 TOP = 163.65' INV OUT = 160.65'	OUTLET 0611 INV = 154.50'				
0606 TOP = 163.62' INV OUT = 160.62'					



100 SCALE 11X17

V&M
 Vaughn & Melton
 Consulting Engineers

Charlotte, North Carolina 704-531-0988
 Tri-Cities, Tennessee 423-461-8400
 Knoxville, Tennessee 865-546-5800
 Middlesboro, Kentucky 606-248-6600
 Asheville, North Carolina 828-253-2196
 Spartanburg, South Carolina 864-514-4715

Copyright © 2006 Vaughn & Melton, Inc. All Rights Reserved.