

PROJECT REFERENCE NO.	SHEET NO.
U-5798A	UC-8A
DESIGNED BY: AAA	UTILITY CONSTRUCTION PLANS ONLY
DRAWN BY: KNS	
CHECKED BY: BRO	
APPROVED BY: BRO	
REVISED:	
NORTH CAROLINA DEPARTMENT OF TRANSPORTATION	
UTILITIES ENGINEERING SEC. PHONE: (919) 707-6690 FAX: (919) 250-4151	

UTILITY CONSTRUCTION

**DOCUMENT NOT CONSIDERED FINAL
UNLESS ALL SIGNATURES COMPLETED**

**THIS SHEET CORRESPONDS
TO ROADWAY SHEET 8**

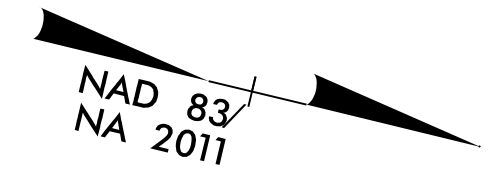

-L- CURVE DATA

PI Sta 93+91.02	PI Sta 101+25.50
$\Delta = 8' 17" 55.2" (LT)$	$\Delta = 6' 12" 24.4" (RT)$
$D = 1' 40" 48.8"$	$D = 0' 38" 11.8"$
$L = 493.90'$	$L = 974.96'$
$T = 247.38'$	$T = 487.96'$
$R = 3,410.00'$	$R = 9,000.00'$
SE = RC	SE = NC

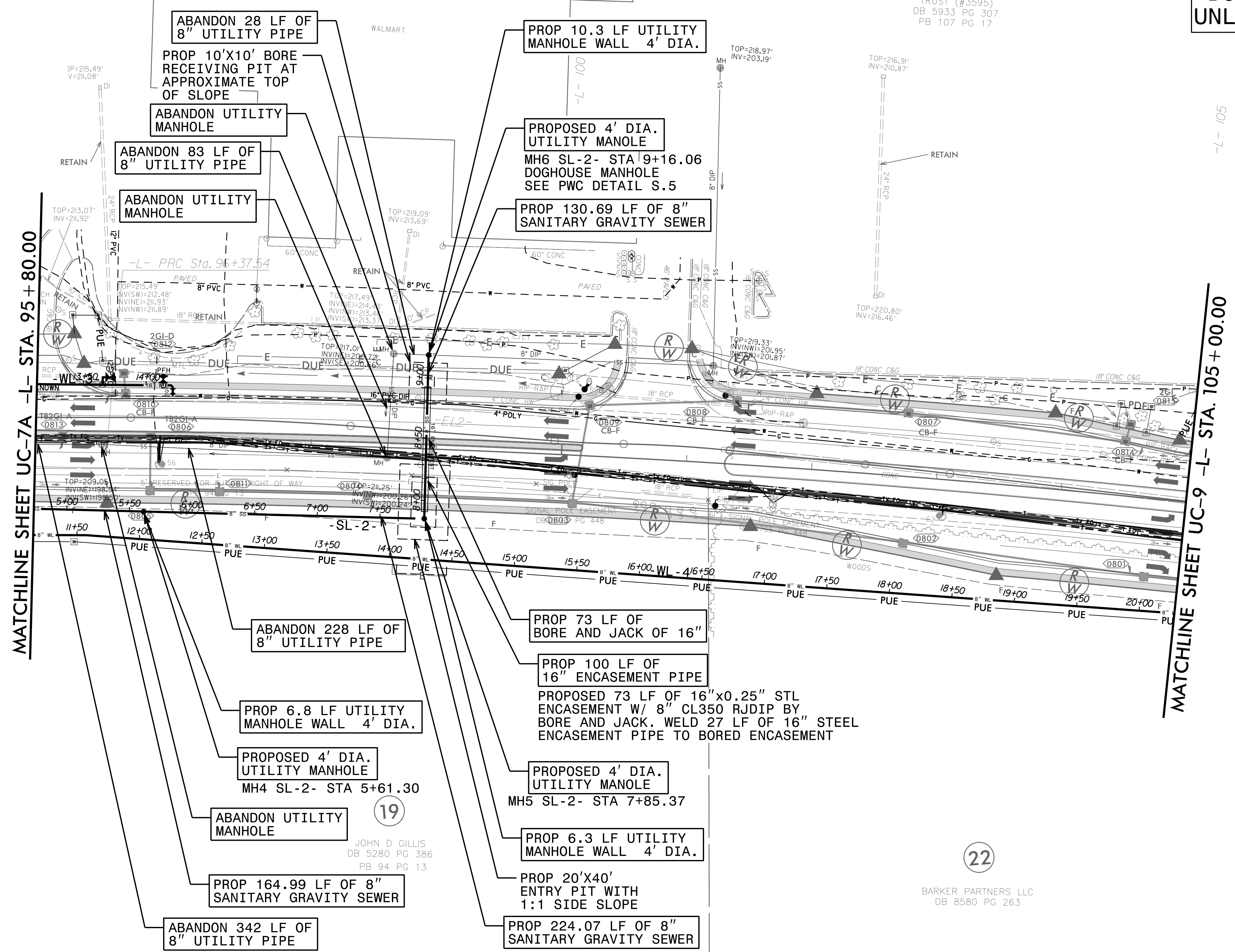

MATCHLINE SHEET UC-7A -L- STA. 95 + 80.00

MATCHLINE SHEET UC-9 -L- STA. 105 + 00.00

21

WAL-MART REAL ESTATE BUSINESS TRUST (#3595)
DB 5933 PG 307
PB 107 PG 17

22

BARKER PARTNERS, LLC
DB 8580 PG 263

NOTES:
SEE SHEET UC-3A FOR REFERENCED NOTES.
SEE SHEET UC-14 FOR -SL-2- PROFILE.

07-DEC-2021 06:28
 C:\Users\jgiles\Documents\Environmental\Fayetteville Public Works Commission\2019061600RA - U-5798 Gills Hill Road Utility Coordination\Utilities\Engineering\UC-Proj\U-5798A_ut_Rd\08_UC08A_psh.dgn
 jgiles
 20211207