

PROJECT REFERENCE NO.	SHEET NO.
U-5798A	UC-8
DESIGNED BY: AAA	UTILITY CONSTRUCTION PLANS ONLY
DRAWN BY: KNS	
CHECKED BY: BRO	
APPROVED BY: BRO	
REVISED:	
NORTH CAROLINA DEPARTMENT OF TRANSPORTATION	
UTILITIES ENGINEERING SEC. PHONE: (919) 707-6690 FAX: (919) 250-4151	

UTILITY CONSTRUCTION

**DOCUMENT NOT CONSIDERED FINAL
UNLESS ALL SIGNATURES COMPLETED**

**THIS SHEET CORRESPONDS
TO ROADWAY SHEET 8**

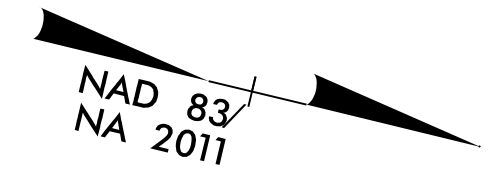

-L- CURVE DATA

PI Sta 93+91.02	PI Sta 101+25.50
$\Delta = 8' 17" 55.2" (LT)$	$\Delta = 6' 12" 24.4" (RT)$
$D = 1' 40" 48.8"$	$D = 0' 38" 11.8"$
$L = 493.90'$	$L = 974.96'$
$T = 247.38'$	$T = 487.96'$
$R = 3,410.00'$	$R = 9,000.00'$
SE = RC	SE = NC

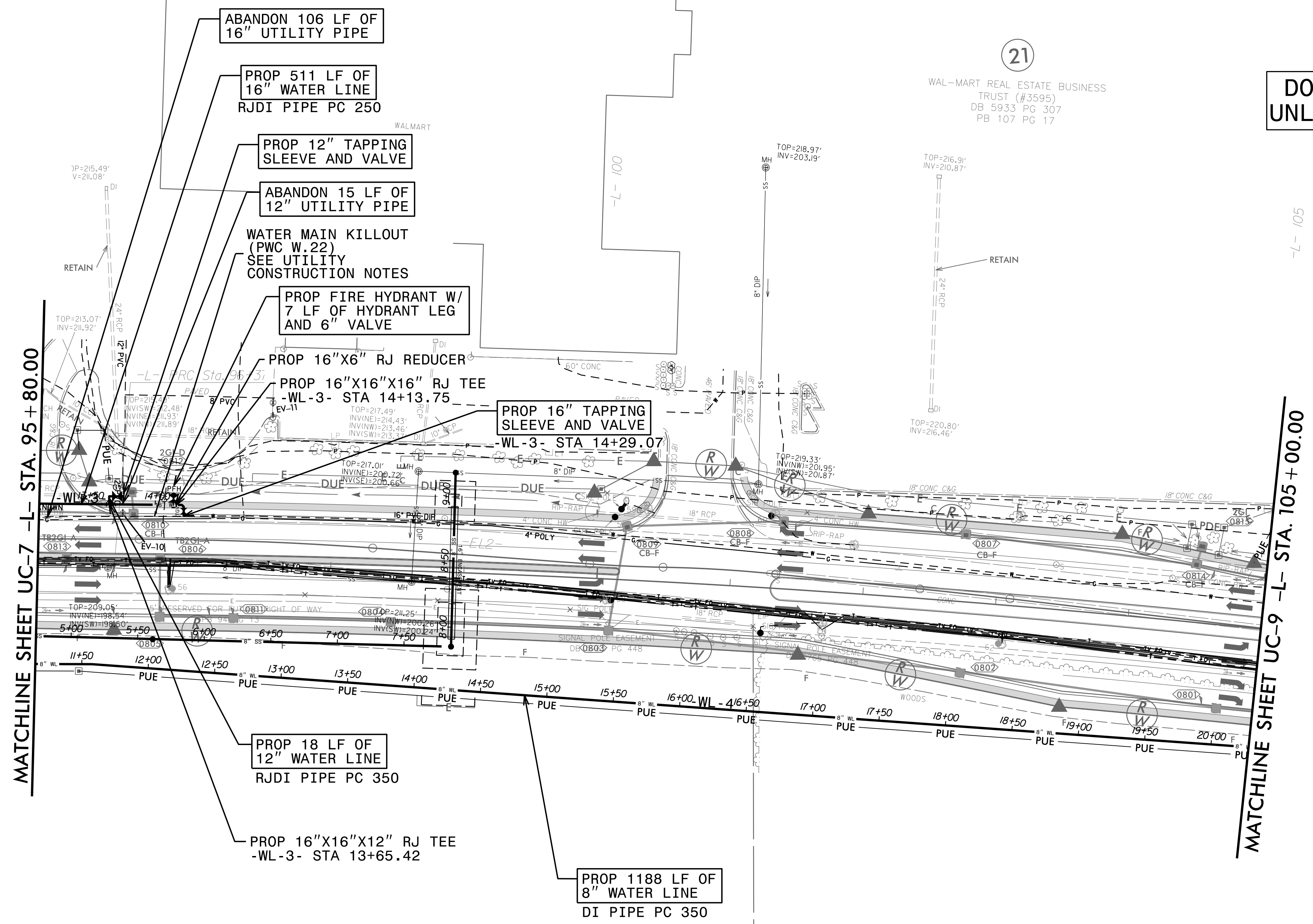

MATCHLINE SHEET UC-7 -L- STA. 95 + 80.00

MATCHLINE SHEET UC-9 -L- STA. 105 + 00.00

19

JOHN D GILLIS
DB 5280 PG 386
PB 94 PG 13

22

BARKER PARTNERS, LLC
DB 8580 PG 263

PROPOSED 2,405 POUNDS OF
DUCTILE IRON WATER PIPE FITTINGS

NOTES:

SEE SHEET UC-3A FOR REFERENCED NOTES.
SEE SHEET UC-11 FOR -WL-3- PROFILE.
SEE SHEET UC-13 FOR -WL-4- PROFILE.

KILLOUT OF THE EXISTING 16" WATER MAIN SOUTH OF THE CONNECTION OF WL-3 NEAR STA. 14+47 TO BE FACILITATED BY SHUTDOWN. EXISTING VALVES EV-9 AND EXISTING IN-LINE VALVE AT INTERSECTION OF OLD RAEFORD RD AND RIM RD/ GILLIS HILL RD WILL BE CRITICAL IN ISOLATING THE EXISTING MAIN IN THIS SHUTDOWN. CONSTRUCTION TIME FOR THIS WORK WILL BE LIMITED TO WEEKEND AND SHALL NOT BEGIN UNTIL 9:00 PM ON SATURDAY. ALL WORK MUST BE COMPLETED AND WATER MAIN BACK IN OPERATIONS BEFORE 6:00 AM MONDAY.

C:\DEC-2021\628... Model.dwg
U-5798 Gillis Hill Road Utility Coordination\CADD\Microstation\Utilities\Engineering\UC\Proc\U-5798A.ut_Rdy08_UC08_psh.dgn