

PHASING DIAGRAM

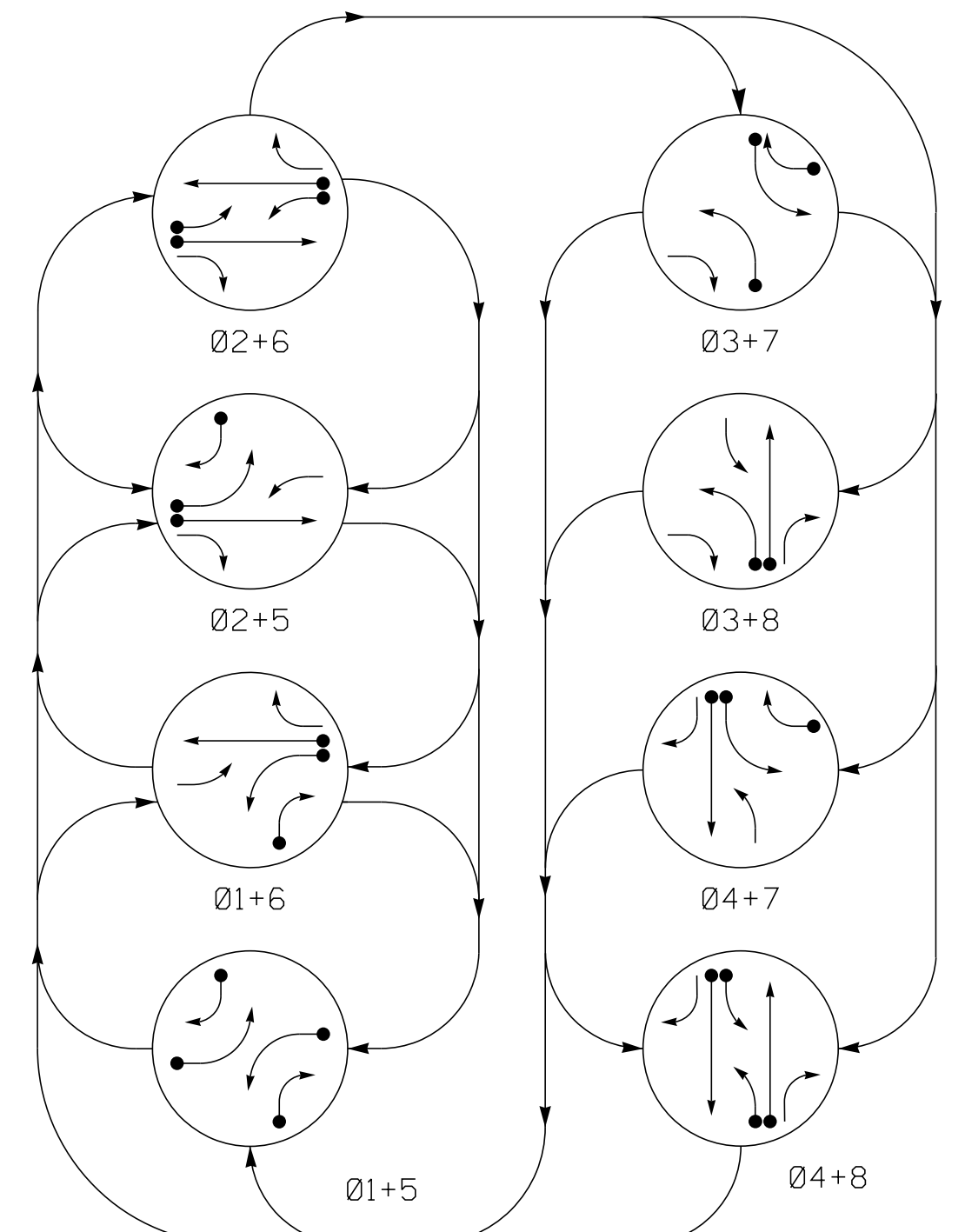

PHASING DIAGRAM DETECTION LEGEND

- DETECTED MOVEMENT
- ← UNDETECTED MOVEMENT (OVERLAP)
- UNSIGNALIZED MOVEMENT
- ⇄ PEDESTRIAN MOVEMENT

DEFAULT TABLE OF OPERATION

SIGNAL FACE	PHASE							
	01+5	01+6	02+5	02+6	03+7	03+8	04+7	04+8
11	←	←	←	←	←	←	←	←
21	R	R	G	G	R	R	R	Y
22	R	R	G	G	R	R	R	Y
31	←	←	←	←	←	←	←	←
41	R	R	R	R	R	R	G	G
42	R	R	R	R	R	R	G	G
51	←	←	←	←	←	←	←	←
61, 62	R	G	R	G	R	R	R	Y
63	R	G	R	G	R	R	R	Y
71	←	←	←	←	←	←	←	←
81	R	R	R	R	R	G	G	R
82	R	R	R	R	R	G	G	R

SIGNAL FACE I.D.

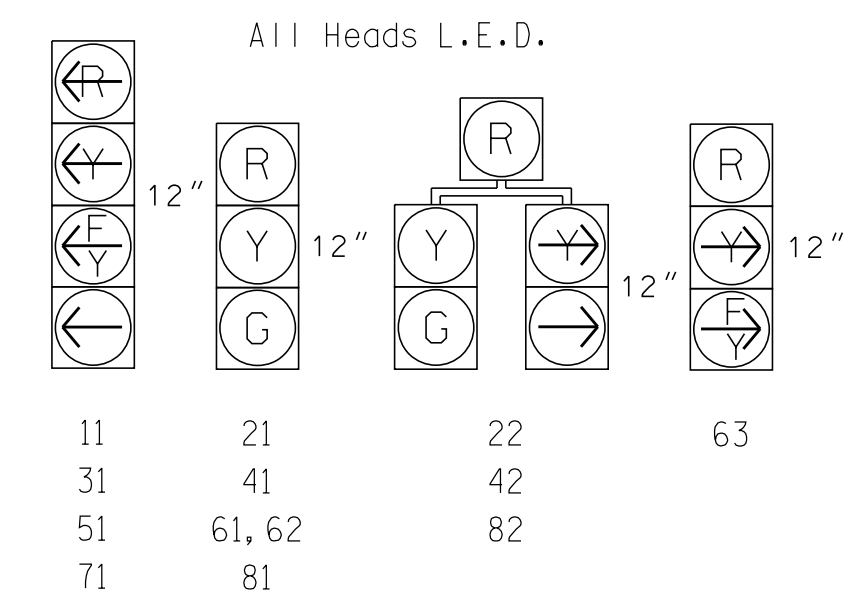

ALTERNATE TABLE OF OPERATION

SIGNAL FACE	PHASE							
	01+5	01+6	02+5	02+6	03+7	03+8	04+7	04+8
11	←	←	←	←	←	←	←	←
21	R	R	G	G	R	R	R	Y
22	R	R	G	G	R	R	R	Y
31	←	←	←	←	←	←	←	←
41	R	R	R	R	R	R	G	G
42	R	R	R	R	R	R	G	G
51	←	←	←	←	←	←	←	←
61, 62	R	G	R	G	R	R	R	Y
63	R	G	R	G	R	R	R	Y
71	←	←	←	←	←	←	←	←
81	R	R	R	R	R	G	G	R
82	R	R	R	R	R	G	G	R

ALTERNATE PHASING DIAGRAM

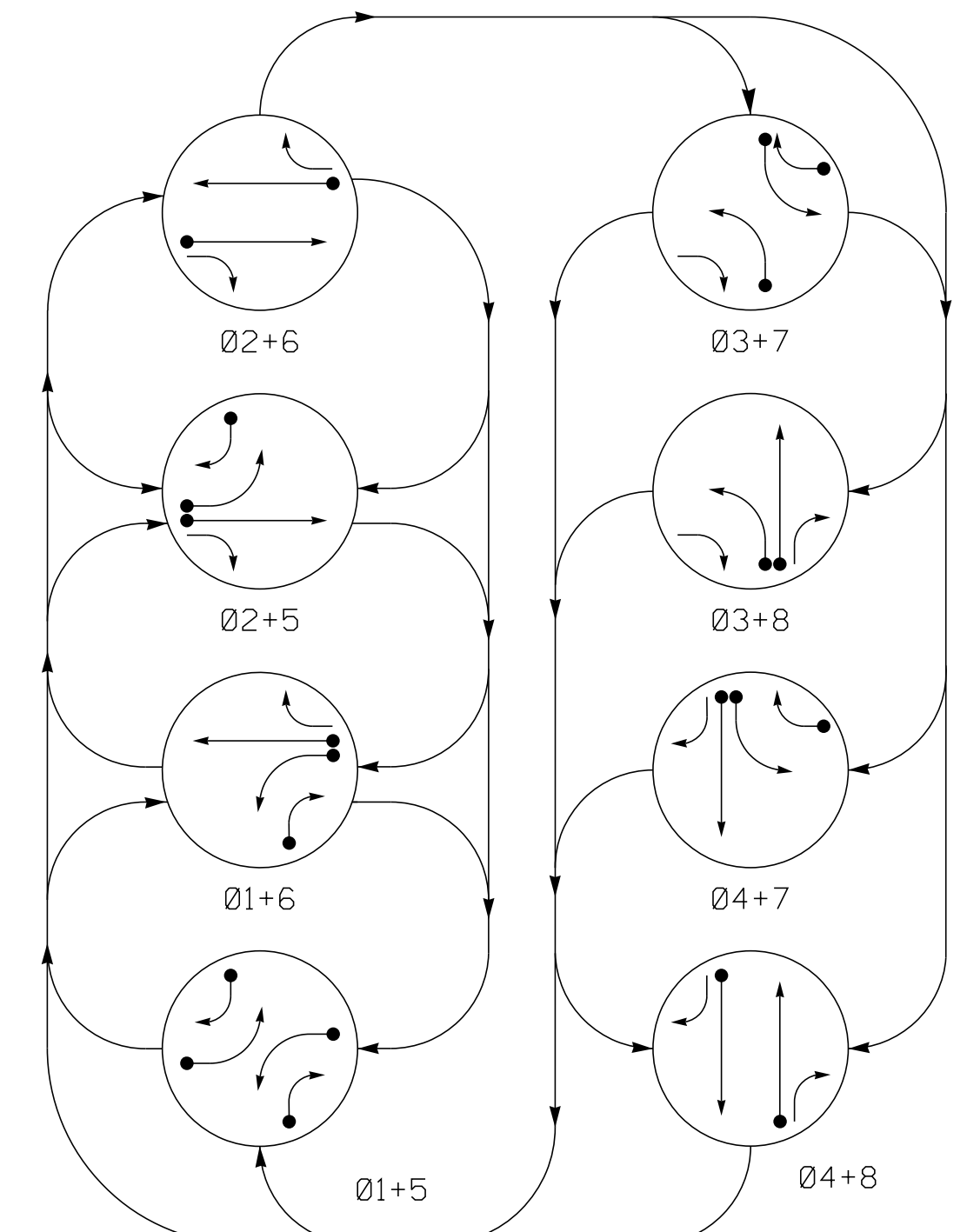

PHASING DIAGRAM DETECTION LEGEND

- DETECTED MOVEMENT
- ← UNDETECTED MOVEMENT (OVERLAP)
- UNSIGNALIZED MOVEMENT
- ⇄ PEDESTRIAN MOVEMENT

8 Phase Fully Actuated Fayetteville Signal System

NOTES

- Refer to "Roadway Standard Drawings NCDOT" dated January 2018 and "Standard Specifications for Roads and Structures" dated January 2018.
- Do not program signal for late night flashing operation unless otherwise directed by the Engineer.
- Phase 1 and/or phase 5 may be lagged.
- Phase 3 and/or phase 7 may be lagged.
- Set all detector units to presence mode.
- Reposition existing signal heads 61 and 62.
- Portions of detection zones 3A and 7A not shown for clarity.
- The Division Traffic Engineer will determine the hours of use for each phasing plan.

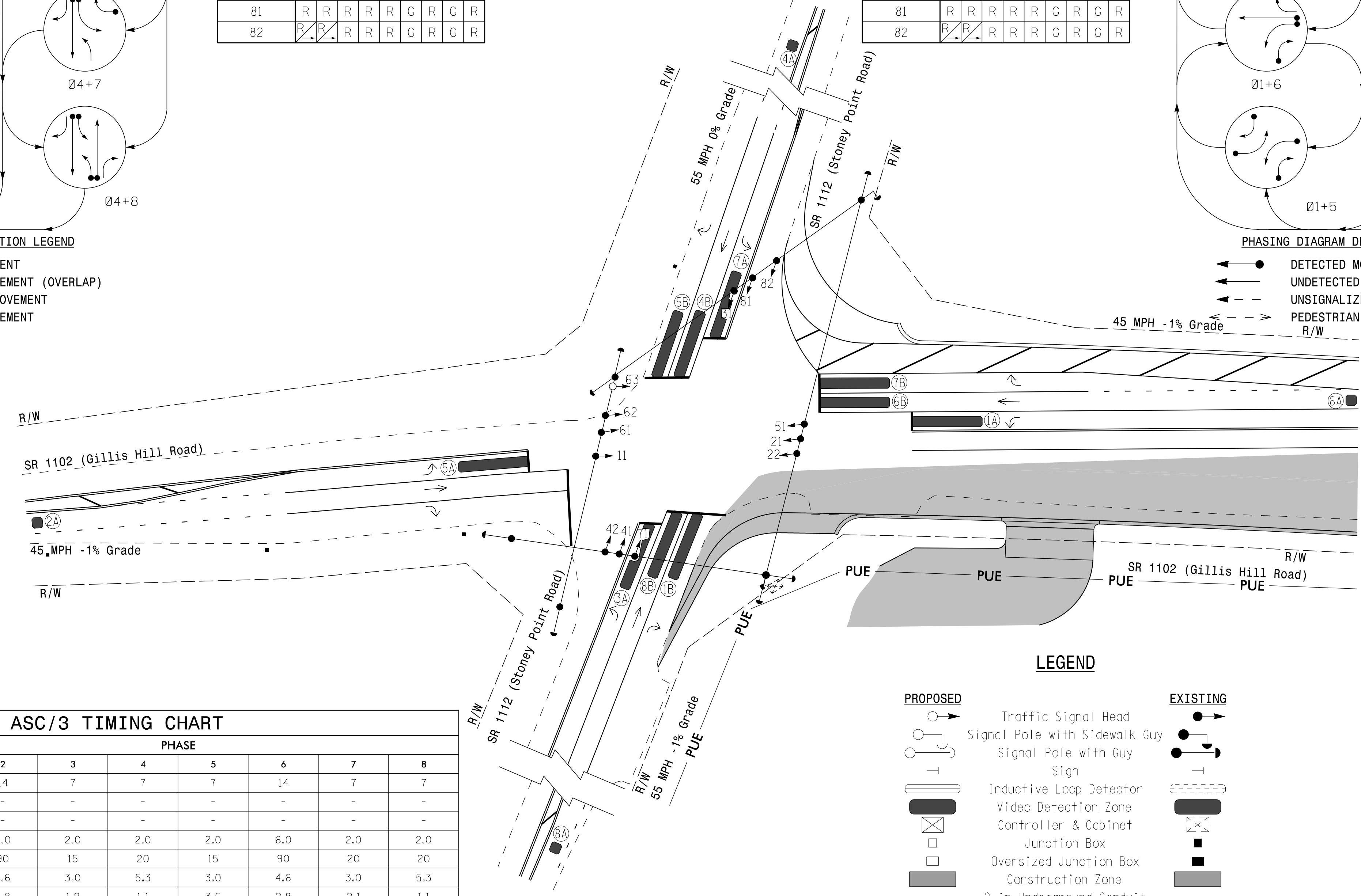

LEGEND

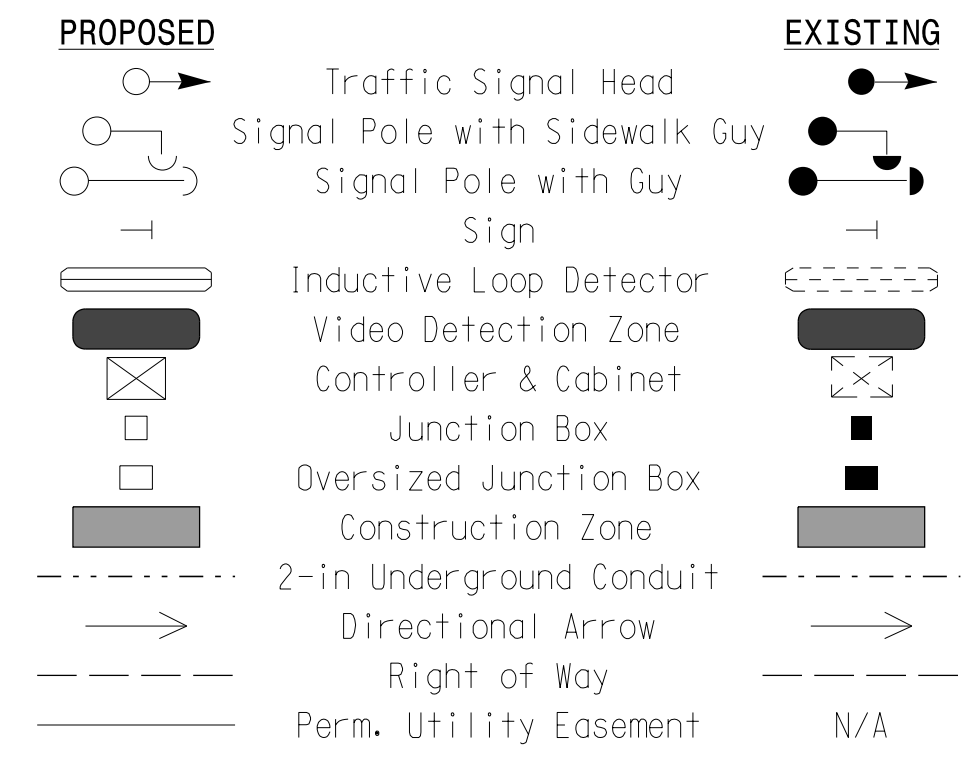

ASC/3 TIMING CHART

FEATURE	PHASE							
	1	2	3	4	5	6	7	8
Min Green *	7	14	7	7	7	14	7	7
Walk *	-	-	-	-	-	-	-	-
Ped Clear	-	-	-	-	-	-	-	-
Veh. Extension *	2.0	6.0	2.0	2.0	2.0	6.0	2.0	2.0
Max 1 *	30	90	15	20	15	90	20	20
Yellow	3.0	4.6	3.0	5.3	3.0	4.6	3.0	5.3
Red Clear	4.4	2.8	1.9	1.1	3.6	2.8	2.1	1.1
Actuations B4 Add *	-	0	-	-	-	0	-	-
Seconds / Actuation *	-	2.5	-	-	-	2.5	-	-
Max Initial *	-	34	-	-	-	34	-	-
Time Before Reduction *	-	15	-	-	-	15	-	-
Time To Reduce *	-	30	-	-	-	30	-	-
Minimum Gap	-	3.0	-	-	-	3.0	-	-
Locking Detector	-	X	-	-	-	X	-	-
Recall Position	-	VEH. RECALL	-	-	-	VEH. RECALL	-	-
Dual Entry	-	-	-	X	-	-	-	X
Simultaneous Gap	X	X	X	X	X	X	X	X

* These values may be field adjusted. Do not adjust Min Green and Extension times for phases 2 and 6 lower than what is shown. Min Green for all other phases should not be lower than 4 seconds.

ASC/3 DETECTOR INSTALLATION CHART

LOOP	SIZE (FT)	DISTANCE FROM STOPBAR (FT)	TURNS	NEW LOOP	PROGRAMMING							
					PHASE	CALLING	EXTEND TIME	DELAY TIME	USED ADDED INITIAL	TYPE	SYSTEM LOOP	NEW CARD
1A	6X40	0	*	*	1	YES	-	15+	-	N	-	*
6A	6X6	300	*	*	6	YES	-	3	-	G	-	*
1B	6X40	0	*	*	1	YES	-	15	-	N	-	*
2A	6X6	300	*	*	2	YES	-	-	X	N	-	*
3A	6X40	0	*	*	3	YES	-	15+	-	N	-	*
4A	6X6	420	*	*	4	NO	3.2	-	-	N	-	*
4B	6X40	0	*	*	4	YES	-	3	-	N	-	*
5A	6X40	0	*	*	5	YES	-	15+	-	N	-	*
5B	6X40	0	*	*	5	YES	-	15	-	N	-	*
6A	6X6	300	*	*	6	YES	-	-	X	N	-	*
7A	6X40	0	*	*	7	YES	-	15+	-	N	-	*
7B	6X40	0	*	*	7	YES	-	15	-	N	-	*
8A	6X6	420	*	*	8	NO	3.2	-	-	N	-	*
8B	6X40	0	*	*	8	YES	-	-	-	N	-	*

* Video Detection Zone
+ Reduce to 3 sec during Alt Phasing Ops
@ Disable calling during Alt Phasing Ops

Temporary Signal 2 - TCP Phase III

NC FIRM LICENSE No: F-0493
8521 SIX FORKS ROAD, SUITE 400
RALEIGH, NC 27615
(919) 926-4100

SR 1102 (Gillis Hill Road)
at
SR 1112 (Stoney Point Road)

Division 6 Cumberland County Fayetteville

PLAN DATE: January 2022 REVIEWED BY: S.G. Haynie

PREPARED BY: S.N. Matthews REVIEWED BY:

SEAL

1/5/2022