

PROJECT REFERENCE NO. U-5798A		SHEET NO. 5	
RW SHEET NO.			
ROADWAY DESIGN ENGINEER		HYDRAULICS ENGINEER	
DOCUMENT NOT CONSIDERED FINAL UNLESS ALL SIGNATURES COMPLETED			

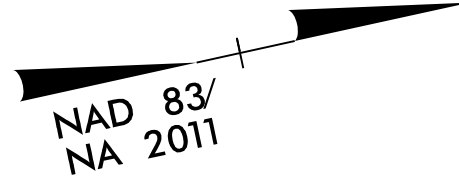

-L- CURVE DATA
 PI Sta 62+27.11
 $\Delta = 13^{\circ} 43' 19.0''$ (LT)
 $D = 0' 47' 36.9''$
 $L = 1,729.14'$
 $T = 868.73'$
 $R = 7,220.00'$
 SE = NC

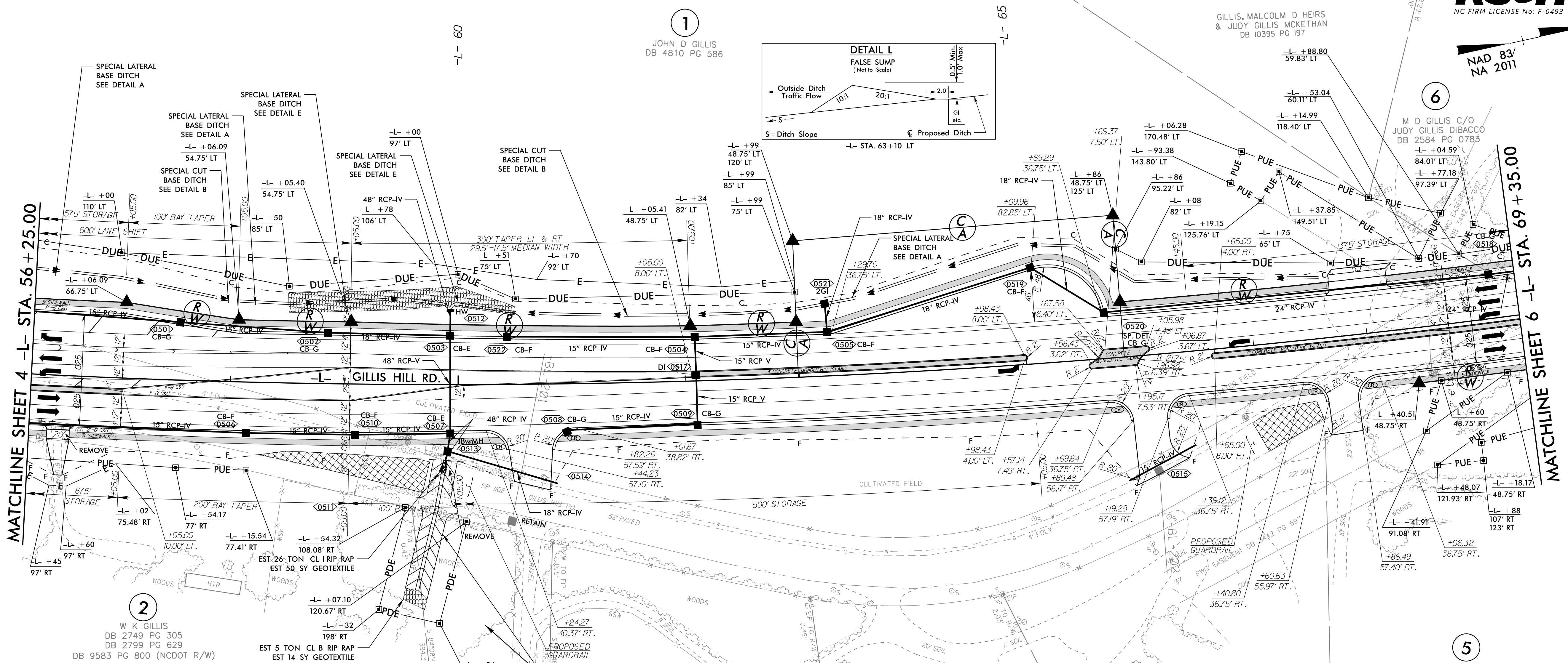

MATCHLINE SHEET 4 -L- STA. 56 + 25.00

MATCHLINE SHEET 6 -L- STA. 69 + 35.00

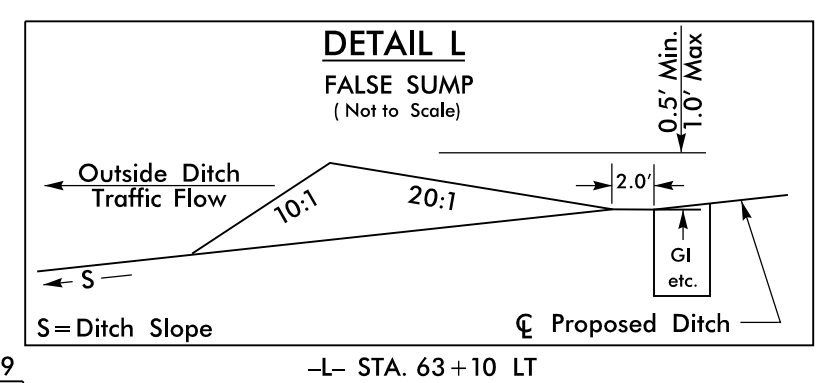
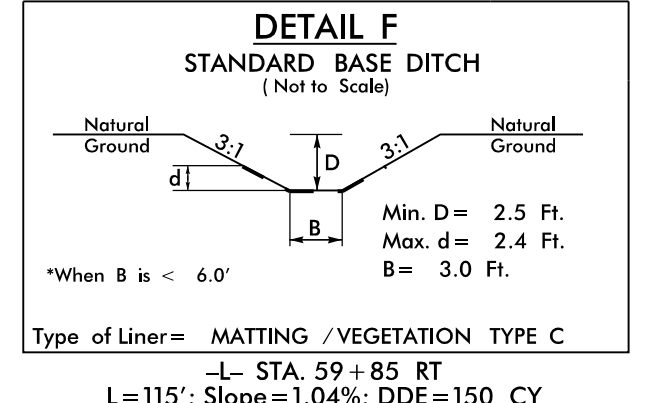
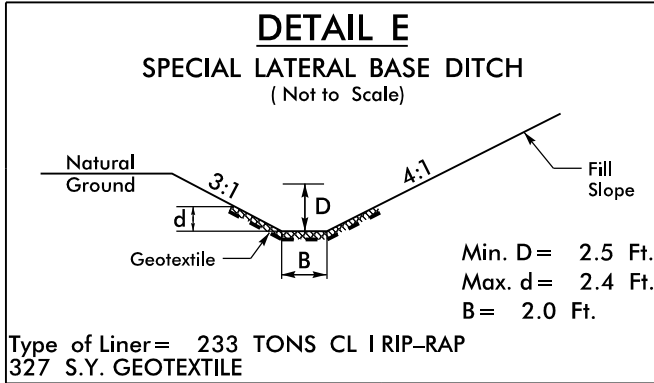
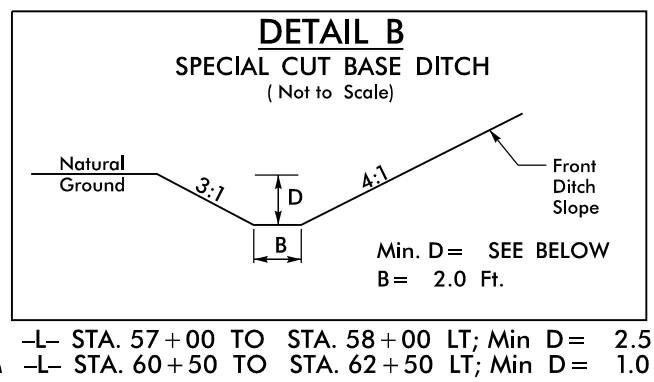
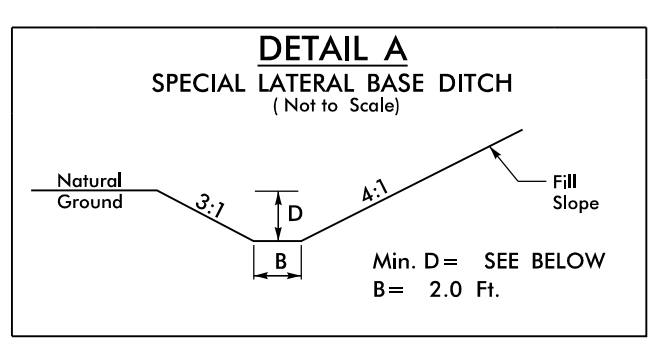

3 ROBERT LEWIS GILLIS & WIFE JUNE MONTGOMERY
DB 6959 PG 374

JOHN DAVIS II
DAVID MILLER GILLIS
DB 8113 PG 669

NATIONAL REGISTER-ELIGIBLE HISTORIC PROPERTY

FRANCIS GILLIS DINKINS
DB 2749 PG 304

4 DAVID MILLER GILLIS
JOHN DAVIS II
DB 7472 PG 454
NATIONAL REGISTER-ELIGIBLE HISTORIC PROPERTY

5 JOHN D GILLIS
DB 5280 PG 386
PB 51 PG 32

PAVEMENT REMOVAL

FOR -L- PROFILE, SEE SHEETS NO. 10

8.17.17.19.9
22-DEC-2021 15:06
P:\Projects\2021\U-5798A\U-5798A_Rdwy_psh_5.dgn
\$\$\$\$\$\$DISPERSE\$\$\$\$\$\$