

**STATE OF NORTH CAROLINA
DEPARTMENT OF TRANSPORTATION**

**PAVEMENT MARKING PLAN
ROWAN COUNTY**

LOCATION: SR 2528 (JULIAN ROAD) FROM
SR 2667 (SUMMIT PARK DRIVE) TO
US 601 (JAKE ALEXANDER BOULEVARD)
IN SALISBURY

T.I.P.: U-5738

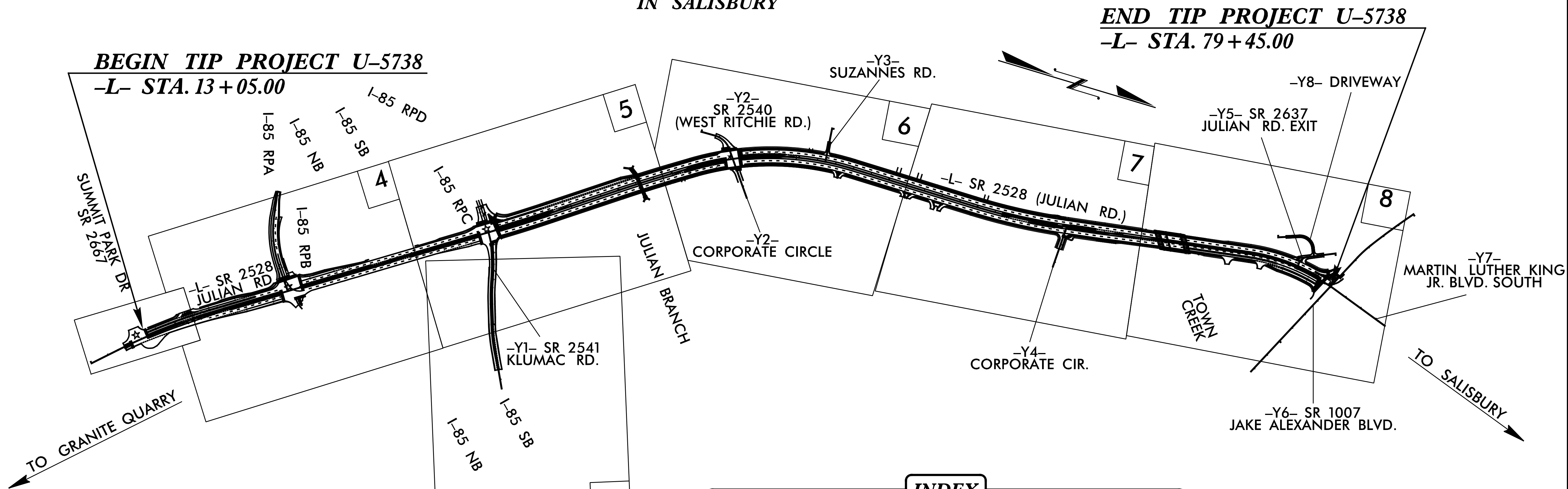

END TIP PROJECT U-5738
-L- STA. 79+45.00

BEGIN TIP PROJECT U-5738
-L- STA. 13+05.00

INDEX

SHEET NO.	DESCRIPTION
PMP-1	PAVEMENT MARKING PLAN TITLE SHEET
PMP-2	PAVEMENT MARKING SCHEDULE & SUMMARY OF QUANTITIES
PMP-3	GENERAL NOTES & ROADWAY STANDARD DRAWINGS
PMP-4-9	PAVEMENT MARKING DETAILS

CONTRACT:

CONTACTS: N.C.D.O.T. SIGNING AND DELINEATION UNIT

<u>Kelvin L. Jordan</u>	SIGNING & DELINEATION REGIONAL ENGINEER
<u>Jonrobert N. Navarrete</u>	SIGNING & DELINEATION PROJECT DESIGN ENGINEER

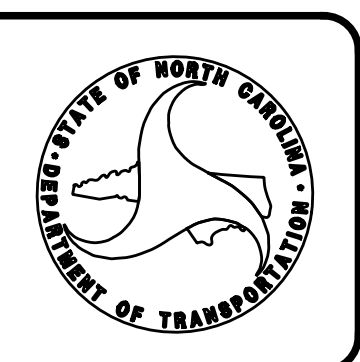

PLAN PREPARED BY:
SEPI, INC.

<u>Steve Miller, PE</u>	PROJECT MANAGER
<u>John Bauman, PE</u>	DESIGN ENGINEER

SEPI

1 Glenwood Avenue
Raleigh, NC 27603
Tel: 919.789.9977
Fax: 919.789.9591
License: C-2197

I:\6\2021\12\16\2016\008\002_U-5738\Traffic\VPMP\U-5738_PMP-1.dgn

PAVEMENT MARKING SCHEDULE

SYMBOL	DESCRIPTION	
T2	WHITE STOP BAR	<u>THERMOPLASTIC (24", 90 MILS)</u>
T9	2 FT. - 6 FT./ SP YELLOW MINISKIP	<u>THERMOPLASTIC (4", 90 MILS)</u>
TA	WHITE EDGE LINE	
TB	YELLOW EDGE LINE	
TC	10 FT. WHITE SKIP	
TD	3 FT. - 9 FT./SP WHITE MINISKIP	
TE	WHITE SOLID LANE LINE	
TI	YELLOW DOUBLE CENTER	
T6	WHITE EDGE LINE	<u>THERMOPLASTIC (6", 90 MILS)</u>
T7	YELLOW EDGE LINE	
T11	2 FT. - 6 FT./SP WHITE MINISKIP	
TJ	10 FT. WHITE SKIP	
TK	3 FT. - 9 FT./SP WHITE MINISKIP	
TL	WHITE SOLID LANE LINE	
T13	3 FT. - 9 FT./SP WHITE MINISKIP	<u>THERMOPLASTIC (8", 90 MILS)</u>
TN	WHITE GORE LINE	
TO	WHITE DIAGONAL	
TP	YELLOW DIAGONAL	
TQ	WHITE CROSSWALK LINE	
TR	WHITE SOLID LANE LINE	
TU	WHITE DIAGONAL	<u>THERMOPLASTIC (12", 90 MILS)</u>
TV	YELLOW DIAGONAL	
UA	LEFT TURN ARROW	<u>THERMOPLASTIC PAVEMENT MARKING SYMBOLS (90 MILS)</u>
UB	RIGHT TURN ARROW	
UC	STRAIGHT ARROW	
UD	COMBO LEFT/STRAIGHT ARROW	
UE	COMBO RIGHT/STRAIGHT ARROW	
UK	BICYCLE STRAIGHT ARROW	
UJ	BICYCLE SYMBOL	
UN	24" YIELD LINE TRIANGLE	
UQ	RAMP ARROW SYMBOL	
US	BICYCLE LOOP DETECTOR	
UT	U-TURN ARROW	
UI	ALPHANUMERIC CHARACTER	<u>THERMOPLASTIC PAVEMENT MARKING SYMBOLS (90 MILS)</u>
CA	WHITE EDGE LINE	<u>COLD APPLIED PLASTIC TYPE III (4")</u>
CB	YELLOW EDGE LINE	
CC	10 FT. WHITE SKIP	
CD	3 FT. - 9 FT./SP WHITE MINISKIP	
CI	YELLOW DOUBLE CENTER	
CL	WHITE SOLID LANE LINE	<u>COLD APPLIED PLASTIC TYPE III (6")</u>
CV	YELLOW DIAGONAL	<u>COLD APPLIED PLASTIC TYPE III (12")</u>
MA	YELLOW & YELLOW	<u>PAVEMENT MARKERS</u>
MB	CRYSTAL & RED	

SUMMARY OF QUANTITIES

ITEM NO.		ITEM DESCRIPTION	QUANTITY	UNIT
DESC. NO.	SECT. NO.			
4685000000-E	1205	THERMOPLASTIC PAVEMENT MARKING LINES (4", 90 MILS)	20555	LF
4688000000-E	1205	THERMOPLASTIC PAVEMENT MARKING LINES (6", 90 MILS)	1690	LF
4695000000-E	1205	THERMOPLASTIC PAVEMENT MARKING LINES (8", 90 MILS)	5460	LF
4700000000-E	1205	THERMOPLASTIC PAVEMENT MARKING LINES (12", 90 MILS)	500	LF
4891000000-E	1205	THERMOPLASTIC PAVEMENT MARKING LINES (24", 90 MILS)	700	LF
4892000000-N	1205	THERMOPLASTIC PAVEMENT MARKING CHARACTER (90 MILS)	24	EA
4725000000-E	1205	THERMOPLASTIC PAVEMENT MARKING SYMBOL (90 MILS)	139	EA
4770000000-E	1205	COLD APPLIED PLASTIC PAVEMENT MARKING LINES, TYPE III(4")	2055	LF
4775000000-E	1205	COLD APPLIED PLASTIC PAVEMENT MARKING LINES, TYPE III(6")	230	LF
4785000000-E	1205	COLD APPLIED PLASTIC PAVEMENT MARKING LINES, TYPE III(12")	130	LF
4900000000-N	1251	PERMANENT RAISED PAVEMENT MARKERS	1015	EA

I:\6208\RD16.008.00_U-5738\Traffic\PMP\U-5738.PMP-2.dgn
 11/15/01
 11:51:00 AM

GENERAL NOTES

THE FOLLOWING GENERAL NOTES APPLY AT ALL TIMES FOR THE DURATION OF THE CONSTRUCTION PROJECT, EXCEPT WHEN OTHERWISE NOTED IN THE PLAN, OR DIRECTED BY THE ENGINEER.

- A) INSTALL PAVEMENT MARKINGS AND PAVEMENT MARKERS ON THE FINAL SURFACE AS FOLLOWS:

ROAD NAME	MARKING	MARKER
SR 2528	THERMOPLASTIC	RAISED
BRIDGE	COLD APPLIED PLASTIC	NONE
-Y- LINES	TYPE III THERMOPLASTIC	RAISED
- B) TIE PROPOSED PAVEMENT MARKING LINES TO EXISTING PAVEMENT MARKING LINES.
- C) REMOVE/REPLACE ANY CONFLICTING/DAMAGED PAVEMENT MARKINGS AND MARKERS.
- D) STOP BAR LOCATION AT NON-SIGNALIZED INTERSECTIONS MAY BE ADJUSTED AS DIRECTED BY THE ENGINEER.
- E) REMOVE ALL RESIDUE AND SURFACE LAITANCE BY ACCEPTABLE METHODS ON CONCRETE BRIDGE DECKS PRIOR TO PLACING COLD APPLIED PLASTIC TYPE III PAVEMENT MARKINGS.
- F) UNLESS OTHERWISE SPECIFIED, HEATED-IN-PLACE THERMOPLASTIC MAY BE USED IN LIEU OF EXTRUDED THERMOPLASTIC FOR STOP BARS, SYMBOLS, CHARACTERS AND DIAGONALS. IF HEATED-IN-PLACE IS USED, IT SHALL BE PAID FOR USING THE EXTRUDED THERMOPLASTIC PAY ITEM.
- G) UNLESS OTHERWISE SPECIFIED, HEATED-IN-PLACE THERMOPLASTIC MAY BE USED IN LIEU OF COLD APPLIED PLASTIC FOR STOP BARS, SYMBOLS, CHARACTERS AND DIAGONALS ON ASPHALT OR CONCRETE ROADWAYS. IF HEATED-IN-PLACE IS USED, IT SHALL BE PAID FOR USING THE COLD APPLIED PLASTIC PAY ITEM.
- H) ALL BICYCLE LANE SYMBOLS SHALL BE HEATED-IN-PLACE THERMOPLASTIC. SYMBOLS SHALL BE PAID FOR USING THE HEATED-IN-PLACE PAY ITEM.
- I) SEE ROADWAY PLANS FOR ALTERNATE CURB RAMP DESIGNS WHEN INDICATED ON PAVEMENT MARKING DETAIL SHEETS.

ROADWAY STANDARD DRAWINGS

THE FOLLOWING ROADWAY STANDARDS AS APPEAR IN "ROADWAY STANDARD DRAWINGS" - PROJECT SERVICES UNIT - N.C. DEPARTMENT OF TRANSPORTATION - RALEIGH, N.C., DATED JANUARY 2018 ARE APPLICABLE TO THIS PROJECT AND BY REFERENCE HEREBY ARE CONSIDERED A PART OF THESE PLANS:

STD. NO.	TITLE
1205.01	PAVEMENT MARKINGS - LINE TYPES AND OFFSETS
1205.02	PAVEMENT MARKINGS - TWO-LANE AND MULTILANE ROADWAYS
1205.04	PAVEMENT MARKINGS - INTERSECTIONS
1205.05	PAVEMENT MARKINGS - TURN LANES
1205.06	PAVEMENT MARKINGS - LANE DROPS (REPLACED BY SIGN-3)
1205.07	PAVEMENT MARKINGS - PEDESTRIAN CROSSWALKS
1205.08	PAVEMENT MARKINGS - SYMBOLS AND WORD MESSAGES
1205.09	PAVEMENT MARKINGS - PAINTED ISLANDS
1205.12	PAVEMENT MARKINGS - BRIDGES
1205.15	PAVEMENT MARKINGS - SUPERSTREETS
1250.01	RAISED PAVEMENT MARKERS - INSTALLATION SPACING
1251.01	RAISED PAVEMENT MARKERS - PERMANENT AND TEMPORARY
1261.01	GUARDRAIL AND BARRIER DELINEATORS - INSTALLATION SPACING
1261.02	GUARDRAIL AND BARRIER DELINEATORS - TYPES AND MOUNTING
1262.01	GUARDRAIL END DELINEATION

K:\6\2018\016\008\00_U-5738\Traffic\PMP\U-5738.PMP-3.dgn

APPROVED: _____
DATE: _____
SEAL

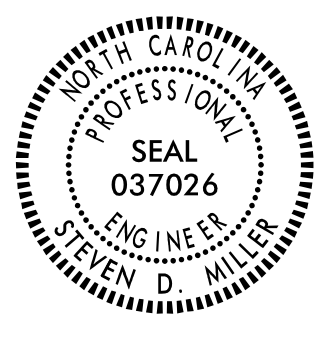

DOCUMENT NOT CONSIDERED FINAL
UNLESS ALL SIGNATURES COMPLETED

NUMBER	CURB RAMP	STATION
⊙	TYPICAL 11	-L-STA 15+32
⊙	TYPICAL 10	-L-STA 16+20
⊙	TYPICAL 11	-L-STA 20+86
⊙	TYPICAL 11	-L-STA 22+06

15

20

25

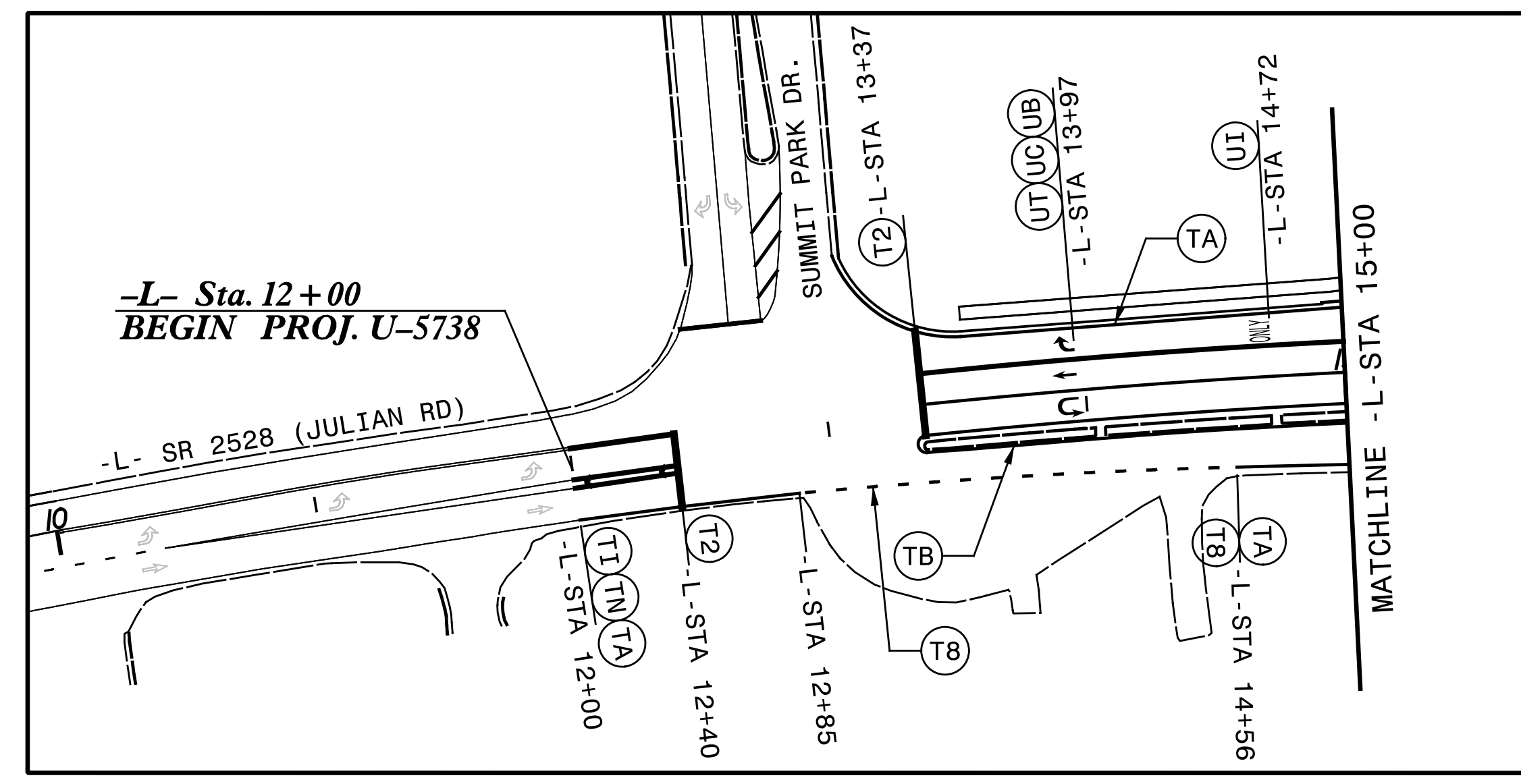
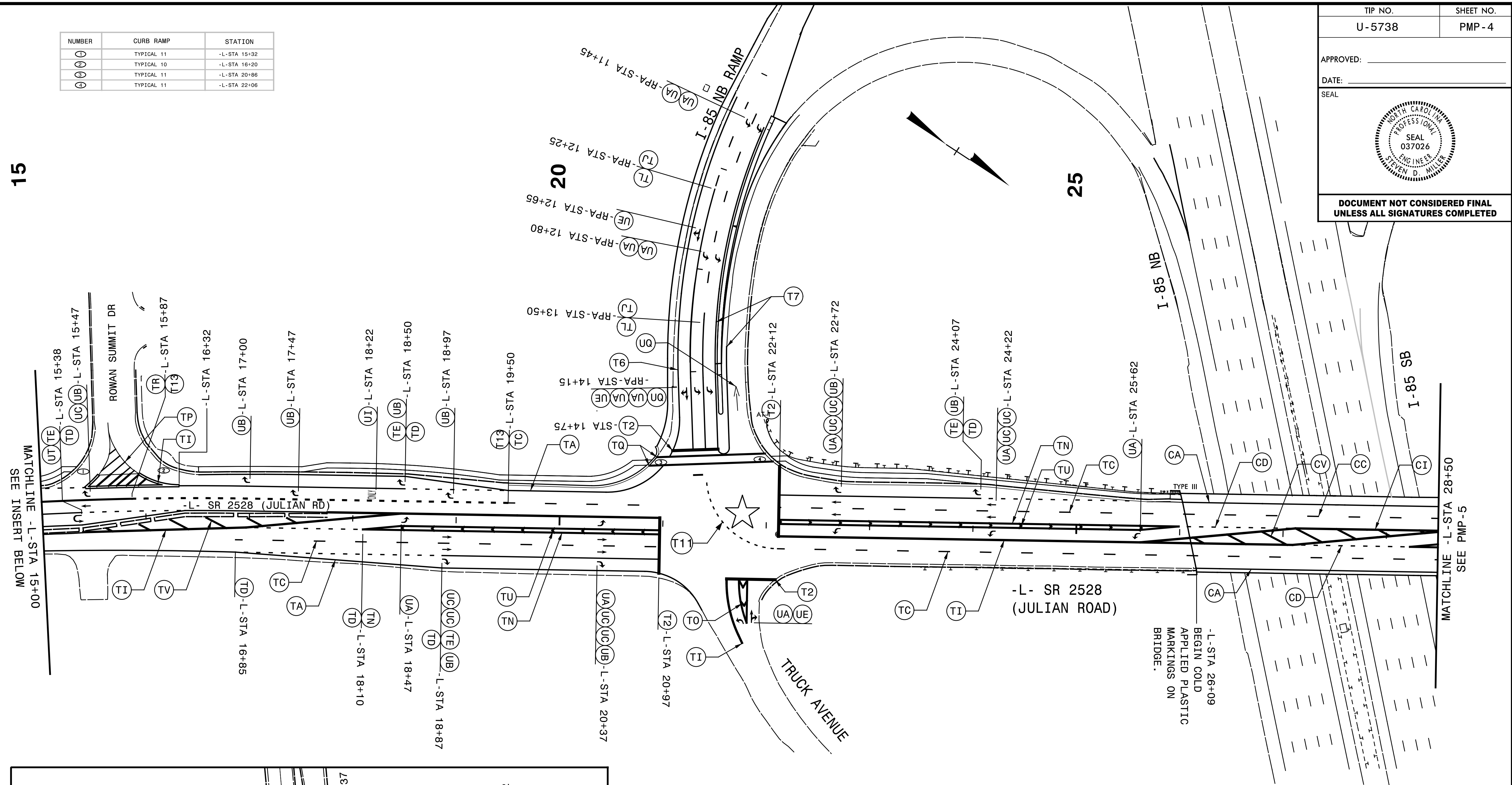

★ SIGNALIZED INTERSECTION



1 Glenwood Avenue
Raleigh, NC 27603
Tel: 919.789.9977
Fax: 919.789.9591
License: C-2197

PAVEMENT MARKING DETAIL

APPROVED: _____
 DATE: _____

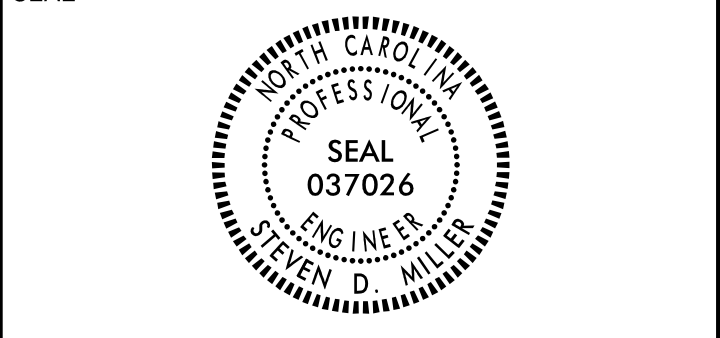

**DOCUMENT NOT CONSIDERED FINAL
 UNLESS ALL SIGNATURES COMPLETED**

NUMBER	CURB RAMP	STATION
(1)	TYPICAL 11	-L-STA 32+07
(2)	TRIANGULAR ISLAND W/ CUT THROUGH	-L-STA 33+03
(3)	TYPICAL 9	-L-STA 33+17
(4)	TYPICAL 9	-L-STA 33+27

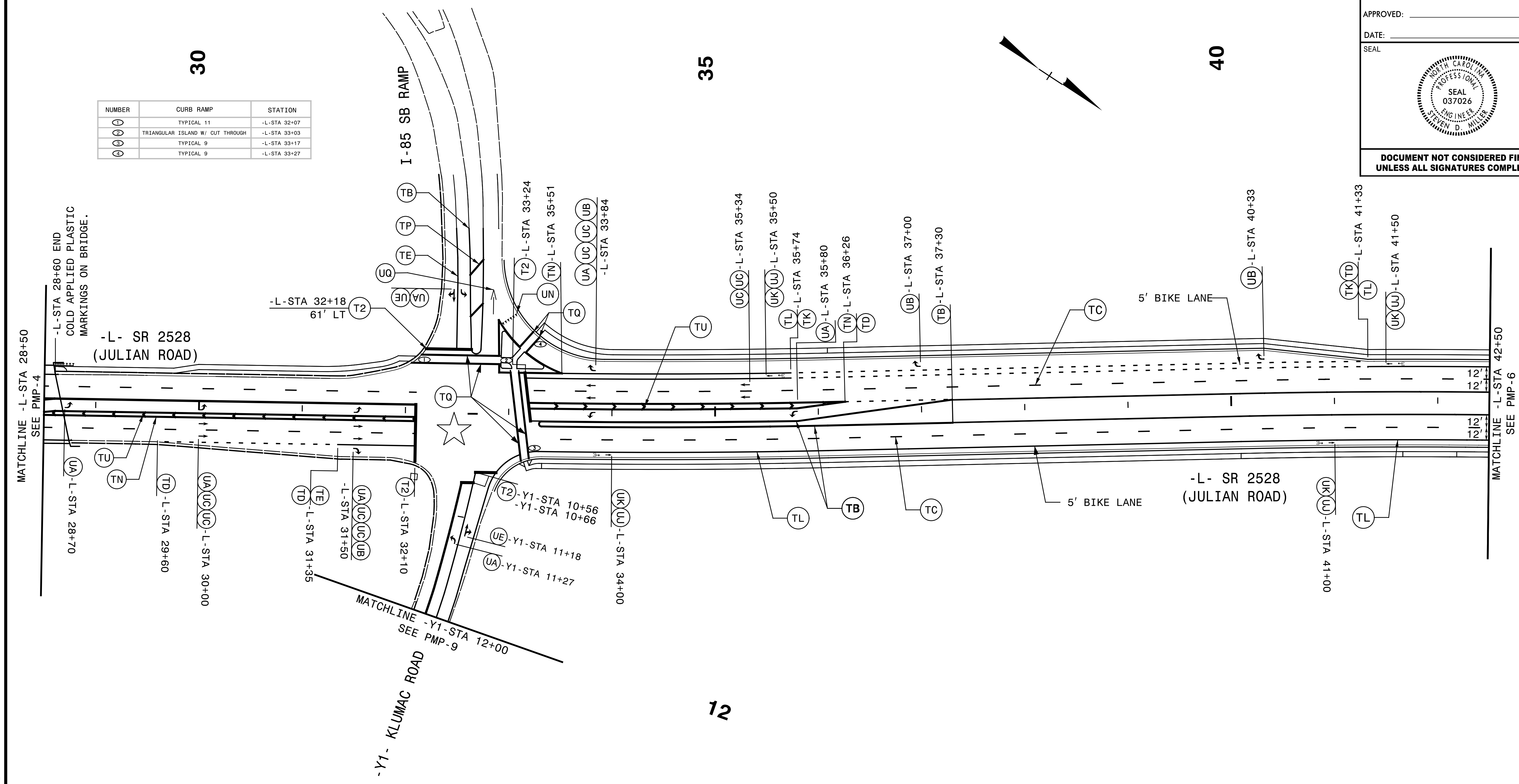

★ SIGNALIZED INTERSECTION

V:\2018\Projects\008.00.U-5738\Traffic\PMP\U-5738.PMP-5.dgn
 12/15/2018 10:08:00 AM

	1 Glenwood Avenue Raleigh, NC 27603 Tel: 919.789.9977 Fax: 919.789.9591 License: C-2197	<h2>PAVEMENT MARKING DETAIL</h2>
--	---	----------------------------------

APPROVED: _____
 DATE: _____

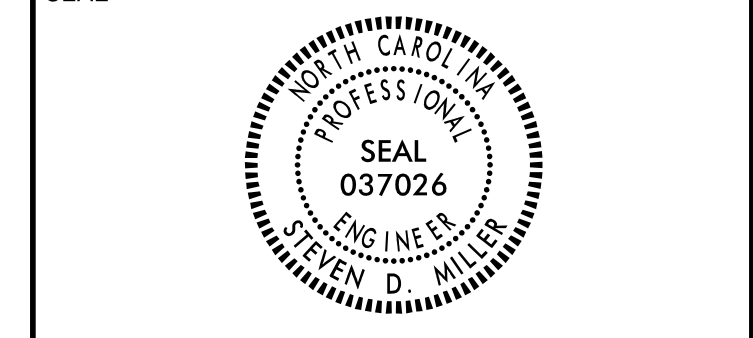

**DOCUMENT NOT CONSIDERED FINAL
 UNLESS ALL SIGNATURES COMPLETED**

NUMBER	CURB RAMP	STATION
①	TYPICAL 11	-L-STA 45+84
②	TYPICAL 11	-L-STA 46+11
③	TYPICAL 11	-L-STA 46+78
④	TYPICAL 11	-L-STA 46+84
⑤	TYPICAL 11	-L-STA 51+32
⑥	TYPICAL 11	-L-STA 51+57
⑦	TYPICAL 11	-L-STA 51+97
⑧	TYPICAL 11	-L-STA 52+57
⑨	TYPICAL 11	-L-STA 55+78

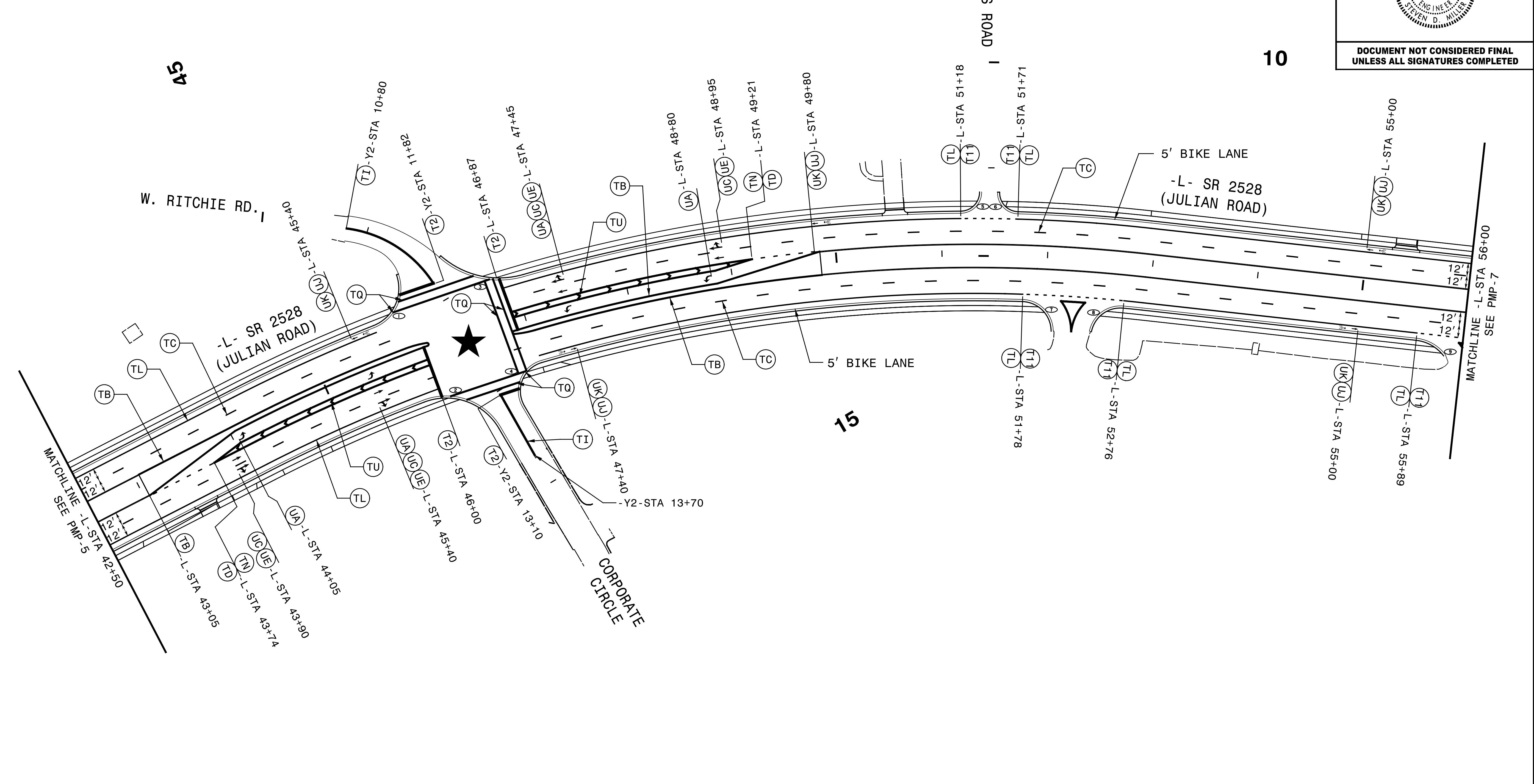

★ PROPOSED
 SIGNALIZED INTERSECTION

V:\2018\016\008\00_U-5738\Traffic\PMP-U-5738.PMP-6.dgn
 1/11/2018 10:00:00 AM
 User: jhumber

1 Glenwood Avenue
 Raleigh, NC 27603
 Tel: 919.789.9977
 Fax: 919.789.9591
 License: C-2197

PAVEMENT MARKING DETAIL

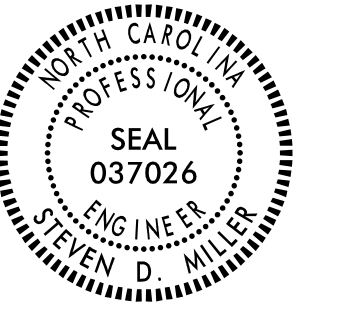

DOCUMENT NOT CONSIDERED FINAL
UNLESS ALL SIGNATURES COMPLETED

NUMBER	CURB RAMP	STATION
⊖	TYPICAL 11	-L-STA 56+53
⊖	TYPICAL 11	-L-STA 57+42
⊖	TYPICAL 11	-L-STA 58+32
⊖	TYPICAL 9	-L-STA 64+61
⊖	TYPICAL 9	-L-STA 65+06

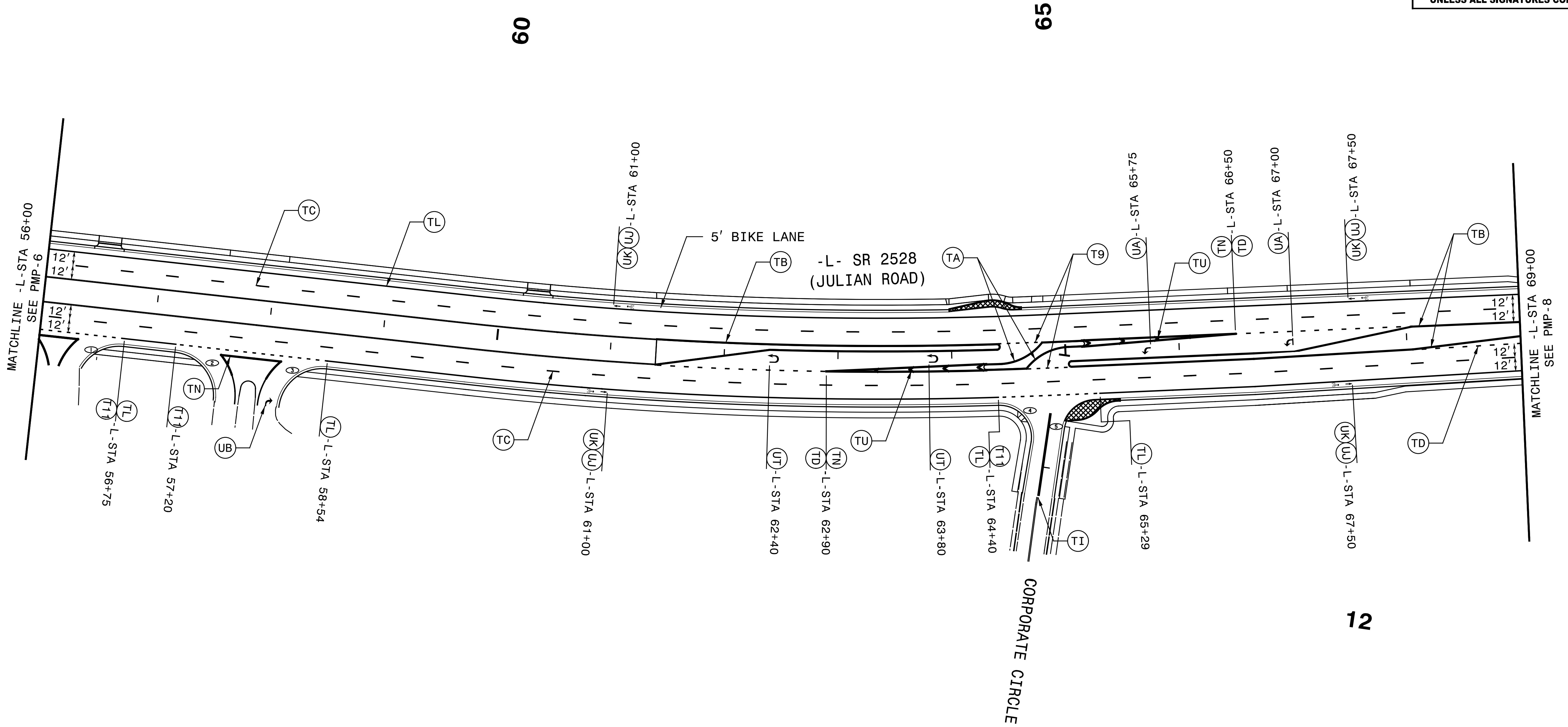

I:\Projects\2016\08\08\U-5738\Traffic\PMU-U-5738.PMP-7.dgn

SEPI
 1 Glenwood Avenue
 Raleigh, NC 27603
 Tel: 919.789.9977
 Fax: 919.789.9591
 License: C-2197

PAVEMENT MARKING DETAIL

NUMBER	CURB RAMP	STATION
	TYPICAL 11	-L-STA 73+52
	TYPICAL 11	-L-STA 74+09
	TYPICAL 11	-L-STA 75+37
	TYPICAL 11	-L-STA 75+90
	TYPICAL 11	-L-STA 77+33
	TYPICAL 11	-L-STA 77+91
	TYPICAL 10	-L-STA 79+05
	TYPICAL 10	-L-STA 79+12
	TRIANGLE ISLAND W/ CUT THROUGH	-L-STA 79+27

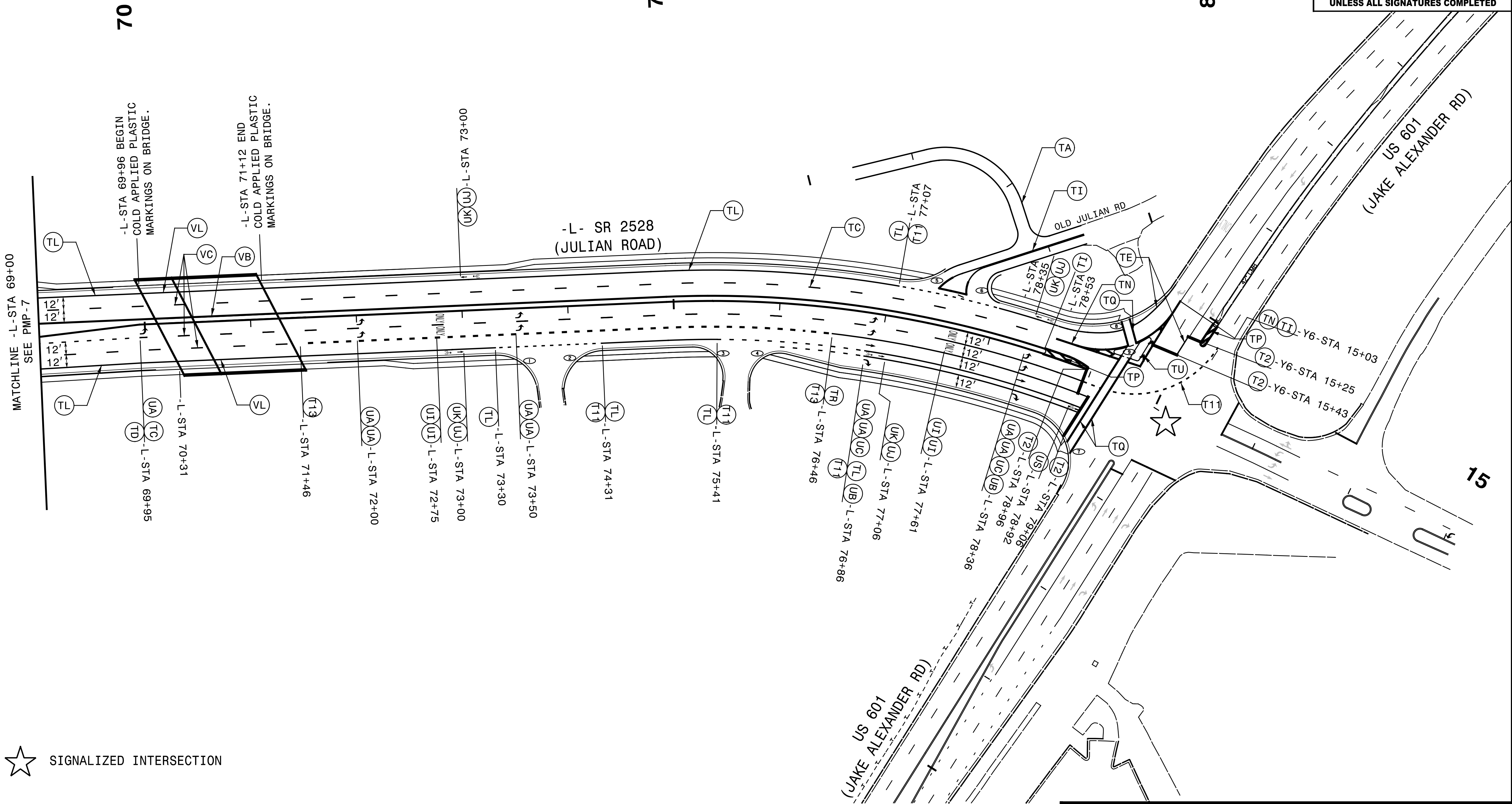

SIGNALIZED INTERSECTION

SEPI
 1 Glenwood Avenue
 Raleigh, NC 27603
 Tel: 919.789.9977
 Fax: 919.789.9591
 License: C-2197

PAVEMENT MARKING DETAIL

I:\Projects\2016\08\08\U-5738\Traffic\PMP\U-5738.PMP-8.dgn
 8/28/16 10:08 AM
 User: smp

APPROVED: _____
 DATE: _____

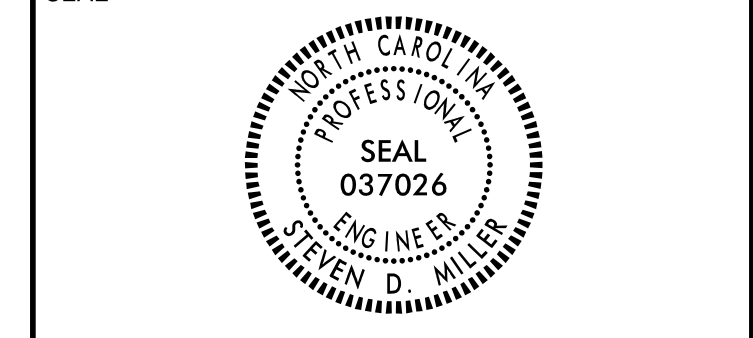

**DOCUMENT NOT CONSIDERED FINAL
 UNLESS ALL SIGNATURES COMPLETED**

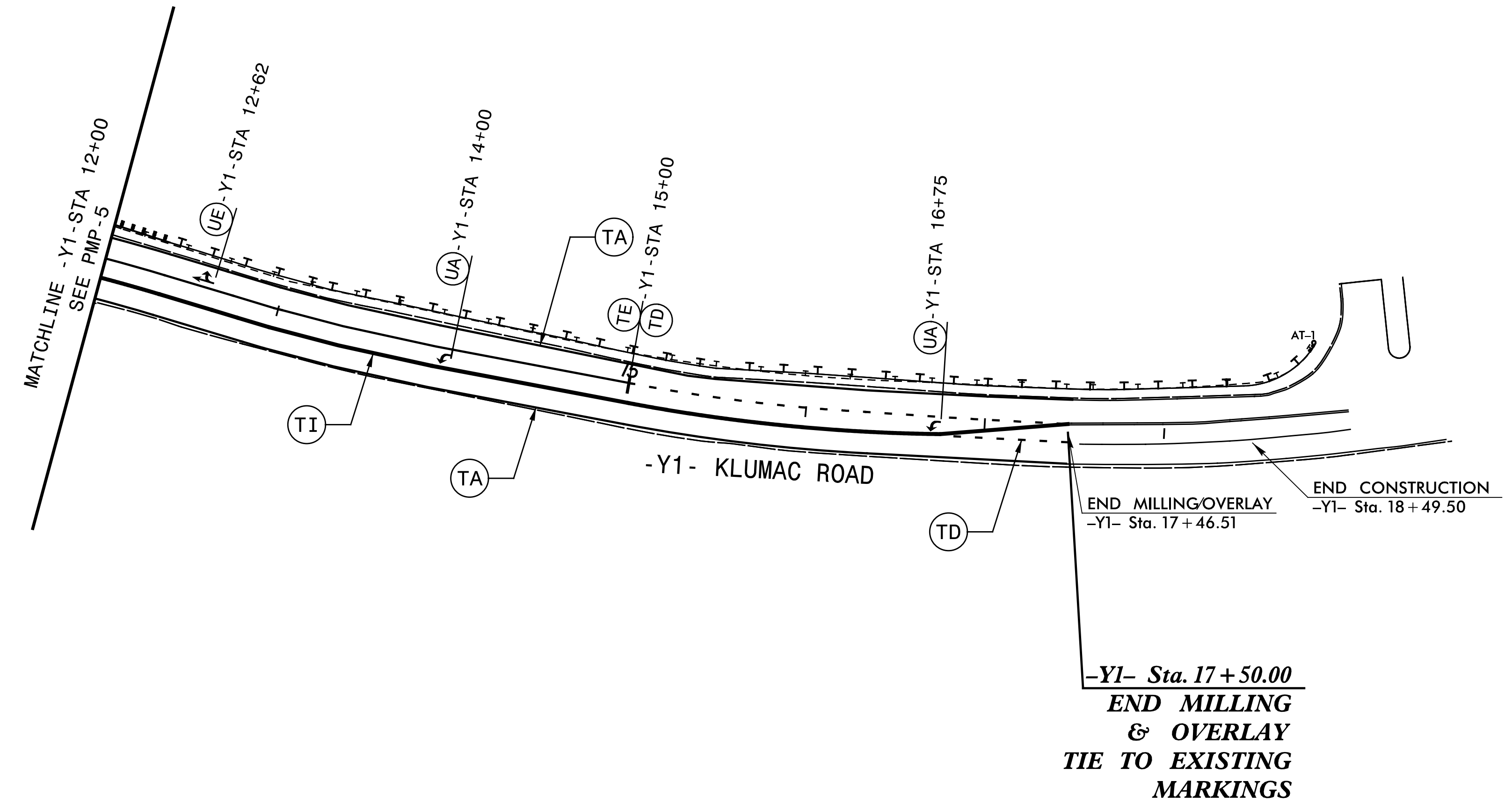
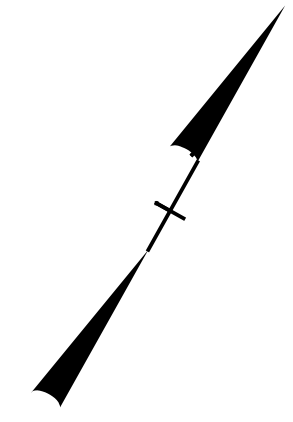

I:\2008\08\08\08\U-5738\Traffic\PMP\U-5738.PMP-9.dgn
 12/16/08
 11:41 AM

1 Glenwood Avenue
 Raleigh, NC 27603
 Tel: 919.789.9977
 Fax: 919.789.9591
 License: C-2197

PAVEMENT MARKING DETAIL