

5/28/99

PROJECT REFERENCE NO. U-5738 SHEET NO. 10

ROADWAY DESIGN ENGINEER SEAL 033871 DANIEL W. GARDNER, JR.	HYDRAULICS ENGINEER SEAL 039122 GREGORY W. BRICKHAM
<i>Daniel W. Gardner, Jr.</i>	<i>Gregory Brickham</i>

DOCUMENT NOT CONSIDERED FINAL UNLESS ALL SIGNATURES COMPLETED

**SEPI**  
ENGINEERING & CONSTRUCTION

1 Glenwood Avenue  
Raleigh, NC 27603  
Tel: 919.789.9977  
Fax: 919.789.9591  
License: C-2197

BEGIN TIP PROJECT U-5738 -L- STA.13+05.00  
CONSTRUCT SIDEWALKS AT EXISTING GRADE

END SIDEWALK  
-L- STA.15+34.97

-L-

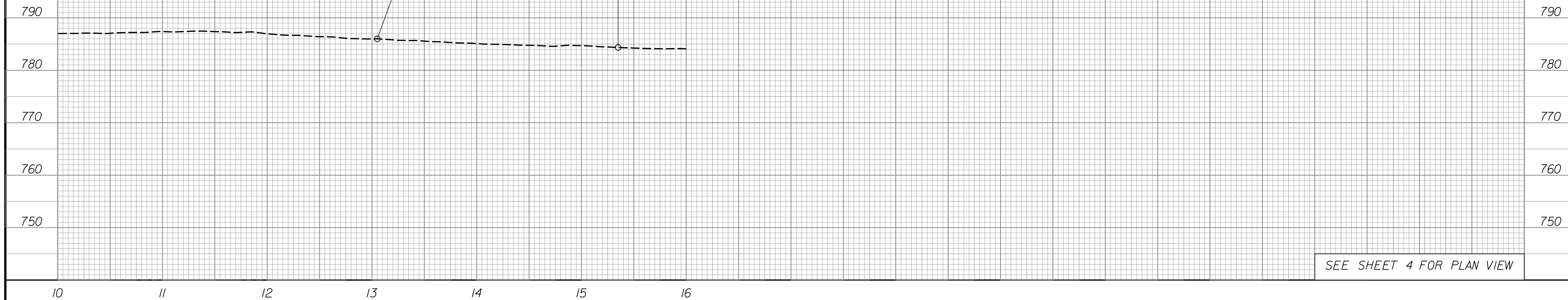

BEGIN SIDEWALK  
-L- STA.16+50.72

EXISTING GROUND

END SIDEWALK  
-L- STA.20+88.70

BEGIN SIDEWALK  
-L- STA.22+03.42

END SIDEWALK  
-L- STA.25+90.36

-L-

BM1 ELEVATION = 781.92'  
N 688798 E 1557651  
L STATION 21+97.00 69' RIGHT  
CHISELED SQUARE IN TOP CURB  
AT EASTERN TERMINUS OF CURB  
ON NORTH SIDE OF TRUCK AVENUE

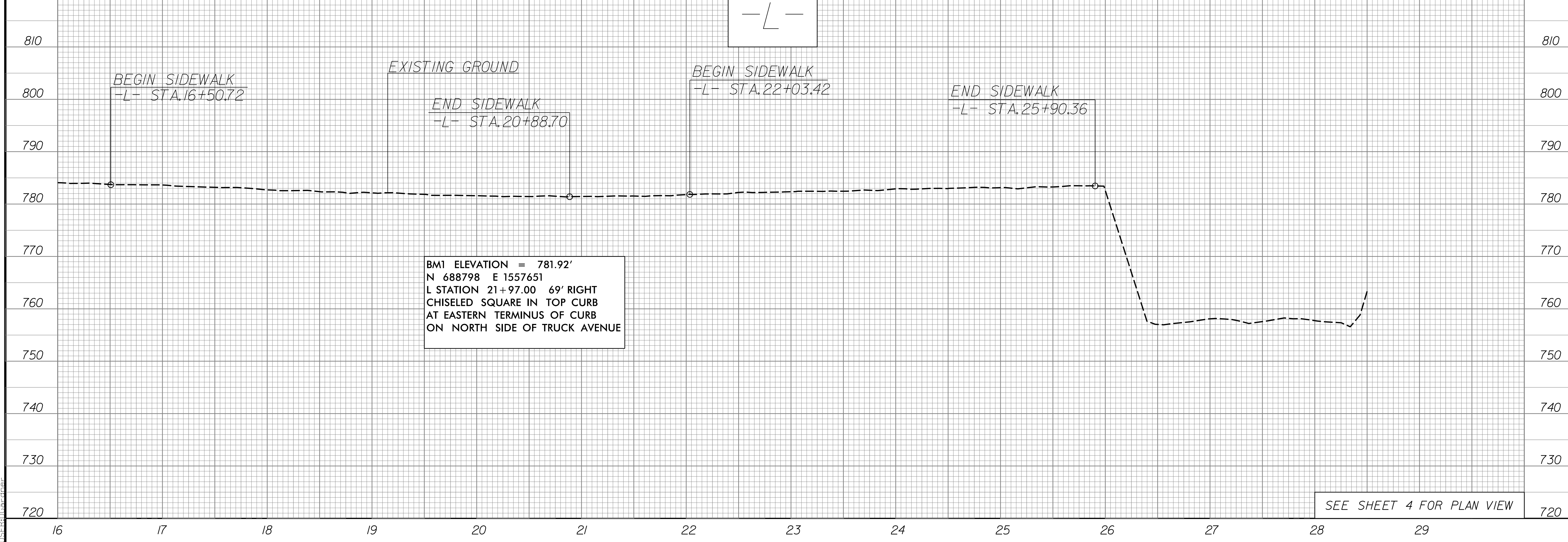

11/19/2021 11:51:10 AM I:\Projects\U5738\_Rd4\_e\1\_10.dgn