

**PLAN OF SIDEWALK (STAGE I & STAGE II)**  
RIGHT SIDE SHOWN, LEFT SIDE SIMILAR

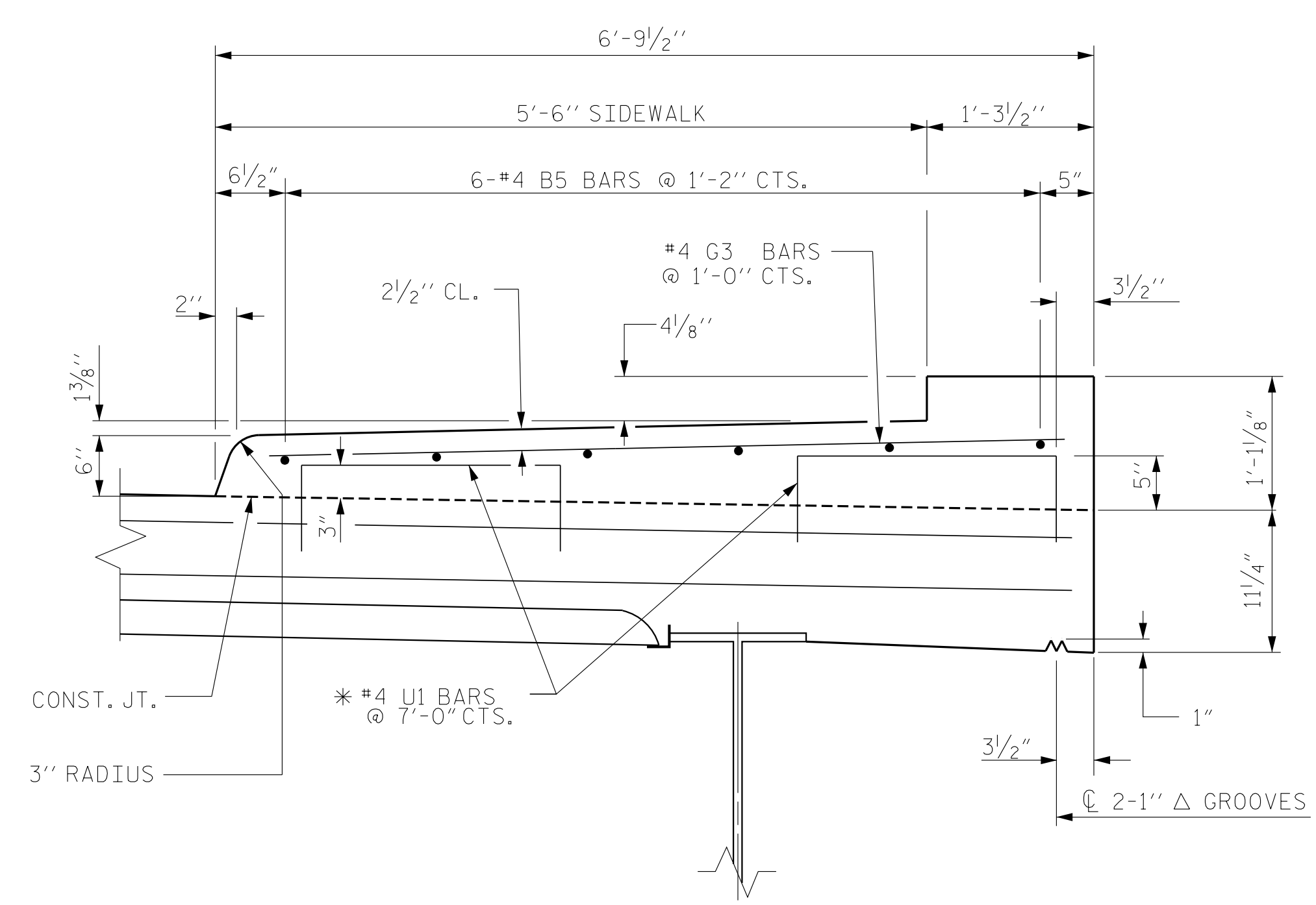

**SECTION THRU SIDEWALK**

\* "U" BARS MAY BE PUSHED INTO GREEN CONCRETE AFTER SPAN HAS BEEN SCREEDED OFF.

**NOTES**

THE CONCRETE AND REINFORCING STEEL REQUIRED FOR THE SIDEWALKS IS INCLUDED IN THE SUPERSTRUCTURE BILL OF MATERIAL AND PAYMENT IS INCLUDED IN THE SQUARE FOOT PRICE BID FOR "REINFORCED CONCRETE DECK SLAB."

THE #4U1 BARS MAY BE PUSHED INTO GREEN CONCRETE AFTER SPAN HAS BEEN SCREEDED OFF.

SIDEWALK SHALL NOT BE CAST UNTIL ALL SLAB CONCRETE IN THE UNIT HAS BEEN CAST AND HAS REACHED A MINIMUM COMPRESSIVE STRENGTH OF 3000 PSI.

THE JOINT IN THE DECK AT THE END BENTS AND LINK SLAB AT THE BENT SHALL BE SAWED PRIOR TO THE CASTING OF THE SIDEWALKS.

ALL REINFORCING STEEL IN SIDEWALKS SHALL BE EPOXY COATED.

GROOVED CONTRACTION JOINTS, 1/2" IN DEPTH, SHALL BE TOOLED IN ALL EXPOSED FACES OF THE SIDEWALK IN ACCORDANCE WITH ARTICLE 825-10(B) OF THE STANDARD SPECIFICATIONS. THE CONTRACTION JOINTS SHALL BE LOCATED AT A SPACING OF 8 FT. TO 10 FT. BETWEEN EXPANSION JOINTS. NO CONTRACTION JOINT WILL BE REQUIRED FOR SEGMENTS LESS THAN 10 FT. IN LENGTH.

**V&M**  
Vaughn & Melton  
Consulting Engineers

Asheville, North Carolina  
828-253-2796

Boone, NC 828-355-9933  
Tri-Cities, TN 423-467-8401  
Knoxville, TN 865-546-5800  
Spartanburg, SC 864-574-4775  
Charleston, SC 843-974-5650  
Middleboro, KY 506-248-6600  
Raleigh, NC 919-977-9455  
Charlotte, NC 704-357-0488  
Atlanta, GA 770-627-3509

Copyright © 2006 Vaughn & Melton, Inc. All Rights Reserved.



PROJECT NO. U-5738  
ROWAN COUNTY  
STATION: 70+72.50 -L-  
SHEET 4 OF 4

STATE OF NORTH CAROLINA  
DEPARTMENT OF TRANSPORTATION  
RALEIGH  
SUPERSTRUCTURE  
PLAN OF SPANS  
SIDEWALKS

DOCUMENT NOT CONSIDERED FINAL UNLESS ALL SIGNATURES COMPLETED		DWN. BY: FRJ	DATE: 11/18	REVISIONS		SHEET NO. S-11
		CHKD. BY: CDB	DATE: 11/18	NO.	BY:	TOTAL SHEETS 39
		DES. EGR. OF RECORD: CDB	DATE: 11/18	1		
				2		
				3		
				4		