

TRAFFIC CONTROL STAGING

STAGE 1
 USING THIS SHEET AND ROADWAY STANDARD DRAWING (RSD) 1101.02, SHEET 3 OF 14, CLOSE THE OUTSIDE WESTBOUND TRAVEL LANE AND COMPLETE SUPERSTRUCTURE BRIDGE WORK ALONG THE RIGHT SIDE OF BRIDGE NO. 81.

NOTE: WORK MAY ALSO BEGIN ON SUBSTRUCTURE AT THIS TIME UTILIZING THE CURRENT LANE CLOSURE OPERATION

REPLACE PAVEMENT MARKINGS OBLITERATED DURING DECK WORK WITH TEMPORARY PAVEMENT MARKINGS IN THEIR ORIGINAL LOCATIONS UNTIL FINAL MARKINGS ARE INSTALLED.

STAGE 2
 USING THIS SHEET AND RSD 1101.02, SHEET 3 OF 14, CLOSE THE INSIDE WESTBOUND TRAVEL LANE AND COMPLETE SUPERSTRUCTURE BRIDGE WORK ALONG THE LEFT SIDE OF BRIDGE NO. 81.

NOTE: WORK MAY CONTINUE ON SUBSTRUCTURE DURING STAGE 2 CONSTRUCTION AND SHALL BE COMPLETED DURING THIS STAGE

REPLACE PAVEMENT MARKINGS OBLITERATED DURING DECK WORK WITH TEMPORARY PAVEMENT MARKINGS IN THEIR ORIGINAL LOCATIONS UNTIL FINAL MARKINGS ARE INSTALLED.

STAGE 3
 AT THE COMPLETION OF ALL BRIDGE WORK, USING RSD 1101.02, SHEET 3 OF 14, MILL APPROACH ROADWAY AND OVERLAY AS SHOWN IN THE STRUCTURE PLANS, THEN USE RSD 1101.02, SHEET 12 OF 14 TO PLACE FINAL PAVEMENT MARKINGS AND MARKERS IN THEIR ORIGINAL LOCATIONS.

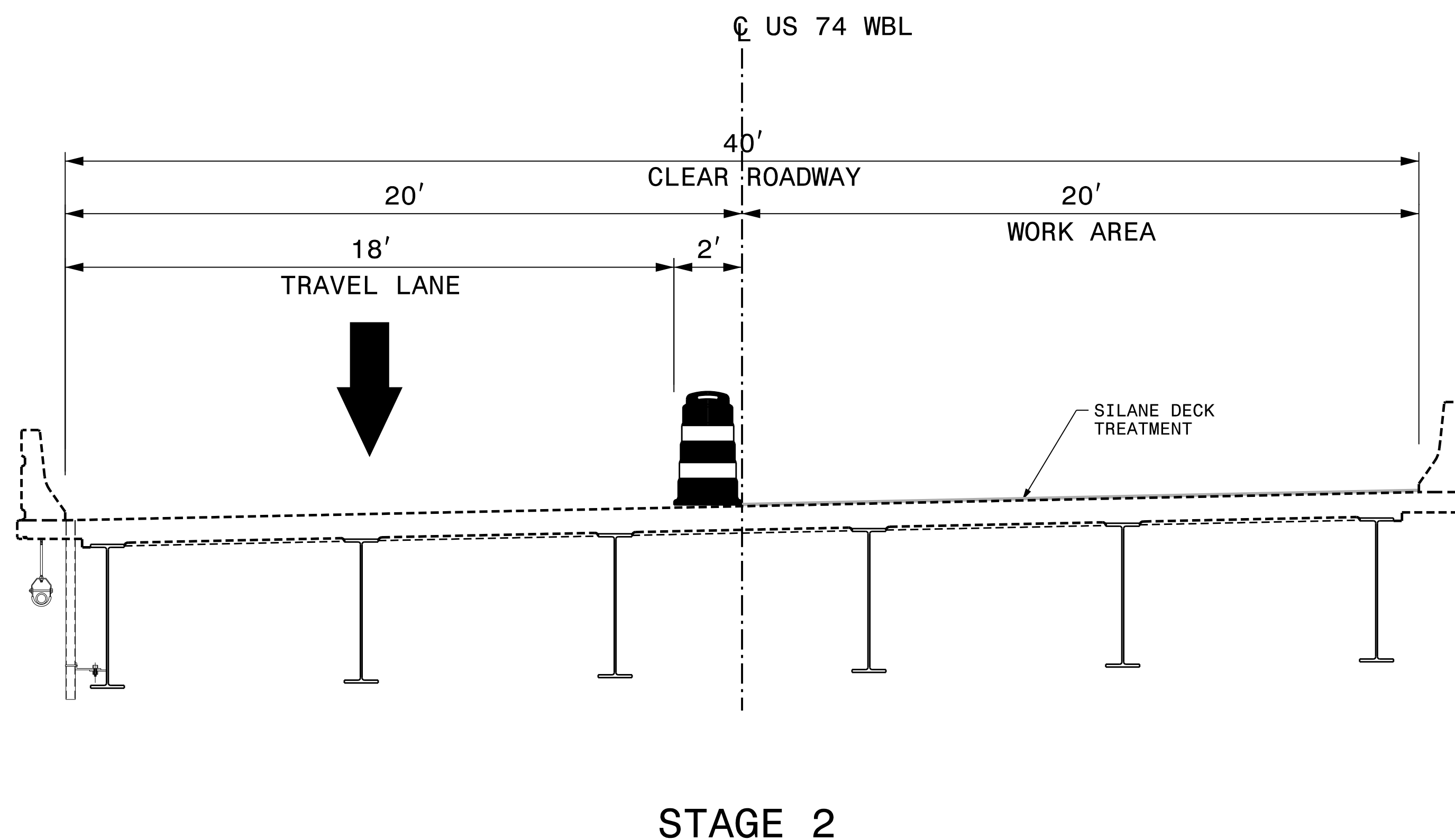

APPROVED: *Michelle Ward*

DATE: 2/12/2019

SEAL

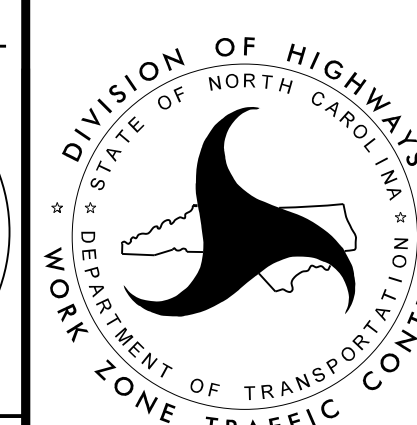
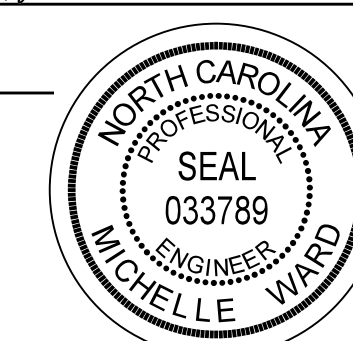

**BRIDGE NO. 81
 TYPICAL SECTION
 & PHASING**

**DOCUMENT NOT CONSIDERED FINAL
 UNLESS ALL SIGNATURES COMPLETED**

PLOT DRIVER: NCDOT_pdf_color_eng_50.plt
 USER: BSCOTT
 DATE: 2/12/2019
 TIME: 5:24:18 PM
 FILE: p:\pwhdr\users\01\HDR-US-East-01\Documents\3322\10001863\10132171\6.0_CAD_BIM\6.1_Final\Plan Set 78\TMP\TMP-TMP-04.dgn

REVISIONS