

8/17/99

INSTALL FABRIC INSERT INLET PROTECTION DEVICE IN LIEU OF ROCK INLET SEDIMENT TRAP TYPE 'C' AS DIRECTED TO AVOID PONDING OF RUNOFF IN ROADWAY OPEN TO PUBLIC TRAFFIC

PROJECT REFERENCE NO.	SHEET NO.
U-5896	EC-09/CONST.04
RW SHEET NO.	
M MOTT MACDONALD PO Box 700 Fuquay-Varina, NC 27526 www.mottmac.com/americas	
vhb VHB Engineering NC, P.C. (C-3705) 940 Main Campus Drive, Suite 500 Raleigh, NC 27606	

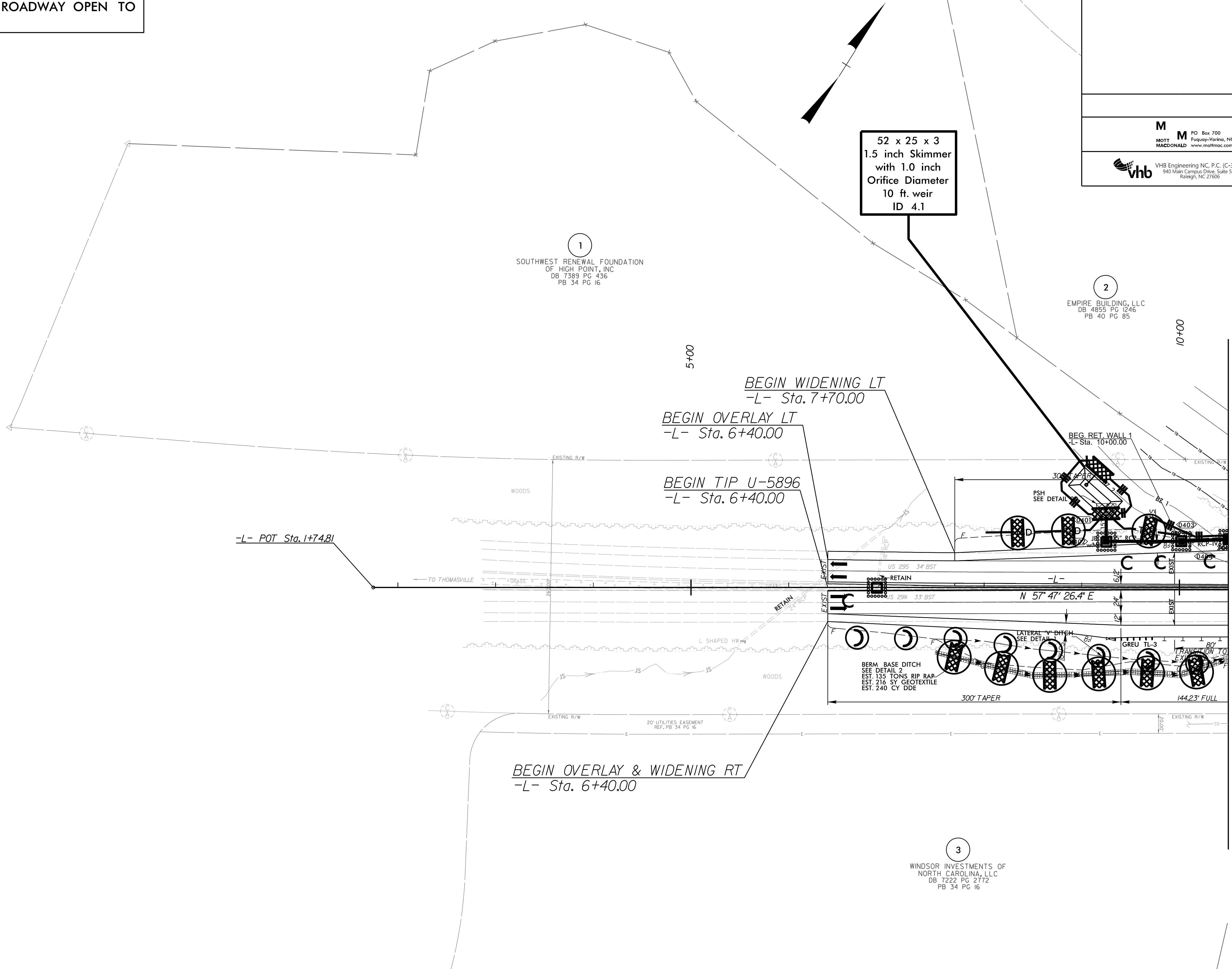

MATCHLINE -L- STA 10+50.00
SEE SHEET NO. 5

8/4/04 3:43 AM
R:\Environmental\Design\PSHU-5896.REU-psu04_FINAL.dgn
berger