

PERMANENT LOAD FACTORS:

LOAD TYPE	MAX FACTOR	MIN FACTOR
DC	1.25	0.90
DW	1.50	0.65
EV	1.30	0.90
EH	1.35	0.90
ES	1.35	0.90
WA	1.00	--

LOAD AND RESISTANCE FACTOR RATING (LRFR) SUMMARY FOR REINFORCED CONCRETE BOX CULVERTS										
	CONTROLLING LOAD RATING	MINIMUM RATING FACTOR (RF)	STRENGTH I LIMIT STATE							
			MOMENT				SHEAR			
			RATING FACTOR	BOX NO.	ELEMENT TYPE	DISTANCE FROM LEFT END OF ELEMENT (FT)	RATING FACTOR	BOX NO.	ELEMENT TYPE	DISTANCE FROM LEFT END OF ELEMENT (FT)
PERMANENT LOAD RATING	①	1.09	1.09	1	BOTTOM SLAB	5.00	1.42	1	BOTT. SLAB	2.65

NOTES:

RATING FACTORS ARE BASED ON THE STRENGTH I LIMIT STATE.

THE EFFECTS OF LIVE LOAD ON DESIGN AND LOAD RATING MAY BE NEGLECTED FOR CULVERTS WITH CERTAIN FILL DEPTHS DESCRIBED IN THE AASHTO LRFD BRIDGE DESIGN SPECIFICATIONS.

CULVERTS WITH NEGLIGIBLE LIVE LOAD SHOULD BE LOAD RATED FOR PERMANENT LOADS ONLY IN ACCORDANCE WITH THE AASHTO MANUAL FOR BRIDGE EVALUATION.

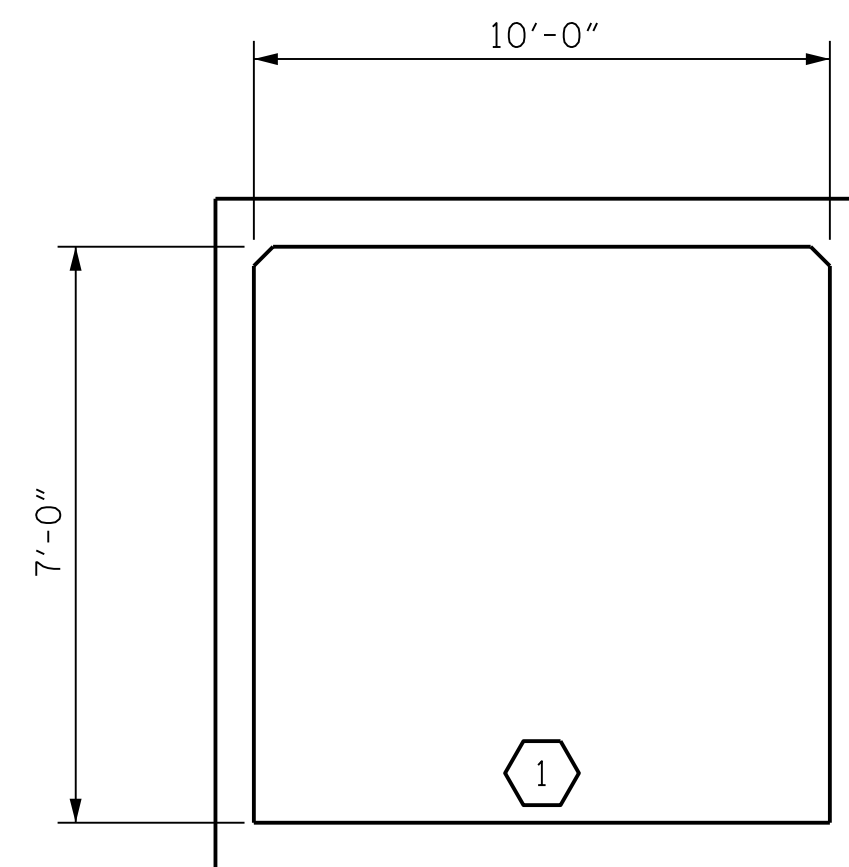

LRFR SUMMARY
(LOOKING DOWNSTREAM)

PROJECT NO. R-2233BB
RUTHERFORD COUNTY
 STATION: 797+66.00 -L3-

SHEET 5 OF 5

STATE OF NORTH CAROLINA
 DEPARTMENT OF TRANSPORTATION
 RALEIGH
 STANDARD
 LRFR SUMMARY FOR
 REINFORCED CONCRETE
 BOX CULVERTS
 (DEEP FILLS)

REVISIONS

NO.	BY:	DATE:	NO.	BY:	DATE:	SHEET NO.
1			3			C1-5
2			4			TOTAL SHEETS 5



333 FAYETTEVILLE STREET, SUITE 500
 RALEIGH, NC 27601
 NC LICENSE NO. C-2979

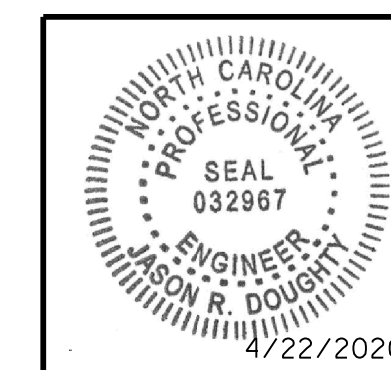

DocuSigned by:
 Jason R Doughty
 SF73FA2DEA874E8...

**DOCUMENT NOT CONSIDERED FINAL
 UNLESS ALL SIGNATURES COMPLETED**

CUL 1

STD. NO. LRFR7

4/22/2020
 410_009_R2233BB_SMU_LRFR.dgn

DESIGNED BY: A. DUTTA DATE : JULY 2019
 DRAWN BY: K. WHITE DATE : JULY 2019
 CHECKED BY: B. LOFLIN DATE : AUG 2019
 DESIGN ENGINEER OF RECORD: J. DOUGHTY DATE : NOV 2019