

## LOAD AND RESISTANCE FACTOR RATING (LRFR) SUMMARY FOR PRESTRESSED CONCRETE GIRDERS

LEVEL	VEHICLE	WEIGHT (W) (TONS)	CONTROLLING LOAD RATING #	MINIMUM RATING FACTORS (RF)	TONS = W x RF	STRENGTH I LIMIT STATE										SERVICE III LIMIT STATE					COMMENT NUMBER			
						MOMENT					SHEAR					MOMENT								
						LIVE-LOAD FACTORS (γ <sub>LL</sub> )	DISTRIBUTION FACTORS (DF)	RATING FACTOR	SPAN	GIRDER LOCATION	DISTANCE FROM LEFT END OF SPAN (FT)	DISTRIBUTION FACTORS (DF)	RATING FACTOR	SPAN	GIRDER LOCATION	DISTANCE FROM LEFT END OF SPAN (FT)	LIVE-LOAD FACTORS (γ <sub>LL</sub> )	DISTRIBUTION FACTORS (DF)	RATING FACTOR	SPAN		GIRDER LOCATION	DISTANCE FROM LEFT END OF SPAN (FT)	
DESIGN LOAD RATING	HL-93 (INVENTORY)	N/A	①	1.19	--	1.75	0.741	1.58	A	E	49.8	0.888	1.19	A	I	9.4	0.80	0.741	1.21	A	E	49.8		
	HL-93 (OPERATING)	N/A		1.58	--	1.35	0.741	2.05	A	E	49.8	0.888	1.58	A	I	9.4	N/A	--	--	--	--	--		
	HS-20 (INVENTORY)	36.000	②	1.63	58.68	1.75	0.741	2.20	A	E	49.8	0.888	1.63	A	I	9.4	0.80	0.741	1.68	A	E	49.8		
	HS-20 (OPERATING)	36.000		2.15	77.40	1.35	0.741	2.86	A	E	49.8	0.888	2.15	A	I	9.4	N/A	--	--	--	--	--		
LEGAL LOAD RATING	SINGLE VEHICLE (SV)	SNSH	13.500		3.99	53.87	1.40	0.741	6.54	A	E	49.8	0.888	5.26	A	I	9.4	0.80	0.741	3.99	A	E	49.8	
		SNGARBS2	20.000		2.89	57.80	1.40	0.741	4.73	A	E	49.8	0.888	3.65	A	I	9.4	0.80	0.741	2.89	A	E	49.8	
		SNAGRIS2	22.000		2.70	59.40	1.40	0.741	4.43	A	E	49.8	0.888	3.36	A	I	9.4	0.80	0.741	2.70	A	E	49.8	
		SNCOTTS3	27.250		1.98	53.96	1.40	0.741	3.25	A	E	49.8	0.888	2.56	A	I	9.4	0.80	0.741	1.98	A	E	49.8	
		SNAGGRS4	34.925		1.62	56.58	1.40	0.741	2.66	A	E	49.8	0.888	2.06	A	I	9.4	0.80	0.741	1.62	A	E	49.8	
		SNS5A	35.550		1.59	56.52	1.40	0.741	2.61	A	E	49.8	0.888	2.07	A	I	9.4	0.80	0.741	1.59	A	E	49.8	
		SNS6A	39.950		1.45	57.93	1.40	0.741	2.37	A	E	49.8	0.888	1.87	A	I	9.4	0.80	0.741	1.45	A	E	49.8	
		SNS7B	42.000		1.38	57.96	1.40	0.741	2.26	A	E	49.8	0.888	1.81	A	I	9.4	0.80	0.741	1.38	A	E	49.8	
	TRUCK TRACTOR SEMI-TRAILER (TTST)	TNAGRIT3	33.000		1.76	58.08	1.40	0.741	2.88	A	E	49.8	0.888	2.25	A	I	9.4	0.80	0.741	1.76	A	E	49.8	
		TNT4A	33.075		1.76	58.21	1.40	0.741	2.89	A	E	49.8	0.888	2.21	A	I	9.4	0.80	0.741	1.76	A	E	49.8	
		TNT6A	41.600		1.43	59.49	1.40	0.741	2.34	A	E	49.8	0.888	1.90	A	I	9.4	0.80	0.741	1.43	A	E	49.8	
		TNT7A	42.000		1.43	60.06	1.40	0.741	2.34	A	E	49.8	0.888	1.87	A	I	9.4	0.80	0.741	1.43	A	E	49.8	
		TNT7B	42.000		1.46	61.32	1.40	0.741	2.40	A	E	49.8	0.888	1.78	A	I	9.4	0.80	0.741	1.46	A	E	49.8	
		TNAGRIT4	43.000		1.40	60.20	1.40	0.741	2.30	A	E	49.8	0.888	1.72	A	I	9.4	0.80	0.741	1.40	A	E	49.8	
TNAGT5A	45.000		1.33	59.85	1.40	0.741	2.18	A	E	49.8	0.888	1.69	A	I	9.4	0.80	0.741	1.33	A	E	49.8			
TNAGT5B	45.000		③	1.32	59.40	1.40	0.741	2.16	A	E	49.8	0.888	1.64	A	I	9.4	0.80	0.741	1.32	A	E	49.8		

**LOAD FACTORS:**

DESIGN LOAD RATING FACTORS	LIMIT STATE	γ <sub>DC</sub>	γ <sub>DW</sub>
	STRENGTH I	1.25	1.50
	SERVICE III	1.00	1.00

**NOTES:**

MINIMUM RATING FACTORS ARE BASED ON THE STRENGTH I AND SERVICE III LIMIT STATES.  
ALLOWABLE STRESSES FOR SERVICE III LIMIT STATE ARE AS REQUIRED FOR DESIGN.

**COMMENTS:**

- 1.
- 2.
- 3.
- 4.

⊠ CONTROLLING LOAD RATING

① DESIGN LOAD RATING (HL-93)

② DESIGN LOAD RATING (HS-20)

③ LEGAL LOAD RATING \*\*

\*\* SEE CHART FOR VEHICLE TYPE

---

GIRDER LOCATION

I - INTERIOR GIRDER  
EL - EXTERIOR LEFT GIRDER  
ER - EXTERIOR RIGHT GIRDER

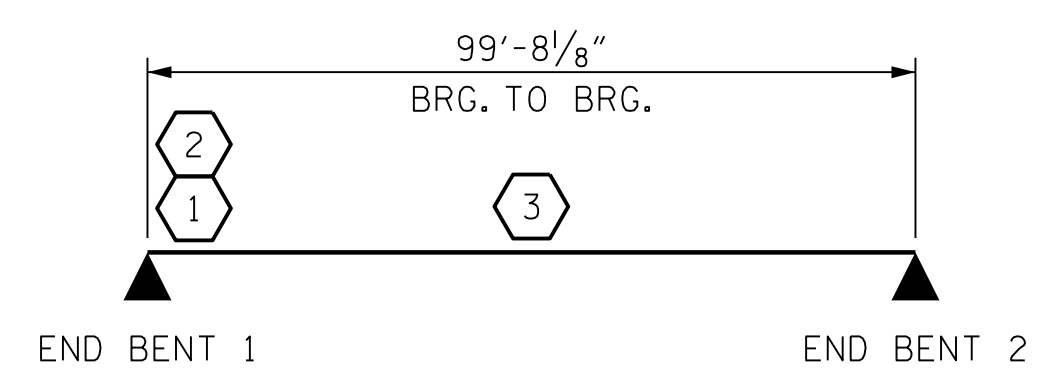

LRFR SUMMARY

PROJECT NO. R-2233BB  
RUTHERFORD COUNTY  
 STATION: 774+41.49 -L3-

4/22/2020 401\_009\_R2233BB\_SML\_LRFR\_800660.dgn

DESIGNED BY: C. CORMAN DATE: AUG 2019  
 DRAWN BY: K. WHITE DATE: AUG 2019  
 CHECKED BY: J. BORUTA DATE: AUG 2019  
 DESIGN ENGINEER OF RECORD: J. DOUGHTY DATE: NOV 2019

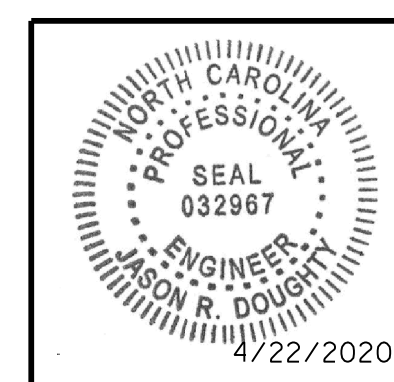

STATE OF NORTH CAROLINA  
 DEPARTMENT OF TRANSPORTATION  
 RALEIGH  
 STANDARD  
 LRFR SUMMARY FOR  
 PRESTRESSED  
 CONCRETE GIRDERS  
 (NON-INTERSTATE TRAFFIC)

**DOCUMENT NOT CONSIDERED FINAL  
 UNLESS ALL SIGNATURES COMPLETED**

REVISIONS						SHEET NO.
NO.	BY:	DATE:	NO.	BY:	DATE:	S1-5
1			3			TOTAL SHEETS
2			4			28