

UTILITIES BY OTHERS

ALL PROPOSED UTILITY WORK SHOWN ON THIS SHEET WILL BE DONE BY OTHERS. NO PAYMENT WILL BE MADE TO THE CONTRACTOR FOR PROPOSED UTILITY WORK SHOWN ON THIS SHEET.

5/14/99

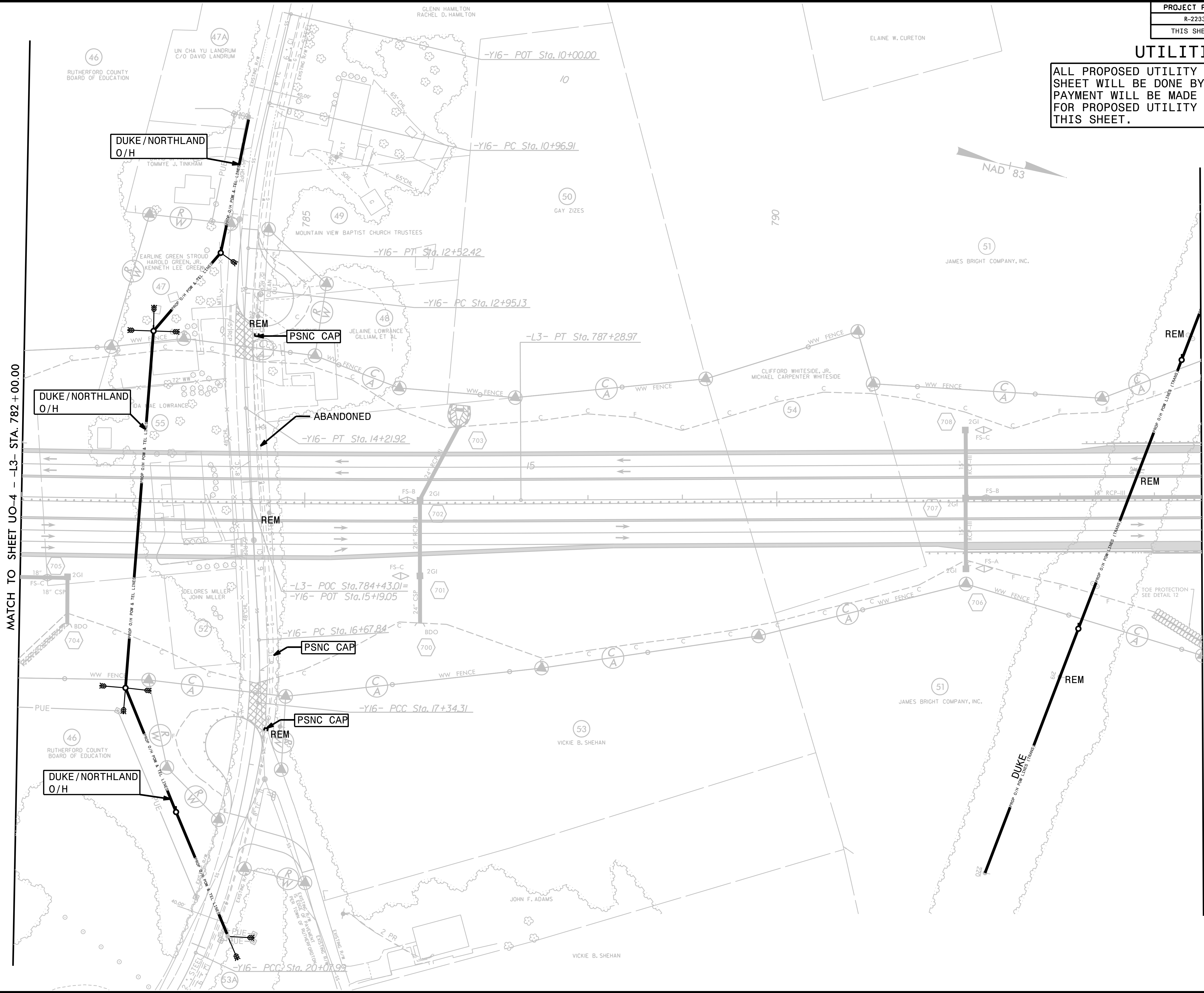

MATCH TO SHEET UO-4 - -L3- STA. 782+00.00

MATCH TO SHEET UO-6 - -L3- STA. 794+50.00



Property owners and addresses shown include: LIN CHA YU LANDRUM C/O DAVID LANDRUM (47A), TOMMYE J. TINKHAM, EARLINE GREEN STROUD, HAROLD GREEN, JR., KENNETH LEE GREEN (47), MOUNTAIN VIEW BAPTIST CHURCH TRUSTEES (49), JELAINE LOWRANCE GILLIAM, ET AL (48), DAVID E. LOWRANCE (55), DELORES MILLER, JOHN MILLER (52), JOHN F. ADAMS (53A), VICKIE B. SHEHAN (53), ELAINE W. CURETON, JAMES BRIGHT COMPANY, INC. (51), GAY ZIZES (50), and RUTHERFORD COUNTY BOARD OF EDUCATION (46).