

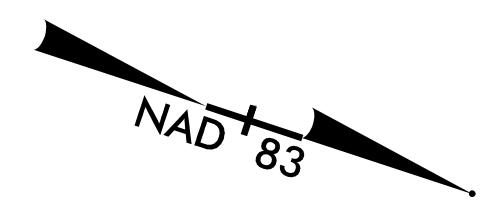

HDR Engineering, Inc. of the Carolinas
 555 Fayetteville St, Suite 900 Raleigh, N.C. 27601
 N.C.B.E.L.S. License Number: F-0116

PROJECT REFERENCE NO. <i>R-2233BB</i>	SHEET NO. <i>EC-31A/CONST. 31</i>
RW SHEET NO.	
ROADWAY DESIGN ENGINEER	HYDRAULICS ENGINEER

NOT TO SCALE



60" WELDED STEEL CONSTRUCTION SEQUENCE STA. 15+00 -Y10-

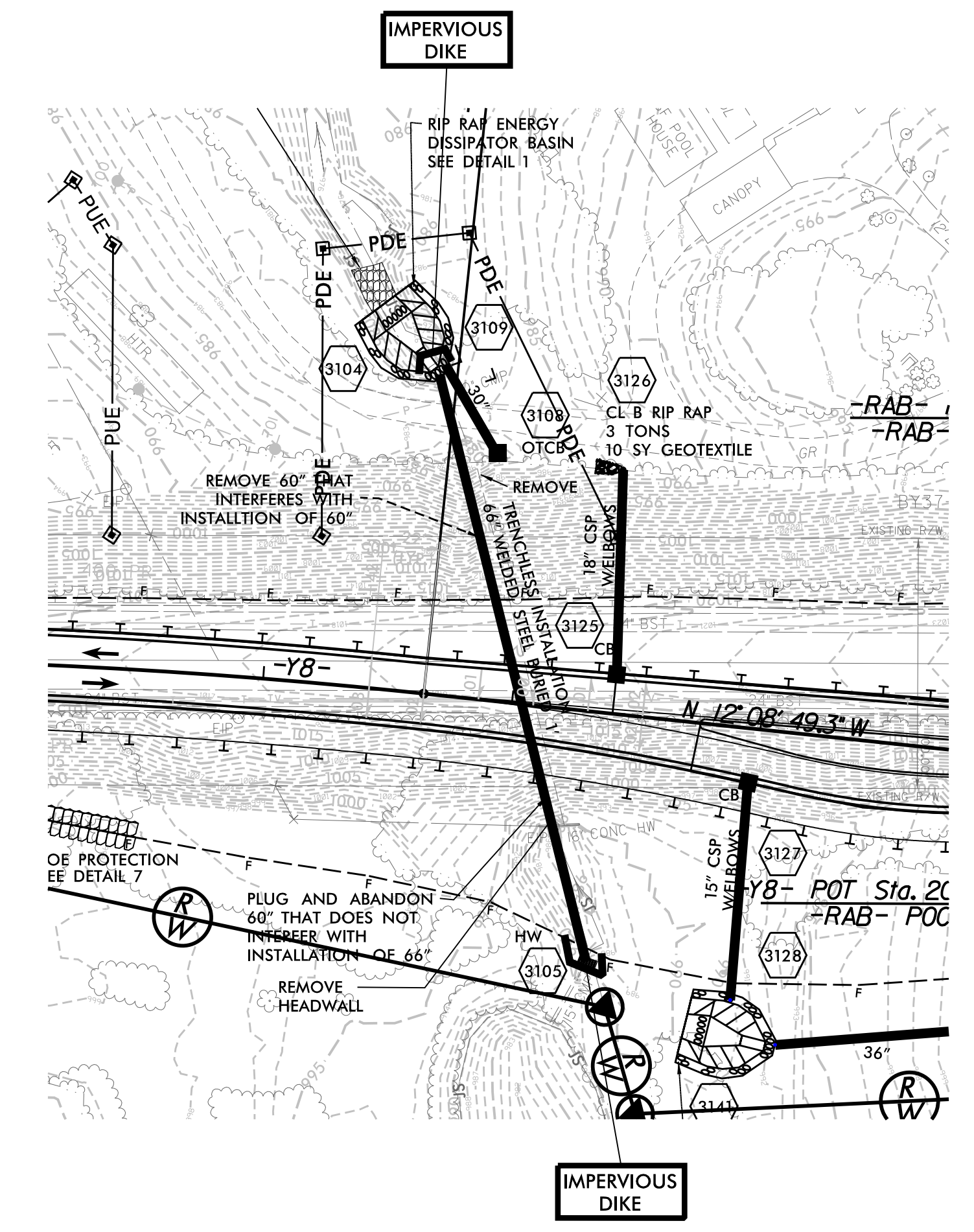

1. INSTALL SPECIAL STILLING BASIN(S) AS NECESSARY.
2. INSTALL IMPERVIOUS DIKES AND DIRECT WATER FLOW THROUGH EXISTING 60" CMP.
3. INSTALL 60" WELDED STEEL PIPE USING TRENCHLESS INSTALLATION.
4. COMPLETE UPSTREAM AND DOWNSTREAM CHANNEL IMPROVEMENTS.
5. REMOVE IMPERVIOUS DIKES TO ESTABLISH FLOW THROUGH NEWLY CONSTRUCTED PIPE.
6. REMOVE EXISTING 60" CMP AND/OR FILL WITH FLOWABLE MATERIAL.
7. REMOVE SPECIAL STILLING BASINS.

NOTE: IT IS ASSUMED THAT THE FINAL LOCATION OF THE PROPOSED 60" WELDED STEEL PIPE WILL BE SUCH THAT THE EXISTING 60" CMP CAN BE UTILIZED TO CONVEY FLOW DURING CONSTRUCTION.