

2 @ 6'X6' RCBC CONSTRUCTION SEQUENCE STA. 797+00 -L3-

HDR Engineering, Inc. of the Carolinas
555 Fayetteville St, Suite 900 Raleigh, N.C. 27601
N.C.B.E.L.S. License Number: F-0116

PROJECT REFERENCE NO. R-2233BB	SHEET NO. EC-8A/CONST.8
RW SHEET NO.	
ROADWAY DESIGN ENGINEER	HYDRAULICS ENGINEER

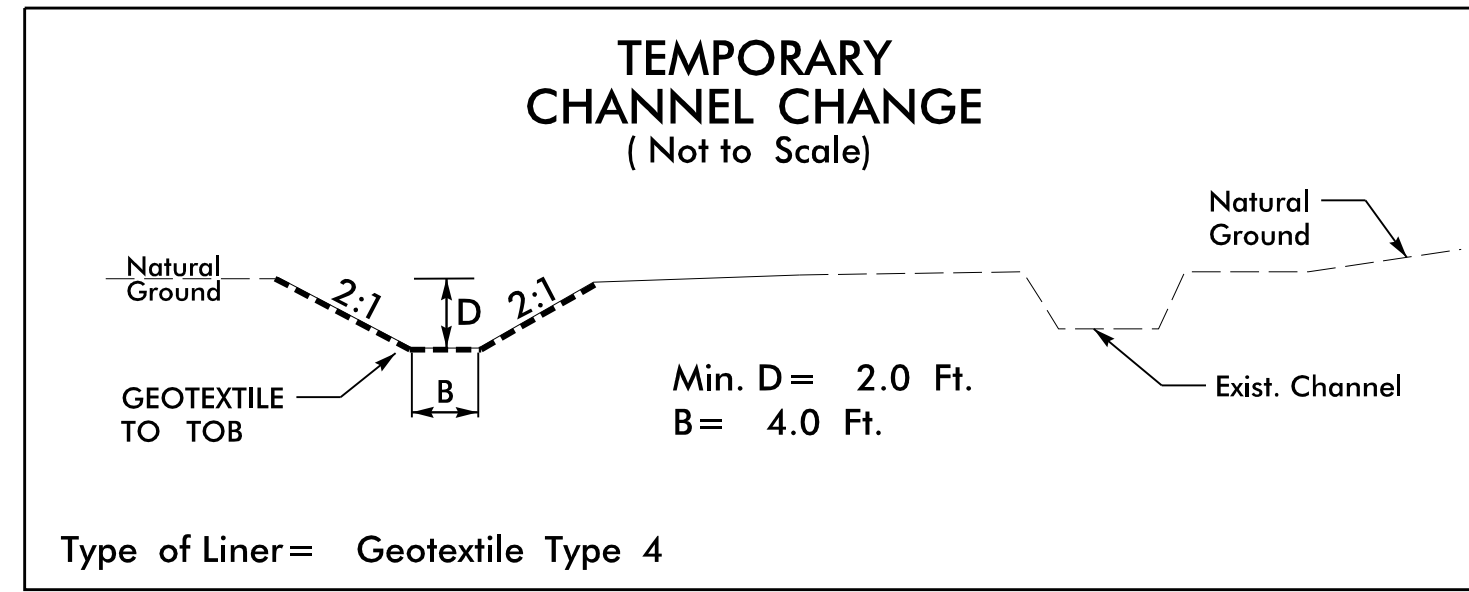

NOT TO SCALE

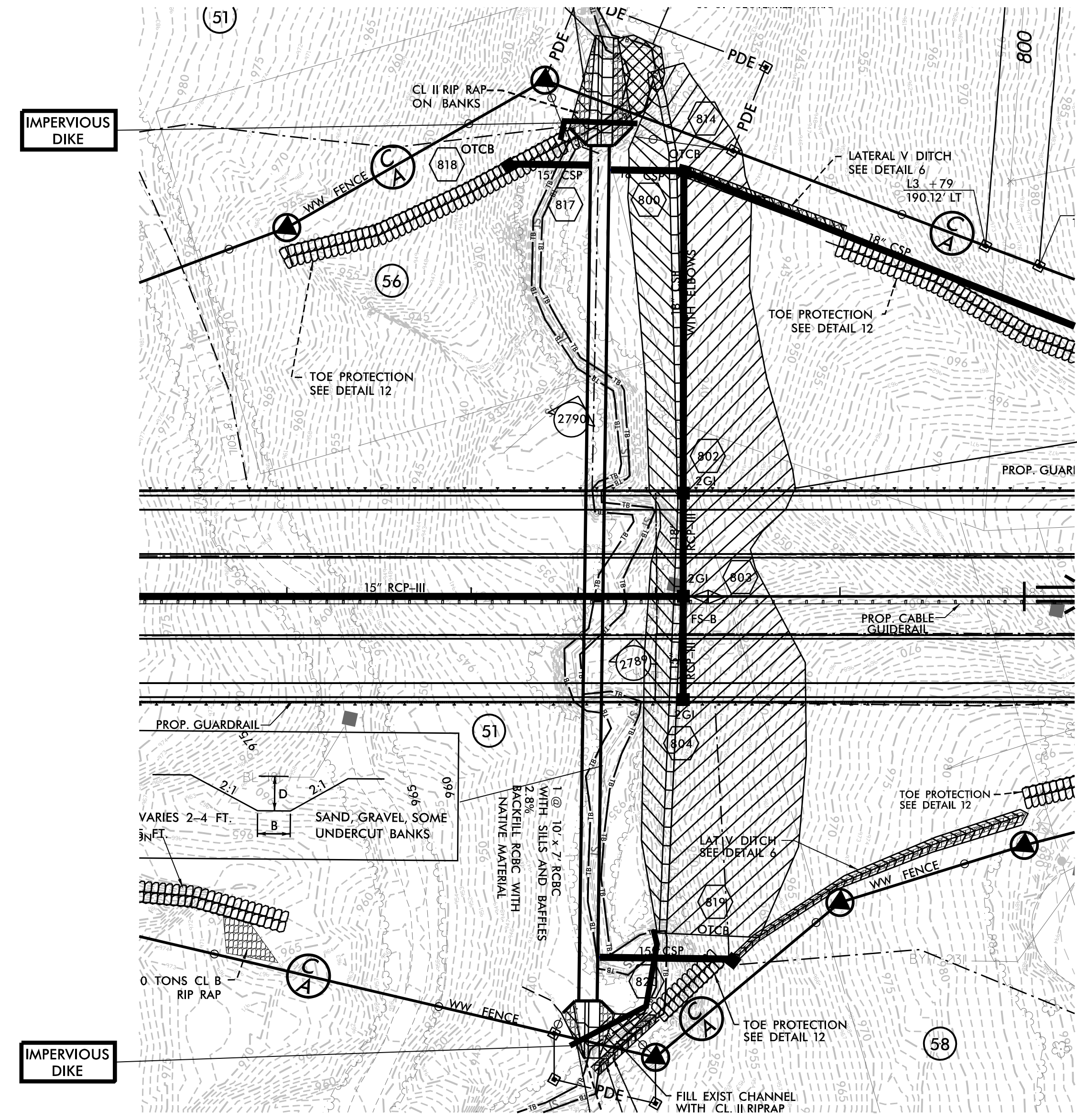
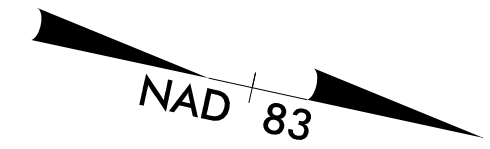

PHASE I

1. INSTALL SPECIAL STILLING BASIN(S) AS NECESSARY.
2. CONSTRUCT 4' BASE TEMPORARY CHANNEL CHANGE WITH LINER.
3. INSTALL IMPERVIOUS DIKES AND DIRECT WATER FLOW AROUND THE WORK AREA DOWN THE CENTER OF THE TEMPORARY CHANNEL CHANGE ON THE NORTH SIDE OF THE FUTURE CULVERT.
4. CONSTRUCT CULVERT.

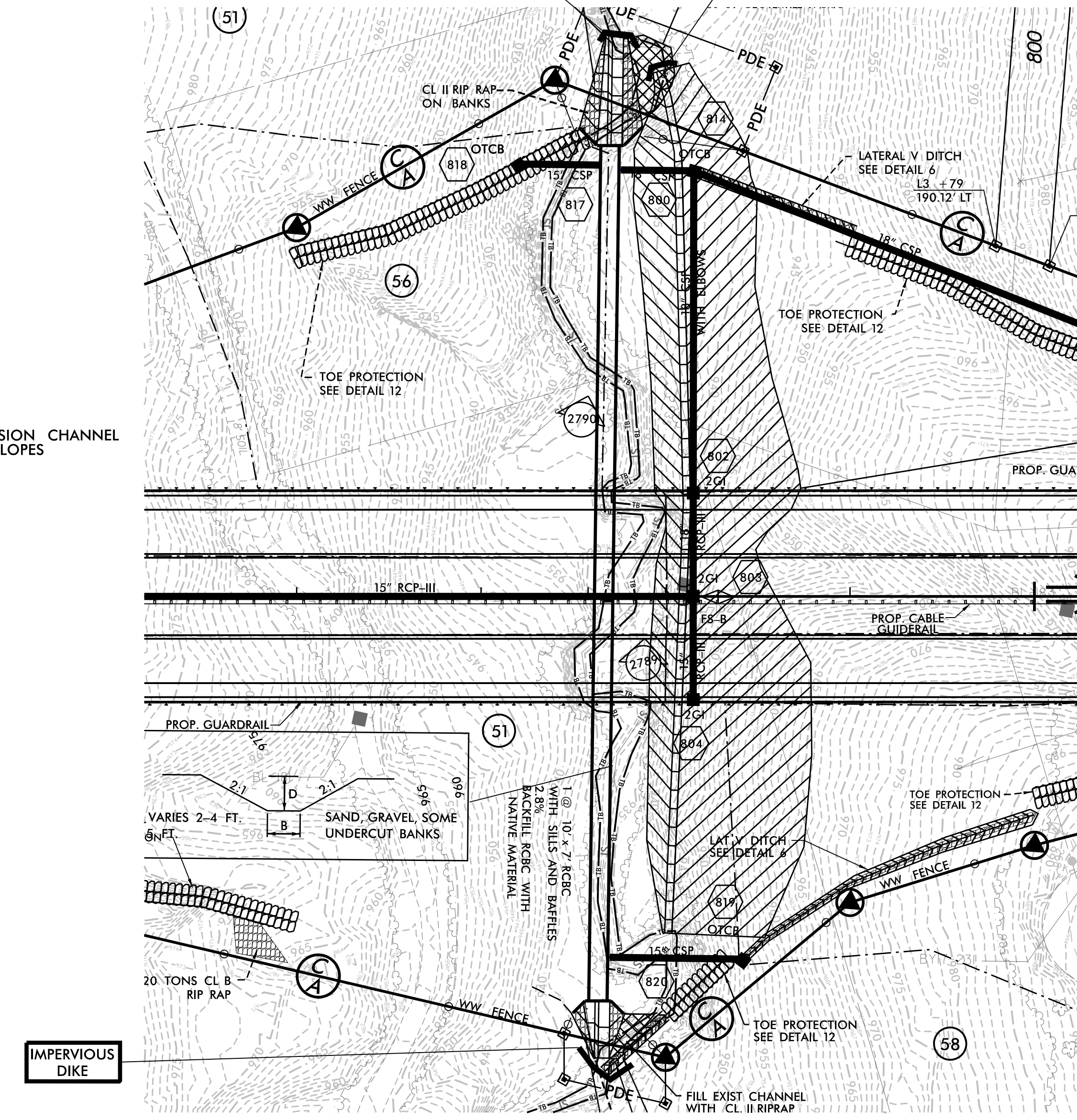

PHASE II

1. INSTALL SPECIAL STILLING BASIN(S) AS NECESSARY.
2. INSTALL IMPERVIOUS DIKES AND USE PUMPING OPERATION AND TEMPORARY CHANNEL CHANGE TO COMPLETE UPSTREAM AND DOWNSTREAM CHANNEL IMPROVEMENTS.
3. REMOVE IMPERVIOUS DIKES TO ESTABLISH FLOW THROUGH NEWLY CONSTRUCTED CULVERT.
4. REMOVE TEMPORARY DIVERSION CHANNEL AND ANY SPECIAL STILLING BASINS.