

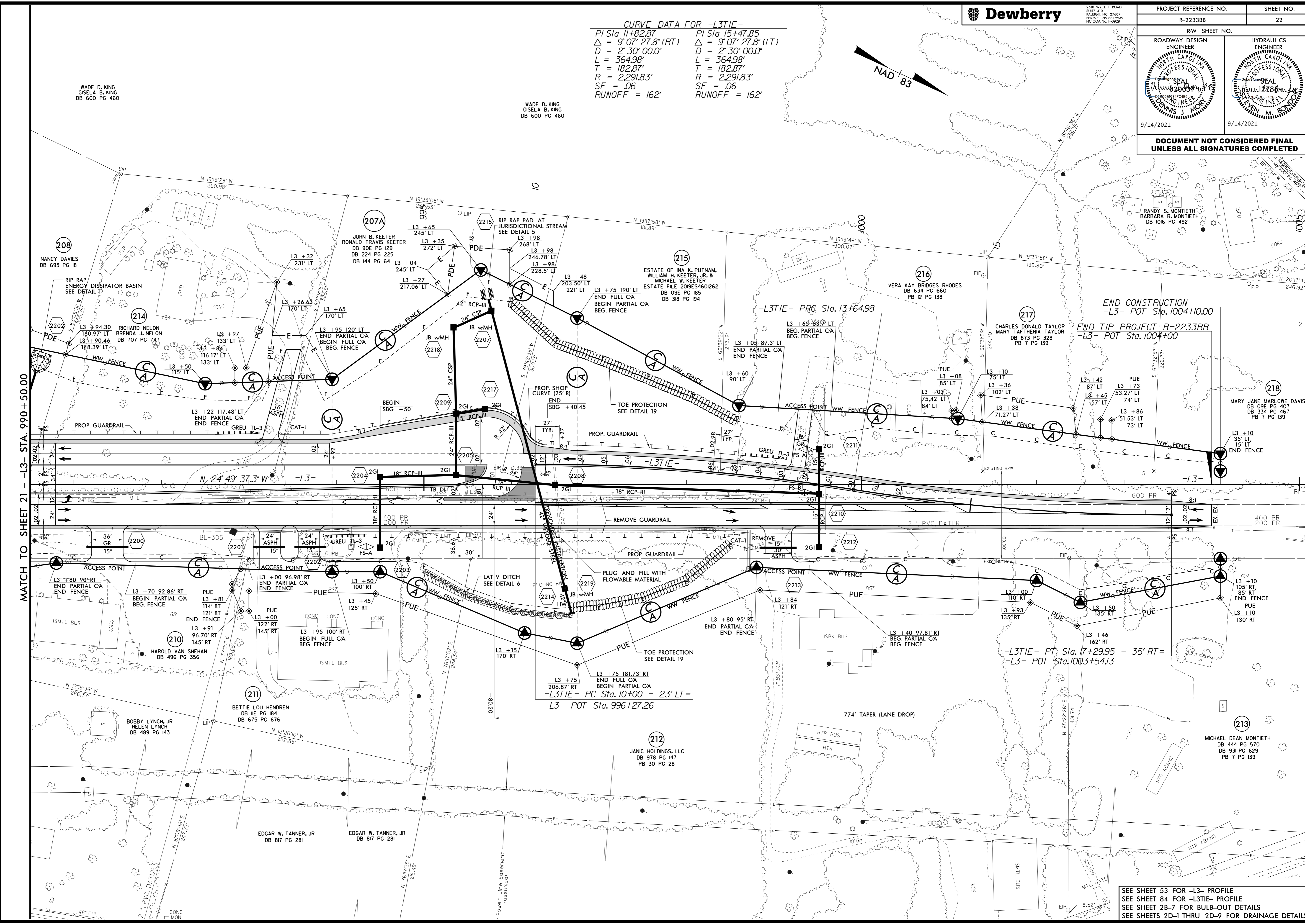

PROJECT REFERENCE NO. R-2233BB		SHEET NO. 22
RW SHEET NO.		
ROADWAY DESIGN ENGINEER	HYDRAULICS ENGINEER	
9/14/2021	9/14/2021	
DOCUMENT NOT CONSIDERED FINAL UNLESS ALL SIGNATURES COMPLETED		

**CURVE DATA FOR -L3TIE-**

PI Sta 11+82.87	PI Sta 15+47.85
$\Delta = 9^{\circ}07'27.8"$ (RT)	$\Delta = 9^{\circ}07'27.8"$ (LT)
$D = 2^{\circ}30'00.0"$	$D = 2^{\circ}30'00.0"$
$L = 364.98'$	$L = 364.98'$
$T = 182.87'$	$T = 182.87'$
$R = 2,291.83'$	$R = 2,291.83'$
$SE = .06$	$SE = .06$
$RUNOFF = 162'$	$RUNOFF = 162'$

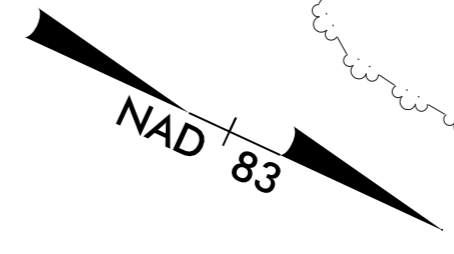

MATCH TO SHEET 21 - L3 - STA. 990 + 50.00

END CONSTRUCTION  
-L3- POT Sta. 1004+10.00  
END TIP PROJECT R-2233BB  
-L3- POT Sta. 1004+00

-L3TIE- PT. Sta. 17+29.95 - 35' RT =  
-L3- POT Sta. 1003+54.13

L3 + 75 206.87' RT  
-L3TIE- PC Sta. 10+00 - 23' LT =  
-L3- POT Sta. 996+27.26

SEE SHEET 53 FOR -L3- PROFILE  
SEE SHEET 84 FOR -L3TIE- PROFILE  
SEE SHEET 2B-7 FOR BULB-OUT DETAILS  
SEE SHEETS 2D-1 THRU 2D-9 FOR DRAINAGE DETAILS

9/13/2021 12:49:00 PM  
152-EP-S1-NR2233BB-RDY\_PSH22.DGN