



PROJECT REFERENCE NO.	R-2233BB	SHEET NO.	12
ROW SHEET NO.			
ROADWAY DESIGN ENGINEER	HYDRAULICS ENGINEER		
NOT A CERTIFIED DOCUMENT AS TO THE ORIGINAL DOCUMENT BUT ONLY AS TO THE REVISIONS.	NOT A CERTIFIED DOCUMENT AS TO THE ORIGINAL DOCUMENT BUT ONLY AS TO THE REVISIONS.		
THIS DOCUMENT ORIGINALLY ISSUED AND SEALED BY:	THIS DOCUMENT ORIGINALLY ISSUED AND SEALED BY:		
DENNIS J. MORY	STEVEN M. BONDOUR		
PE# 020031 ON 9/14/2021	PE# 012786 ON 9/14/2021		
THIS DOCUMENT IS ONLY CERTIFIED AS TO THE REVISIONS.	THIS DOCUMENT IS ONLY CERTIFIED AS TO THE REVISIONS.		

DOCUMENT NOT CONSIDERED FINAL UNLESS ALL SIGNATURES COMPLETED

ROADWAY DESIGN ENGINEER

HYDRAULICS ENGINEER

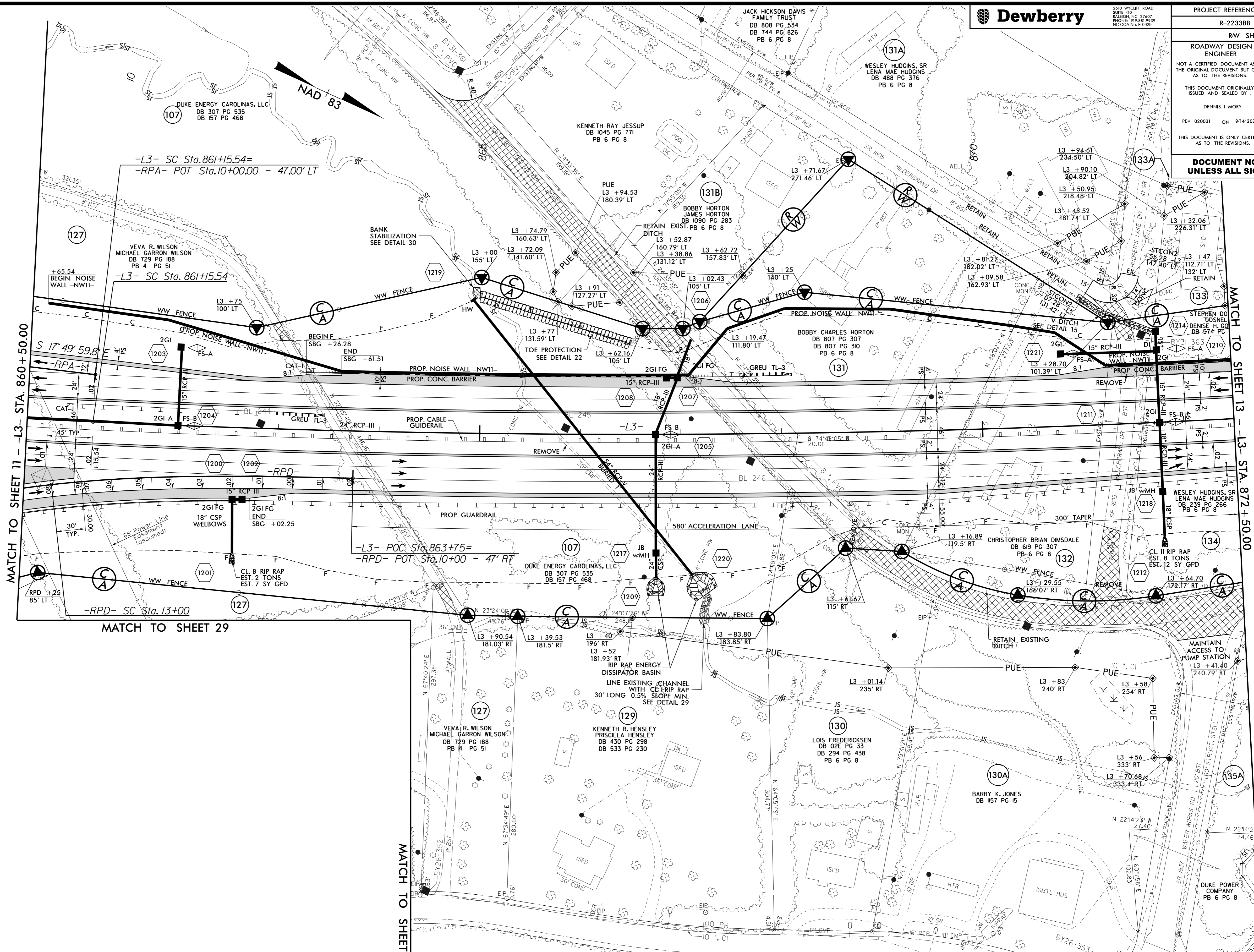

CURVE DATA FOR -RPD-

Pls Sta 12+00.19	PI Sta 15+27.21	Pls Sta 18+12.27
Os = 7° 45' 00.0"	Δ = 23° 09' 28.9" (LT)	Os = 4° 57' 36.0"
Ls = 300.00'	D = 5° 10' 00.0"	Ls = 192.00'
LT = 200.19'	L = 448.22'	LT = 128.05'
ST = 100.17'	T = 227.21'	ST = 64.05'
	R = 1,08.95'	
	SE = .08	

CURVE DATA FOR -L3-

Pls Sta 860+48.88	PI Sta 872+38.56	Pls Sta 884+21.15
Os = 0° 29' 53.6"	Δ = 11° 09' 17.8" (LT)	Os = 0° 29' 53.6"
Ls = 200.00'	D = 0° 29' 53.6"	Ls = 200.00'
LT = 123.33'	L = 2,238.94'	LT = 133.33'
ST = 66.67'	T = 1123.02'	ST = 66.67'
	R = 11,500.00'	
	SE = RC	
	RUNOFF = 90.00'	

SEE SHEET 43 FOR -L3- PROFILE
 SEE SHEET 67 FOR -RPA- PROFILE
 SEE SHEET 72 FOR -RPD- PROFILE
 SEE SHEETS 2D-1 THRU 2D-9 FOR DRAINAGE DETAILS

CONSTRUCTION REV. - APRIL 29, 2022 - Revised slope stakes along outside of -RPD- to account for SBG on cross sections.

4/29/2022 10:45:15 AM
 L:\Users\jmorris\OneDrive\Documents\Projects\2233BB-RDY_PSH12.DGN