

09/28/99

TIP PROJECT: U-5888

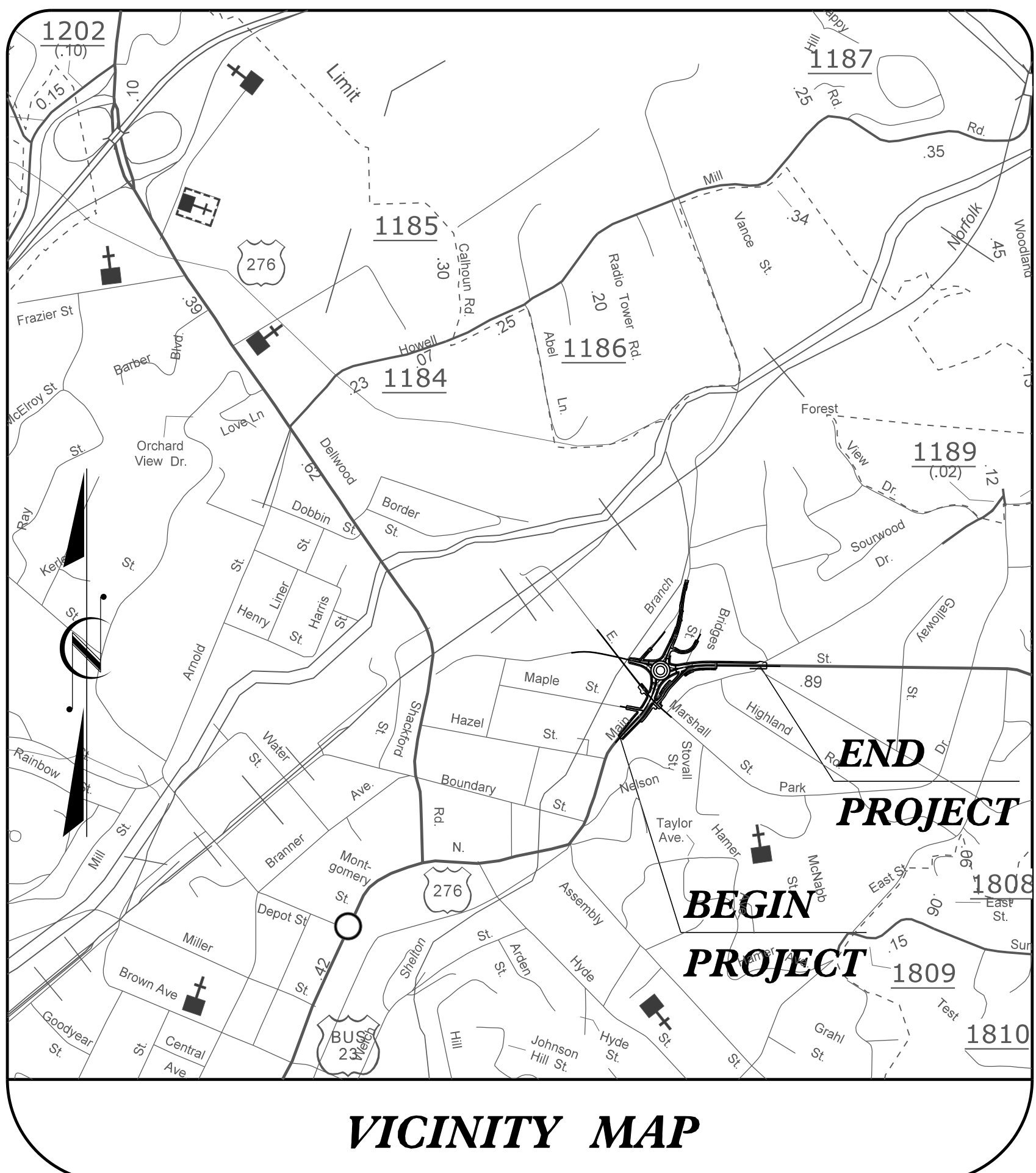

See Sheet 1-A For Index of Sheets
See Sheet 1-B For Conventional Symbols

STATE OF NORTH CAROLINA
DIVISION OF HIGHWAYS

**UTILITIES BY OTHERS PLANS
HAYWOOD COUNTY**

T.I.P. NO.	SHEET NO.
U-5888	UO-1

NOTE:
ALL UTILITY WORK SHOWN ON THIS SHEET WILL BE DONE BY OTHERS. NO PAYMENT WILL BE MADE TO THE CONTRACTOR FOR UTILITY WORK SHOWN ON THIS SHEET.

**LOCATION: WAYNESVILLE - INTERSECTION OF
US 23 BUSINESS (N. MAIN ST.) AND
WALNUT ST.**
**TYPE OF WORK: POWER, TELEPHONE, AND
CATV RELOCATION**

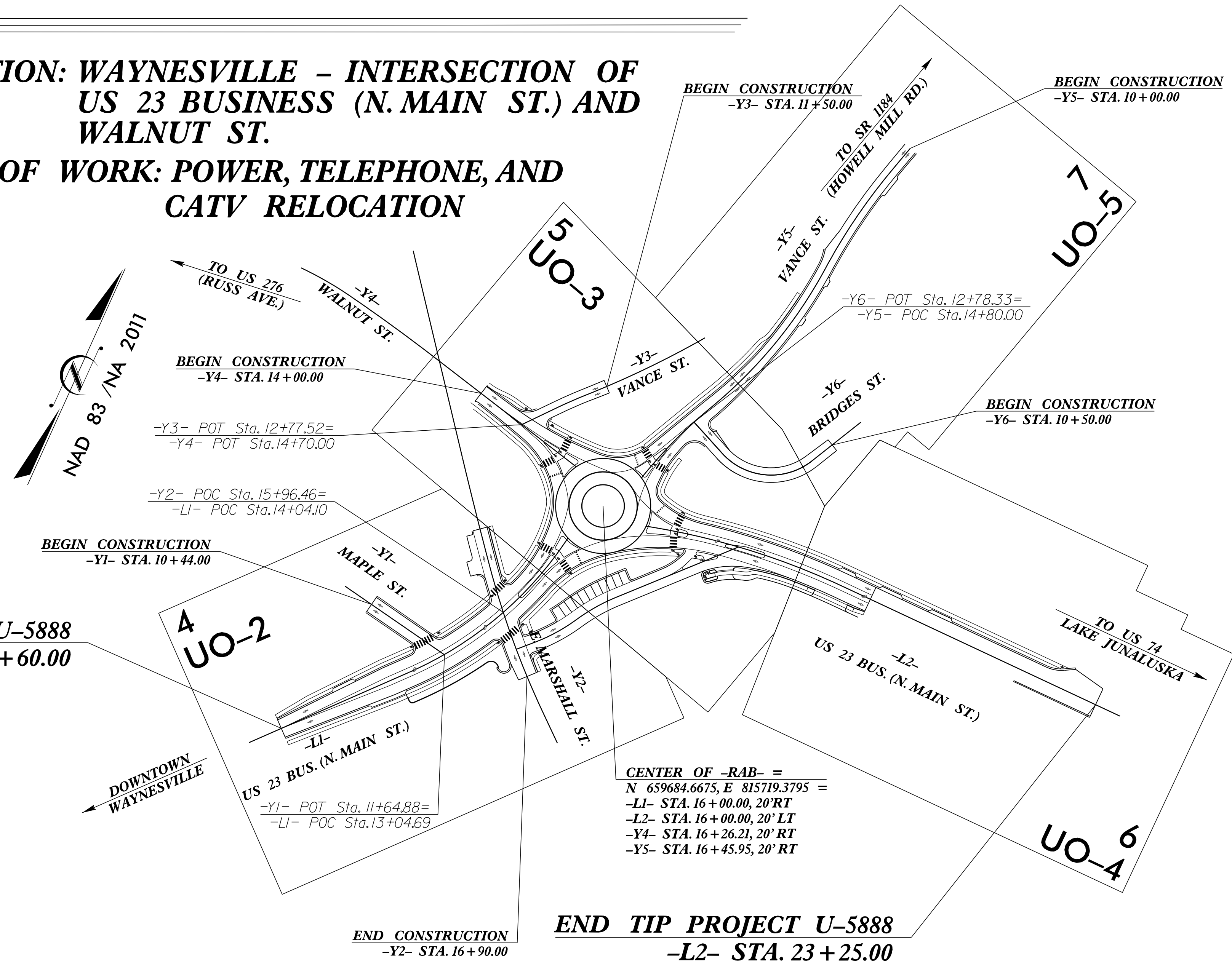

**BEGIN TIP PROJECT U-5888
-L1- STA. 10+60.00**

**END TIP PROJECT U-5888
-L2- STA. 23+25.00**

GRAPHIC SCALES

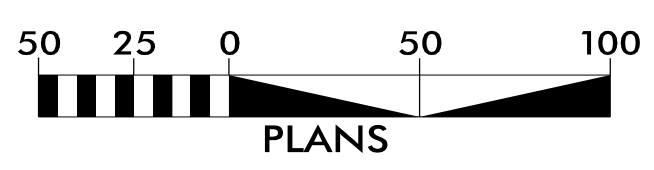

INDEX OF SHEETS

SHEET NO.:	DESCRIPTION:
UO-1	TITLE SHEET
UO-2	PLAN SHEET SYMBOLS
UO-3	NOT USED
UO-4 THRU UO-7	UBO PLAN SHEETS

UTILITY OWNERS WITH CONFLICTS

- (A) POWER - TOWN OF WAYNESVILLE
- (B) COMMUNICATION - AT&T
- (C) COMMUNICATION - MCNC
- (D) COMMUNICATION - BASLAM WEST
- (E) COMMUNICATION - ERC
- (F) CATV - CHARTER

PREPARED IN THE OFFICE OF:

WETHERILL ENGINEERING

1223 Jones Franklin Rd.
Raleigh, N.C. 27606
License No. F-0377
Bus: 919 851 8077
Fax: 919 851 8107

TRANSPORTATION PLANNING/DESIGN - BRIDGE/STRUCTURE DESIGN
CIVIL/SITE DESIGN - GIS/GPS - CONSTRUCTION OBSERVATION

John D. Schriener, PLS PROJECT UTILITY COORDINATOR

**DIVISION OF HIGHWAYS
DIVISION 14**

253 Webster Road
Sylva, NC, 28779

J. Scott Miller, III Division 14 DDC Engineer
Bob Golding Division Utility Coordinator
Bill Green Division Utility Coordinator

\$\$\$\$\$ SYSTEM \$\$\$\$\$\$ DGN\$\$\$\$\$ USER NAME \$\$\$\$\$\$

STATE OF NORTH CAROLINA, DIVISION OF HIGHWAYS

CONVENTIONAL PLAN SHEET SYMBOLS

12/2/2016

BOUNDARIES AND PROPERTY:

State Line	-----
County Line	-----
Township Line	-----
City Line	-----
Reservation Line	-----
Property Line	-----
Existing Iron Pin	○ EIP
Computed Property Corner	-----
Property Monument	□ ECM
Parcel/Sequence Number	①23
Existing Fence Line	-x-x-x-
Proposed Woven Wire Fence	○
Proposed Chain Link Fence	□
Proposed Barbed Wire Fence	◇
Existing Wetland Boundary	--- WLB ---
Proposed Wetland Boundary	--- WLB ---
Existing Endangered Animal Boundary	--- EAB ---
Existing Endangered Plant Boundary	--- EPB ---
Existing Historic Property Boundary	--- HPB ---
Known Contamination Area: Soil	☠-s-☠
Potential Contamination Area: Soil	☠-s-☠
Known Contamination Area: Water	☠-w-☠
Potential Contamination Area: Water	☠-w-☠
Contaminated Site: Known or Potential	☠?

BUILDINGS AND OTHER CULTURE:

Gas Pump Vent or U/G Tank Cap	○
Sign	○ S
Well	○ W
Small Mine	⋈
Foundation	□
Area Outline	□
Cemetery	□
Building	□
School	□
Church	□
Dam	□

HYDROLOGY:

Stream or Body of Water	-----
Hydro, Pool or Reservoir	□
Jurisdictional Stream	--- JS ---
Buffer Zone 1	--- BZ 1 ---
Buffer Zone 2	--- BZ 2 ---
Flow Arrow	←
Disappearing Stream	→
Spring	○
Wetland	--- WLB ---
Proposed Lateral, Tail, Head Ditch	--- FLOW ---
False Sump	▽

RAILROADS:

Standard Gauge	-----
RR Signal Milepost	○ MILEPOST 35
Switch	□ SWITCH
RR Abandoned	-----
RR Dismantled	-----

RIGHT OF WAY & PROJECT CONTROL:

Secondary Horiz and Vert Control Point	◆
Primary Horiz Control Point	○
Primary Horiz and Vert Control Point	◆
Exist Permanent Easement Pin and Cap	◇
New Permanent Easement Pin and Cap	◆
Vertical Benchmark	⊠
Existing Right of Way Marker	△
Existing Right of Way Line	-----
New Right of Way Line	○ R W
New Right of Way Line with Pin and Cap	○ R W ◆
New Right of Way Line with Concrete or Granite R/W Marker	△ R W
New Control of Access Line with Concrete C/A Marker	△ C/A
Existing Control of Access	○ C/A
New Control of Access	○ C/A
Existing Easement Line	--- E ---
New Temporary Construction Easement	--- E ---
New Temporary Drainage Easement	--- TDE ---
New Permanent Drainage Easement	--- PDE ---
New Permanent Drainage / Utility Easement	--- DUE ---
New Permanent Utility Easement	--- PUE ---
New Temporary Utility Easement	--- TUE ---
New Aerial Utility Easement	--- AUE ---

ROADS AND RELATED FEATURES:

Existing Edge of Pavement	-----
Existing Curb	-----
Proposed Slope Stakes Cut	--- C ---
Proposed Slope Stakes Fill	--- F ---
Proposed Curb Ramp	--- CR ---
Existing Metal Guardrail	--- T ---
Proposed Guardrail	--- T ---
Existing Cable Guiderail	--- T ---
Proposed Cable Guiderail	--- T ---
Equality Symbol	⊕
Pavement Removal	⊠

VEGETATION:

Single Tree	○
Single Shrub	○

Note: Not to Scale *S.U.E. = *Subsurface Utility Engineering*

Hedge	-----
Woods Line	-----
Orchard	○
Vineyard	□ Vineyard

EXISTING STRUCTURES:

MAJOR:	
Bridge, Tunnel or Box Culvert	--- CONC ---
Bridge Wing Wall, Head Wall and End Wall	--- CONC WW ---
MINOR:	
Head and End Wall	--- CONC HW ---
Pipe Culvert	-----
Footbridge	---
Drainage Box: Catch Basin, DI or JB	□ CB
Paved Ditch Gutter	-----
Storm Sewer Manhole	○ S
Storm Sewer	--- S ---

UTILITIES:

POWER:	
Existing Power Pole	●
Proposed Power Pole	○
Existing Joint Use Pole	●
Proposed Joint Use Pole	○
Power Manhole	○ P
Power Line Tower	⊠
Power Transformer	⊠
U/G Power Cable Hand Hole	○
H-Frame Pole	●
U/G Power Line LOS B (S.U.E.*)	--- P ---
U/G Power Line LOS C (S.U.E.*)	--- P ---
U/G Power Line LOS D (S.U.E.*)	--- P ---

TELEPHONE:

Existing Telephone Pole	●
Proposed Telephone Pole	○
Telephone Manhole	○ T
Telephone Pedestal	□
Telephone Cell Tower	⊠
U/G Telephone Cable Hand Hole	○
U/G Telephone Cable LOS B (S.U.E.*)	--- T ---
U/G Telephone Cable LOS C (S.U.E.*)	--- T ---
U/G Telephone Cable LOS D (S.U.E.*)	--- T ---
U/G Telephone Conduit LOS B (S.U.E.*)	--- TC ---
U/G Telephone Conduit LOS C (S.U.E.*)	--- TC ---
U/G Telephone Conduit LOS D (S.U.E.*)	--- TC ---
U/G Fiber Optics Cable LOS B (S.U.E.*)	--- T FO ---
U/G Fiber Optics Cable LOS C (S.U.E.*)	--- T FO ---
U/G Fiber Optics Cable LOS D (S.U.E.*)	--- T FO ---

WATER:

Water Manhole	○ W
Water Meter	○
Water Valve	⊗
Water Hydrant	⊕
U/G Water Line LOS B (S.U.E.*)	--- W ---
U/G Water Line LOS C (S.U.E.*)	--- W ---
U/G Water Line LOS D (S.U.E.*)	--- W ---
Above Ground Water Line	--- A/G Water ---

TV:

TV Pedestal	□
TV Tower	⊗
U/G TV Cable Hand Hole	○
U/G TV Cable LOS B (S.U.E.*)	--- TV ---
U/G TV Cable LOS C (S.U.E.*)	--- TV ---
U/G TV Cable LOS D (S.U.E.*)	--- TV ---
U/G Fiber Optic Cable LOS B (S.U.E.*)	--- TV FO ---
U/G Fiber Optic Cable LOS C (S.U.E.*)	--- TV FO ---
U/G Fiber Optic Cable LOS D (S.U.E.*)	--- TV FO ---

GAS:

Gas Valve	◇
Gas Meter	⊕
U/G Gas Line LOS B (S.U.E.*)	--- G ---
U/G Gas Line LOS C (S.U.E.*)	--- G ---
U/G Gas Line LOS D (S.U.E.*)	--- G ---
Above Ground Gas Line	--- A/G Gas ---

SANITARY SEWER:

Sanitary Sewer Manhole	⊕
Sanitary Sewer Cleanout	⊕
U/G Sanitary Sewer Line	--- SS ---
Above Ground Sanitary Sewer	--- A/G Sanitary Sewer ---
SS Forced Main Line LOS B (S.U.E.*)	--- FSS ---
SS Forced Main Line LOS C (S.U.E.*)	--- FSS ---
SS Forced Main Line LOS D (S.U.E.*)	--- FSS ---

MISCELLANEOUS:

Utility Pole	●
Utility Pole with Base	□
Utility Located Object	○
Utility Traffic Signal Box	⊠
Utility Unknown U/G Line LOS B (S.U.E.*)	--- 7UTL ---
U/G Tank; Water, Gas, Oil	□
Underground Storage Tank, Approx. Loc.	⊠ UST
A/G Tank; Water, Gas, Oil	□
Geoenvironmental Boring	⊕
U/G Test Hole LOS A (S.U.E.*)	○
Abandoned According to Utility Records	AATUR
End of Information	E.O.I.

UTILITIES BY OTHERS

ALL PROPOSED UTILITY WORK SHOWN ON THIS SHEET WILL BE DONE BY OTHERS. NO PAYMENT WILL BE MADE TO THE CONTRACTOR FOR PROPOSED UTILITY WORK SHOWN ON THIS SHEET.

O/H POWER - TOWN OF WAYNESVILLE
O/H COMMUNICATIONS - CHARTER
O/H COMMUNICATIONS - AT&T

SEE UO PROVISIONS FOR TEST HOLE INFORMATION

LYNDA D. MACLEAN
DB 649 PG 475

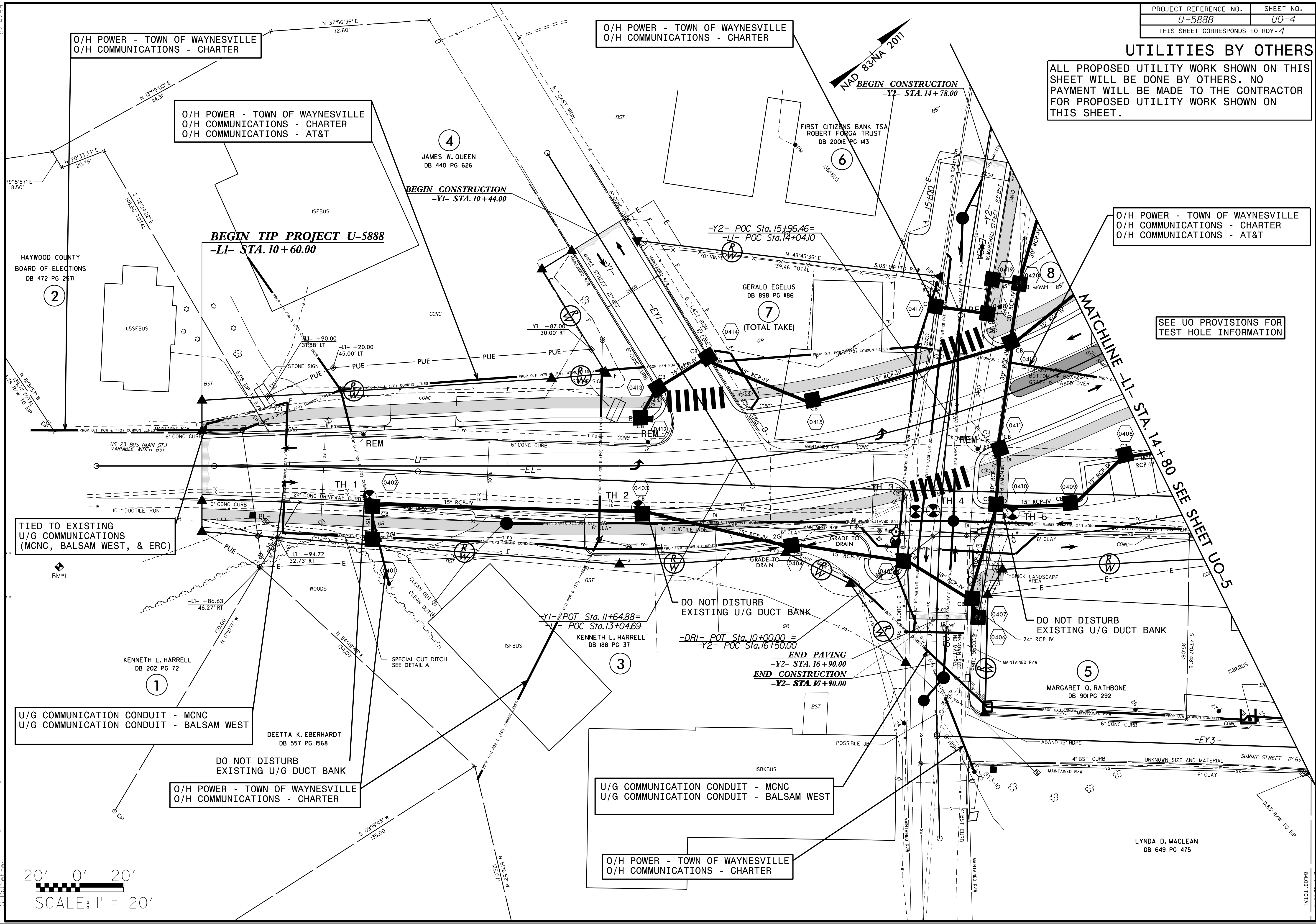

TIED TO EXISTING
U/G COMMUNICATIONS
(MCNC, BALSAM WEST, & ERC)

U/G COMMUNICATION CONDUIT - MCNC
U/G COMMUNICATION CONDUIT - BALSAM WEST

O/H POWER - TOWN OF WAYNESVILLE
O/H COMMUNICATIONS - CHARTER

U/G COMMUNICATION CONDUIT - MCNC
U/G COMMUNICATION CONDUIT - BALSAM WEST

O/H POWER - TOWN OF WAYNESVILLE
O/H COMMUNICATIONS - CHARTER

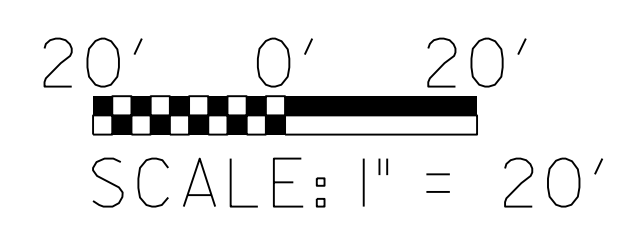

5/14/99
 12/16/2008
 U-5888.ut_rdy4_U04_psh.dgn
 84.09' TOTAL

UTILITIES BY OTHERS

ALL PROPOSED UTILITY WORK SHOWN ON THIS SHEET WILL BE DONE BY OTHERS. NO PAYMENT WILL BE MADE TO THE CONTRACTOR FOR PROPOSED UTILITY WORK SHOWN ON THIS SHEET.

O/H POWER - TOWN OF WAYNESVILLE
O/H COMMUNICATIONS - CHARTER
O/H COMMUNICATIONS - AT&T

O/H POWER - TOWN OF WAYNESVILLE
O/H COMMUNICATIONS - CHARTER
O/H COMMUNICATIONS - AT&T
O/H COMMUNICATIONS - ERC

U/G COMMUNICATION CONDUIT - MCNC
U/G COMMUNICATION CONDUIT - BALSAM WEST

O/H POWER - TOWN OF WAYNESVILLE
O/H COMMUNICATIONS - CHARTER
O/H COMMUNICATIONS - AT&T

DO NOT DISTURB EXISTING U/G DUCT BANK

MATCHLINE -Y5- STA. 14+00 SEE SHEET UO-7
MATCHLINE -Y6- STA. 11+00 SEE SHEET UO-7
MATCHLINE -L2- STA. 18+80 SEE SHEET UO-6

MATCHLINE -L1- STA. 14+80 SEE SHEET UO-4

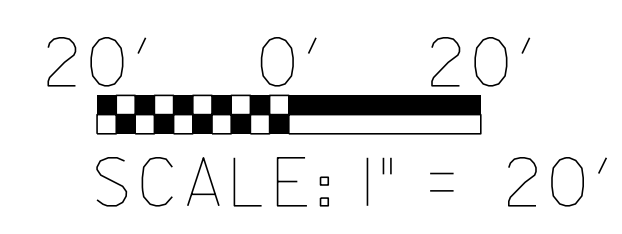
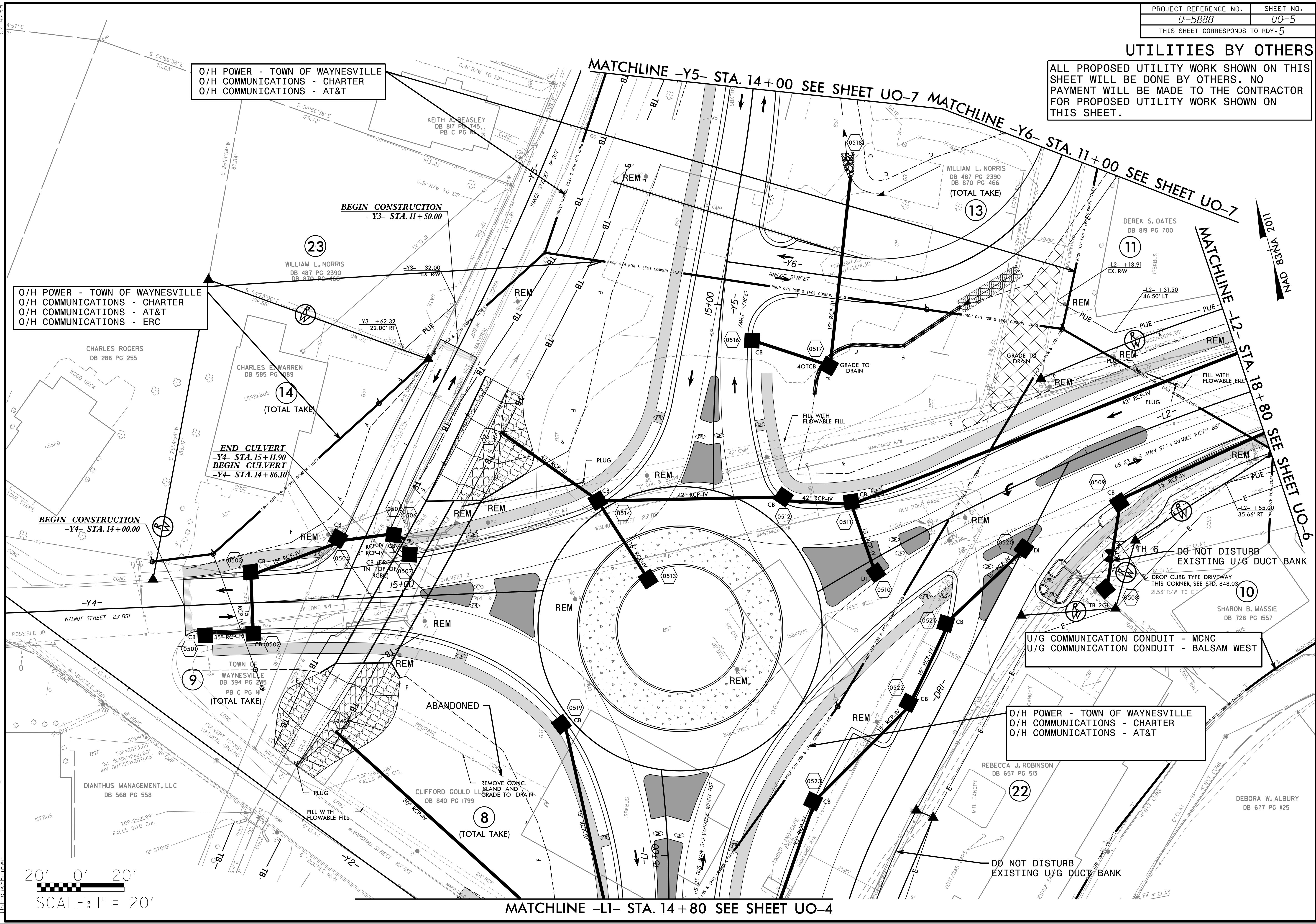

20-NOV-15-88 ut_rdy5_U05_psh.dgn

UTILITIES BY OTHERS

ALL PROPOSED UTILITY WORK SHOWN ON THIS SHEET WILL BE DONE BY OTHERS. NO PAYMENT WILL BE MADE TO THE CONTRACTOR FOR PROPOSED UTILITY WORK SHOWN ON THIS SHEET.

O/H POWER - TOWN OF WAYNESVILLE
O/H COMMUNICATIONS - CHARTER
O/H COMMUNICATIONS - AT&T

O/H POWER - TOWN OF WAYNESVILLE
O/H COMMUNICATIONS - CHARTER

END GRADE
BEGIN MILL AND OVERLAY OF EXISTING PAVEMENT
INSTALL NEW C&G AND SIDEWALK LT. SIDE
-L2- STA. 19+85.00 TO -L2- STA. 22+80.00

END TIP PROJECT U-5888
-L2- STA. 23+25.00
MATCH EXISTING

MATCHLINE -L2- STA. 18+80 SEE SHEET U0-5

MATCHLINE -L2- POT. STA. 24+18.50

NAD 83/NA 2011

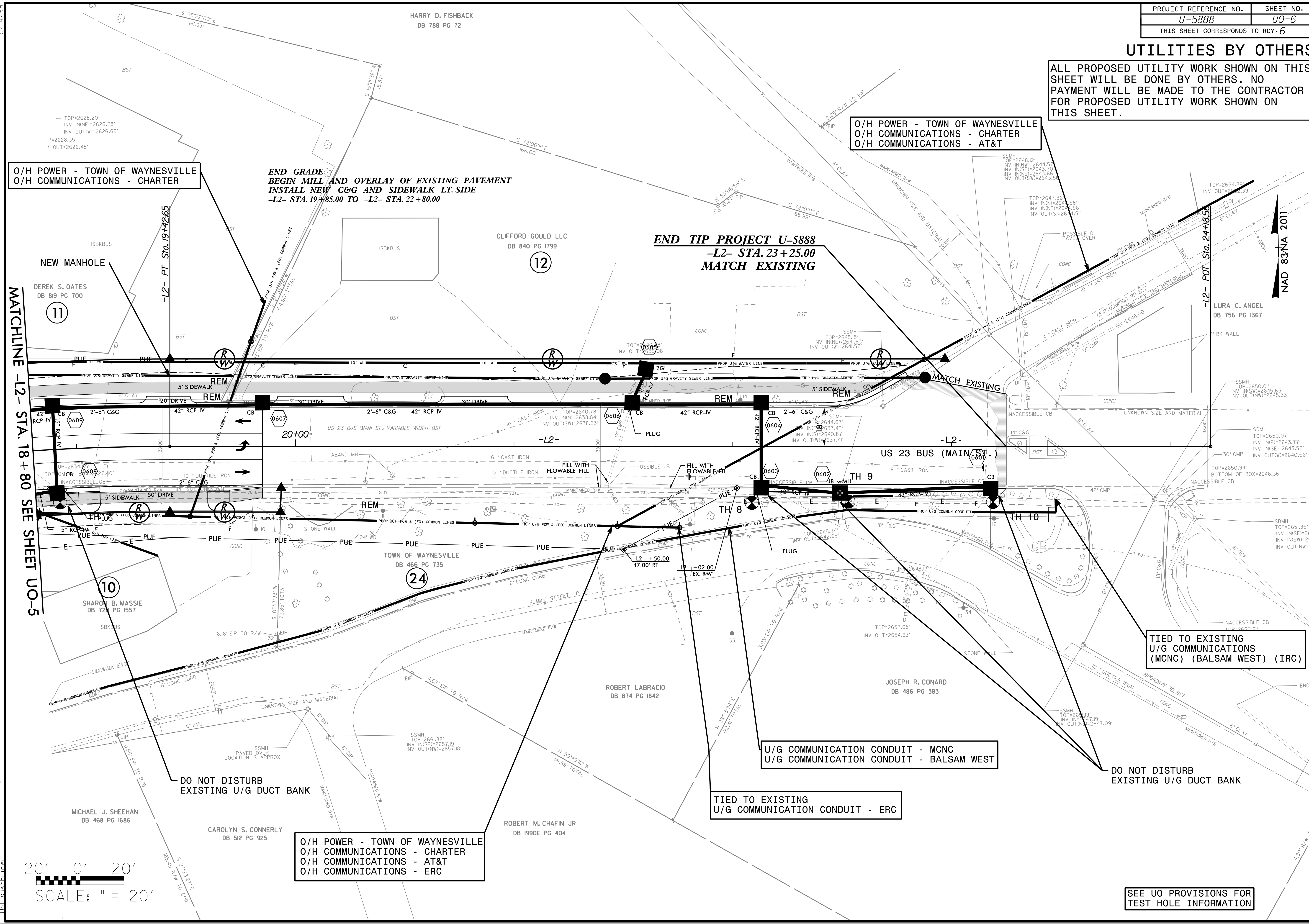

TIED TO EXISTING
U/G COMMUNICATIONS
(MCNC) (BALSAM WEST) (IRC)

U/G COMMUNICATION CONDUIT - MCNC
U/G COMMUNICATION CONDUIT - BALSAM WEST

TIED TO EXISTING
U/G COMMUNICATION CONDUIT - ERC

DO NOT DISTURB
EXISTING U/G DUCT BANK

O/H POWER - TOWN OF WAYNESVILLE
O/H COMMUNICATIONS - CHARTER
O/H COMMUNICATIONS - AT&T
O/H COMMUNICATIONS - ERC

DO NOT DISTURB
EXISTING U/G DUCT BANK

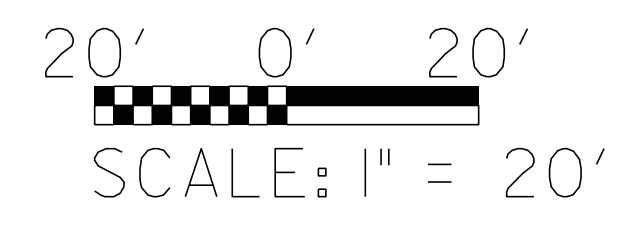

SEE U0 PROVISIONS FOR
TEST HOLE INFORMATION

5/14/2019 20-Nov-19 15:58:88 ut_rdy6_U06_psh.dgn

UTILITIES BY OTHERS

ALL PROPOSED UTILITY WORK SHOWN ON THIS SHEET WILL BE DONE BY OTHERS. NO PAYMENT WILL BE MADE TO THE CONTRACTOR FOR PROPOSED UTILITY WORK SHOWN ON THIS SHEET.

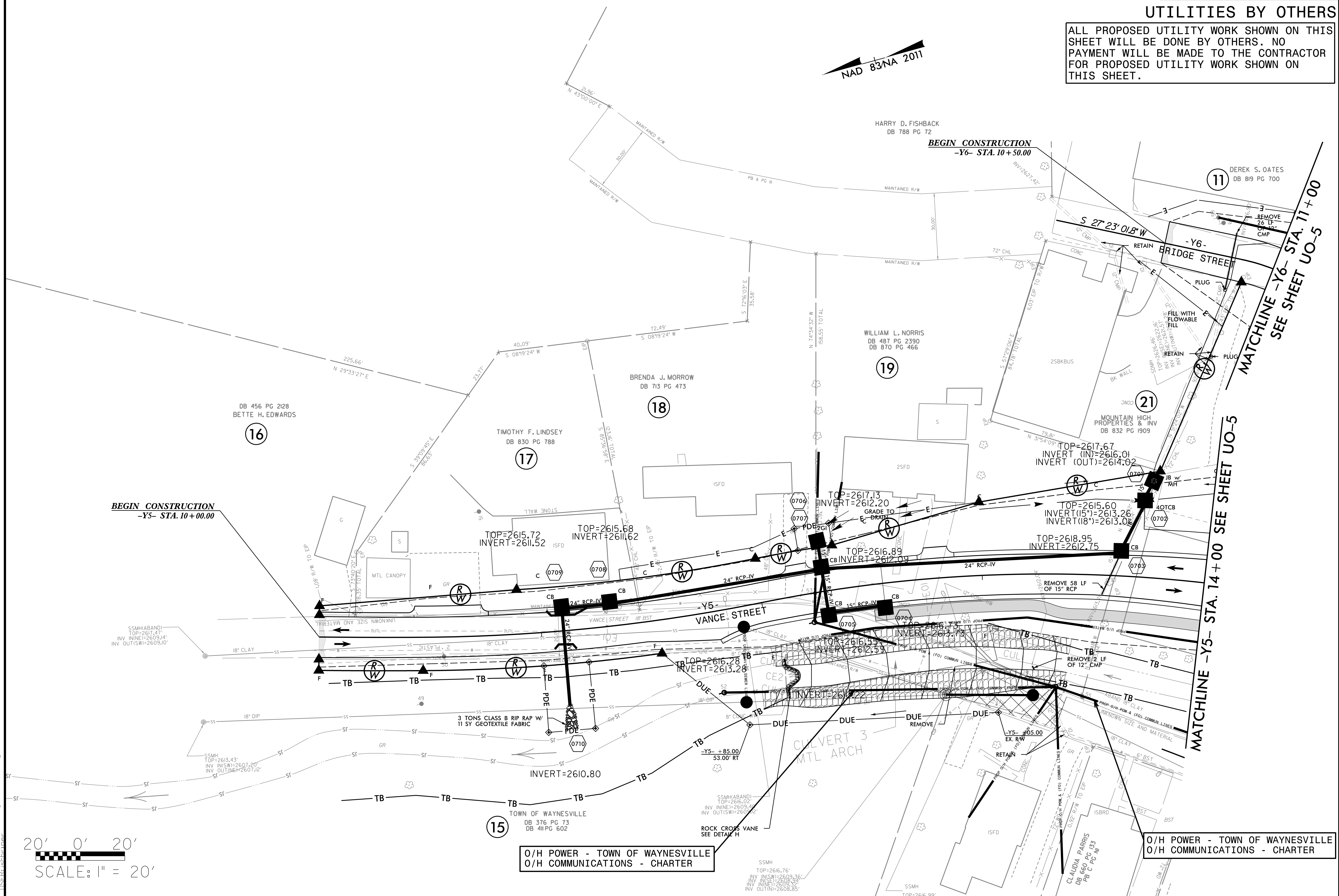
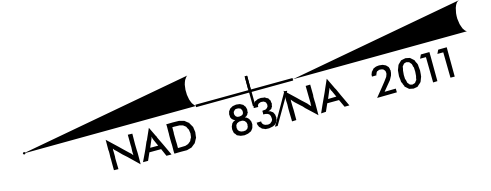

BEGIN CONSTRUCTION
-Y5- STA. 10+00.00

BEGIN CONSTRUCTION
-Y6- STA. 10+50.00

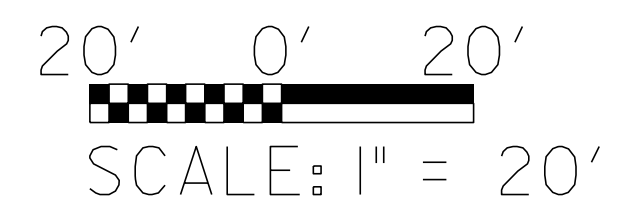

O/H POWER - TOWN OF WAYNESVILLE
O/H COMMUNICATIONS - CHARTER

O/H POWER - TOWN OF WAYNESVILLE
O/H COMMUNICATIONS - CHARTER

20-Nov-15 8:58 ut_rdy7_U07_psh.dgn