

TIP PROJECT: U-5888

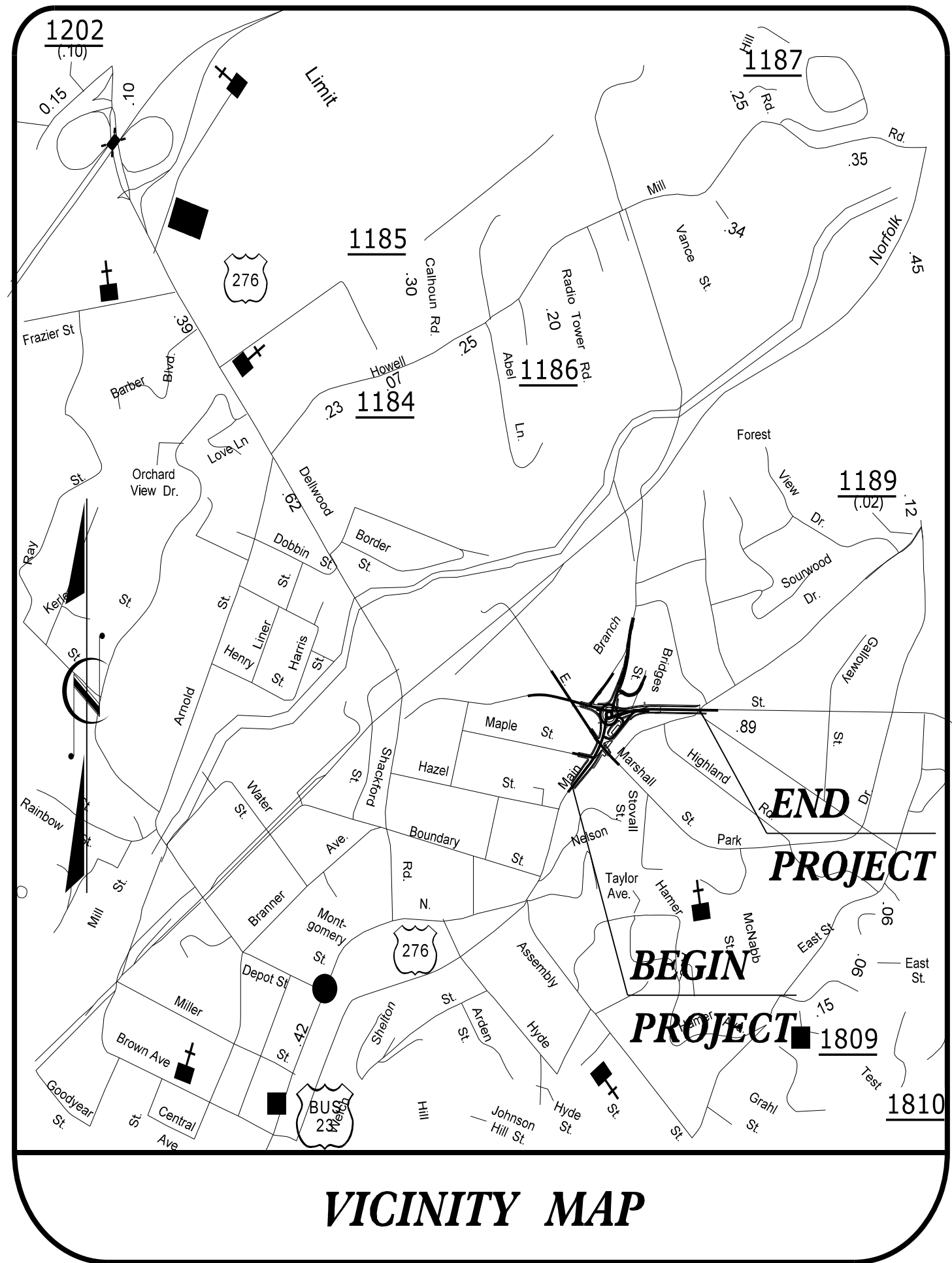

VICINITY MAP

STATE OF NORTH CAROLINA DIVISION OF HIGHWAYS PLAN FOR PROPOSED HIGHWAY EROSION CONTROL

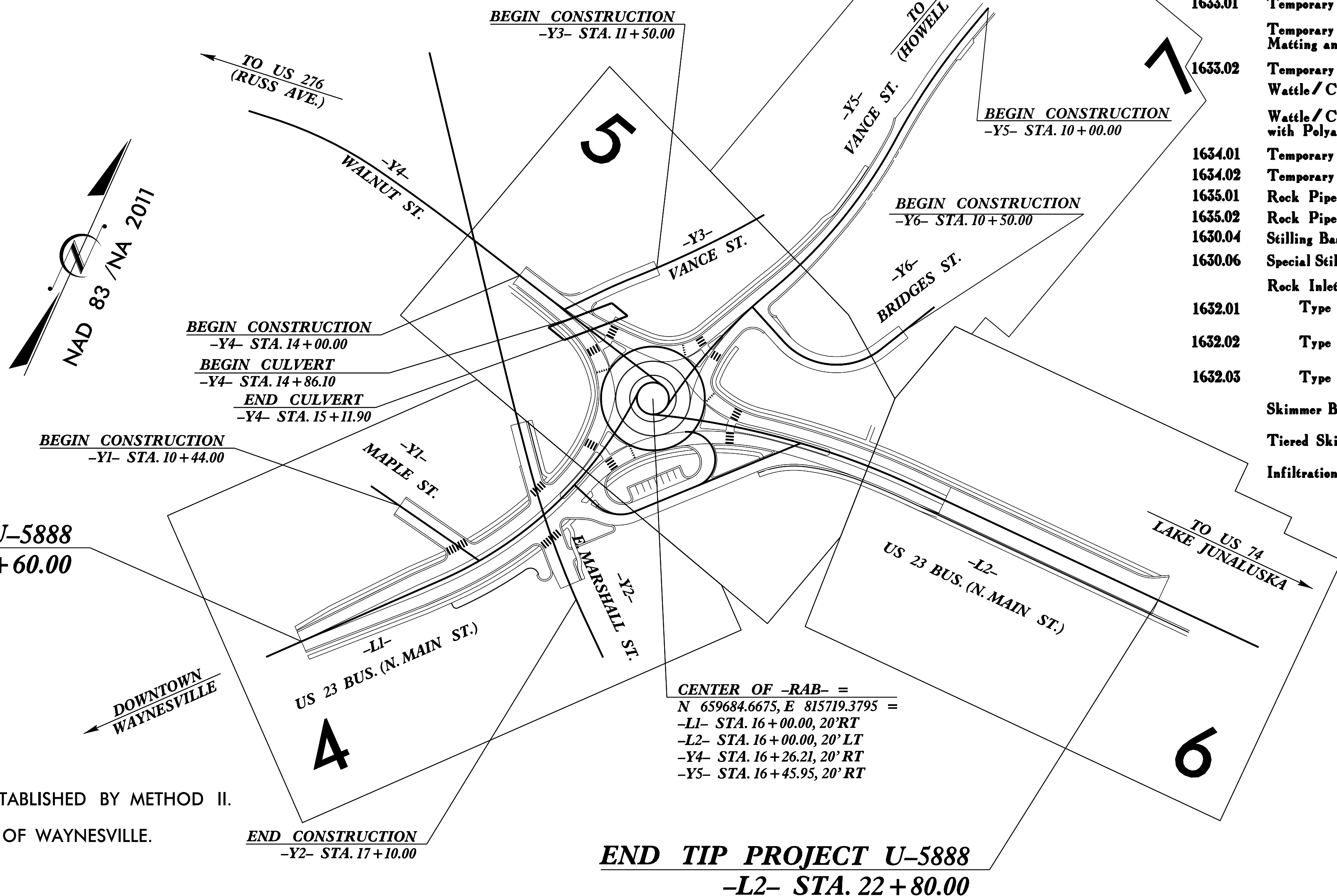

CLEARING ON THIS PROJECT SHALL BE PERFORMED TO THE LIMITS ESTABLISHED BY METHOD II.
THIS PROJECT IS WITHIN THE MUNICIPAL BOUNDARIES OF THE TOWN OF WAYNESVILLE.

| STATE | STATE PROJECT REFERENCE NO. | SHEET NO. | TOTAL SHEETS |
|-----------------|-----------------------------|-------------|--------------|
| N.C. | U-5888 | EC-1 | |
| STATE PROJ. NO. | F.A. PROJ. NO. | DESCRIPTION | |
| 44625.1.1 | N/A | PE | |
| 44625.1.1 | N/A | R/W /UTIL. | |

EROSION AND SEDIMENT CONTROL MEASURES

| Std. # | Description | Symbol |
|---------|--|--------|
| 1630.03 | Temporary Silt Ditch | |
| 1630.05 | Temporary Diversion | |
| 1605.01 | Temporary Silt Fence | |
| 1606.01 | Special Sediment Control Fence | |
| 1622.01 | Temporary Berms and Slope Drains | |
| 1630.02 | Silt Basin Type B | |
| 1633.01 | Temporary Rock Silt Check Type-A | |
| | Temporary Rock Silt Check Type-A with Matting and Polyacrylamide (PAM) | |
| 1633.02 | Temporary Rock Silt Check Type-B | |
| | Wattle / Coir Fiber Wattle | |
| | Wattle / Coir Fiber Wattle with Polyacrylamide (PAM) | |
| 1634.01 | Temporary Rock Sediment Dam Type-A | |
| 1634.02 | Temporary Rock Sediment Dam Type-B | |
| 1635.01 | Rock Pipe Inlet Sediment Trap Type-A | |
| 1635.02 | Rock Pipe Inlet Sediment Trap Type-B | |
| 1630.04 | Stilling Basin | |
| 1630.06 | Special Stilling Basin | |
| | Rock Inlet Sediment Trap: | |
| 1632.01 | Type A | |
| 1632.02 | Type B | |
| 1632.03 | Type C | |
| | Skimmer Basin | |
| | Tiered Skimmer Basin | |
| | Infiltration Basin | |

THIS PROJECT CONTAINS EROSION CONTROL PLANS FOR CLEARING AND GRUBBING PHASE OF CONSTRUCTION.

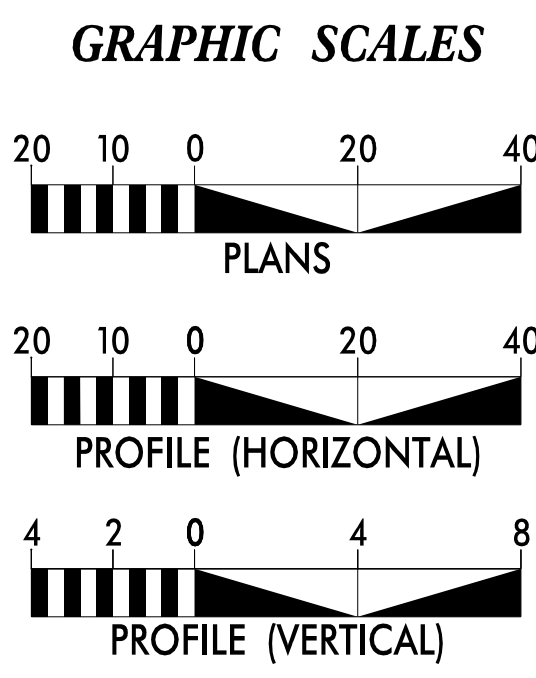

THESE EROSION AND SEDIMENT CONTROL PLANS COMPLY WITH THE REGULATIONS SET FORTH BY THE NCG-010000 GENERAL CONSTRUCTION PERMIT EFFECTIVE APRIL 1, 2019 AND ISSUED BY THE NORTH CAROLINA DEPARTMENT OF ENVIRONMENT AND NATURAL RESOURCES DIVISION OF WATER RESOURCES.

Prepared in the Office of:
WETHERILL ENGINEERING INC.
1223 Jones Franklin Road
Raleigh, nc 27606

Designed by:
Jim Davis, PE 3554
NAME LEVEL III CERTIFICATION NO.

Reviewed in the Office of:
ROADSIDE ENVIRONMENTAL UNIT
1 South Wilmington St.
Raleigh, NC 27611

2018 STANDARD SPECIFICATIONS

Roadway Standard Drawings

The following roadway english standards as appear in "Roadway Standard Drawings"- Roadway Design Unit - N. C. Department of Transportation - Raleigh, N. C., dated January 2018 and the latest revision thereto are applicable to this project and by reference hereby are considered a part of these plans.

| | |
|--|--|
| 1604.01 Railroad Erosion Control Detail | 1632.01 Rock Inlet Sediment Trap Type A |
| 1605.01 Temporary Silt Fence | 1632.02 Rock Inlet Sediment Trap Type B |
| 1606.01 Special Sediment Control Fence | 1632.03 Rock Inlet Sediment Trap Type C |
| 1607.01 Gravel Construction Entrance | 1633.01 Temporary Rock Silt Check Type A |
| 1622.01 Temporary Berms and Slope Drains | 1633.02 Temporary Rock Silt Check Type B |
| 1630.01 Riser Basin | 1634.01 Temporary Rock Sediment Dam Type A |
| 1630.02 Silt Basin Type B | 1634.02 Temporary Rock Sediment Dam Type B |
| 1630.03 Temporary Silt Ditch | 1635.01 Rock Pipe Inlet Sediment Trap Type A |
| 1630.04 Stilling Basin | 1635.02 Rock Pipe Inlet Sediment Trap Type B |
| 1630.05 Temporary Diversion | 1640.01 Coir Fiber Baffle |
| 1630.06 Special Stilling Basin | 1645.01 Temporary Stream Crossing |
| 1631.01 Matting Installation | |