

REVISIONS

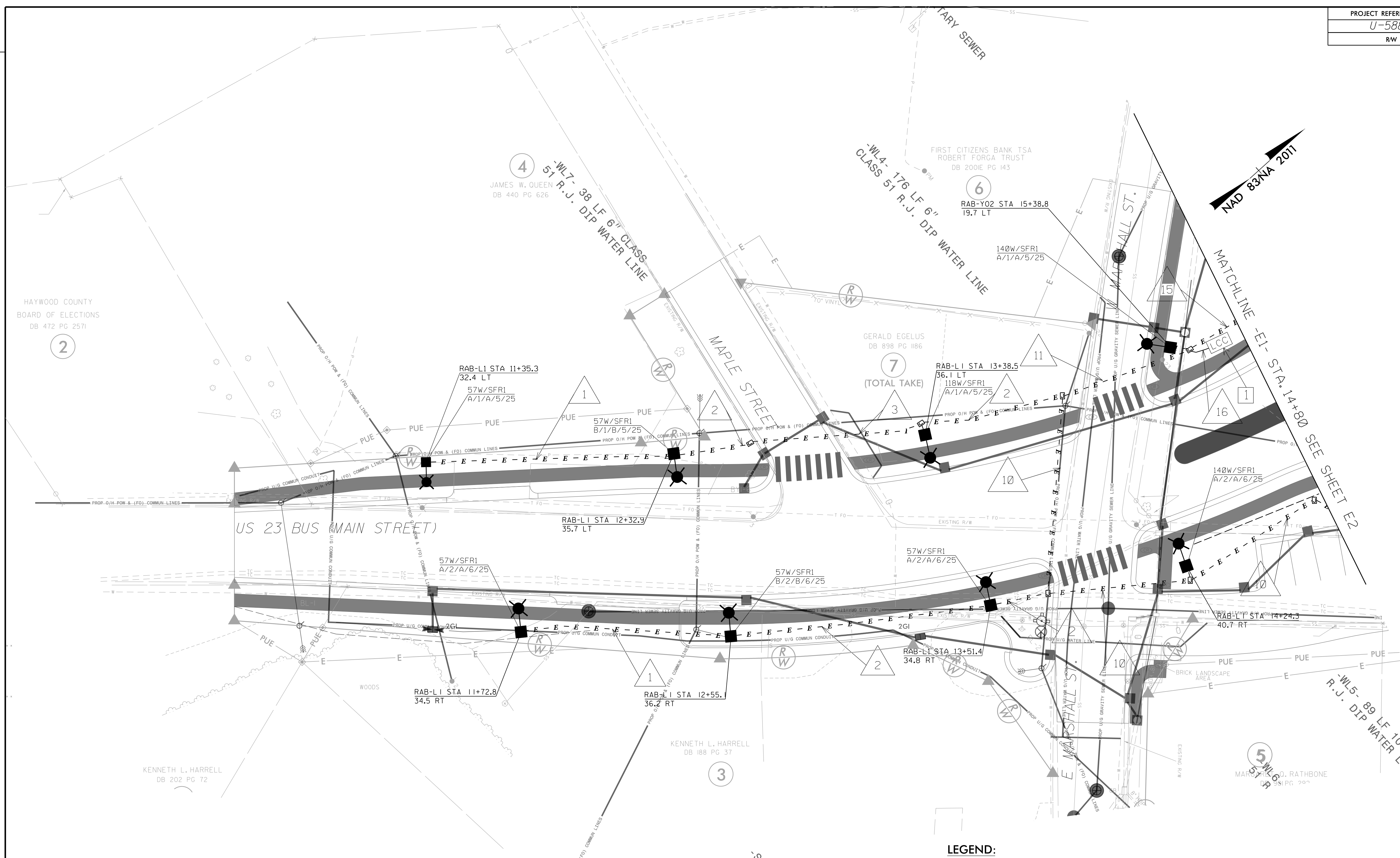

- GENERAL NOTES:**
- CONTRACTOR SHALL COORDINATE ELECTRICAL SERVICE CONNECTION WITH THE CITY OF WAYNESVILLE. CONTRACTOR SHALL OBTAIN 120/240V SERVICE.
 - CONTRACTOR SHALL INSTALL ALL EQUIPMENT IN ACCORDANCE WITH JURISDICTIONAL CODES AND STANDARDS AS WELL AS THE JURISDICTION'S LATEST ADOPTED VERSION OF THE NATIONAL ELECTRICAL CODE.
 - SEE SHEET E5 FOR LUMINAIRE CONDUIT AND CONDUCTOR SCHEDULE
 - CONTRACTOR SHALL LABEL LIGHT POLE RECEPTACLES FOR "MAX. OF 1.5A/180W LOAD"

- SHEET NOTES:**
- SEE SHEET E5 FOR LIGHTING CONTROL CENTER DETAILS.

LEGEND:

#W-SFR#	LUMINAIRE SUPERSCRIPT	- E - E -	ELECTRICAL CONDUIT (SEE CONDUIT AND CONDUCTOR SCHEDULE ON SHEET E5 FOR DETAILS)
#W	INDICATED LUMINAIRE WATTAGE	LCC	LIGHTING CONTROL CENTER
SFR#	INDICATES FOUNDATION TYPE	■	LUMINAIRE (SEE PHOTOMETRIC PLANS FOR DETAILS)
X/#/Y/\$/&	LUMINAIRE SUBSCRIPT	△	CONDUIT AND CONDUCTOR CALLOUT (SEE SHEET E5 FOR DETAILS)
X	INDICATES PHASE CONNECTION TO LUMINAIRE	□	13"W X 24"L X 18"D ELECTRICAL JUNCTION BOX
#	INDICATES CIRCUIT NUMBER FOR LUMINAIRE		
Y	INDICATES PHASE CONNECTION TO RECEPTACLE		
\$	INDICATES CIRCUIT NUMBER FOR RECEPTACLE		
&	INDICATES MOUNTING HEIGHT FOR LUMINAIRE		