

REFERENCE: U-2579AB

PROJECT: 34839

**CONTENTS**

<u>SHEET NO.</u>	<u>DESCRIPTION</u>
1	TITLE SHEET
2	LEGEND (SOIL & ROCK)
3-6	PLAN & PROFILE SHEETS

**STATE OF NORTH CAROLINA**  
**DEPARTMENT OF TRANSPORTATION**  
**DIVISION OF HIGHWAYS**  
**GEOTECHNICAL ENGINEERING UNIT**

**STRUCTURE**  
**SUBSURFACE INVESTIGATION**

COUNTY FORSYTH  
PROJECT DESCRIPTION WINSTON-SALEM BELTWAY  
FROM US 421/I-40 BUS TO I-40

SITE DESCRIPTION SOUND WALL 1516

STATE	STATE PROJECT REFERENCE NO.	SHEET NO.	TOTAL SHEETS
N.C.	U-2579AB	1	6

**CAUTION NOTICE**

THE SUBSURFACE INFORMATION AND THE SUBSURFACE INVESTIGATION ON WHICH IT IS BASED WERE MADE FOR THE PURPOSE OF STUDY, PLANNING AND DESIGN, AND NOT FOR CONSTRUCTION OR PAY PURPOSES. THE VARIOUS FIELD BORING LOGS, ROCK CORES AND SOIL TEST DATA AVAILABLE MAY BE REVIEWED OR INSPECTED IN RALEIGH BY CONTACTING THE N. C. DEPARTMENT OF TRANSPORTATION, GEOTECHNICAL ENGINEERING UNIT AT (919) 707-6850. THE SUBSURFACE PLANS AND REPORTS, FIELD BORING LOGS, ROCK CORES AND SOIL TEST DATA ARE NOT PART OF THE CONTRACT.

GENERAL SOIL AND ROCK STRATA DESCRIPTIONS AND INDICATED BOUNDARIES ARE BASED ON A GEOTECHNICAL INTERPRETATION OF ALL AVAILABLE SUBSURFACE DATA AND MAY NOT NECESSARILY REFLECT THE ACTUAL SUBSURFACE CONDITIONS BETWEEN BORINGS OR BETWEEN SAMPLED STRATA WITHIN THE BOREHOLE. THE LABORATORY SAMPLE DATA AND THE IN SITU (IN-PLACE) TEST DATA CAN BE RELIED ON ONLY TO THE DEGREE OF RELIABILITY INHERENT IN THE STANDARD TEST METHOD. THE OBSERVED WATER LEVELS OR SOIL MOISTURE CONDITIONS INDICATED IN THE SUBSURFACE INVESTIGATIONS ARE AS RECORDED AT THE TIME OF THE INVESTIGATION. THESE WATER LEVELS OR SOIL MOISTURE CONDITIONS MAY VARY CONSIDERABLY WITH TIME ACCORDING TO CLIMATIC CONDITIONS INCLUDING TEMPERATURES, PRECIPITATION AND WIND, AS WELL AS OTHER NON-CLIMATIC FACTORS.

THE BIDDER OR CONTRACTOR IS CAUTIONED THAT DETAILS SHOWN ON THE SUBSURFACE PLANS ARE PRELIMINARY ONLY AND IN MANY CASES THE FINAL DESIGN DETAILS ARE DIFFERENT. FOR BIDDING AND CONSTRUCTION PURPOSES, REFER TO THE CONSTRUCTION PLANS AND DOCUMENTS FOR FINAL DESIGN INFORMATION ON THIS PROJECT. THE DEPARTMENT DOES NOT WARRANT OR GUARANTEE THE SUFFICIENCY OR ACCURACY OF THE INVESTIGATION MADE, NOR THE INTERPRETATIONS MADE, OR OPINION OF THE DEPARTMENT AS TO THE TYPE OF MATERIALS AND CONDITIONS TO BE ENCOUNTERED. THE BIDDER OR CONTRACTOR IS CAUTIONED TO MAKE SUCH INDEPENDENT SUBSURFACE INVESTIGATIONS AS HE DEEMS NECESSARY TO SATISFY HIMSELF AS TO CONDITIONS TO BE ENCOUNTERED ON THE PROJECT. THE CONTRACTOR SHALL HAVE NO CLAIM FOR ADDITIONAL COMPENSATION OR FOR AN EXTENSION OF TIME FOR ANY REASON RESULTING FROM THE ACTUAL CONDITIONS ENCOUNTERED AT THE SITE DIFFERING FROM THOSE INDICATED IN THE SUBSURFACE INFORMATION.

- NOTES:
1. THE INFORMATION CONTAINED HEREIN IS NOT IMPLIED OR GUARANTEED BY THE N. C. DEPARTMENT OF TRANSPORTATION AS ACCURATE NOR IS IT CONSIDERED PART OF THE PLANS, SPECIFICATIONS OR CONTRACT FOR THE PROJECT.
  2. BY HAVING REQUESTED THIS INFORMATION, THE CONTRACTOR SPECIFICALLY WAIVES ANY CLAIMS FOR INCREASED COMPENSATION OR EXTENSION OF TIME BASED ON DIFFERENCES BETWEEN THE CONDITIONS INDICATED HEREIN AND THE ACTUAL CONDITIONS AT THE PROJECT SITE.

**PERSONNEL**

A. SUTTLE, G.I.T.

**TOTAL DEPTH DRILLING**

J. GARRICK, G.I.T.

INVESTIGATED BY ECS SOUTHEAST, LLP

DRAWN BY K. DE MONTBRUN, P.E.

CHECKED BY M. WALKO, P.E.

SUBMITTED BY ECS SOUTHEAST, LLP

DATE JULY 2021

Prepared in the Office of:



ECS SOUTHEAST, LLP  
1812 CENTER PARK DRIVE, SUITE D  
CHARLOTTE, NC 28217  
(704) 525-5152 [PHONE]  
(704) 357-0023 [FAX]  
NC REGISTERED  
ENGINEERING  
FIRM # F-1078



DocuSigned by:  
Kelly de Montbrun 7/13/2021  
7BDD9975E2830A  
SIGNATURE DATE

**DOCUMENT NOT CONSIDERED FINAL UNLESS ALL SIGNATURES COMPLETED**

**NORTH CAROLINA DEPARTMENT OF TRANSPORTATION**  
**DIVISION OF HIGHWAYS**  
**GEOTECHNICAL ENGINEERING UNIT**  
**SUBSURFACE INVESTIGATION**  
**SOIL AND ROCK LEGEND, TERMS, SYMBOLS, AND ABBREVIATIONS**

SOIL DESCRIPTION										GRADATION					ROCK DESCRIPTION					TERMS AND DEFINITIONS																																																																																																																																																																					
SOIL IS CONSIDERED UNCONSOLIDATED, SEMI-CONSOLIDATED, OR WEATHERED EARTH MATERIALS THAT CAN BE PENETRATED WITH A CONTINUOUS FLIGHT POWER AUGER AND YIELD LESS THAN 100 BLOWS PER FOOT ACCORDING TO THE STANDARD PENETRATION TEST (AASHTO T 206, ASTM D1586). SOIL CLASSIFICATION IS BASED ON THE AASHTO SYSTEM. BASIC DESCRIPTIONS GENERALLY INCLUDE THE FOLLOWING: CONSISTENCY, COLOR, TEXTURE, MOISTURE, AASHTO CLASSIFICATION, AND OTHER PERTINENT FACTORS SUCH AS MINERALOGICAL COMPOSITION, ANGULARITY, STRUCTURE, PLASTICITY, ETC. FOR EXAMPLE, <i>VERY STIFF, GRAY, SILTY CLAY, MOIST WITH INTERBEDDED FINE SAND LAYERS, HIGHLY PLASTIC, A-7-6</i>										WELL GRADED - INDICATES A GOOD REPRESENTATION OF PARTICLE SIZES FROM FINE TO COARSE. UNIFORMLY GRADED - INDICATES THAT SOIL PARTICLES ARE ALL APPROXIMATELY THE SAME SIZE. GAP-GRADED - INDICATES A MIXTURE OF UNIFORM PARTICLE SIZES OF TWO OR MORE SIZES.					HARD ROCK IS NON-COASTAL PLAIN MATERIAL THAT WOULD YIELD SPT REFUSAL IF TESTED, AN INFERRED ROCK LINE INDICATES THE LEVEL AT WHICH NON-COASTAL PLAIN MATERIAL WOULD YIELD SPT REFUSAL. SPT REFUSAL IS PENETRATION BY A SPLIT SPOON SAMPLER EQUAL TO OR LESS THAN 0.1 FOOT PER 60 BLOWS IN NON-COASTAL PLAIN MATERIAL. THE TRANSITION BETWEEN SOIL AND ROCK IS OFTEN REPRESENTED BY A ZONE OF WEATHERED ROCK. ROCK MATERIALS ARE TYPICALLY DIVIDED AS FOLLOWS:					ALLUVIUM (ALLUV.) - SOILS THAT HAVE BEEN TRANSPORTED BY WATER. AQUIFER - A WATER BEARING FORMATION OR STRATA. ARENACEOUS - APPLIED TO ROCKS THAT HAVE BEEN DERIVED FROM SAND OR THAT CONTAIN SAND. ARGILLACEOUS - APPLIED TO ALL ROCKS OR SUBSTANCES COMPOSED OF CLAY MINERALS, OR HAVING A NOTABLE PROPORTION OF CLAY IN THEIR COMPOSITION, SUCH AS SHALE, SLATE, ETC. ARTESIAN - GROUND WATER THAT IS UNDER SUFFICIENT PRESSURE TO RISE ABOVE THE LEVEL AT WHICH IT IS ENCOUNTERED, BUT WHICH DOES NOT NECESSARILY RISE TO OR ABOVE THE GROUND SURFACE. CALCAREOUS (CALC.) - SOILS THAT CONTAIN APPRECIABLE AMOUNTS OF CALCIUM CARBONATE. COLLUVIUM - ROCK FRAGMENTS MIXED WITH SOIL DEPOSITED BY GRAVITY ON SLOPE OR AT BOTTOM OF SLOPE. CORE RECOVERY (REC.) - TOTAL LENGTH OF ALL MATERIAL RECOVERED IN THE CORE BARREL DIVIDED BY TOTAL LENGTH OF CORE RUN AND EXPRESSED AS A PERCENTAGE. DIKE - A TABULAR BODY OF IGNEOUS ROCK THAT CUTS ACROSS THE STRUCTURE OF ADJACENT ROCKS OR CUTS MASSIVE ROCK. DIP - THE ANGLE AT WHICH A STRATUM OR ANY PLANAR FEATURE IS INCLINED FROM THE HORIZONTAL. DIP DIRECTION (DIP AZIMUTH) - THE DIRECTION OR BEARING OF THE HORIZONTAL TRACE OF THE LINE OF DIP, MEASURED CLOCKWISE FROM NORTH. FAULT - A FRACTURE OR FRACTURE ZONE ALONG WHICH THERE HAS BEEN DISPLACEMENT OF THE SIDES RELATIVE TO ONE ANOTHER PARALLEL TO THE FRACTURE. FISSILE - A PROPERTY OF SPLITTING ALONG CLOSELY SPACED PARALLEL PLANES. FLOAT - ROCK FRAGMENTS ON SURFACE NEAR THEIR ORIGINAL POSITION AND DISLOGGED FROM PARENT MATERIAL. FLOOD PLAIN (FP) - LAND BORDERING A STREAM, BUILT OF SEDIMENTS DEPOSITED BY THE STREAM. FORMATION (FM) - A MAPPABLE GEOLOGIC UNIT THAT CAN BE RECOGNIZED AND TRACED IN THE FIELD. JOINT - FRACTURE IN ROCK ALONG WHICH NO APPRECIABLE MOVEMENT HAS OCCURRED. LEDGE - A SHELF-LIKE RIDGE OR PROJECTION OF ROCK WHOSE THICKNESS IS SMALL COMPARED TO ITS LATERAL EXTENT. LENS - A BODY OF SOIL OR ROCK THAT THINS OUT IN ONE OR MORE DIRECTIONS. MOTTLED (MOT.) - IRREGULARLY MARKED WITH SPOTS OF DIFFERENT COLORS, MOTTLING IN SOILS USUALLY INDICATES POOR AERATION AND LACK OF GOOD DRAINAGE. PERCHED WATER - WATER MAINTAINED ABOVE THE NORMAL GROUND WATER LEVEL BY THE PRESENCE OF AN INTERVENING IMPERVIOUS STRATUM. RESIDUAL (RES.) SOIL - SOIL FORMED IN PLACE BY THE WEATHERING OF ROCK. ROCK QUALITY DESIGNATION (ROD) - A MEASURE OF ROCK QUALITY DESCRIBED BY TOTAL LENGTH OF ROCK SEGMENTS EQUAL TO OR GREATER THAN 4 INCHES DIVIDED BY THE TOTAL LENGTH OF CORE RUN AND EXPRESSED AS A PERCENTAGE. SAPROLITE (SAP.) - RESIDUAL SOIL THAT RETAINS THE RELIC STRUCTURE OR FABRIC OF THE PARENT ROCK. SILL - AN INTRUSIVE BODY OF IGNEOUS ROCK OF APPROXIMATELY UNIFORM THICKNESS AND RELATIVELY THIN COMPARED WITH ITS LATERAL EXTENT, THAT HAS BEEN EMPLACED PARALLEL TO THE BEDDING OR SCHISTOSITY OF THE INTRUDED ROCKS. SLICKENSIDE - POLISHED AND STRIATED SURFACE THAT RESULTS FROM FRICTION ALONG A FAULT OR SLIP PLANE. STANDARD PENETRATION TEST (PENETRATION RESISTANCE) (SPT) - NUMBER OF BLOWS (N OR BPF) OF A 140 LB. HAMMER FALLING 30 INCHES REQUIRED TO PRODUCE A PENETRATION OF 1 FOOT INTO SOIL WITH A 2 INCH OUTSIDE DIAMETER SPLIT SPOON SAMPLER. SPT REFUSAL IS PENETRATION EQUAL TO OR LESS THAN 0.1 FOOT PER 60 BLOWS. STRATA CORE RECOVERY (SREC.) - TOTAL LENGTH OF STRATA MATERIAL RECOVERED DIVIDED BY TOTAL LENGTH OF STRATUM AND EXPRESSED AS A PERCENTAGE. STRATA ROCK QUALITY DESIGNATION (SROD) - A MEASURE OF ROCK QUALITY DESCRIBED BY TOTAL LENGTH OF ROCK SEGMENTS WITHIN A STRATUM EQUAL TO OR GREATER THAN 4 INCHES DIVIDED BY THE TOTAL LENGTH OF STRATA AND EXPRESSED AS A PERCENTAGE. TOPSOIL (TS) - SURFACE SOILS USUALLY CONTAINING ORGANIC MATTER.																																																																																																																																																																					
<b>SOIL LEGEND AND AASHTO CLASSIFICATION</b>										<b>ANGULARITY OF GRAINS</b>					<b>WEATHERING</b>					<b>ROCK HARDNESS</b>																																																																																																																																																																					
<table border="1" style="width:100%; border-collapse: collapse;"> <tr> <th colspan="10">SOIL LEGEND AND AASHTO CLASSIFICATION</th> </tr> <tr> <th rowspan="2">GENERAL CLASS.</th> <th colspan="5">GRANULAR MATERIALS (&lt;= 35% PASSING #200)</th> <th colspan="5">SILT-CLAY MATERIALS (&gt; 35% PASSING #200)</th> <th colspan="5">ORGANIC MATERIALS</th> </tr> <tr> <th>A-1</th> <th>A-3</th> <th>A-2</th> <th>A-2-4</th> <th>A-2-5</th> <th>A-2-6</th> <th>A-2-7</th> <th>A-4</th> <th>A-5</th> <th>A-6</th> <th>A-7</th> <th>A-1, A-2</th> <th>A-3</th> <th>A-4, A-5</th> <th>A-6, A-7</th> </tr> <tr> <th>GROUP CLASS.</th> <td>A-1-a</td> <td>A-1-b</td> <td>A-3</td> <td>A-2-4</td> <td>A-2-5</td> <td>A-2-6</td> <td>A-2-7</td> <td>A-4</td> <td>A-5</td> <td>A-6</td> <td>A-7</td> <td>A-1, A-2</td> <td>A-3</td> <td>A-4, A-5</td> <td>A-6, A-7</td> </tr> <tr> <th>SYMBOL</th> <td></td> <td></td> <td></td> <td></td> <td></td> <td></td> <td></td> <td></td> <td></td> <td></td> <td></td> <td></td> <td></td> <td></td> <td></td> </tr> <tr> <th>% PASSING #10 #40 #200</th> <td>50 MX 30 MX 15 MX</td> <td>50 MX 25 MX</td> <td>51 MN 35 MX</td> <td>40 MX 35 MX</td> <td>41 MN 35 MX</td> <td>42 MN 35 MX</td> <td>43 MN 35 MX</td> <td>36 MN</td> <td>37 MN</td> <td>38 MN</td> <td>39 MN</td> <td>40 MN</td> <td>41 MN</td> <td>42 MN</td> <td>43 MN</td> </tr> <tr> <th>MATERIAL PASSING #40 LL PI</th> <td>-</td> <td>-</td> <td>NP</td> <td>40 MX</td> <td>41 MN</td> <td>42 MN</td> <td>43 MN</td> <td>40 MX</td> <td>41 MN</td> <td>42 MN</td> <td>43 MN</td> <td>40 MX</td> <td>41 MN</td> <td>42 MN</td> <td>43 MN</td> </tr> <tr> <th>GROUP INDEX</th> <td>0</td> <td>0</td> <td>0</td> <td>0</td> <td>0</td> <td>0</td> <td>0</td> <td>0</td> <td>0</td> <td>0</td> <td>0</td> <td>0</td> <td>0</td> <td>0</td> <td>0</td> </tr> <tr> <th>USUAL TYPES OF MAJOR MATERIALS</th> <td colspan="3">STONE FRAGS. GRAVEL, AND SAND</td> <td colspan="3">FINE SAND</td> <td colspan="3">SILTY OR CLAYEY GRAVEL AND SAND</td> <td colspan="3">SILTY SOILS</td> <td colspan="3">CLAYEY SOILS</td> </tr> <tr> <th>GEN. RATING AS SUBGRADE</th> <td colspan="5">EXCELLENT TO GOOD</td> <td colspan="5">FAIR TO POOR</td> <td>FAIR TO POOR</td> <td>POOR</td> <td>UNSATURABLE</td> </tr> <tr> <td colspan="10">PI OF A-7-5 SUBGROUP IS &lt;= LL - 30 ; PI OF A-7-6 SUBGROUP IS &gt; LL - 30</td> </tr> </table>										SOIL LEGEND AND AASHTO CLASSIFICATION										GENERAL CLASS.	GRANULAR MATERIALS (<= 35% PASSING #200)					SILT-CLAY MATERIALS (> 35% PASSING #200)					ORGANIC MATERIALS					A-1	A-3	A-2	A-2-4	A-2-5	A-2-6	A-2-7	A-4	A-5	A-6	A-7	A-1, A-2	A-3	A-4, A-5	A-6, A-7	GROUP CLASS.	A-1-a	A-1-b	A-3	A-2-4	A-2-5	A-2-6	A-2-7	A-4	A-5	A-6	A-7	A-1, A-2	A-3	A-4, A-5	A-6, A-7	SYMBOL																% PASSING #10 #40 #200	50 MX 30 MX 15 MX	50 MX 25 MX	51 MN 35 MX	40 MX 35 MX	41 MN 35 MX	42 MN 35 MX	43 MN 35 MX	36 MN	37 MN	38 MN	39 MN	40 MN	41 MN	42 MN	43 MN	MATERIAL PASSING #40 LL PI	-	-	NP	40 MX	41 MN	42 MN	43 MN	40 MX	41 MN	42 MN	43 MN	40 MX	41 MN	42 MN	43 MN	GROUP INDEX	0	0	0	0	0	0	0	0	0	0	0	0	0	0	0	USUAL TYPES OF MAJOR MATERIALS	STONE FRAGS. GRAVEL, AND SAND			FINE SAND			SILTY OR CLAYEY GRAVEL AND SAND			SILTY SOILS			CLAYEY SOILS			GEN. RATING AS SUBGRADE	EXCELLENT TO GOOD					FAIR TO POOR					FAIR TO POOR	POOR	UNSATURABLE	PI OF A-7-5 SUBGROUP IS <= LL - 30 ; PI OF A-7-6 SUBGROUP IS > LL - 30										<b>MINERALOGICAL COMPOSITION</b>					<b>PERCENTAGE OF MATERIAL</b>					<b>GROUND WATER</b>				
SOIL LEGEND AND AASHTO CLASSIFICATION																																																																																																																																																																																									
GENERAL CLASS.	GRANULAR MATERIALS (<= 35% PASSING #200)					SILT-CLAY MATERIALS (> 35% PASSING #200)					ORGANIC MATERIALS																																																																																																																																																																														
	A-1	A-3	A-2	A-2-4	A-2-5	A-2-6	A-2-7	A-4	A-5	A-6	A-7	A-1, A-2	A-3	A-4, A-5	A-6, A-7																																																																																																																																																																										
GROUP CLASS.	A-1-a	A-1-b	A-3	A-2-4	A-2-5	A-2-6	A-2-7	A-4	A-5	A-6	A-7	A-1, A-2	A-3	A-4, A-5	A-6, A-7																																																																																																																																																																										
SYMBOL																																																																																																																																																																																									
% PASSING #10 #40 #200	50 MX 30 MX 15 MX	50 MX 25 MX	51 MN 35 MX	40 MX 35 MX	41 MN 35 MX	42 MN 35 MX	43 MN 35 MX	36 MN	37 MN	38 MN	39 MN	40 MN	41 MN	42 MN	43 MN																																																																																																																																																																										
MATERIAL PASSING #40 LL PI	-	-	NP	40 MX	41 MN	42 MN	43 MN	40 MX	41 MN	42 MN	43 MN	40 MX	41 MN	42 MN	43 MN																																																																																																																																																																										
GROUP INDEX	0	0	0	0	0	0	0	0	0	0	0	0	0	0	0																																																																																																																																																																										
USUAL TYPES OF MAJOR MATERIALS	STONE FRAGS. GRAVEL, AND SAND			FINE SAND			SILTY OR CLAYEY GRAVEL AND SAND			SILTY SOILS			CLAYEY SOILS																																																																																																																																																																												
GEN. RATING AS SUBGRADE	EXCELLENT TO GOOD					FAIR TO POOR					FAIR TO POOR	POOR	UNSATURABLE																																																																																																																																																																												
PI OF A-7-5 SUBGROUP IS <= LL - 30 ; PI OF A-7-6 SUBGROUP IS > LL - 30																																																																																																																																																																																									
GENERAL CLASS.										MINERAL NAMES SUCH AS QUARTZ, FELDSPAR, MICA, TALC, KAOLIN, ETC. ARE USED IN DESCRIPTIONS WHEN THEY ARE CONSIDERED OF SIGNIFICANCE.					SLIGHTLY COMPRESSIBLE LL < 31 MODERATELY COMPRESSIBLE LL = 31 - 50 HIGHLY COMPRESSIBLE LL > 50					<table border="1" style="width:100%; border-collapse: collapse;"> <tr> <th colspan="4">PERCENTAGE OF MATERIAL</th> </tr> <tr> <th>ORGANIC MATERIAL</th> <th>GRANULAR SOILS</th> <th>SILT - CLAY SOILS</th> <th>OTHER MATERIAL</th> </tr> <tr> <td>TRACE OF ORGANIC MATTER</td> <td>2 - 3%</td> <td>3 - 5%</td> <td>TRACE</td> </tr> <tr> <td>LITTLE ORGANIC MATTER</td> <td>3 - 5%</td> <td>5 - 12%</td> <td>LITTLE</td> </tr> <tr> <td>MODERATELY ORGANIC</td> <td>5 - 10%</td> <td>12 - 20%</td> <td>SOME</td> </tr> <tr> <td>HIGHLY ORGANIC</td> <td>&gt; 10%</td> <td>&gt; 20%</td> <td>HIGHLY</td> </tr> <tr> <td></td> <td></td> <td></td> <td>35% AND ABOVE</td> </tr> </table>					PERCENTAGE OF MATERIAL				ORGANIC MATERIAL	GRANULAR SOILS	SILT - CLAY SOILS	OTHER MATERIAL	TRACE OF ORGANIC MATTER	2 - 3%	3 - 5%	TRACE	LITTLE ORGANIC MATTER	3 - 5%	5 - 12%	LITTLE	MODERATELY ORGANIC	5 - 10%	12 - 20%	SOME	HIGHLY ORGANIC	> 10%	> 20%	HIGHLY				35% AND ABOVE																																																																																																																																					
PERCENTAGE OF MATERIAL																																																																																																																																																																																									
ORGANIC MATERIAL	GRANULAR SOILS	SILT - CLAY SOILS	OTHER MATERIAL																																																																																																																																																																																						
TRACE OF ORGANIC MATTER	2 - 3%	3 - 5%	TRACE																																																																																																																																																																																						
LITTLE ORGANIC MATTER	3 - 5%	5 - 12%	LITTLE																																																																																																																																																																																						
MODERATELY ORGANIC	5 - 10%	12 - 20%	SOME																																																																																																																																																																																						
HIGHLY ORGANIC	> 10%	> 20%	HIGHLY																																																																																																																																																																																						
			35% AND ABOVE																																																																																																																																																																																						
<b>CONSISTENCY OR DENSENESS</b>										<b>MISCELLANEOUS SYMBOLS</b>					<b>RECOMMENDATION SYMBOLS</b>																																																																																																																																																																										
<table border="1" style="width:100%; border-collapse: collapse;"> <tr> <th rowspan="2">PRIMARY SOIL TYPE</th> <th rowspan="2">COMPACTNESS OR CONSISTENCY</th> <th colspan="2">RANGE OF STANDARD PENETRATION RESISTANCE (N-VALUE)</th> <th colspan="2">RANGE OF UNCONFINED COMPRESSIVE STRENGTH (TONS/FT<sup>2</sup>)</th> </tr> <tr> <th>&lt; 4</th> <th>4 TO 10</th> <th>&lt; 0.25</th> <th>0.25 TO 0.5</th> </tr> <tr> <td>GENERALLY GRANULAR MATERIAL (NON-COHEISIVE)</td> <td>VERY LOOSE LOOSE MEDIUM DENSE DENSE VERY DENSE</td> <td>4 TO 10</td> <td>10 TO 30</td> <td>N/A</td> <td>N/A</td> </tr> <tr> <td>GENERALLY SILT-CLAY MATERIAL (COHEISIVE)</td> <td>VERY SOFT SOFT MEDIUM STIFF STIFF VERY STIFF HARD</td> <td>&lt; 2 2 TO 4 4 TO 8 8 TO 15 15 TO 30 &gt; 30</td> <td>2 TO 4 4 TO 8 8 TO 15 15 TO 30 &gt; 30</td> <td>&lt; 0.25 0.25 TO 0.5 0.5 TO 1.0 1 TO 2 2 TO 4 &gt; 4</td> <td>&lt; 0.25 0.25 TO 0.5 0.5 TO 1.0 1 TO 2 2 TO 4 &gt; 4</td> </tr> </table>										PRIMARY SOIL TYPE	COMPACTNESS OR CONSISTENCY	RANGE OF STANDARD PENETRATION RESISTANCE (N-VALUE)		RANGE OF UNCONFINED COMPRESSIVE STRENGTH (TONS/FT <sup>2</sup> )		< 4	4 TO 10	< 0.25	0.25 TO 0.5	GENERALLY GRANULAR MATERIAL (NON-COHEISIVE)	VERY LOOSE LOOSE MEDIUM DENSE DENSE VERY DENSE	4 TO 10	10 TO 30	N/A	N/A	GENERALLY SILT-CLAY MATERIAL (COHEISIVE)	VERY SOFT SOFT MEDIUM STIFF STIFF VERY STIFF HARD	< 2 2 TO 4 4 TO 8 8 TO 15 15 TO 30 > 30	2 TO 4 4 TO 8 8 TO 15 15 TO 30 > 30	< 0.25 0.25 TO 0.5 0.5 TO 1.0 1 TO 2 2 TO 4 > 4	< 0.25 0.25 TO 0.5 0.5 TO 1.0 1 TO 2 2 TO 4 > 4	<table border="1" style="width:100%; border-collapse: collapse;"> <tr> <th colspan="2">ROADWAY EMBANKMENT (RE) WITH SOIL DESCRIPTION</th> <th colspan="2">DIP &amp; DIP DIRECTION OF ROCK STRUCTURES</th> <th colspan="2">SLOPE INDICATOR INSTALLATION</th> </tr> <tr> <td></td> <td>SOIL SYMBOL</td> <td></td> <td>SPT TEST BORING</td> <td></td> <td>CONE PENETROMETER TEST</td> </tr> <tr> <td></td> <td>ARTIFICIAL FILL (AF) OTHER THAN ROADWAY EMBANKMENT</td> <td></td> <td>AUGER BORING</td> <td></td> <td>SOUNDING ROD</td> </tr> <tr> <td></td> <td>INFERRED SOIL BOUNDARY</td> <td></td> <td>CORE BORING</td> <td></td> <td>TEST BORING WITH CORE</td> </tr> <tr> <td></td> <td>INFERRED ROCK LINE</td> <td></td> <td>MONITORING WELL</td> <td></td> <td>SPT N-VALUE</td> </tr> <tr> <td></td> <td>ALLUVIAL SOIL BOUNDARY</td> <td></td> <td>PIEZOMETER INSTALLATION</td> <td></td> <td></td> </tr> </table>					ROADWAY EMBANKMENT (RE) WITH SOIL DESCRIPTION		DIP & DIP DIRECTION OF ROCK STRUCTURES		SLOPE INDICATOR INSTALLATION			SOIL SYMBOL		SPT TEST BORING		CONE PENETROMETER TEST		ARTIFICIAL FILL (AF) OTHER THAN ROADWAY EMBANKMENT		AUGER BORING		SOUNDING ROD		INFERRED SOIL BOUNDARY		CORE BORING		TEST BORING WITH CORE		INFERRED ROCK LINE		MONITORING WELL		SPT N-VALUE		ALLUVIAL SOIL BOUNDARY		PIEZOMETER INSTALLATION			<table border="1" style="width:100%; border-collapse: collapse;"> <tr> <th colspan="3">RECOMMENDATION SYMBOLS</th> </tr> <tr> <td></td> <td>UNDERCUT</td> <td></td> </tr> <tr> <td></td> <td>SHALLOW UNDERCUT</td> <td></td> </tr> <tr> <td></td> <td>UNCLASSIFIED EXCAVATION - UNSUITABLE WASTE</td> <td></td> </tr> <tr> <td></td> <td>UNCLASSIFIED EXCAVATION - ACCEPTABLE DEGRADABLE ROCK</td> <td></td> </tr> </table>					RECOMMENDATION SYMBOLS				UNDERCUT			SHALLOW UNDERCUT			UNCLASSIFIED EXCAVATION - UNSUITABLE WASTE			UNCLASSIFIED EXCAVATION - ACCEPTABLE DEGRADABLE ROCK																																																																																														
PRIMARY SOIL TYPE	COMPACTNESS OR CONSISTENCY	RANGE OF STANDARD PENETRATION RESISTANCE (N-VALUE)		RANGE OF UNCONFINED COMPRESSIVE STRENGTH (TONS/FT <sup>2</sup> )																																																																																																																																																																																					
		< 4	4 TO 10	< 0.25	0.25 TO 0.5																																																																																																																																																																																				
GENERALLY GRANULAR MATERIAL (NON-COHEISIVE)	VERY LOOSE LOOSE MEDIUM DENSE DENSE VERY DENSE	4 TO 10	10 TO 30	N/A	N/A																																																																																																																																																																																				
GENERALLY SILT-CLAY MATERIAL (COHEISIVE)	VERY SOFT SOFT MEDIUM STIFF STIFF VERY STIFF HARD	< 2 2 TO 4 4 TO 8 8 TO 15 15 TO 30 > 30	2 TO 4 4 TO 8 8 TO 15 15 TO 30 > 30	< 0.25 0.25 TO 0.5 0.5 TO 1.0 1 TO 2 2 TO 4 > 4	< 0.25 0.25 TO 0.5 0.5 TO 1.0 1 TO 2 2 TO 4 > 4																																																																																																																																																																																				
ROADWAY EMBANKMENT (RE) WITH SOIL DESCRIPTION		DIP & DIP DIRECTION OF ROCK STRUCTURES		SLOPE INDICATOR INSTALLATION																																																																																																																																																																																					
	SOIL SYMBOL		SPT TEST BORING		CONE PENETROMETER TEST																																																																																																																																																																																				
	ARTIFICIAL FILL (AF) OTHER THAN ROADWAY EMBANKMENT		AUGER BORING		SOUNDING ROD																																																																																																																																																																																				
	INFERRED SOIL BOUNDARY		CORE BORING		TEST BORING WITH CORE																																																																																																																																																																																				
	INFERRED ROCK LINE		MONITORING WELL		SPT N-VALUE																																																																																																																																																																																				
	ALLUVIAL SOIL BOUNDARY		PIEZOMETER INSTALLATION																																																																																																																																																																																						
RECOMMENDATION SYMBOLS																																																																																																																																																																																									
	UNDERCUT																																																																																																																																																																																								
	SHALLOW UNDERCUT																																																																																																																																																																																								
	UNCLASSIFIED EXCAVATION - UNSUITABLE WASTE																																																																																																																																																																																								
	UNCLASSIFIED EXCAVATION - ACCEPTABLE DEGRADABLE ROCK																																																																																																																																																																																								
<b>TEXTURE OR GRAIN SIZE</b>										<b>ABBREVIATIONS</b>					<b>TEXTURE OR GRAIN SIZE</b>																																																																																																																																																																										
<table border="1" style="width:100%; border-collapse: collapse;"> <tr> <th>U.S. STD. SIEVE SIZE OPENING (MM)</th> <th>4</th> <th>10</th> <th>40</th> <th>60</th> <th>200</th> <th>270</th> </tr> <tr> <th></th> <td>4.76</td> <td>2.00</td> <td>0.42</td> <td>0.25</td> <td>0.075</td> <td>0.053</td> </tr> <tr> <th>BOULDER (BLDR.)</th> <th>COBBLE (COB.)</th> <th>GRAVEL (GR.)</th> <th>COARSE SAND (CS.SD.)</th> <th>FINE SAND (F.SD.)</th> <th>SILT (SL.)</th> <th>CLAY (CL.)</th> </tr> <tr> <td></td> <td></td> <td></td> <td></td> <td></td> <td></td> <td></td> </tr> <tr> <th>GRAIN SIZE</th> <th>MM</th> <th>305</th> <th>75</th> <th>2.0</th> <th>0.25</th> <th>0.05</th> </tr> <tr> <th></th> <th>IN.</th> <td>12</td> <td>3</td> <td></td> <td></td> <td>0.005</td> </tr> </table>										U.S. STD. SIEVE SIZE OPENING (MM)	4	10	40	60	200	270		4.76	2.00	0.42	0.25	0.075	0.053	BOULDER (BLDR.)	COBBLE (COB.)	GRAVEL (GR.)	COARSE SAND (CS.SD.)	FINE SAND (F.SD.)	SILT (SL.)	CLAY (CL.)								GRAIN SIZE	MM	305	75	2.0	0.25	0.05		IN.	12	3			0.005	<table border="1" style="width:100%; border-collapse: collapse;"> <tr> <th colspan="3">ABBREVIATIONS</th> </tr> <tr> <td>AR - AUGER REFUSAL</td> <td>BT - BORING TERMINATED</td> <td>CL - CLAY</td> </tr> <tr> <td>CPT - COARSE PENETRATION TEST</td> <td>CSE - COARSE</td> <td>DMT - DILATOMETER TEST</td> </tr> <tr> <td>DPT - DYNAMIC PENETRATION TEST</td> <td>e - VOID RATIO</td> <td>F - FINE</td> </tr> <tr> <td>FOSS. - FOSSILIFEROUS</td> <td>FRAC. - FRACTURED, FRACTURES</td> <td>FRAGS. - FRAGMENTS</td> </tr> <tr> <td>HI. - HIGHLY</td> <td></td> <td></td> </tr> <tr> <td>MED. - MEDIUM</td> <td>MICA - MICACEOUS</td> <td>MOD. - MODERATELY</td> </tr> <tr> <td>NP - NON PLASTIC</td> <td>ORG. - ORGANIC</td> <td>PMT - PRESSUREMETER TEST</td> </tr> <tr> <td>SAP. - SAPROLITIC</td> <td>SD. - SAND, SANDY</td> <td>SL. - SILTY, SILTY</td> </tr> <tr> <td>SLI. - SLIGHTLY</td> <td>TCR - TRICONE REFUSAL</td> <td>w - MOISTURE CONTENT</td> </tr> <tr> <td>V - VERY</td> <td></td> <td></td> </tr> <tr> <td>VST - VANE SHEAR TEST</td> <td>WEA. - WEATHERED</td> <td>UNIT WEIGHT</td> </tr> <tr> <td></td> <td></td> <td>DRY UNIT WEIGHT</td> </tr> <tr> <td></td> <td></td> <td>SAMPLE ABBREVIATIONS</td> </tr> <tr> <td></td> <td></td> <td>S - BULK</td> </tr> <tr> <td></td> <td></td> <td>SS - SPLIT SPOON</td> </tr> <tr> <td></td> <td></td> <td>ST - SHELBY TUBE</td> </tr> <tr> <td></td> <td></td> <td>RS - ROCK</td> </tr> <tr> <td></td> <td></td> <td>RT - RECOMPACTED TRIAXIAL</td> </tr> <tr> <td></td> <td></td> <td>CBR - CALIFORNIA BEARING RATIO</td> </tr> </table>					ABBREVIATIONS			AR - AUGER REFUSAL	BT - BORING TERMINATED	CL - CLAY	CPT - COARSE PENETRATION TEST	CSE - COARSE	DMT - DILATOMETER TEST	DPT - DYNAMIC PENETRATION TEST	e - VOID RATIO	F - FINE	FOSS. - FOSSILIFEROUS	FRAC. - FRACTURED, FRACTURES	FRAGS. - FRAGMENTS	HI. - HIGHLY			MED. - MEDIUM	MICA - MICACEOUS	MOD. - MODERATELY	NP - NON PLASTIC	ORG. - ORGANIC	PMT - PRESSUREMETER TEST	SAP. - SAPROLITIC	SD. - SAND, SANDY	SL. - SILTY, SILTY	SLI. - SLIGHTLY	TCR - TRICONE REFUSAL	w - MOISTURE CONTENT	V - VERY			VST - VANE SHEAR TEST	WEA. - WEATHERED	UNIT WEIGHT			DRY UNIT WEIGHT			SAMPLE ABBREVIATIONS			S - BULK			SS - SPLIT SPOON			ST - SHELBY TUBE			RS - ROCK			RT - RECOMPACTED TRIAXIAL			CBR - CALIFORNIA BEARING RATIO	<table border="1" style="width:100%; border-collapse: collapse;"> <tr> <th colspan="3">TEXTURE OR GRAIN SIZE</th> </tr> <tr> <th>U.S. STD. SIEVE SIZE OPENING (MM)</th> <th>4</th> <th>10</th> <th>40</th> <th>60</th> <th>200</th> <th>270</th> </tr> <tr> <th></th> <td>4.76</td> <td>2.00</td> <td>0.42</td> <td>0.25</td> <td>0.075</td> <td>0.053</td> </tr> <tr> <th>BOULDER (BLDR.)</th> <th>COBBLE (COB.)</th> <th>GRAVEL (GR.)</th> <th>COARSE SAND (CS.SD.)</th> <th>FINE SAND (F.SD.)</th> <th>SILT (SL.)</th> <th>CLAY (CL.)</th> </tr> <tr> <td></td> <td></td> <td></td> <td></td> <td></td> <td></td> <td></td> </tr> <tr> <th>GRAIN SIZE</th> <th>MM</th> <th>305</th> <th>75</th> <th>2.0</th> <th>0.25</th> <th>0.05</th> </tr> <tr> <th></th> <th>IN.</th> <td>12</td> <td>3</td> <td></td> <td></td> <td>0.005</td> </tr> </table>					TEXTURE OR GRAIN SIZE			U.S. STD. SIEVE SIZE OPENING (MM)	4	10	40	60	200	270		4.76	2.00	0.42	0.25	0.075	0.053	BOULDER (BLDR.)	COBBLE (COB.)	GRAVEL (GR.)	COARSE SAND (CS.SD.)	FINE SAND (F.SD.)	SILT (SL.)	CLAY (CL.)								GRAIN SIZE	MM	305	75	2.0	0.25	0.05		IN.	12	3			0.005																			
U.S. STD. SIEVE SIZE OPENING (MM)	4	10	40	60	200	270																																																																																																																																																																																			
	4.76	2.00	0.42	0.25	0.075	0.053																																																																																																																																																																																			
BOULDER (BLDR.)	COBBLE (COB.)	GRAVEL (GR.)	COARSE SAND (CS.SD.)	FINE SAND (F.SD.)	SILT (SL.)	CLAY (CL.)																																																																																																																																																																																			
GRAIN SIZE	MM	305	75	2.0	0.25	0.05																																																																																																																																																																																			
	IN.	12	3			0.005																																																																																																																																																																																			
ABBREVIATIONS																																																																																																																																																																																									
AR - AUGER REFUSAL	BT - BORING TERMINATED	CL - CLAY																																																																																																																																																																																							
CPT - COARSE PENETRATION TEST	CSE - COARSE	DMT - DILATOMETER TEST																																																																																																																																																																																							
DPT - DYNAMIC PENETRATION TEST	e - VOID RATIO	F - FINE																																																																																																																																																																																							
FOSS. - FOSSILIFEROUS	FRAC. - FRACTURED, FRACTURES	FRAGS. - FRAGMENTS																																																																																																																																																																																							
HI. - HIGHLY																																																																																																																																																																																									
MED. - MEDIUM	MICA - MICACEOUS	MOD. - MODERATELY																																																																																																																																																																																							
NP - NON PLASTIC	ORG. - ORGANIC	PMT - PRESSUREMETER TEST																																																																																																																																																																																							
SAP. - SAPROLITIC	SD. - SAND, SANDY	SL. - SILTY, SILTY																																																																																																																																																																																							
SLI. - SLIGHTLY	TCR - TRICONE REFUSAL	w - MOISTURE CONTENT																																																																																																																																																																																							
V - VERY																																																																																																																																																																																									
VST - VANE SHEAR TEST	WEA. - WEATHERED	UNIT WEIGHT																																																																																																																																																																																							
		DRY UNIT WEIGHT																																																																																																																																																																																							
		SAMPLE ABBREVIATIONS																																																																																																																																																																																							
		S - BULK																																																																																																																																																																																							
		SS - SPLIT SPOON																																																																																																																																																																																							
		ST - SHELBY TUBE																																																																																																																																																																																							
		RS - ROCK																																																																																																																																																																																							
		RT - RECOMPACTED TRIAXIAL																																																																																																																																																																																							
		CBR - CALIFORNIA BEARING RATIO																																																																																																																																																																																							
TEXTURE OR GRAIN SIZE																																																																																																																																																																																									
U.S. STD. SIEVE SIZE OPENING (MM)	4	10	40	60	200	270																																																																																																																																																																																			
	4.76	2.00	0.42	0.25	0.075	0.053																																																																																																																																																																																			
BOULDER (BLDR.)	COBBLE (COB.)	GRAVEL (GR.)	COARSE SAND (CS.SD.)	FINE SAND (F.SD.)	SILT (SL.)	CLAY (CL.)																																																																																																																																																																																			
GRAIN SIZE	MM	305	75	2.0	0.25	0.05																																																																																																																																																																																			
	IN.	12	3			0.005																																																																																																																																																																																			
<b>SOIL MOISTURE - CORRELATION OF TERMS</b>										<b>EQUIPMENT USED ON SUBJECT PROJECT</b>					<b>FRACURE SPACING</b>																																																																																																																																																																										
<table border="1" style="width:100%; border-collapse: collapse;"> <tr> <th colspan="2">SOIL MOISTURE SCALE (ATTERBERG LIMITS)</th> <th>FIELD MOISTURE DESCRIPTION</th> <th>GUIDE FOR FIELD MOISTURE DESCRIPTION</th> </tr> <tr> <td rowspan="4">PLASTIC RANGE (PI)</td> <td>LL</td> <td>LIQUID LIMIT</td> <td>- SATURATED - (SAT.)</td> </tr> <tr> <td>PL</td> <td>PLASTIC LIMIT</td> <td>- WET - (W)</td> </tr> <tr> <td>OM</td> <td>OPTIMUM MOISTURE</td> <td>- MOIST - (M)</td> </tr> <tr> <td>SL</td> <td>SHRINKAGE LIMIT</td> <td>- DRY - (D)</td> </tr> <tr> <td></td> <td></td> <td></td> <td>USUALLY LIQUID; VERY WET, USUALLY FROM BELOW THE GROUND WATER TABLE</td> </tr> <tr> <td></td> <td></td> <td></td> <td>SEMISOLID; REQUIRES DRYING TO ATTAIN OPTIMUM MOISTURE</td> </tr> <tr> <td></td> <td></td> <td></td> <td>SOLID; AT OR NEAR OPTIMUM MOISTURE</td> </tr> <tr> <td></td> <td></td> <td></td> <td>REQUIRES ADDITIONAL WATER TO ATTAIN OPTIMUM MOISTURE</td> </tr> </table>										SOIL MOISTURE SCALE (ATTERBERG LIMITS)		FIELD MOISTURE DESCRIPTION	GUIDE FOR FIELD MOISTURE DESCRIPTION	PLASTIC RANGE (PI)	LL	LIQUID LIMIT	- SATURATED - (SAT.)	PL	PLASTIC LIMIT	- WET - (W)	OM	OPTIMUM MOISTURE	- MOIST - (M)	SL	SHRINKAGE LIMIT	- DRY - (D)				USUALLY LIQUID; VERY WET, USUALLY FROM BELOW THE GROUND WATER TABLE				SEMISOLID; REQUIRES DRYING TO ATTAIN OPTIMUM MOISTURE				SOLID; AT OR NEAR OPTIMUM MOISTURE				REQUIRES ADDITIONAL WATER TO ATTAIN OPTIMUM MOISTURE	<table border="1" style="width:100%; border-collapse: collapse;"> <tr> <th colspan="2">EQUIPMENT USED ON SUBJECT PROJECT</th> </tr> <tr> <td>DRILL UNITS:</td> <td>ADVANCING TOOLS:</td> </tr> <tr> <td><input type="checkbox"/> CME-45C</td> <td><input type="checkbox"/> CLAY BITS</td> </tr> <tr> <td><input type="checkbox"/> CME-55</td> <td><input type="checkbox"/> 6" CONTINUOUS FLIGHT AUGER</td> </tr> <tr> <td><input checked="" type="checkbox"/> CME-550</td> <td><input checked="" type="checkbox"/> 8" HOLLOW AUGERS</td> </tr> <tr> <td><input type="checkbox"/> VANE SHEAR TEST</td> <td><input type="checkbox"/> HARD FACED FINGER BITS</td> </tr> <tr> <td><input type="checkbox"/> PORTABLE HOIST</td> <td><input type="checkbox"/> TUNG-CARBIDE INSERTS</td> </tr> <tr> <td></td> <td><input type="checkbox"/> CASING <input type="checkbox"/> W/ ADVANCER</td> </tr> <tr> <td></td> <td><input type="checkbox"/> TRICONE <input type="checkbox"/> *STEEL TEETH</td> </tr> <tr> <td></td> <td><input type="checkbox"/> TRICONE <input type="checkbox"/> *TUNG-CARB.</td> </tr> <tr> <td></td> <td><input type="checkbox"/> CORE BIT</td> </tr> <tr> <td></td> <td></td> </tr> </table>					EQUIPMENT USED ON SUBJECT PROJECT		DRILL UNITS:	ADVANCING TOOLS:	<input type="checkbox"/> CME-45C	<input type="checkbox"/> CLAY BITS	<input type="checkbox"/> CME-55	<input type="checkbox"/> 6" CONTINUOUS FLIGHT AUGER	<input checked="" type="checkbox"/> CME-550	<input checked="" type="checkbox"/> 8" HOLLOW AUGERS	<input type="checkbox"/> VANE SHEAR TEST	<input type="checkbox"/> HARD FACED FINGER BITS	<input type="checkbox"/> PORTABLE HOIST	<input type="checkbox"/> TUNG-CARBIDE INSERTS		<input type="checkbox"/> CASING <input type="checkbox"/> W/ ADVANCER		<input type="checkbox"/> TRICONE <input type="checkbox"/> *STEEL TEETH		<input type="checkbox"/> TRICONE <input type="checkbox"/> *TUNG-CARB.		<input type="checkbox"/> CORE BIT			<table border="1" style="width:100%; border-collapse: collapse;"> <tr> <th colspan="2">FRACURE SPACING</th> </tr> <tr> <th>TERM</th> <th>SPACING</th> </tr> <tr> <td>VERY WIDE</td> <td>MORE THAN 10 FEET</td> </tr> <tr> <td>WIDE</td> <td>3 TO 10 FEET</td> </tr> <tr> <td>MODERATELY CLOSE</td> <td>1 TO 3 FEET</td> </tr> <tr> <td>CLOSE</td> <td>0.16 TO 1 FOOT</td> </tr> <tr> <td>VERY CLOSE</td> <td>LESS THAN 0.16 FEET</td> </tr> </table>					FRACURE SPACING		TERM	SPACING	VERY WIDE	MORE THAN 10 FEET	WIDE	3 TO 10 FEET	MODERATELY CLOSE	1 TO 3 FEET	CLOSE	0.16 TO 1 FOOT	VERY CLOSE	LESS THAN 0.16 FEET																																																																																															
SOIL MOISTURE SCALE (ATTERBERG LIMITS)		FIELD MOISTURE DESCRIPTION	GUIDE FOR FIELD MOISTURE DESCRIPTION																																																																																																																																																																																						
PLASTIC RANGE (PI)	LL	LIQUID LIMIT	- SATURATED - (SAT.)																																																																																																																																																																																						
	PL	PLASTIC LIMIT	- WET - (W)																																																																																																																																																																																						
	OM	OPTIMUM MOISTURE	- MOIST - (M)																																																																																																																																																																																						
	SL	SHRINKAGE LIMIT	- DRY - (D)																																																																																																																																																																																						
			USUALLY LIQUID; VERY WET, USUALLY FROM BELOW THE GROUND WATER TABLE																																																																																																																																																																																						
			SEMISOLID; REQUIRES DRYING TO ATTAIN OPTIMUM MOISTURE																																																																																																																																																																																						
			SOLID; AT OR NEAR OPTIMUM MOISTURE																																																																																																																																																																																						
			REQUIRES ADDITIONAL WATER TO ATTAIN OPTIMUM MOISTURE																																																																																																																																																																																						
EQUIPMENT USED ON SUBJECT PROJECT																																																																																																																																																																																									
DRILL UNITS:	ADVANCING TOOLS:																																																																																																																																																																																								
<input type="checkbox"/> CME-45C	<input type="checkbox"/> CLAY BITS																																																																																																																																																																																								
<input type="checkbox"/> CME-55	<input type="checkbox"/> 6" CONTINUOUS FLIGHT AUGER																																																																																																																																																																																								
<input checked="" type="checkbox"/> CME-550	<input checked="" type="checkbox"/> 8" HOLLOW AUGERS																																																																																																																																																																																								
<input type="checkbox"/> VANE SHEAR TEST	<input type="checkbox"/> HARD FACED FINGER BITS																																																																																																																																																																																								
<input type="checkbox"/> PORTABLE HOIST	<input type="checkbox"/> TUNG-CARBIDE INSERTS																																																																																																																																																																																								
	<input type="checkbox"/> CASING <input type="checkbox"/> W/ ADVANCER																																																																																																																																																																																								
	<input type="checkbox"/> TRICONE <input type="checkbox"/> *STEEL TEETH																																																																																																																																																																																								
	<input type="checkbox"/> TRICONE <input type="checkbox"/> *TUNG-CARB.																																																																																																																																																																																								
	<input type="checkbox"/> CORE BIT																																																																																																																																																																																								
FRACURE SPACING																																																																																																																																																																																									
TERM	SPACING																																																																																																																																																																																								
VERY WIDE	MORE THAN 10 FEET																																																																																																																																																																																								
WIDE	3 TO 10 FEET																																																																																																																																																																																								
MODERATELY CLOSE	1 TO 3 FEET																																																																																																																																																																																								
CLOSE	0.16 TO 1 FOOT																																																																																																																																																																																								
VERY CLOSE	LESS THAN 0.16 FEET																																																																																																																																																																																								
<b>PLASTICITY</b>										<b>INDURATION</b>					<b>BEDDING</b>																																																																																																																																																																										
<table border="1" style="width:100%; border-collapse: collapse;"> <tr> <th colspan="2">PLASTICITY</th> </tr> <tr> <th>NON PLASTIC</th> <th>SLIGHTLY PLASTIC</th> </tr> <tr> <th>MODERATELY PLASTIC</th> <th>HIGHLY PLASTIC</th> </tr> <tr> <td>0-5</td> <td>6-15</td> </tr> <tr> <td>16-25</td> <td>26 OR MORE</td> </tr> <tr> <td>VERY LOW</td> <td>SLIGHT</td> </tr> <tr> <td>MEDIUM</td> <td>HIGH</td> </tr> </table>										PLASTICITY		NON PLASTIC	SLIGHTLY PLASTIC	MODERATELY PLASTIC	HIGHLY PLASTIC	0-5	6-15	16-25	26 OR MORE	VERY LOW	SLIGHT	MEDIUM	HIGH	<table border="1" style="width:100%; border-collapse: collapse;"> <tr> <th colspan="2">INDURATION</th> </tr> <tr> <th>TERM</th> <th>THICKNESS</th> </tr> <tr> <td>FRIABLE</td> <td>4 FEET</td> </tr> <tr> <td>MODERATELY INDURATED</td> <td>1.5 - 4 FEET</td> </tr> <tr> <td>INDURATED</td> <td>0.16 - 1.5 FEET</td> </tr> <tr> <td>EXTREMELY INDURATED</td> <td>0.03 - 0.16 FEET</td> </tr> <tr> <td></td> <td>0.008 - 0.03 FEET</td> </tr> <tr> <td></td> <td>&lt; 0.008 FEET</td> </tr> </table>					INDURATION		TERM	THICKNESS	FRIABLE	4 FEET	MODERATELY INDURATED	1.5 - 4 FEET	INDURATED	0.16 - 1.5 FEET	EXTREMELY INDURATED	0.03 - 0.16 FEET		0.008 - 0.03 FEET		< 0.008 FEET	<table border="1" style="width:100%; border-collapse: collapse;"> <tr> <th colspan="2">BEDDING</th> </tr> <tr> <th>TERM</th> <th>THICKNESS</th> </tr> <tr> <td>VERY THICKLY BEDDED</td> <td>4 FEET</td> </tr> <tr> <td>THICKLY BEDDED</td> <td>1.5 - 4 FEET</td> </tr> <tr> <td>THINLY BEDDED</td> <td>0.16 - 1.5 FEET</td> </tr> <tr> <td>VERY THINLY BEDDED</td> <td>0.03 - 0.16 FEET</td> </tr> <tr> <td>THICKLY LAMINATED</td> <td>0.008 - 0.03 FEET</td> </tr> <tr> <td>THINLY LAMINATED</td> <td>&lt; 0.008 FEET</td> </tr> </table>					BEDDING		TERM	THICKNESS	VERY THICKLY BEDDED	4 FEET	THICKLY BEDDED	1.5 - 4 FEET	THINLY BEDDED	0.16 - 1.5 FEET	VERY THINLY BEDDED	0.03 - 0.16 FEET	THICKLY LAMINATED	0.008 - 0.03 FEET	THINLY LAMINATED	< 0.008 FEET																																																																																																																								
PLASTICITY																																																																																																																																																																																									
NON PLASTIC	SLIGHTLY PLASTIC																																																																																																																																																																																								
MODERATELY PLASTIC	HIGHLY PLASTIC																																																																																																																																																																																								
0-5	6-15																																																																																																																																																																																								
16-25	26 OR MORE																																																																																																																																																																																								
VERY LOW	SLIGHT																																																																																																																																																																																								
MEDIUM	HIGH																																																																																																																																																																																								
INDURATION																																																																																																																																																																																									
TERM	THICKNESS																																																																																																																																																																																								
FRIABLE	4 FEET																																																																																																																																																																																								
MODERATELY INDURATED	1.5 - 4 FEET																																																																																																																																																																																								
INDURATED	0.16 - 1.5 FEET																																																																																																																																																																																								
EXTREMELY INDURATED	0.03 - 0.16 FEET																																																																																																																																																																																								
	0.008 - 0.03 FEET																																																																																																																																																																																								
	< 0.008 FEET																																																																																																																																																																																								
BEDDING																																																																																																																																																																																									
TERM	THICKNESS																																																																																																																																																																																								
VERY THICKLY BEDDED	4 FEET																																																																																																																																																																																								
THICKLY BEDDED	1.5 - 4 FEET																																																																																																																																																																																								
THINLY BEDDED	0.16 - 1.5 FEET																																																																																																																																																																																								
VERY THINLY BEDDED	0.03 - 0.16 FEET																																																																																																																																																																																								
THICKLY LAMINATED	0.008 - 0.03 FEET																																																																																																																																																																																								
THINLY LAMINATED	< 0.008 FEET																																																																																																																																																																																								
<b>COLOR</b>										<b>FRACURE SPACING</b>					<b>INDURATION</b>																																																																																																																																																																										
<p>DESCRIPTIONS MAY INCLUDE COLOR OR COLOR COMBINATIONS (TAN, RED, YELLOW-BROWN, BLUE-GRAY). MODIFIERS SUCH AS LIGHT, DARK, STREAKED, ETC. ARE USED TO DESCRIBE APPEARANCE.</p>										<table border="1" style="width:100%; border-collapse: collapse;"> <tr> <th colspan="2">FRACURE SPACING</th> </tr> <tr> <th>TERM</th> <th>SPACING</th> </tr> <tr> <td>VERY WIDE</td> <td>MORE THAN 10 FEET</td> </tr> <tr> <td>WIDE</td> <td>3 TO 10 FEET</td> </tr> <tr> <td>MODERATELY CLOSE</td> <td>1 TO 3 FEET</td> </tr> <tr> <td>CLOSE</td> <td>0.16 TO 1 FOOT</td> </tr> <tr> <td>VERY CLOSE</td> <td>LESS THAN 0.16 FEET</td> </tr> </table>					FRACURE SPACING		TERM	SPACING	VERY WIDE	MORE THAN 10 FEET	WIDE	3 TO 10 FEET	MODERATELY CLOSE	1 TO 3 FEET	CLOSE	0.16 TO 1 FOOT	VERY CLOSE	LESS THAN 0.16 FEET	<table border="1" style="width:100%; border-collapse: collapse;"> <tr> <th colspan="2">INDURATION</th> </tr> <tr> <th>TERM</th> <th>THICKNESS</th> </tr> <tr> <td>FRIABLE</td> <td>4 FEET</td> </tr> <tr> <td>MODERATELY INDURATED</td> <td>1.5 - 4 FEET</td> </tr> <tr> <td>INDURATED</td> <td>0.16 - 1.5 FEET</td> </tr> <tr> <td>EXTREMELY INDURATED</td> <td>0.03 - 0.16 FEET</td> </tr> <tr> <td></td> <td>0.008 - 0.03 FEET</td> </tr> <tr> <td></td> <td>&lt; 0.008 FEET</td> </tr> </table>					INDURATION		TERM	THICKNESS	FRIABLE	4 FEET	MODERATELY INDURATED	1.5 - 4 FEET	INDURATED	0.16 - 1.5 FEET	EXTREMELY INDURATED	0.03 - 0.16 FEET		0.008 - 0.03 FEET		< 0.008 FEET																																																																																																																																								
FRACURE SPACING																																																																																																																																																																																									
TERM	SPACING																																																																																																																																																																																								
VERY WIDE	MORE THAN 10 FEET																																																																																																																																																																																								
WIDE	3 TO 10 FEET																																																																																																																																																																																								
MODERATELY CLOSE	1 TO 3 FEET																																																																																																																																																																																								
CLOSE	0.16 TO 1 FOOT																																																																																																																																																																																								
VERY CLOSE	LESS THAN 0.16 FEET																																																																																																																																																																																								
INDURATION																																																																																																																																																																																									
TERM	THICKNESS																																																																																																																																																																																								
FRIABLE	4 FEET																																																																																																																																																																																								
MODERATELY INDURATED	1.5 - 4 FEET																																																																																																																																																																																								
INDURATED	0.16 - 1.5 FEET																																																																																																																																																																																								
EXTREMELY INDURATED	0.03 - 0.16 FEET																																																																																																																																																																																								
	0.008 - 0.03 FEET																																																																																																																																																																																								
	< 0.008 FEET																																																																																																																																																																																								
<b>NOTES:</b>										<b>FRACURE SPACING</b>					<b>INDURATION</b>																																																																																																																																																																										
<p>ROADWAY DESIGN FILES, .TIN, AND GPK FILE PROVIDED BY NCDOT</p> <p>NORTHING AND EASTING OBTAINED USING A TRIMBLE GEO7X.</p> <p>ELEVATIONS OBTAINED USING PROVIDED SURVEY INFORMATION.</p> <p>FIAD= FILLED IN AFTER DRILLING</p>										<table border="1" style="width:100%; border-collapse: collapse;"> <tr> <td colspan="2">ELEVATION: N/A FEET</td> </tr> </table>					ELEVATION: N/A FEET		<table border="1" style="width:100%; border-collapse: collapse;"> <tr> <td colspan="2">ELEVATION: N/A FEET</td> </tr> </table>					ELEVATION: N/A FEET																																																																																																																																																																			
ELEVATION: N/A FEET																																																																																																																																																																																									
ELEVATION: N/A FEET																																																																																																																																																																																									
<b>NOTES:</b>										<b>FRACURE SPACING</b>					<b>INDURATION</b>																																																																																																																																																																										
<p>ROADWAY DESIGN FILES, .TIN, AND GPK FILE PROVIDED BY NCDOT</p> <p>NORTHING AND EASTING OBTAINED USING A TRIMBLE GEO7X.</p> <p>ELEVATIONS OBTAINED USING PROVIDED SURVEY INFORMATION.</p> <p>FIAD= FILLED IN AFTER DRILLING</p>										<table border="1" style="width:100%; border-collapse: collapse;"> <tr> <td colspan="2">ELEVATION: N/A FEET</td> </tr> </table>					ELEVATION: N/A FEET		<table border="1" style="width:100%; border-collapse: collapse;"> <tr> <td colspan="2">ELEVATION: N/A FEET</td> </tr> </table>					ELEVATION: N/A FEET																																																																																																																																																																			
ELEVATION: N/A FEET																																																																																																																																																																																									
ELEVATION: N/A FEET																																																																																																																																																																																									

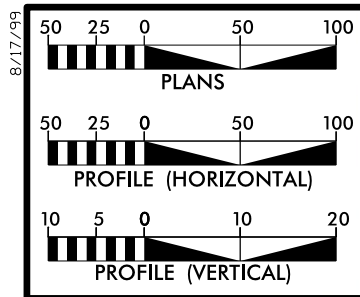

# PLAN AND PROFILE OF NOISE WALL 15/16

PROJECT REFERENCE NO. <b>U-2579AB</b>	SHEET NO. <b>3</b>
R/W SHEET NO.	
ROADWAY DESIGN ENGINEER	HYDRAULICS ENGINEER
<b>INCOMPLETE PLANS</b> DO NOT USE FOR R/W ACQUISITION	
<b>DOCUMENT NOT CONSIDERED FINAL</b> UNLESS ALL SIGNATURES COMPLETED	

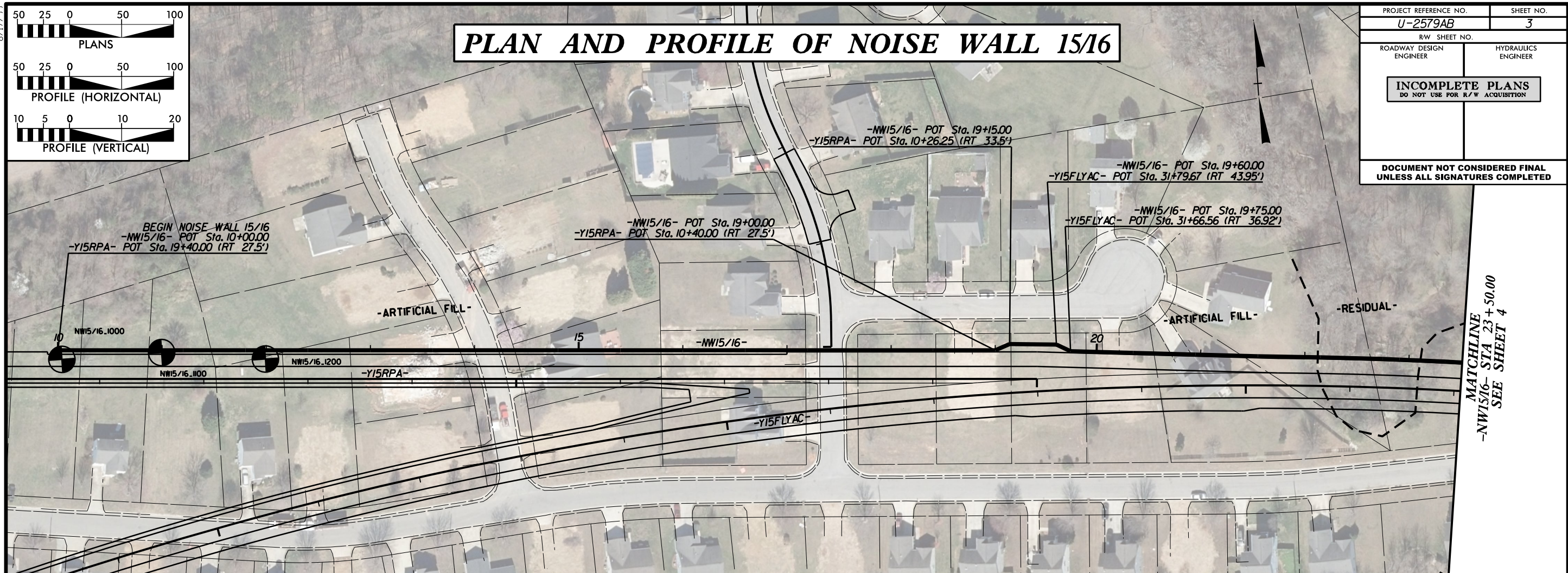

MATCHLINE  
-NW15/16- STA 23+50.00  
SEE SHEET 4

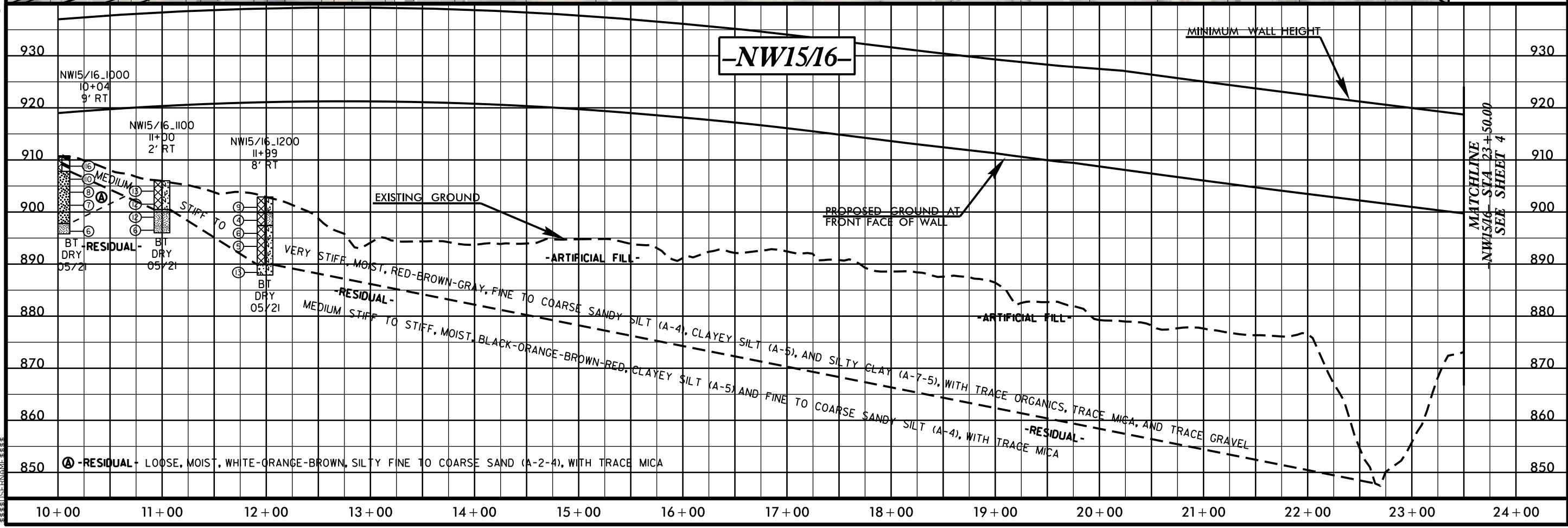

MATCHLINE  
-NW15/16- STA 23+50.00  
SEE SHEET 4

8/17/99  
08-11-2021 13:10  
S:\PHOTO\2000-29499\09-29433 U-2579AB SWAL (37946)\CADD\GEOTECH\Plan\Prof\U2579AB\_NW15\_16\_psh01.dgn

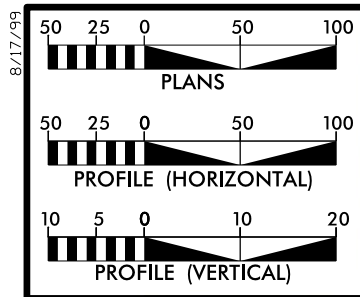

# PLAN AND PROFILE OF NOISE WALL 1/13

PROJECT REFERENCE NO. <b>U-2579AB</b>	SHEET NO. <b>4</b>
RW SHEET NO.	
ROADWAY DESIGN ENGINEER	HYDRAULICS ENGINEER
<b>INCOMPLETE PLANS</b> DO NOT USE FOR R/W ACQUISITION	
<b>DOCUMENT NOT CONSIDERED FINAL</b> UNLESS ALL SIGNATURES COMPLETED	

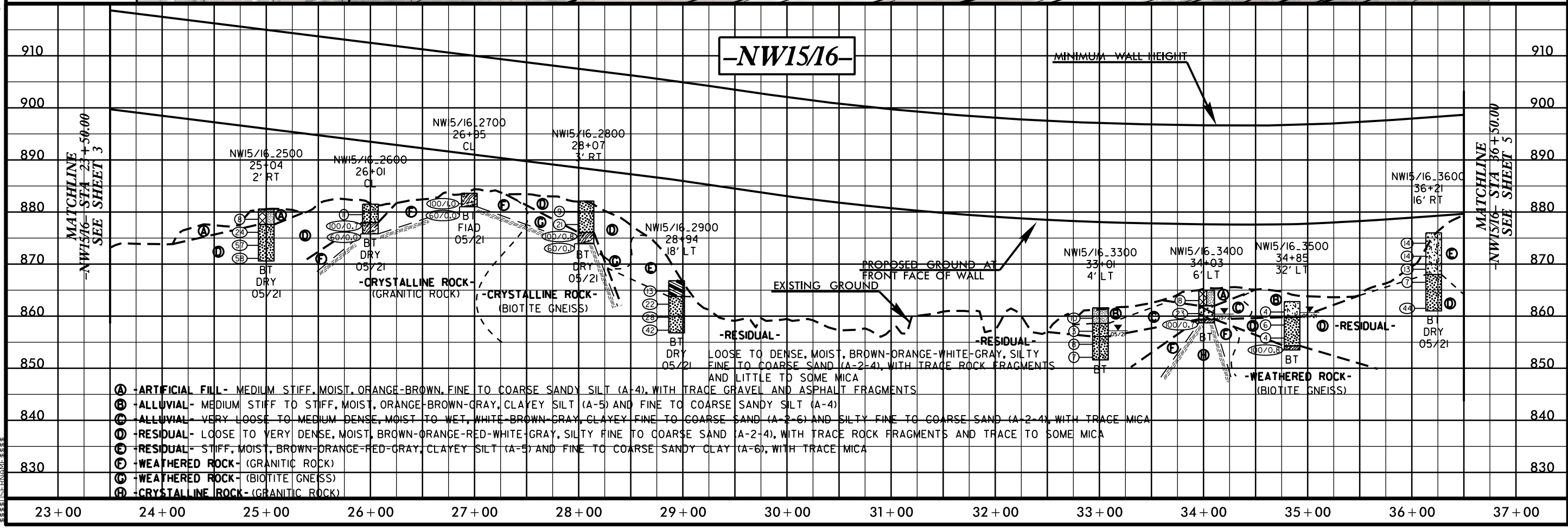
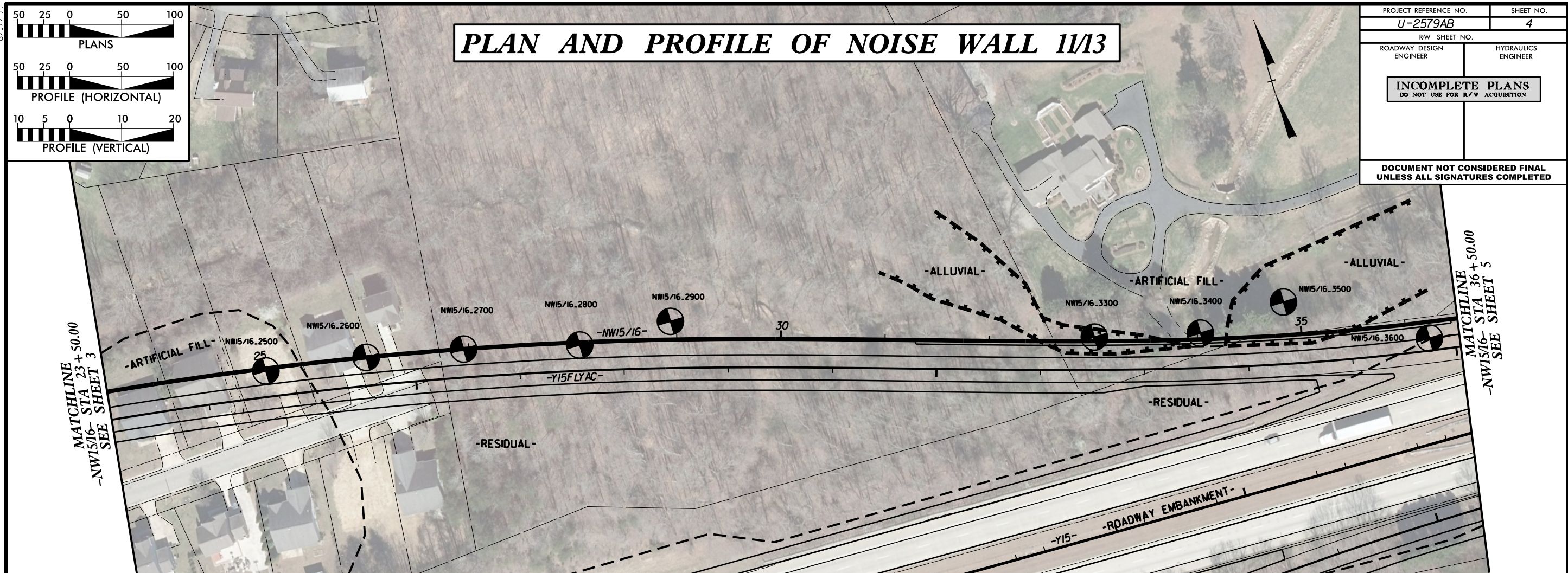

- Ⓐ -ARTIFICIAL FILL- MEDIUM STIFF, MOIST, ORANGE-BROWN, FINE TO COARSE SANDY SILT (A-4), WITH TRACE GRAVEL AND ASPHALT FRAGMENTS
- Ⓑ -ALLUVIAL- MEDIUM STIFF TO STIFF, MOIST, ORANGE-BROWN-GRAY, CLAYEY SILT (A-5) AND FINE TO COARSE SANDY SILT (A-4)
- Ⓒ -ALLUVIAL- VERY LOOSE TO MEDIUM DENSE, MOIST TO WET, WHITE-BROWN-GRAY, CLAYEY FINE TO COARSE SAND (A-2-6) AND SILTY FINE TO COARSE SAND (A-2-4), WITH TRACE MICA
- Ⓓ -RESIDUAL- LOOSE TO VERY DENSE, MOIST, BROWN-ORANGE-RED-WHITE-GRAY, SILTY FINE TO COARSE SAND (A-2-4), WITH TRACE ROCK FRAGMENTS AND TRACE TO SOME MICA
- Ⓔ -RESIDUAL- STIFF, MOIST, BROWN-ORANGE-RED-GRAY, CLAYEY SILT (A-5) AND FINE TO COARSE SANDY CLAY (A-6), WITH TRACE MICA
- Ⓜ -WEATHERED ROCK- (GRANITIC ROCK)
- Ⓝ -WEATHERED ROCK- (BIOTITE GNEISS)
- Ⓢ -CRYSTALLINE ROCK- (GRANITIC ROCK)

08-10-2021 15:20:00 29499109-29433 U-2579AB SWAL (37946)\CADD\GEOTECH\Plan\Prof\U2579AB\_NW15\_16\_psf02.dgn  
 8/17/99

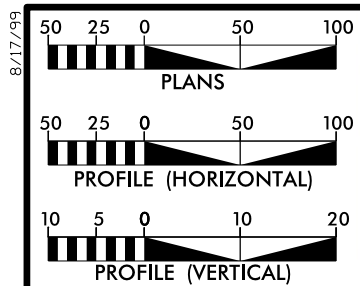

# PLAN AND PROFILE OF NOISE WALL 15/16

PROJECT REFERENCE NO. <b>U-2579AB</b>	SHEET NO. <b>5</b>
RW SHEET NO.	
ROADWAY DESIGN ENGINEER	HYDRAULICS ENGINEER
<b>INCOMPLETE PLANS</b> DO NOT USE FOR R/W ACQUISITION	
<b>DOCUMENT NOT CONSIDERED FINAL</b> UNLESS ALL SIGNATURES COMPLETED	

MATCHLINE -NW15/16- STA 36+50.00 SEE SHEET 4

MATCHLINE -NW15/16- STA 49+45.00 SEE SHEET 6

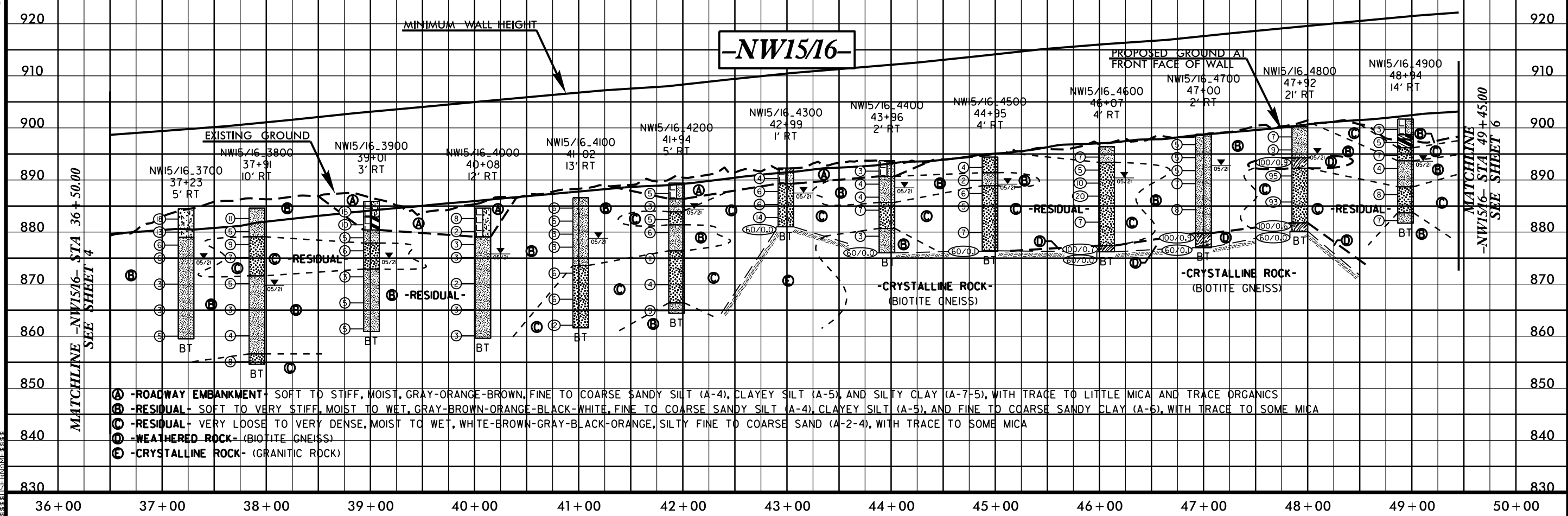
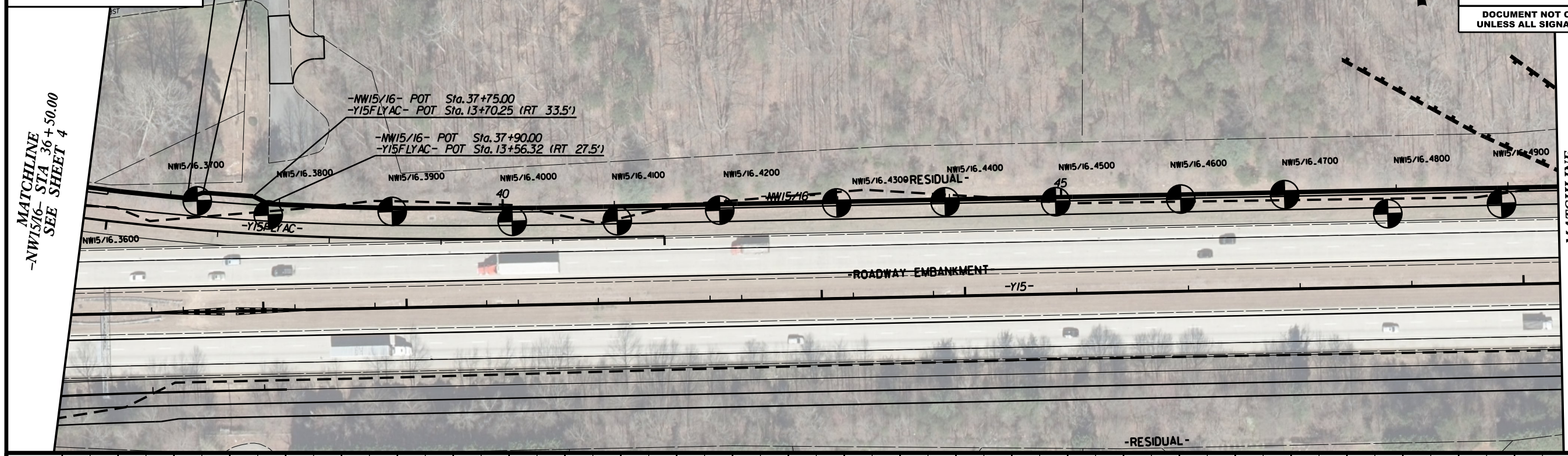

08-11-2021 13:12 U:\PROJECTS\20000-29499\09-29433 U-2579AB SWAL (37946)\CADD\GEOTECH\Plan\Prof\U2579AB\_NW15\_16.psf03.dgn

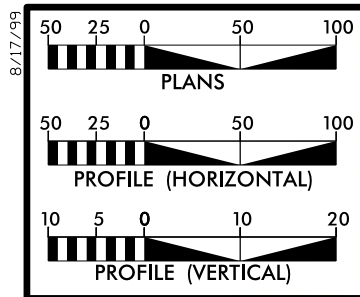

# PLAN AND PROFILE OF NOISE WALL 15/16

PROJECT REFERENCE NO. <b>U-2579AB</b>	SHEET NO. <b>6</b>
RW SHEET NO.	
ROADWAY DESIGN ENGINEER	HYDRAULICS ENGINEER
<b>INCOMPLETE PLANS</b> DO NOT USE FOR R/W ACQUISITION	
<b>DOCUMENT NOT CONSIDERED FINAL</b> UNLESS ALL SIGNATURES COMPLETED	

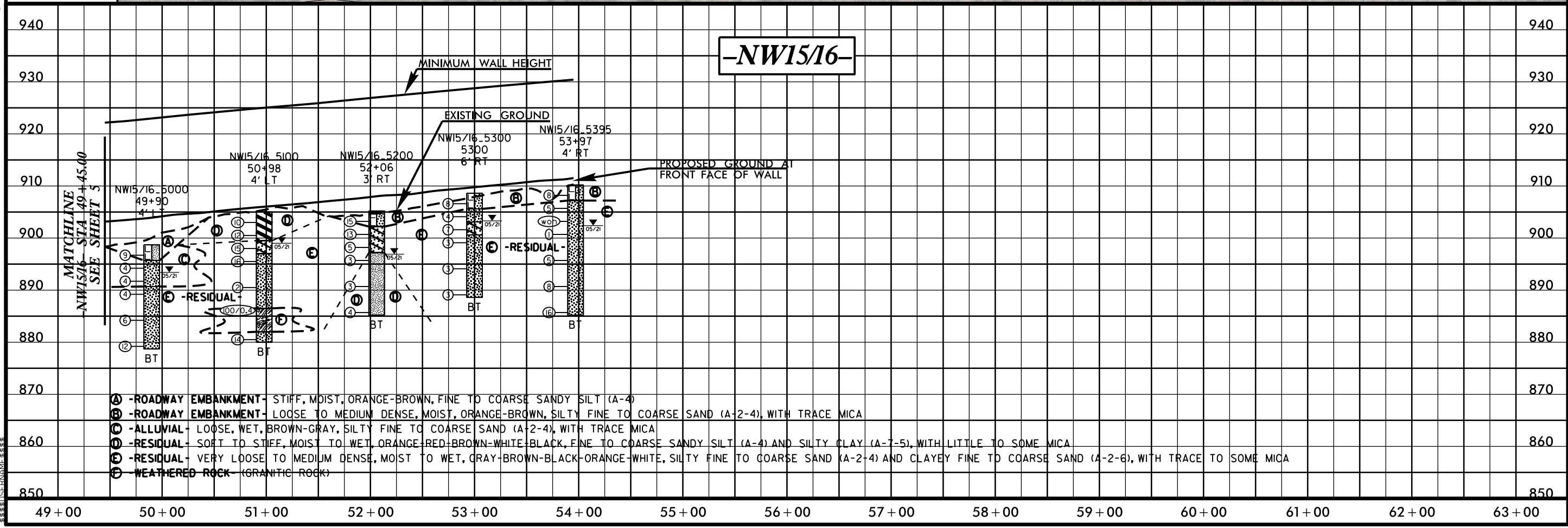
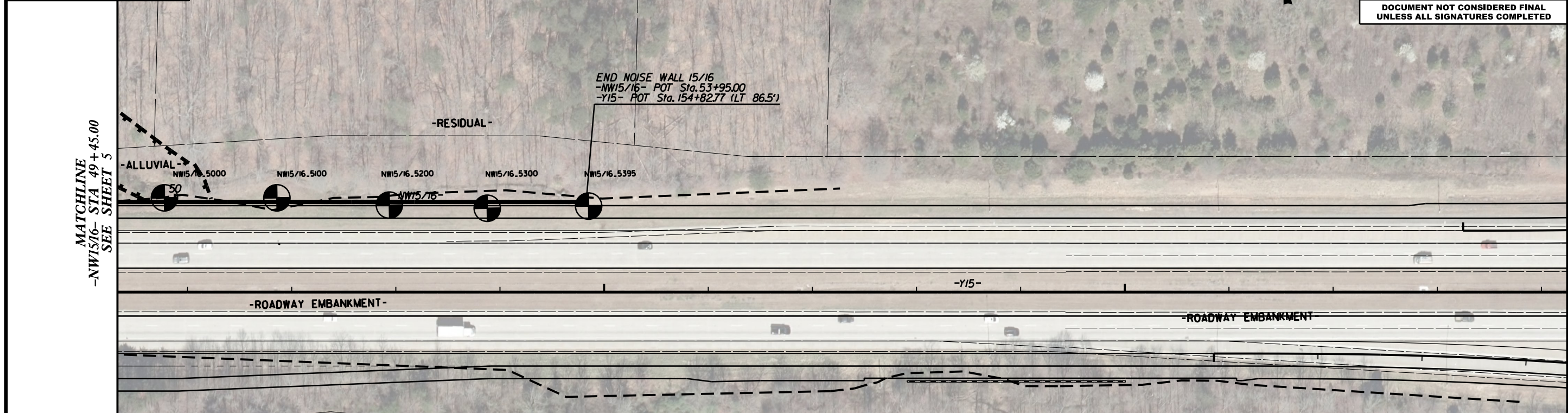

08-11-2021 13:12  
 W:\PHOTO\1520000-29499\09-29433 U-2579AB SWAL (37946)\CADD\GEOTECH\Plan\Prof\U2579AB\_NW15\_16\_psf04.dgn