

**PLAN OF WING W1**

THE STRAIGHT ENDS OF #5 H2 BARS CAN BE TRIMMED AS NECESSARY TO AVOID CONFLICT WITH PILE IN CAP. HOOKED ENDS SHALL NOT BE CUT.

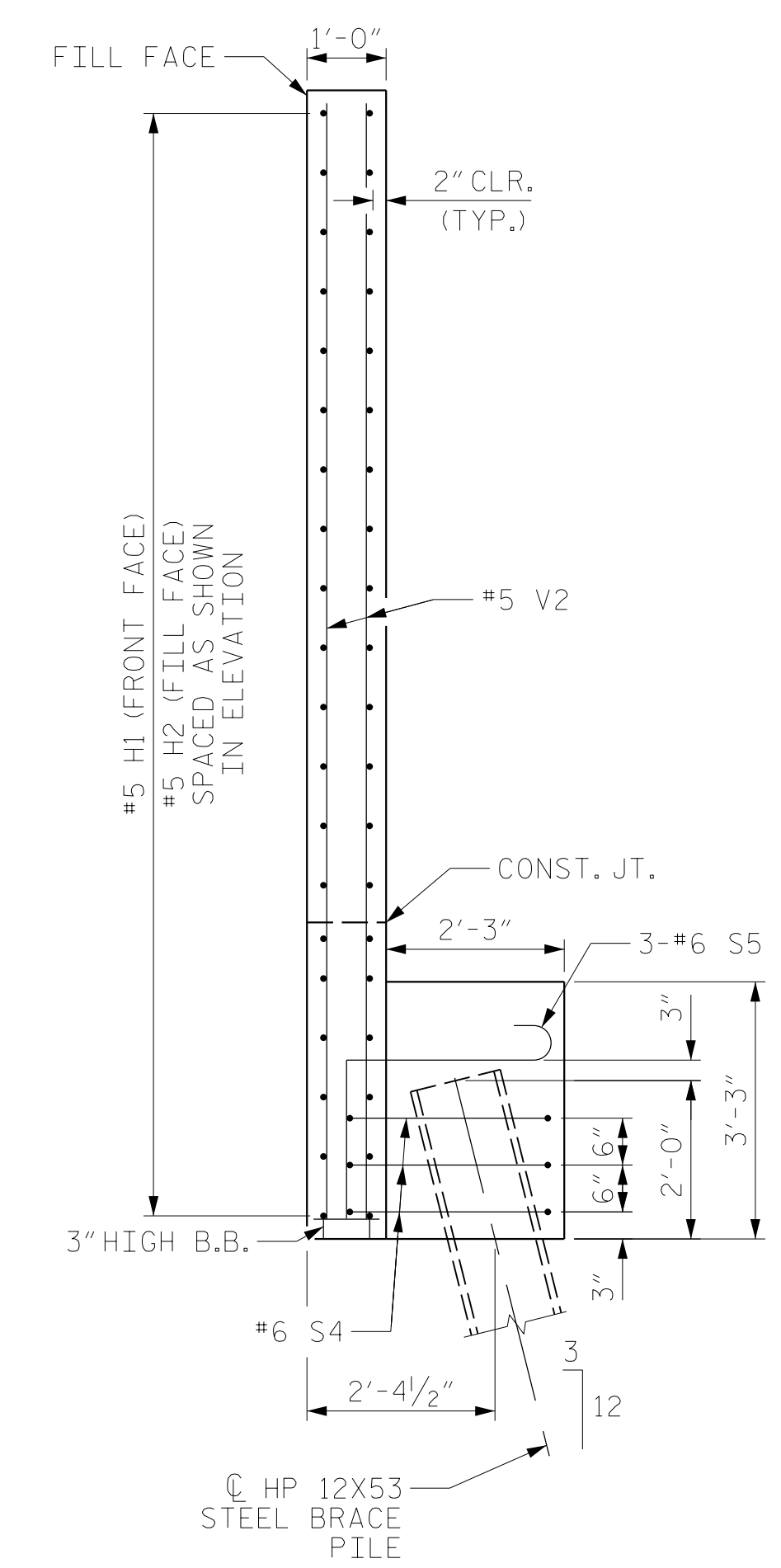

**SECTION X-X**

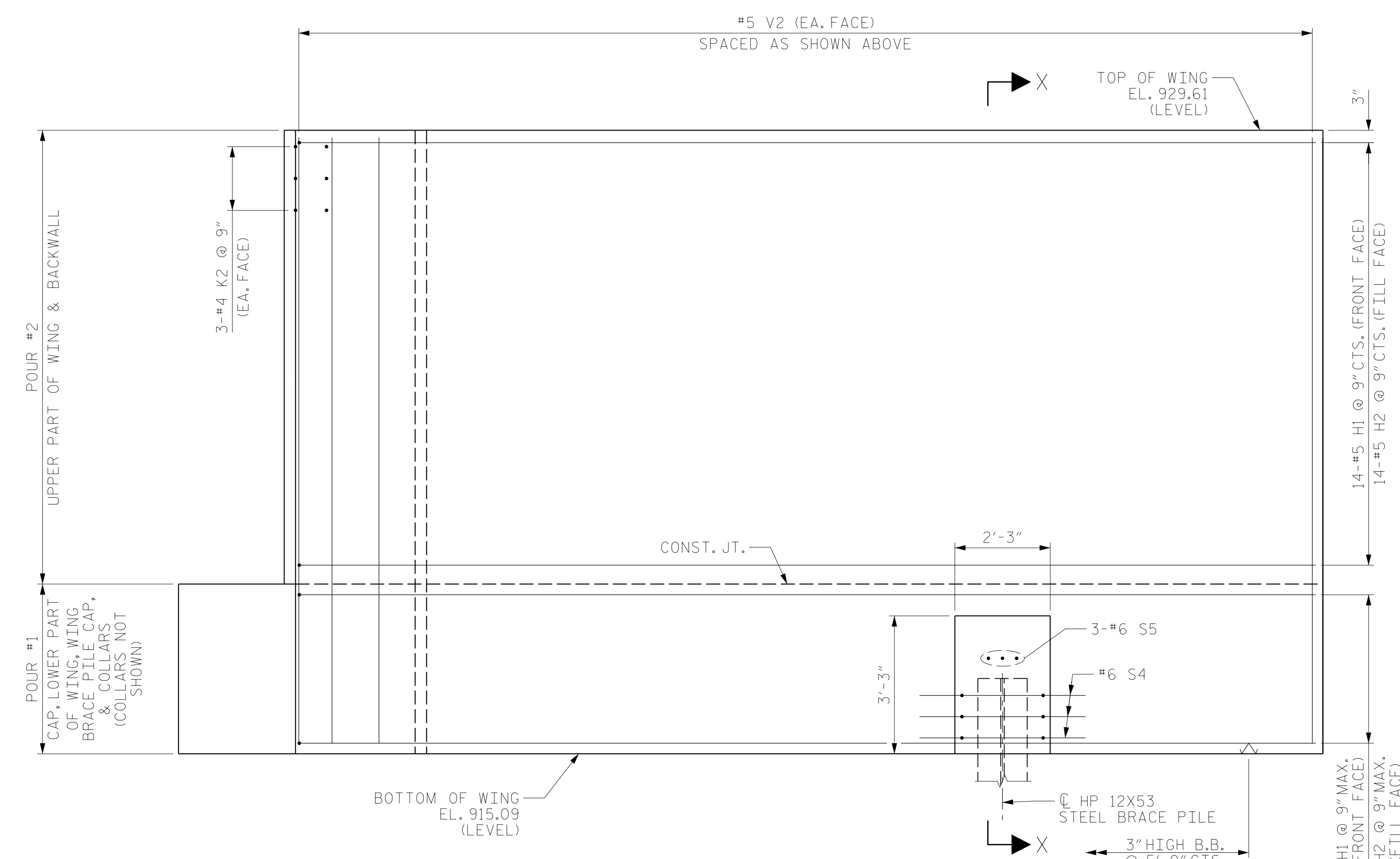

**ELEVATION OF WING W1**

PROJECT NO. U-2579AB  
FORSYTH COUNTY  
 STATION: 23+43.03 -Y16-

SHEET 3 OF 5



STATE OF NORTH CAROLINA  
 DEPARTMENT OF TRANSPORTATION  
 RALEIGH  
 SUBSTRUCTURE  
 END BENT 1  
 WING W1

DRAWN BY : TRM DATE : 08/2019  
 CHECKED BY : MAL DATE : 12/2019  
 DESIGN ENGINEER OF RECORD: JMR DATE : 12/2019

DOCUMENT NOT CONSIDERED  
 FINAL UNLESS ALL  
 SIGNATURES COMPLETED

REVISIONS						SHEET NO.
NO.	BY:	DATE:	NO.	BY:	DATE:	S7-35
1			3			TOTAL SHEETS
2			4			48