

PLOT DRIVER: NCDOT.pdf_color_eng-50dpi
 USER: PPETERSO DATE: 10/14/2021
 FILE: ...SUBSTR

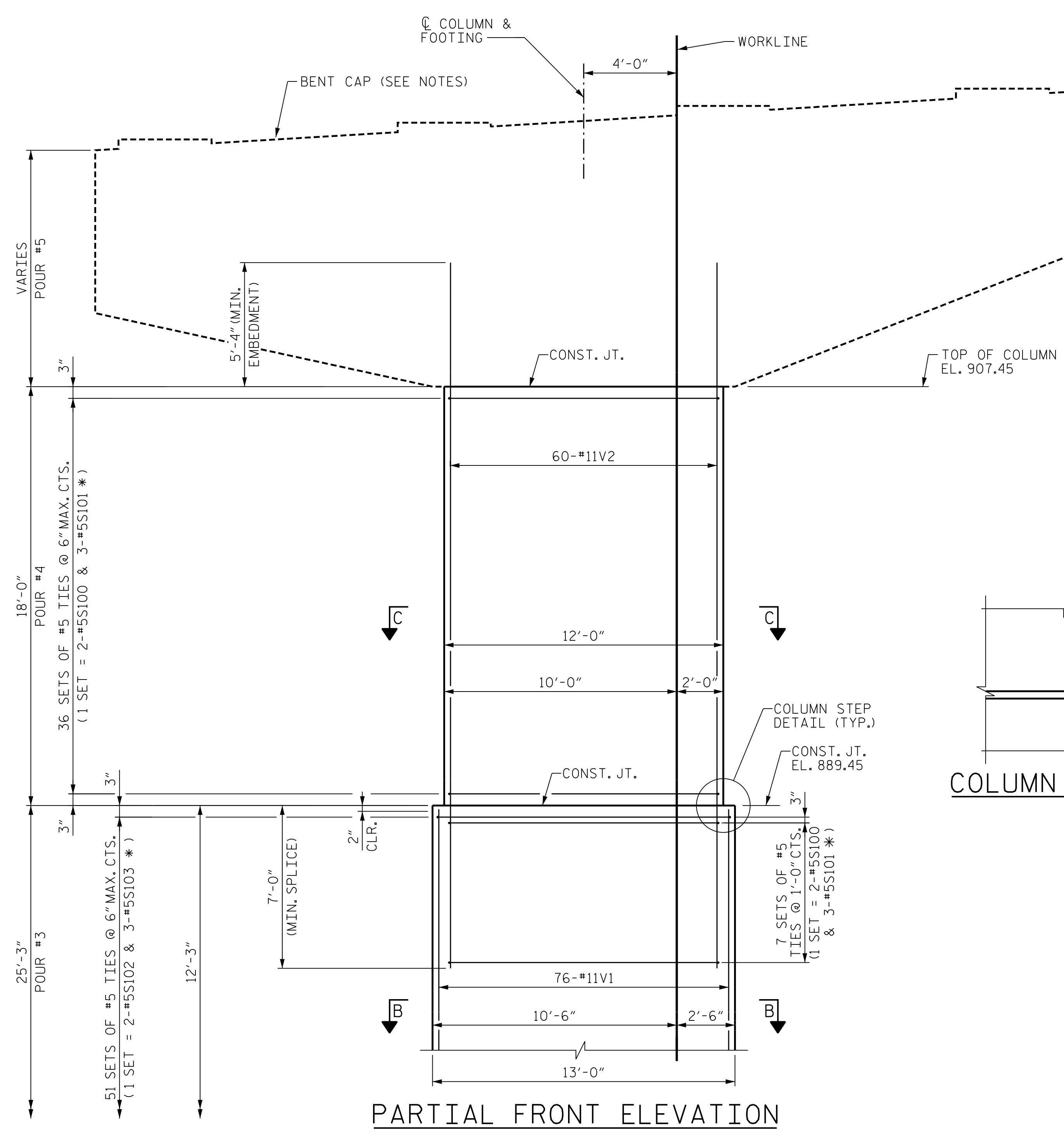

PARTIAL FRONT ELEVATION

* INVERT ORIENTATION OF ALTERNATE #5S101 AND #5S103 TIES

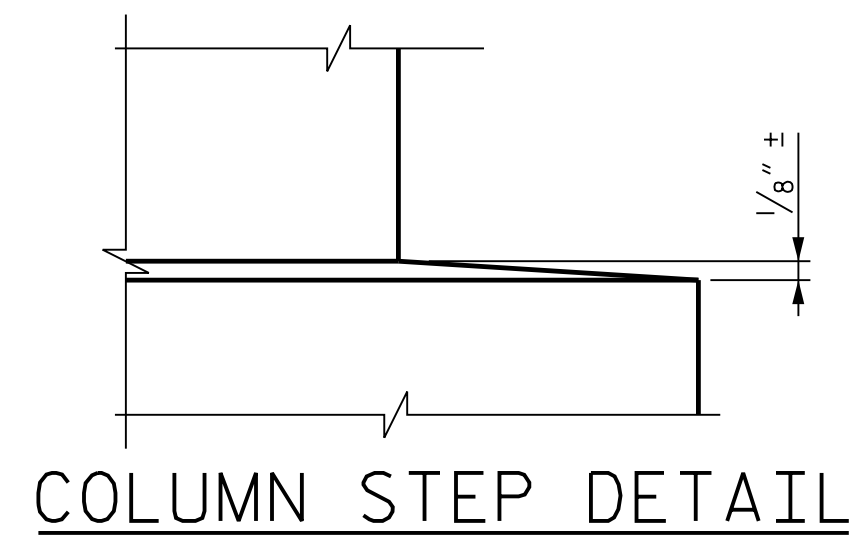

COLUMN STEP DETAIL

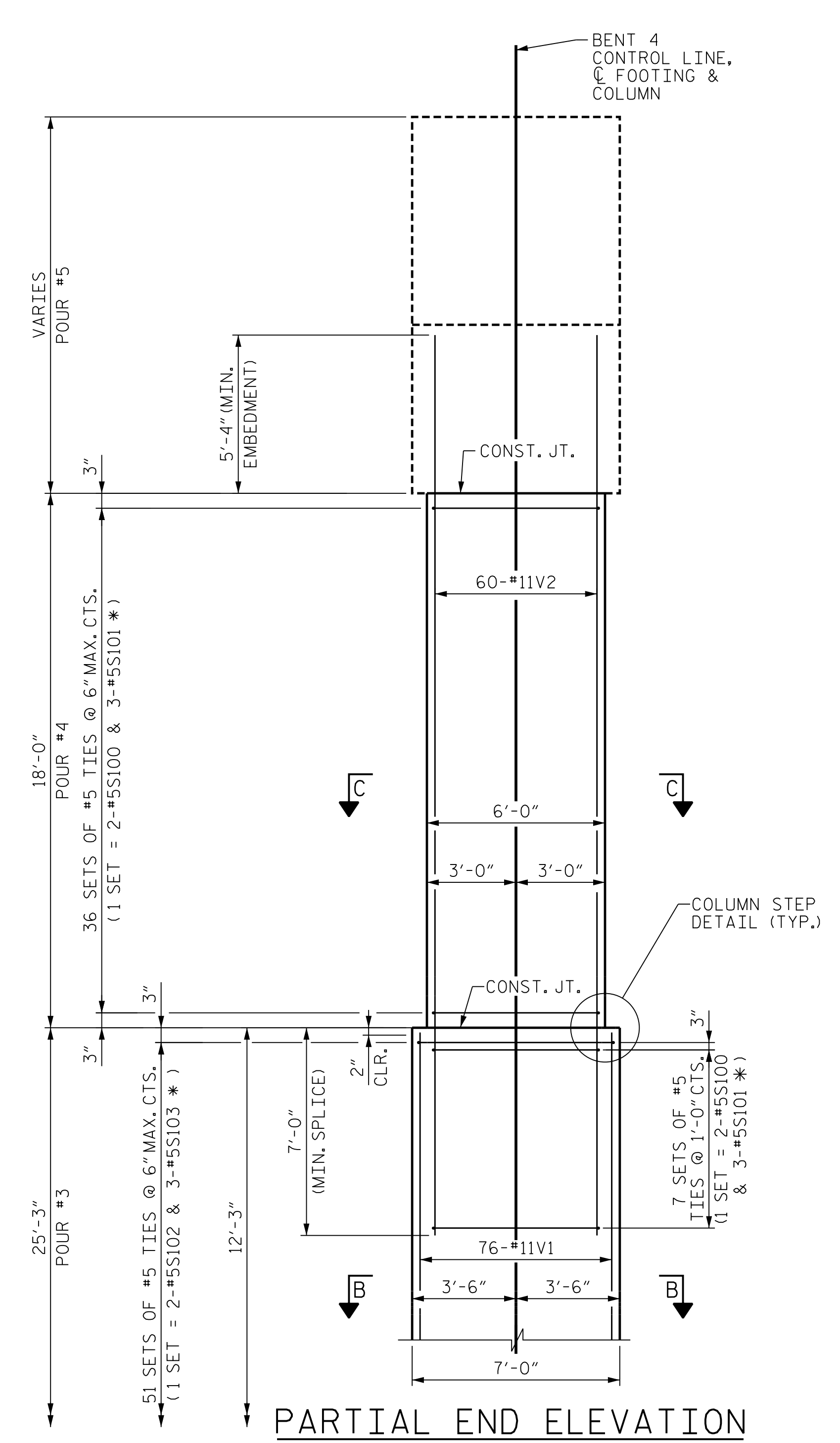

PARTIAL END ELEVATION

CONTINUATION OF NOTES FROM SHEET 1 OF 6

HOOKS ON M1 AND T7 BARS MAY BE TURNED AS NECESSARY FOR PLACING REINFORCING STEEL.

"T" BARS IN TOP OF FOOTINGS MAY BE SHIFTED AS NECESSARY, WITHOUT VIOLATING THE 1'-0" MAXIMUM SPACING, TO CLEAR M1 BARS EXTENDING INTO COLUMNS.

FOR MASS CONCRETE, SEE SPECIAL PROVISIONS.

PLANS AND CALCULATIONS FOR ANY TEMPORARY SUPPORTS ATTACHED TO FOOTINGS, COLUMNS OR BENT CAPS SHALL BE SUBMITTED FOR REVIEW AND APPROVAL BY THE ENGINEER PRIOR TO START OF BENT CONSTRUCTION. ANY ATTACHMENT PROVISIONS SHALL BE REMOVED AFTER USE AND THE FOOTINGS, COLUMNS OR BENT CAPS REPAIRED IN SUCH A WAY AS TO NOT COMPROMISE THE INTEGRITY OF THE BENT.

DETAILED DRAWINGS FOR FALSEWORK AND FORMS FOR ALL HAMMERHEAD BENTS SHALL BE SUBMITTED FOR REVIEW AND APPROVAL BY THE ENGINEER. SEE SPECIAL PROVISIONS FOR FORMWORK AND FALSEWORK.

NOTES FOR THIS SHEET

FOR SECTION B-B, SEE "SUBSTRUCTURE BENT 4 FOOTING & COLUMN DETAILS", SHEET 3 OF 6.

FOR SECTION C-C, SEE "SUBSTRUCTURE BENT 4 BENT CAP DETAILS", SHEET 5 OF 6.

FOR DETAILS OF BENT CAP, SEE "SUBSTRUCTURE BENT 4 BENT CAP PLAN AND ELEVATION", SHEET 4 OF 6 AND "SUBSTRUCTURE BENT 4 BENT CAP DETAILS", SHEET 5 OF 6.

PROJECT NO. U-2579AB
 FORSYTH COUNTY
 STATION: 58+33.94 -Y15FLYCA-

SHEET 2 OF 6

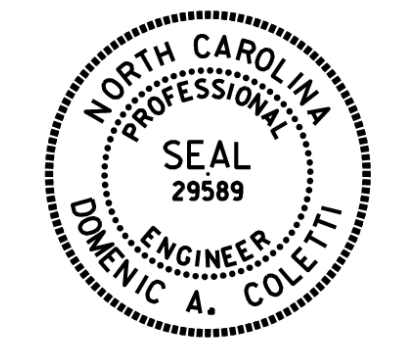

Dominic A. Coletti 10/15/2021

STATE OF NORTH CAROLINA
 DEPARTMENT OF TRANSPORTATION
 RALEIGH

SUBSTRUCTURE BENT 4 ELEVATIONS

DES BY: S. CHAUDHARI	DATE: 09/19	DWG BY: B. PETERSON	DATE: 12/19
DES CHK: N. LIU	DATE: 10/19	CHK BY: N. LIU	DATE: 01/20



DOCUMENT NOT CONSIDERED FINAL UNLESS ALL SIGNATURES COMPLETED

REVISIONS						SHEET NO. 506-102 TOTAL SHEETS 129
NO.	BY:	DATE:	NO.	BY:	DATE:	
1	--	--	3	--	--	
2	--	--	4	--	--	