

PARTIAL FRONT ELEVATION

* INVERT ORIENTATION OF ALTERNATE #5S101 AND #5S103 TIES

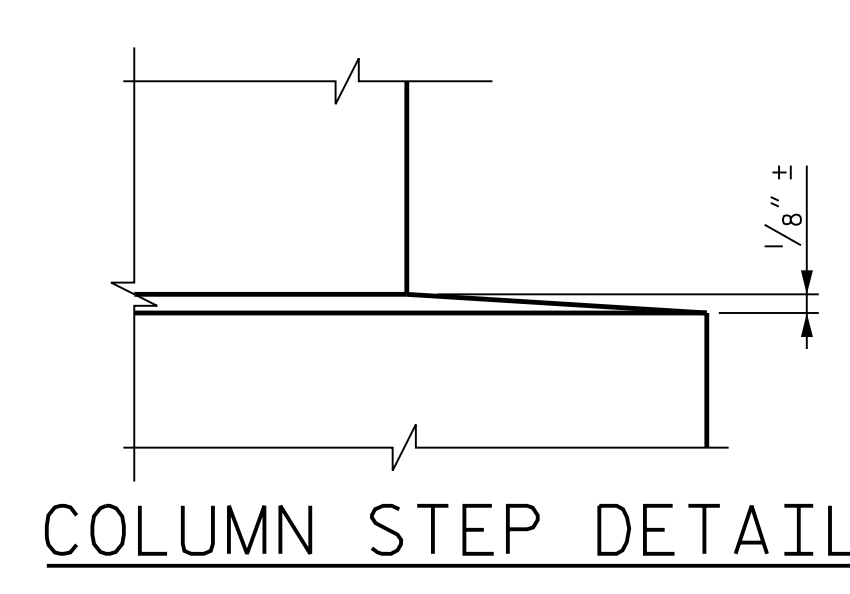

COLUMN STEP DETAIL

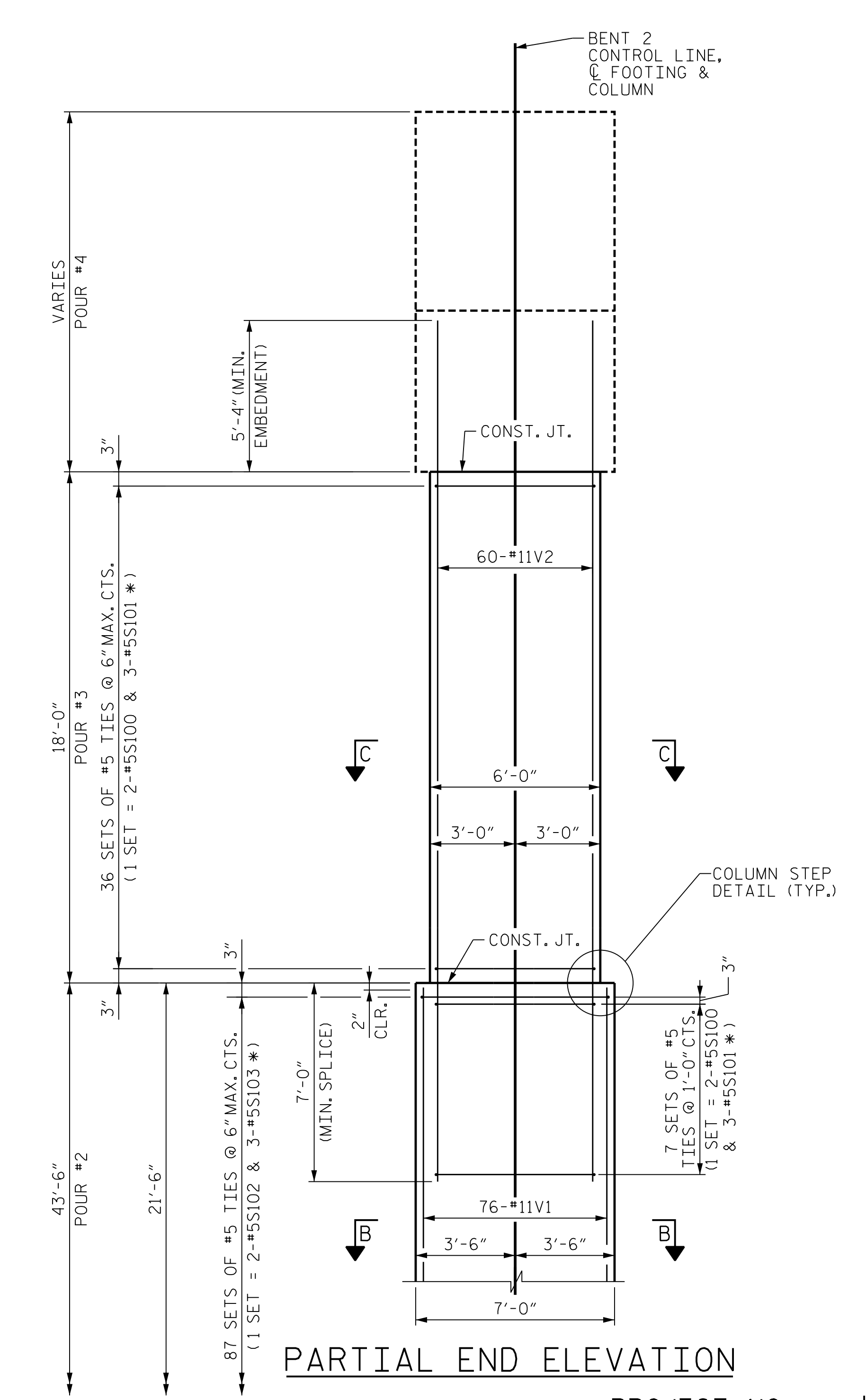

PARTIAL END ELEVATION

PROJECT NO. U-2579AB
 FORSYTH COUNTY
 STATION: 47+63.62 -Y15FLYBD-
 SHEET 2 OF 6

NOTES

- FOR SECTION B-B, SEE "SUBSTRUCTURE BENT 2 FOOTING & COLUMN DETAILS", SHEET 3 OF 6.
- FOR SECTION C-C, SEE "SUBSTRUCTURE BENT 2 BENT CAP DETAILS", SHEET 5 OF 6.
- FOR DETAILS OF BENT CAP, SEE "SUBSTRUCTURE BENT 2 BENT CAP PLAN AND ELEVATION", SHEET 4 OF 6 AND "SUBSTRUCTURE BENT 2 BENT CAP DETAILS", SHEET 5 OF 6.
- FOR ADDITIONAL NOTES, SEE "SUBSTRUCTURE BENT 1 ELEVATIONS", SHEET 1 OF 5.

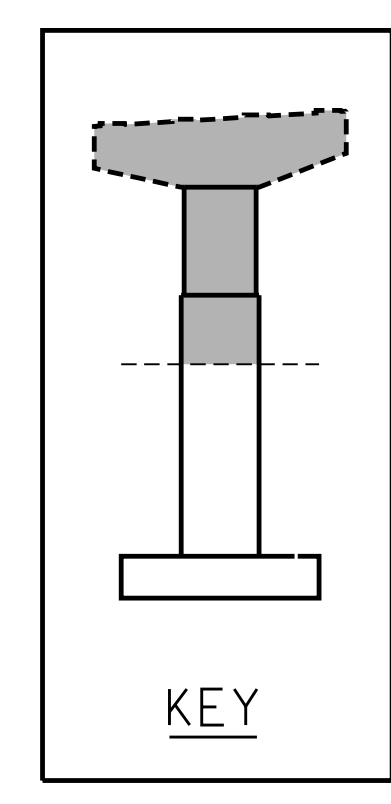

STATE OF NORTH CAROLINA
 DEPARTMENT OF TRANSPORTATION
 RALEIGH

SUBSTRUCTURE BENT 2 ELEVATIONS

REVISIONS					
NO.	BY:	DATE:	NO.	BY:	DATE:
1	--	--	3	--	--
2	--	--	4	--	--

SHEET NO. 505-081
 TOTAL SHEETS 116

DES BY: K. OLIVER	DATE: 11/19	DWG BY: B. PETERSON	DATE: 11/19
DES CHK: N. LIU	DATE: 11/19	CHK BY: N. LIU	DATE: 12/19



DOCUMENT NOT CONSIDERED FINAL UNLESS ALL SIGNATURES COMPLETED