

PLAN OF SPAN A
* DIMENSIONS ARE RADIAL TO -Y1B-

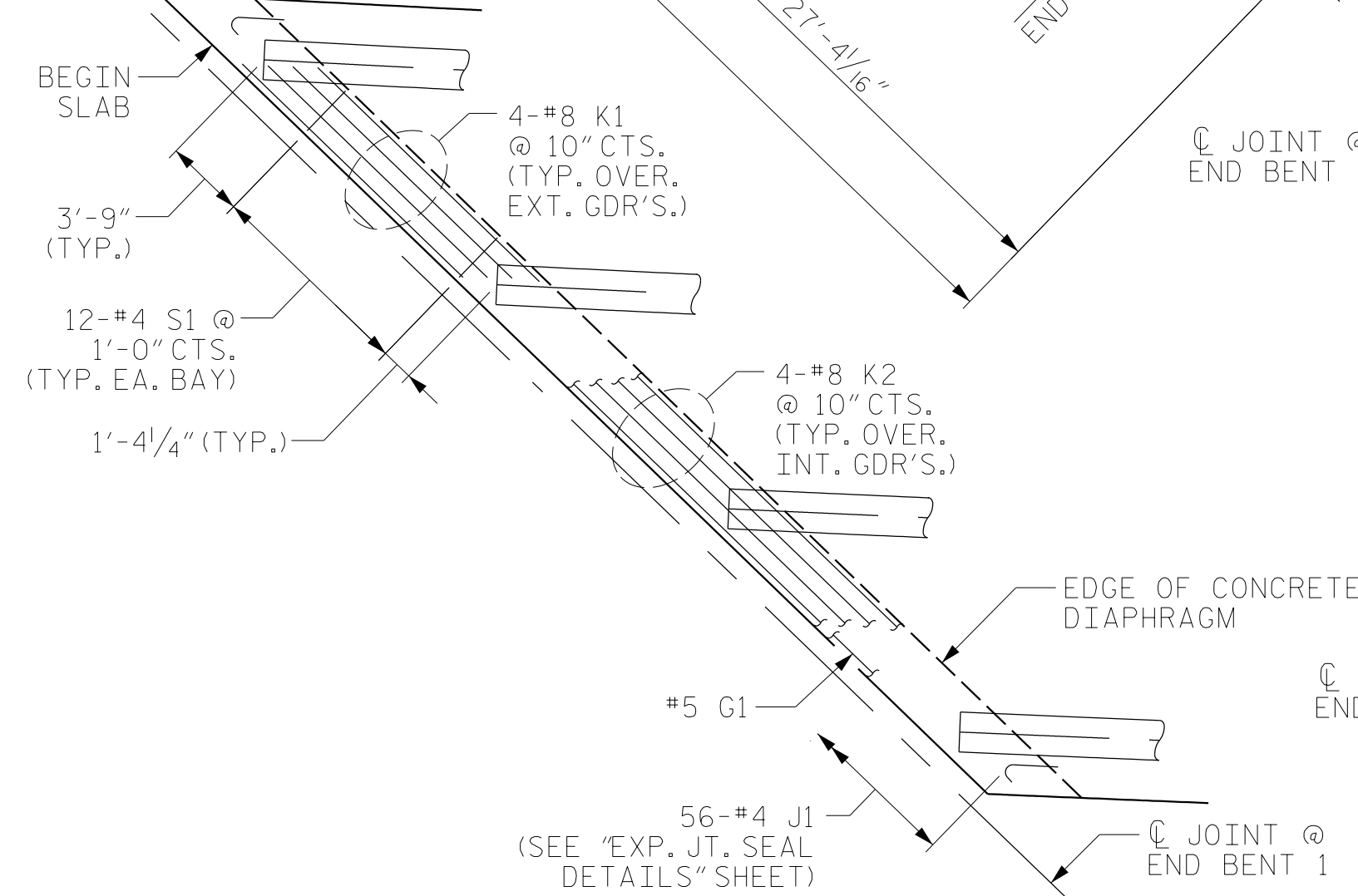

END BENT 1 DIAPHRAGM REINFORCING DETAILS

#5 G1 MAY BE SHIFTED SLIGHTLY, AS NECESSARY, TO CLEAR REINFORCING STEEL AND STIRRUPS

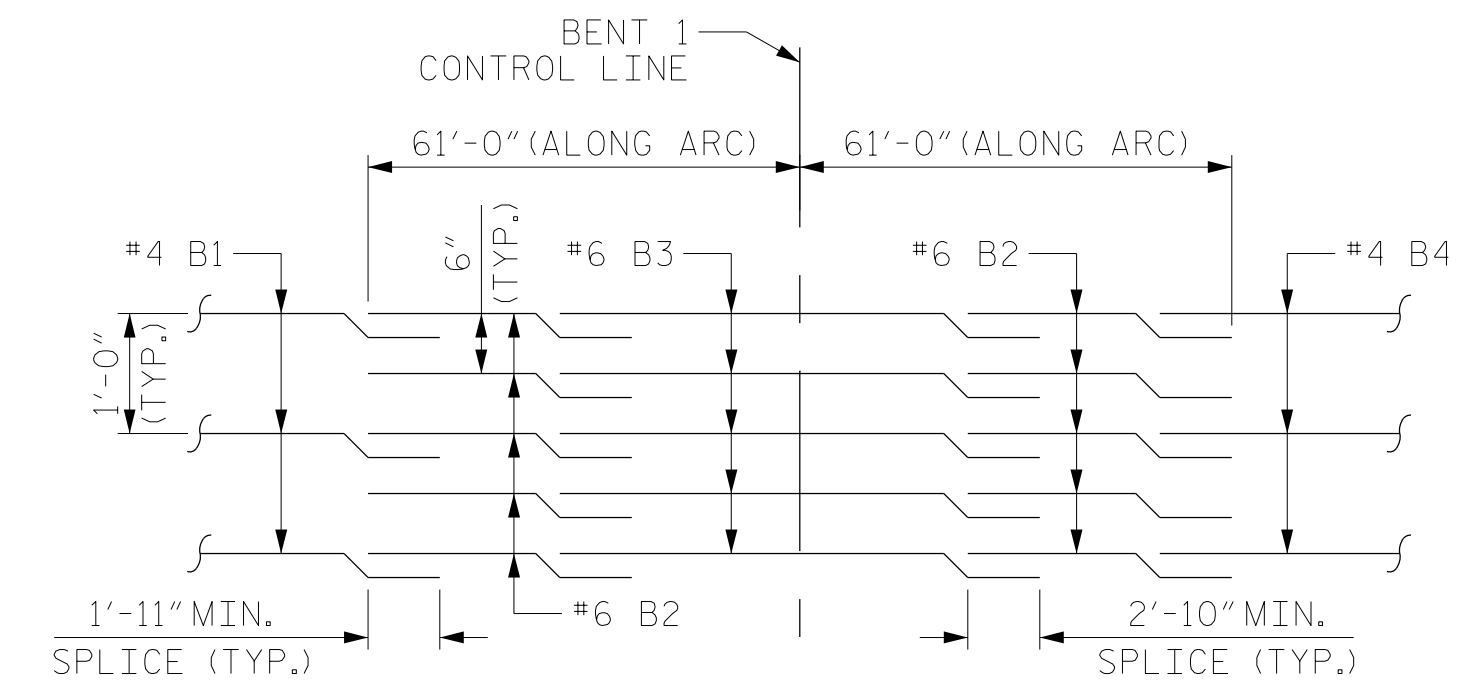

TOP OF SLAB REINFORCING STEEL LAYOUT
CURVATURE OF BARS NOT SHOWN FOR CLARITY

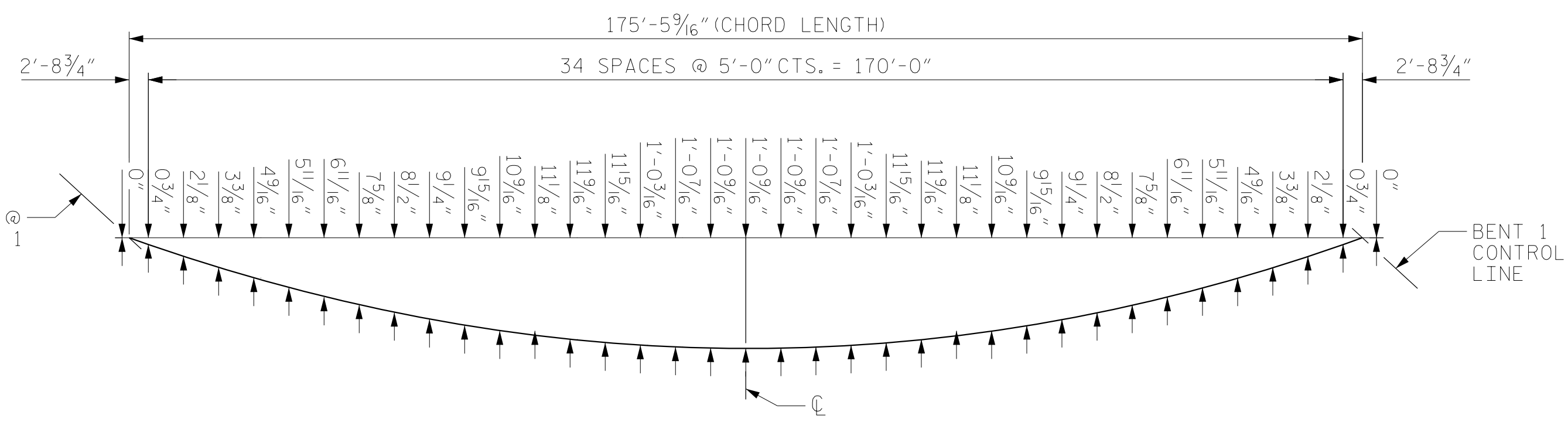

LEFT SIDE SPAN A ARC OFFSETS

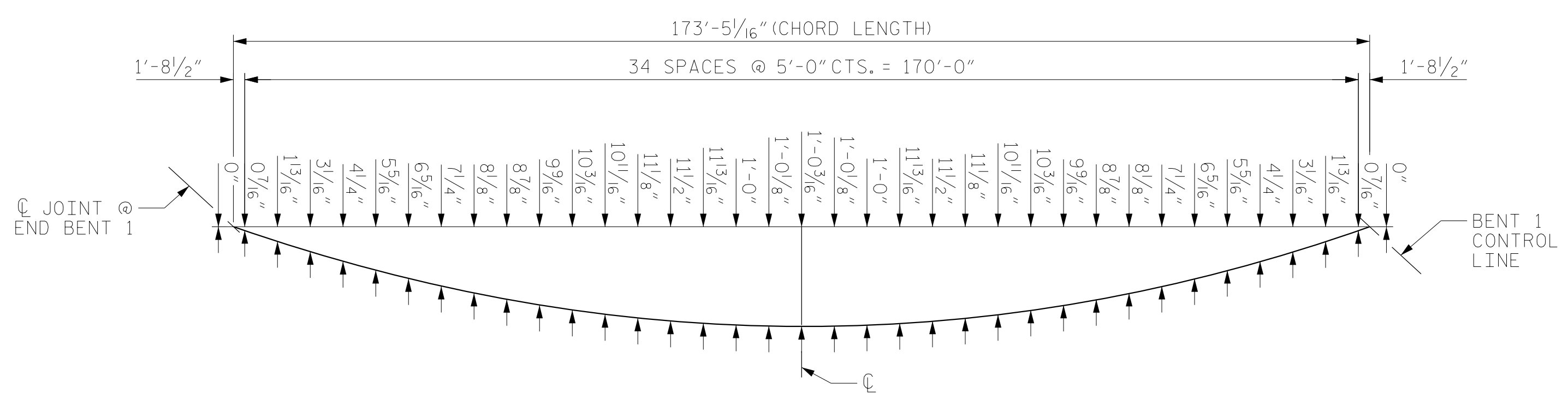

RIGHT SIDE SPAN A ARC OFFSETS

NOTES:
FOR SPLICE LENGTHS NOT SHOWN, REFER TO MINIMUM SPLICE LENGTH TABLE ON "SUPERSTRUCTURE BILL OF MATERIAL" SHEET 1 OF 2.
INTERMEDIATE DIAPHRAGMS NOT SHOWN FOR CLARITY. FOR LOCATIONS, SEE "FRAMING PLAN" SHEET.
FOR PARAPET REINFORCING STEEL, SEE PARAPET SHEETS.
FOR SIDEWALK REINFORCING STEEL, SEE "SIDEWALK DETAILS" SHEET.
FOR POURING SEQUENCE, SEE "SUPERSTRUCTURE BILL OF MATERIAL" SHEET 2 OF 2.
LIMITS OF CONCRETE DIAPHRAGM EXTEND TO OUTSIDE EDGE OF DECK AS SHOWN IN "END BENT 1 DIAPHRAGM REINFORCING DETAILS" ON THIS SHEET.
#5 "A" BARS ARE SPACED PERPENDICULAR TO THE LONG CHORD.
T.O.S. = TOP OF SLAB
B.O.S. = BOTTOM OF SLAB

PROJECT NO. U-2579AB
FORSYTH COUNTY
STATION: 22+26.35 -Y1B-

SHEET 1 OF 2



STATE OF NORTH CAROLINA
DEPARTMENT OF TRANSPORTATION
RALEIGH
SUPERSTRUCTURE
PLAN OF SPAN A

DRAWN BY : MRA DATE : 10/2019
CHECKED BY : JMR DATE : 11/2019
DESIGN ENGINEER OF RECORD: MAL DATE : 11/2019

DOCUMENT NOT CONSIDERED
FINAL UNLESS ALL
SIGNATURES COMPLETED

REVISIONS						SHEET NO.
NO.	BY:	DATE:	NO.	BY:	DATE:	S1-9
1			3			TOTAL SHEETS
2			4			47