

PHASING DIAGRAM

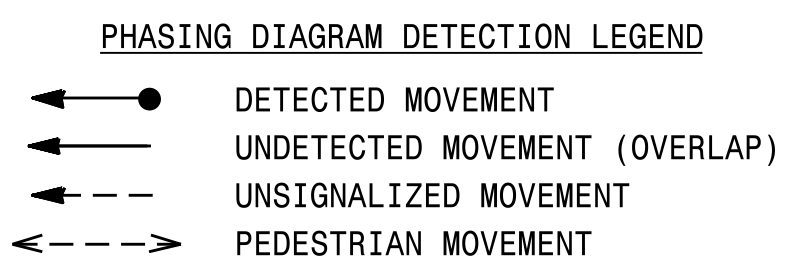
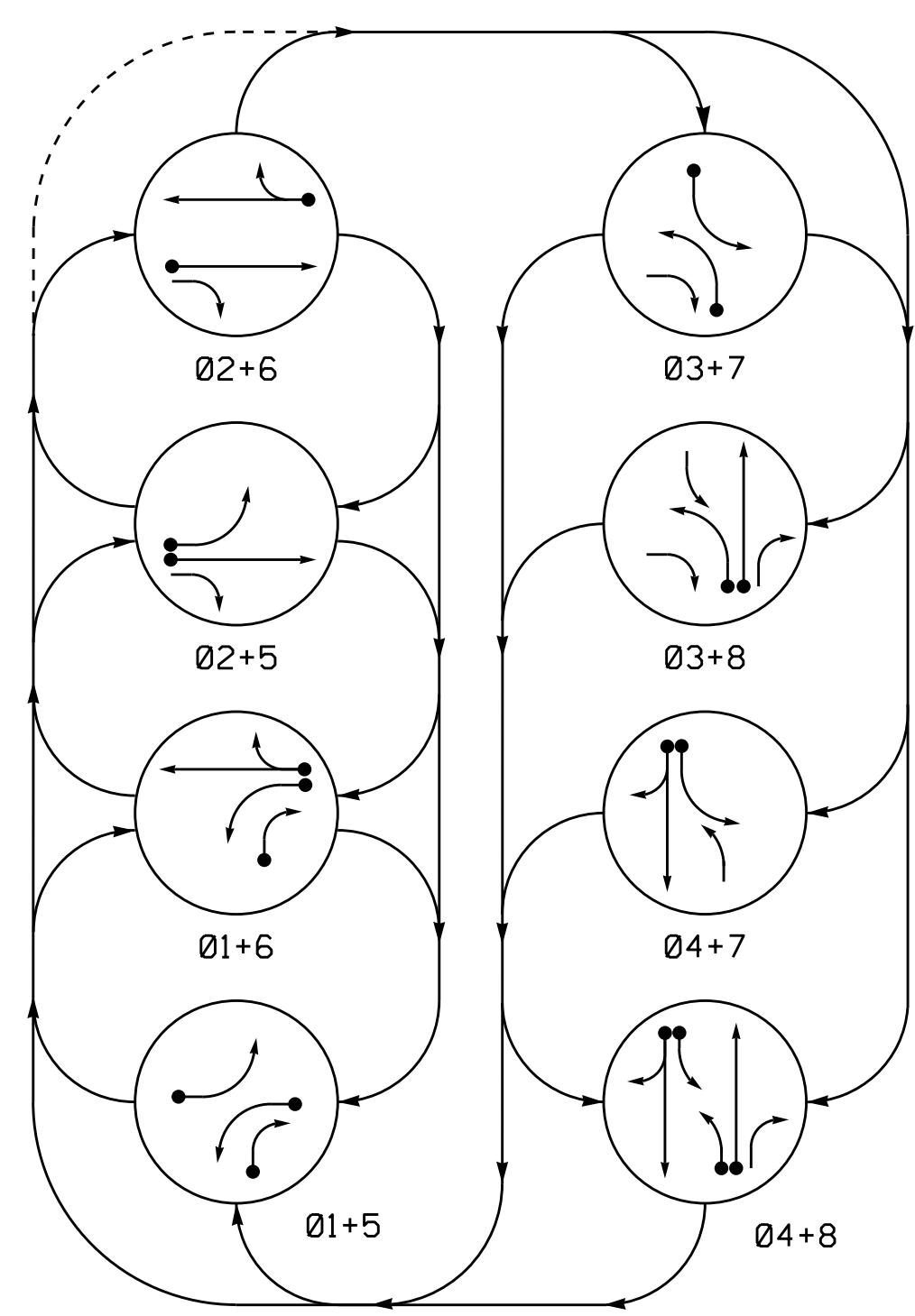
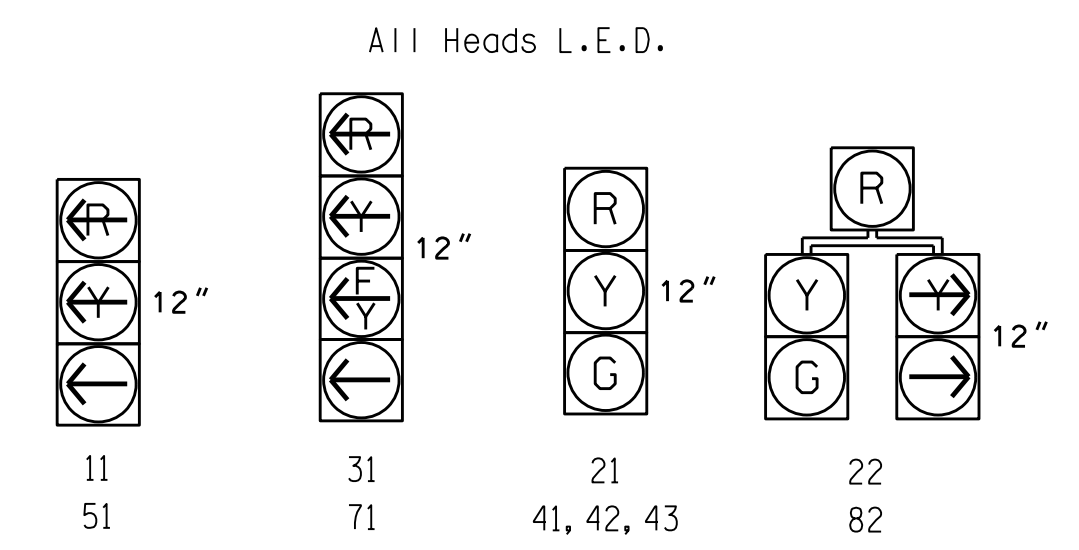

TABLE OF OPERATION

SIGNAL FACE	PHASE							
	01+5	01+6	02+5	02+6	03+7	03+8	04+7	04+8
11	←	←	←	←	←	←	←	←
21	R	R	G	G	R	R	R	Y
31	←	←	←	←	←	←	←	←
41, 42, 43	R	R	R	R	R	R	G	G
51	←	←	←	←	←	←	←	←
61, 62	R	G	R	G	R	R	R	Y
71	←	←	←	←	←	←	←	←
81	R	R	R	R	R	G	R	G
82	R	R	R	R	R	G	R	G

SIGNAL FACE I.D.



OASIS 2070 LOOP & DETECTOR INSTALLATION CHART

ZONE	SIZE (FT)	DISTANCE FROM STOPBAR (FT)	TURNS	NEW LOOP	DETECTOR PROGRAMMING				SYSTEM LOOP	NEW CARD	
					PHASE	CALLING	EXTENSION	STRETCH TIME			DELAY TIME
1A*	6X40	0	*	*	1	Y	Y	-	3	-	*
2A*	6X6	300	*	*	2	Y	Y	-	-	-	*
3A*	6X40	0	*	*	3	Y	Y	-	15	-	*
4A*	6X40	0	*	*	4	Y	Y	-	10	-	*
4B*	6X6	0	*	*	4	Y	Y	-	15	-	*
5A*	6X40	0	*	*	5	Y	Y	-	3	-	*
6A*	6X6	300	*	*	6	Y	Y	-	-	-	*
7A*	6X40	0	*	*	7	Y	Y	-	15	-	*
8A*	6X40	0	*	*	8	Y	Y	-	3	-	*

* Video Detection Zone

8 Phase Fully Actuated (Winston-Salem Signal System)

NOTES

1. Refer to "Roadway Standard Drawings NCDOT" dated January 2018 and "Standard Specifications for Roads and Structures" dated January 2018.
2. Do not program signal for late night flashing operation unless otherwise directed by the Engineer.
3. Phase 1 and/or phase 5 may be lagged.
4. Phase 3 and/or phase 7 may be lagged.
5. Set all detector units to presence mode.
6. Locate new cabinet so as not to obstruct sight distance of vehicles turning right on red.
7. Pavement markings are existing.
8. This intersection uses video detection. Install detectors according to the manufacturer's instructions to achieve the desired detection.
9. Maximum times shown in timing chart are for free-run operation only. Coordinated signal system timing values supersede these values.

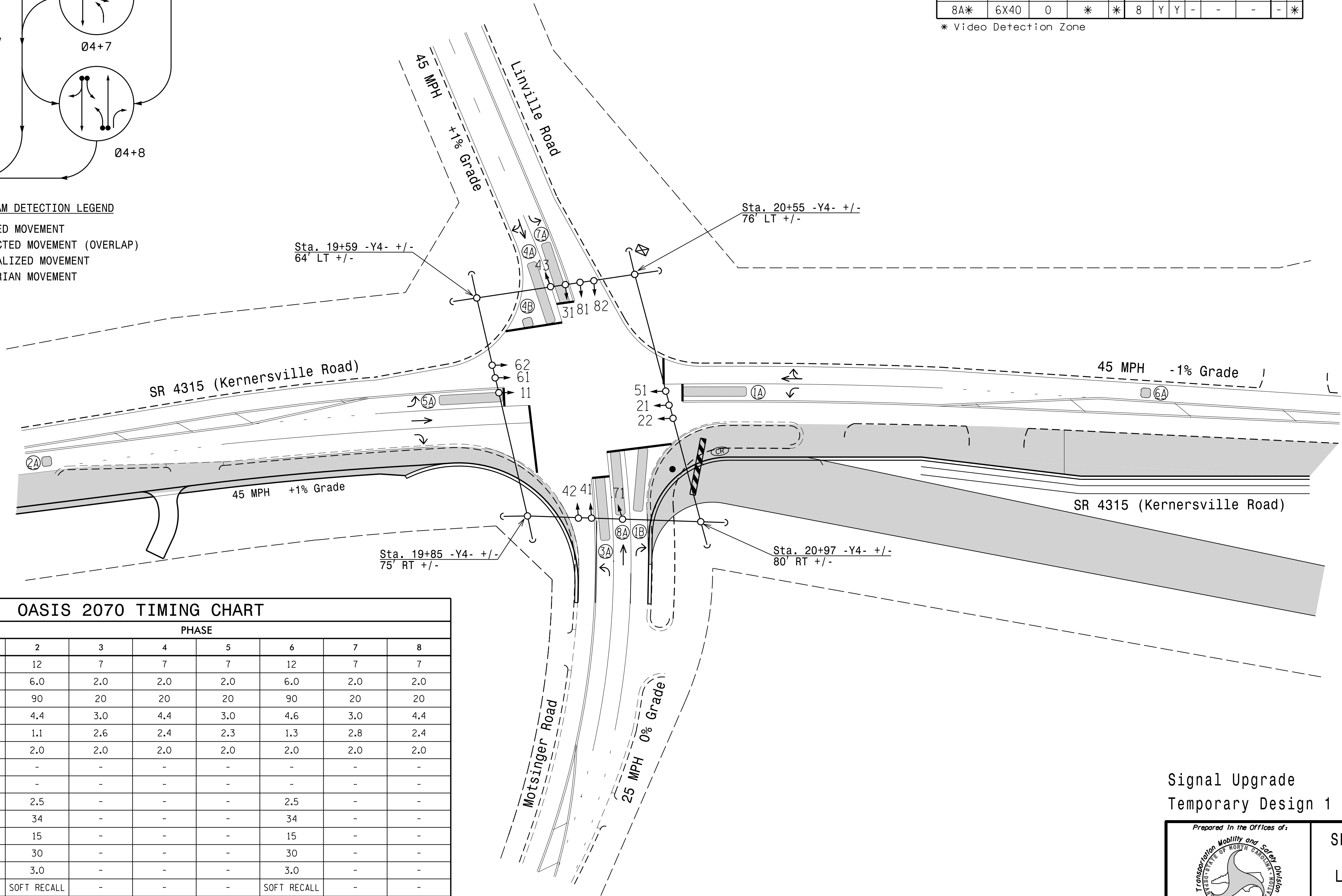

OASIS 2070 TIMING CHART

FEATURE	PHASE							
	1	2	3	4	5	6	7	8
Min Green 1 *	7	12	7	7	7	12	7	7
Extension 1 *	2.0	6.0	2.0	2.0	2.0	6.0	2.0	2.0
Max Green 1 *	20	90	20	20	20	90	20	20
Yellow Clearance	3.0	4.4	3.0	4.4	3.0	4.6	3.0	4.4
Red Clearance	2.1	1.1	2.6	2.4	2.3	1.3	2.8	2.4
Red Revert	2.0	2.0	2.0	2.0	2.0	2.0	2.0	2.0
Walk 1 *	-	-	-	-	-	-	-	-
Don't Walk 1	-	-	-	-	-	-	-	-
Seconds Per Actuation *	-	2.5	-	-	-	2.5	-	-
Max Variable Initial *	-	34	-	-	-	34	-	-
Time Before Reduction *	-	15	-	-	-	15	-	-
Time To Reduce *	-	30	-	-	-	30	-	-
Minimum Gap	-	3.0	-	-	-	3.0	-	-
Recall Mode	-	SOFT RECALL	-	-	-	SOFT RECALL	-	-
Vehicle Call Memory	-	YELLOW	-	-	-	YELLOW	-	-
Dual Entry	-	-	-	ON	-	-	-	ON
Simultaneous Gap	ON	ON	ON	ON	ON	ON	ON	ON

* These values may be field adjusted. Do not adjust Min Green and Extension times for phases 2 and 6 lower than what is shown. Min Green for all other phases should not be lower than 4 seconds.

LEGEND

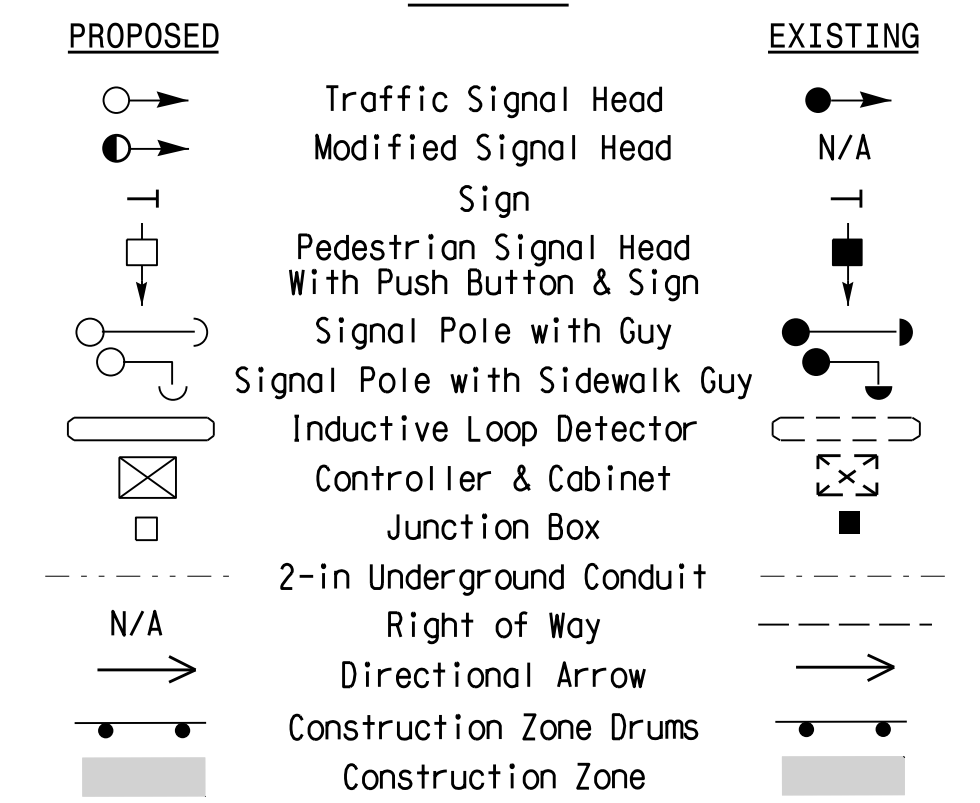

Signal Upgrade Temporary Design 1 (TMP Area 3 Phase 1)

750 N. Greenfield Pkwy, Garner, NC 27529

SR 4315 (Kernersville Road) at Linville Rd./Motsinger Rd.

Division 9 Forsyth County Winston-Salem

PLAN DATE: May 2021 REVIEWED BY:

PREPARED BY: I. O. Umzurike REVIEWED BY:

DOCUMENT NOT CONSIDERED FINAL UNLESS ALL SIGNATURES COMPLETED

SEAL

7/9/2021

SIG. INVENTORY NO. 09-0660T1