

PROJECT REFERENCE NO. U-2579AB		SHEET NO. 26	
ROADWAY DESIGN ENGINEER		HYDRAULICS ENGINEER	
			
10/14/2021		10/13/2021	

**DOCUMENT NOT CONSIDERED FINAL
UNLESS ALL SIGNATURES COMPLETED**

HDR HDR Engineering, Inc. of the Carolinas
555 Fayetteville St. Suite 900 Raleigh, N.C. 27601
N.C.B.E.L.S. License Number: F-0116

-Y5B-			
PI Sta. 12+85.91 Δ = 27° 30' 01.6" (RT) D = 19° 05' 54.9" L = 143.99' T = 73.41' R = 300.00'	PI Sta. 16+34.35 Δ = 20° 46' 49.2" (RT) D = 7° 09' 43.1" L = 290.15' T = 146.69' R = 800.00' SE = 0.03	PI Sta. 21+40.17 Δ = 19° 49' 48.4" (LT) D = 7° 09' 43.1" L = 276.88' T = 139.84' R = 800.00' SE = 0.03	PI Sta. 24+70.15 Δ = 6° 54' 56.0" (LT) D = 2° 39' 31.5" L = 260.11' T = 130.21' R = 2,155.00'

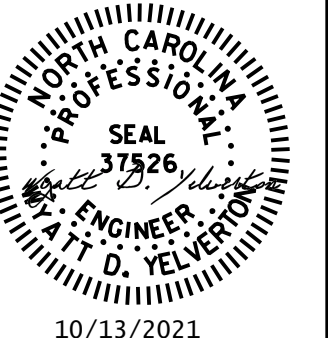
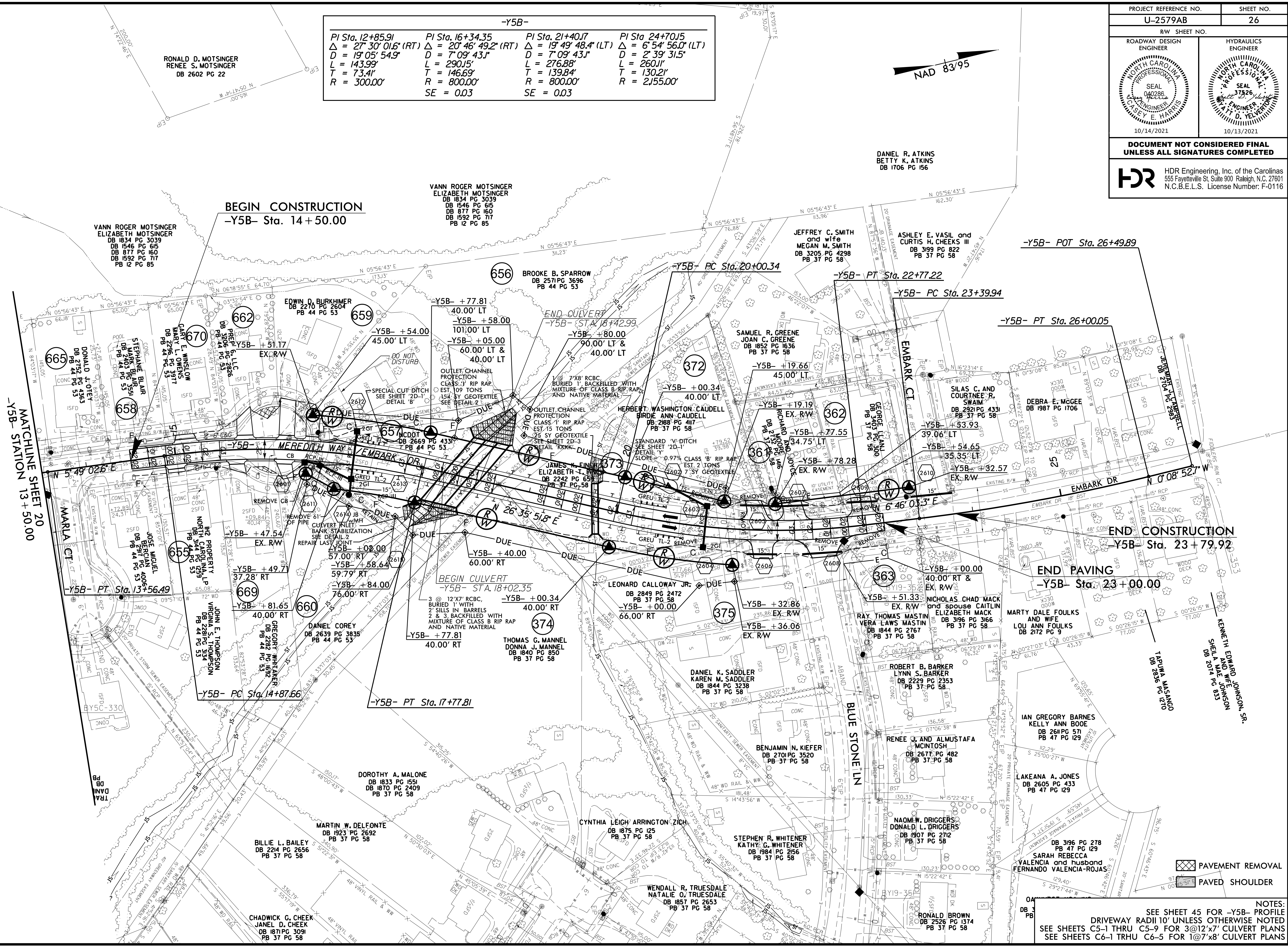
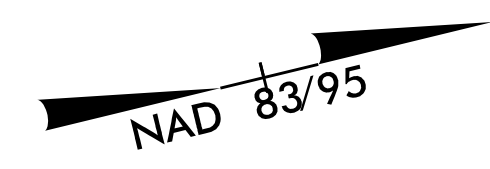

MATCHLINE SHEET 20
-Y5B- STATION 13+50.00

END CONSTRUCTION
-Y5B- Sta. 23+79.92

END PAVING
-Y5B- Sta. 23+00.00

REVISIONS

PLOT DRIVER: NCDOT...
USER: SPEREIRA
DATE: 8/27/2021
TIME: 2:09:33 PM

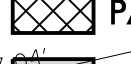
 PAVEMENT REMOVAL

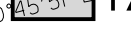
 PAVED SHOULDER

NOTES:
SEE SHEET 45 FOR -Y5B- PROFILE
DRIVEWAY RADII 10' UNLESS OTHERWISE NOTED
SEE SHEETS C5-1 THRU C5-9 FOR 3@12'x7' CULVERT PLANS
SEE SHEETS C6-1 THRU C6-5 FOR 1@7'x8' CULVERT PLANS